



CATLINK RFID Pet Feeder

Luxury User Manual



Toll free: +1 833 440 2772 Email: support@catlink.cn

Thank you for purchasing the CATLINK RFID Pet Feeder - Luxury!

CATLINK is committed to developing innovative products that cater to your pet's needs and make your life easier.

The CATLINK RFID Pet Feeder - Luxury is designed to recognize the CATLINK RFID Collar Tag, which comes in packs of two that are included with the feeder. When your pet places its head on the front top of the feeder, the collar tag will be scanned, allowing your pet to access its food while keeping other animals out. This feeder is perfect for use in multi-pet households, as it only opens for authorized pets.

This user manual provides step-by-step instructions for configuring the feeder to work in your home. From installing the batteries to teaching your pet how to use the feeder, we will guide you through the entire process.

The CATLINK RFID Pet Feeder - Luxury is packed with many features, so be sure to keep this manual handy for future reference. If you require assistance or have any questions, please don't hesitate to reach out to us at support@catlink.cn or call us at +1 833 440 2772.

We hope you and your pets enjoy the freedom that comes with the CATLINK RFID Pet Feeder - Luxury.

Thank you again for choosing CATLINK.

01 Important Notice

- Before using this product, make sure to read this manual carefully. By using this product, you acknowledge that you have read and accepted the following safety precautions.
- It is important to note that we cannot be held responsible for any accidents or losses resulting from failure to comply with the guidelines outlined in this manual.
- Be aware that Shanghai Catlink Intelligent Technology Co., Ltd. retains the right to interpret and make amendments to this manual as necessary.

02 Important Safety Instructions

- ① To properly install and use the device, it is important to strictly follow this manual.
- ② Follow the official tutorial steps provided for installation and use. Do not forcibly insert or remove parts, as this may result in the device malfunctioning.
- ③ Only use the recommended adapter to power the device to prevent damage, malfunction or potential security risks.
- ④ To prevent damage to the feeder or shorten its service life, use it indoors and keep it away from sources of fire, high temperatures, high humidity, or direct sunlight.
- ⑤ Ensure the device is placed horizontally on a stable surface to avoid tipping over.
- ⑥ Keep any objects at least 20cm away from the front of the device to avoid interfering with your cat's eating experience or the device's proper operation.
- ⑦ Do not manually press the bowl as this may affect the weighing accuracy and feeding mechanism.
- ⑧ After cleaning the bowl, gently place it back on the device once it has dried. Make sure to align it correctly.
- ⑨ If the device will not be used for an extended period, remove the battery, clean the device, pack the parts in the original order, and store in a dry place.
- ⑩ Do not immerse the feeder in water. Instead, turn it off, wipe it with a dry cloth, and allow it to dry completely before turning it back on. Avoid using gasoline, alcohol, or other chemicals, as this may cause damage.
- ⑪ Please note that the device or related functions may differ from those described in this manual as we continue to improve it. For any questions, refer to the latest e-Manual in the CATLINK APP or contact us at support@catlink.cn or +1 833 440 2772.

03 What's In the Box

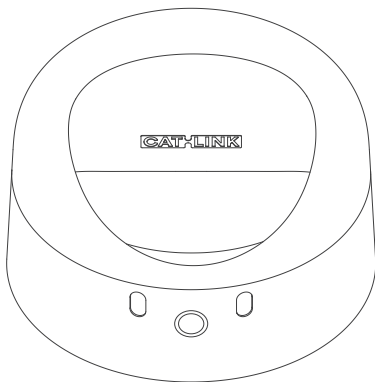

Feeder x1



Adapter x1



Cable x1



Collar x2



RFID Collar Tag x2



User Manual x1

04 Product Structure

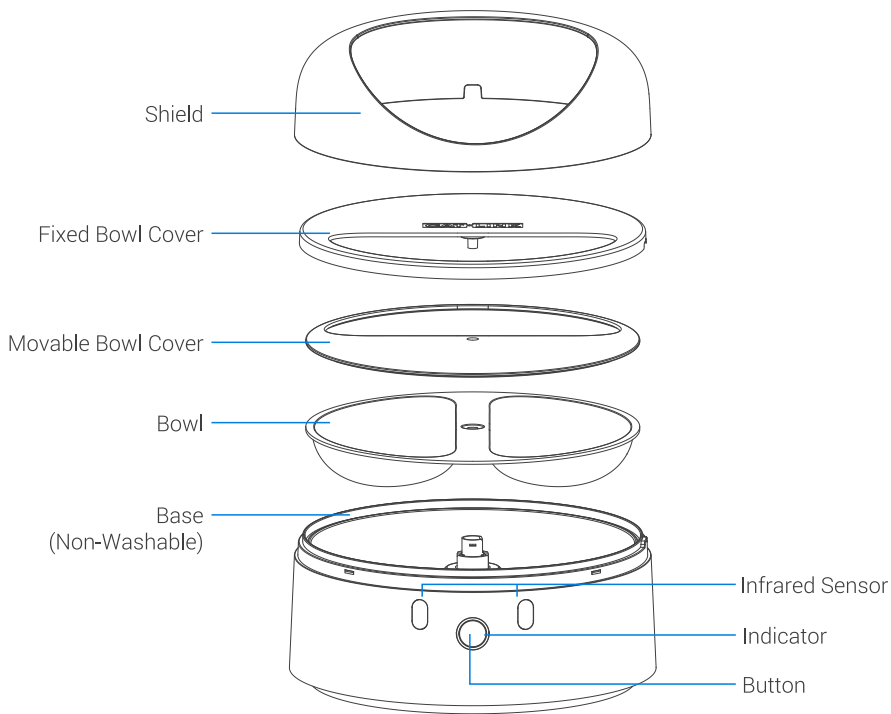

05 Setting Up Your CATLINK RFID Pet Feeder - Luxury

Once you have assembled the product and confirmed that the package is complete, get started by following the steps below.

① Placement

- Place the feeder on a flat and sturdy surface with no objects underneath it. Avoid soft, uneven, or unstable flooring as this can affect its performance.
- Make sure the feeder is positioned to receive a stable Wi-Fi signal. If necessary, move it closer to your Wi-Fi router.
- Ensure that there are no obstructions within 50cm in front of the feeder to prevent interference with the sensor.
- Stay close to the power outlet and keep the power cord slack to avoid safety hazards.

② Power

- Connect the small end of the power supply to the Power input at the back of the Base. Next, plug the adapter into a wall outlet.
- It is recommended to install four No.2 batteries to ensure uninterrupted operation even during unexpected power outages.

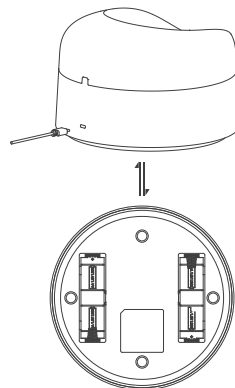

③ Wi-Fi Connection

NOTE:

- Place the feeder as close to the router as possible and make sure it is powered on.
- Authorize the location information, and turn on GPS on your Android phone.
- Use a 2.4GHz Wi-Fi network to connect the feeder. 5GHz Wi-Fi is not supported, and certain locations such as hotels and airports that require special certification of Wi-Fi may also not be supported.

① Download the CATLINK APP from your phone's application market or scan the QR code.



CATLINK app



For iOS



For Android

- ② Register your account in the app and log in (Make sure to authorize the location information and turn on GPS for your Android phone).
- ③ On the DEVICE page, click the '+' in the upper right corner. The APP will automatically search for this product. If the automatic search does not work, press and hold the button for 5 seconds until the blue light flashes, and then click 'Re-search' in the APP.
- ④ Select CATLINK RFID Pet Feeder - Luxury and follow the instructions to complete the Wi-Fi connection. Before connecting, ensure that your mobile phone is connected to Wi-Fi. Once the connection is successful, the indicator on the base will remain on.

Connection Failed

If you experience connection failure, turn off the power and try again. We recommend referring to the NOTE under the [Wi-Fi Connection] section of this chapter to ensure a smooth setup process.

If the connection is still unsuccessful, please feel free to contact us at +1 833 440 2772 or support@catlink.cn.

④ Scale Reset

NOTE:

- Make sure that there are no foreign objects in the bowl.
- Ensure that the bowl is placed properly.

Press and hold the button for 3 seconds. When you hear a beep and see the indicator flashing blue, release the button to complete the Scale Reset.

*Record the amount of pet food consumed in a single feeding, starting from a minimum of 2 grams.

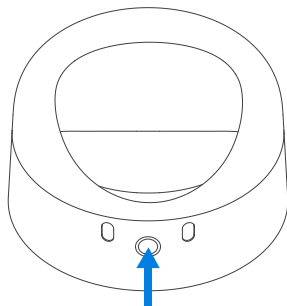

06 Replacing the Food

NOTE:

- The maximum capacity of the bowl is 400mL, with two sections of 200mL each. The bowl should be placed properly.
- The bowl can hold freeze-dried, wet food, and other types of cat food. We recommend placing different types of cat food in each section.
- Be sure to pay attention to the amount of food you pour into the bowl and DO NOT exceed the mobile bowl cover. It is recommended to use a spoon to spread the cat food evenly.

- ① Double-click the button to open the feeder.
- ② Fill one section of the bowl with food, making sure not to overfill it, as this may prevent the cover from closing properly and cause a mess.
- ③ To close the feeder, double-click the button again.
- ④ Repeat the process to fill the other section of the bowl.

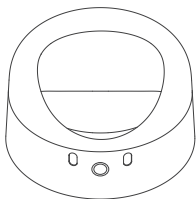

Open the feeder

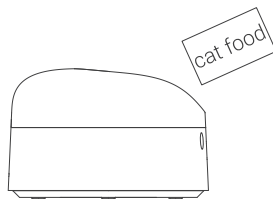

Put food in one section

07 Authorizing Pets to Use the Feeder

Use the CATLINK APP to scan the QR code on the Collar Tag and pair your pet's collar with their feeder. Then put on the corresponding collar for your pet.

Once installed, the CATLINK RFID Pet Feeder - Luxury will prevent greedy or aggressive pets from accessing food that is not theirs, giving you control over your pets' prescribed meals, medications, and weight management. Pets often prefer to consume small meals throughout the day. To facilitate this and minimize waste, the CATLINK RFID Pet Feeder - Luxury was designed.

NOTE: For **single-cat** households, it is optional to not bind the collar tag for usage. In the case where the device is not bound to a tag, it can automatically open when the cat approaches the front.

Authorized pets with collar tag

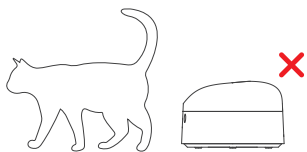
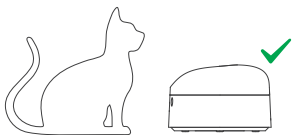

- The feeder cover will remain closed until you open it to replace the food.
- The infrared sensor at front of the device detects the arrival of your cat and activates the RFID sensor to identify the pet's tag information.
- If your pet's tag is authorized and allowed to eat, the cover will open for it.
- Once your pet has finished eating and walked away, the feeder cover will close after a short delay(20s). This helps to keep the food fresher by sealing the bowl again.

Unauthorized pets

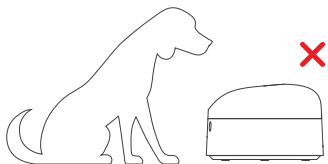

- The lid will not open if an unauthorized pet attempts to access the feeder while it is closed.

08 Teaching Your Pet to Use the Feeder (Training Mode)

To help your pet get comfortable with the new feeder, start with Training Mode via the CATLINK APP if your pet is using the feeder for the first time or has not used it for a while. This mode will allow your pet to become familiar with the movement of the feeder's cover.

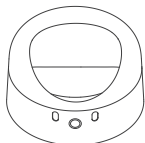

Open

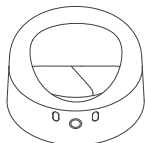

Semi-closed

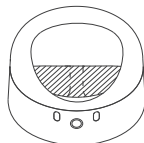

Closed

Training Mode (5 days/period)

Phase I (2 days):

During Training Mode, the device will remain open, and after your pet has finished eating and left, it will automatically open another section of the bowl after one feeding.

Phase II (2 days):

When your pet finishes eating and leaves, the device will semi-close the food bowl until it detects that your pet has come to eat again, and it will fully open the food bowl.

Phase III (1 day):

The device will then enter Auto Mode, which means that the cover of the bowl will only open for authorized cats. You should closely observe your pet at this point to ensure that it has fully adapted to the new feeder. If your pet is still nervous or uncomfortable, you can re-enter the Training Mode in the APP until your pet is fully acclimated.

09 Training Multiple Pets

If multiple pets have the same feeding requirements, they can share a feeder. However, if they have different dietary needs or require different amounts of food, it's best to provide each pet with its own feeder. This allows you to precisely control each pet's diet and avoid any potential feeding conflicts.

1

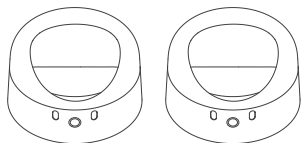

It is recommended to have a separate feeder for each pet, as this allows for precise diet management for each individual pet.

2

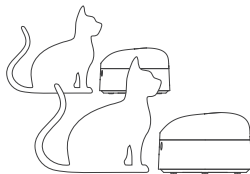

Make sure to keep the feeders separated so that each pet can recognize its own feeder.

3

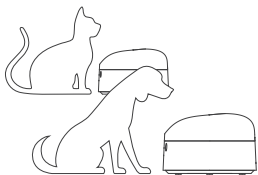

Before beginning the Training Mode, ensure that each pet is comfortable consuming food from the feeder while it is in the open position.

4

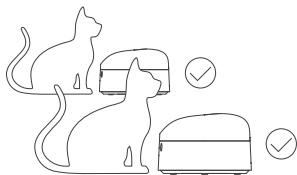

As you progress through the training stages, your pets will learn which feeder is theirs since it will only open for them.

10 Button Functions

Operation	Function	Explanation
Double-click	Open/Close	Open one section, close it; open the other one, and so on.
Press for 3 seconds	Scale Reset	Empty the bowl and properly install it. Press and hold the button for 3 seconds until the green light will flash. After one beep, the Scale Reset is complete. NOTE: The following conditions may cause inaccurate weighing, so calibrate it if necessary: 1. The pet touches the bowl strongly while eating. 2. The bowl has not been calibrated in a long time. 3. The bowl has been not recalibrated after cleaning.
Press for 5 seconds	Wi-Fi Connection	To connect the bowl to your Wi-Fi network, press and hold the button for 5 seconds until the green light will flash. Keep pressing and holding until the blue light starts flashing, indicating that the bowl has entered Wi-Fi Connection mode. If the Wi-Fi Connection is unsuccessful within 5 minutes, the Wi-Fi Connection mode will automatically exit.

The device or related functions may differ from those described in this manual as we continue to improve it. For any questions, refer to the latest e-Manual in the CATLINK APP.

11 Indicators

Indicator	Status	Explanation
White	Solid	The device runs properly.
	Blinking	The collar tag has been successfully read. The cover is open. The pet is eating.
Green	Blinking	It's calibrating.
Blue	Blinking	It is connecting to Wi-Fi network.
	Solid	The device has successfully connected to Wi-Fi. After a constant blue light for 10 seconds, it will turn to the solid white light.
Red	Solid	There is not enough food in the bowl.
	Blinking	There is a device failure (e.g. not properly installed, food stuck, etc.). Details can be viewed in the APP.

The device or related functions may differ from those described in this manual as we continue to improve it. For any questions, refer to the latest e-Manual in the CATLINK APP.

12 Working Mode

To customize the device's settings and choose different working modes, simply access the CATLINK APP on your phone.

Mode	Explanation	Note
Training Mode	This mode helps your pet get used to the new feeder.	Refer to chapter 08 [Teaching Your Pet to Use the Feeder (Training Mode)].
Auto Mode	When an authorized pet is detected, the cover will open and then close after the pet leaves. Unauthorized pets will not be able to open the cover.	The two sections of the bowl will open sequentially.
Timer Mode	You can customize feeding plans and set a voice message to play each time food is dispensed via the CATLINK APP. Authorized pets can open the cover and access their food within half an hour of dispensing.	The voice message (up to 5 seconds) can be customized via the CATLINK APP.

13 Backup Battery (Optional)

When operating in battery mode, the device will enter a low-power mode. We recommend users to use battery power only after the device has been fully set up and configured for optimal performance.

- It is recommended to use four C batteries.
- When switching to battery power, the device will automatically enter a low-power consumption mode and operate in offline mode. Once the pet has finished eating, it will automatically connect to Wi-Fi, synchronize data with the app, and then return to offline mode.
- If you need to configure the device, please plug in, and then cover the front of the Feeder or open the Food Bowl to ensure the device is connected to Wi-Fi.
- If the app displays a low battery warning, replace the batteries promptly.

14 Cleaning & Maintenance

Do not submerge the entire feeder in water or put it in the dishwasher.

- Washable parts: **Shield, Fixed Bowl Cover, Mobile Bowl Cover, Bowl**
- Unwashable part: **Base**

How to disassemble the feeder?

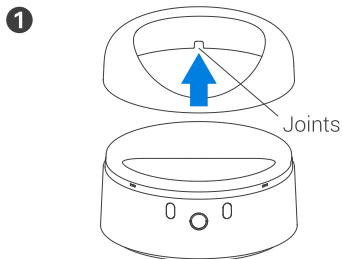

Align the joints and remove the Shield upwards.

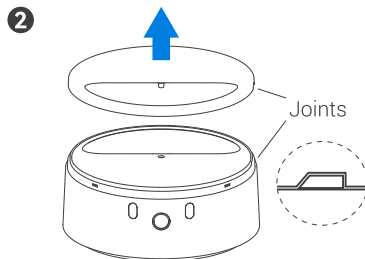

Align the joints and remove the Fixed Bowl Cover upwards.

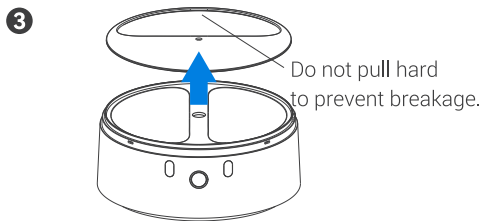

Align the joints and remove the Mobile Bowl Cover upwards.

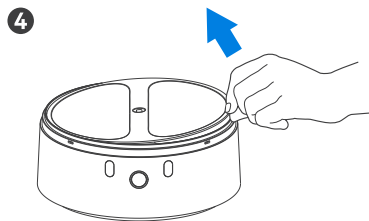

Remove the Bowl diagonally upwards.
The Bowl is washable.
The Base is unwashable.

15 Specification

Product Name	CATLINK RFID Pet Feeder - Luxury
Product Model	CL-FC-02
Main Material	ABS
Product Size	240 x 240 x 155 mm (9.45 x 9.45 x 6.10 inches)
Rated Voltage	5V $\overline{\text{=}}$ 1A
Rated Power	5W
Applicable Scope	Cats or small dogs
Product Weight	1.3kg (2.87lbs)
Carried Standard	GB 4706.1-2005
Brand Owner	Shanghai Catlink Intelligent Technology Co., Ltd
Address	No.800 Naxian road, Pudong New District, Shanghai, China
Website	www.catlinkus.com

16 Customer Service

We will provide customers with a one-year free warranty service.
If you have questions or need assistance, contact us!

Phone Support

+1 833 440 2772

Mon-Fri: 10AM-6PM EST

Email Support

support@catlink.cn 24/7



Toll free: +1 833 440 2772 Email: support@catlink.cn