

morphy richards

Steam iron

COMFIGRIP  Trizone



Please read and keep these instructions

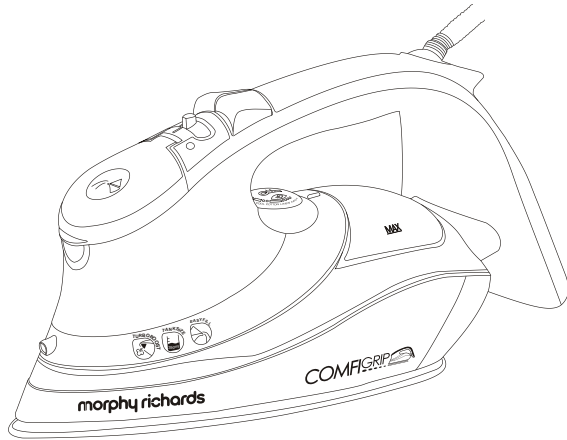

getting the best from
your new steam iron...



www.morphyrichards.co.uk
www.morphyrichardsindia.com

Important safeguards:

- This appliance can not be used by children aged below 8 years and persons with reduced physical, sensory or mental capabilities or lack of experience or knowledge if they have been given supervision or instruction concerning use of the appliance in a safe way and understand the hazards involved. Children shall not play with the appliance. Cleaning and user maintenance shall not be made by children without supervision.
- Keep the iron and its cord out of reach of children below 8 years of age at all times.
- The iron must not be left unattended while it is connected to the supply mains.
- The plug must be removed from the socket before being filled with water.
- The iron must be used and rested on a stable surface.
- When placing the iron on its heel, ensure that the surface on which the heel is placed is stable.
- The iron is not to be used if it has been dropped, if there are visible signs of damage or it is leaking.
- The filling aperture must not be opened during use.

Using the iron for steam ironing

Make sure the iron is not plugged in. Set the steam switch (2) to 'O'. Fill the water tank (10).

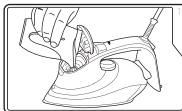

IN HARD WATER AREAS, WE RECOMMEND A MIX OF 50% TAP WATER AND 50% DISTILLED OR DEMINERALISED WATER. Never use battery topping up fluid or water containing any

substances like starch, sugar, fragrant additives or defrosted water from a refrigerator.

Plug in the iron and switch on. Set the temperature dial (8) to the temperature required (see 'Temperature Guide' on page 3). Begin with cool fabrics and work up to higher settings. An iron heats up quicker than it cools down so you will save time and energy. Your iron is fitted with a temperature indicator light (9) which will switch on and off whilst you are ironing.

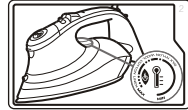

Vary the steam output using the steam switch (2). For optimum performance and energy savings, set to Eco steam setting, using the green line. Only use the steam facility on heavy fabrics (midway between 2 and 3-dot, to MAX).

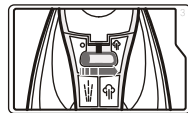

For stubborn creases, use the water spray button (4). You may need to press this a few times to prime the pump.



Steam boost Press

(3) for an extra steam boost for stubborn creases / heavy fabrics. NOTE: If you need to use the steam boost whilst dry ironing, check the temperature dial (8) is set within the steam range. OTE: For optimum steam quality, do not operate the shot more than three times in succession.

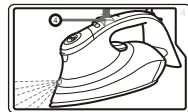

Know your iron:

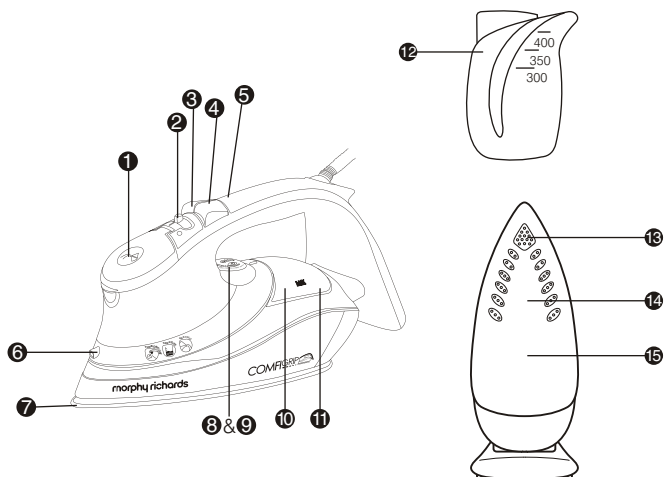





Features

1. Filling hole with cap
 2. Steam switch
 3. Steam boost button
 4. Water spray button
 5. Auto shut-off indicator
(certain models only)
 6. Spray nozzle
 7. Soleplate
 8. Temperature dial
 9. Temperature indicator light
 10. Water tank
 11. Life long anti-scale
(certain models only)
 12. Filling beaker
(certain models only)
- #### Tri-zone Soleplate
13. **Turbo Boost Powerful** boost of steam gets in the trickiest places
 14. **Constant Steam**
Removes all creases at a level you control
 15. **Press Plate** Removes moisture - to set a crease-free finish

Temperature guide:

Heat setting markings on the adjustable control dial of all Morphy Richards irons match those of the International Textile Care Labelling Code

Symbol	(120°C Max) Cool	(160°C Max) Warm	(210°C Max) Hot	MAX setting
				
Control knob positions	Do not iron ●	●●	●●●	
Fabric	Nylon, Acetates, synthetic fabrics	Wool, Polyester mixtures	Cotton, Linen Rayon, Rayon mixtures	
Ironing	Iron on reverse side, if moisture required, use damp cloth (not Acetate)		Fabrics requiring this setting usually require steam pressing.	
With water in tank	← Dry and spray →		← Steam/spray/shot of steam →	
Without water in tank	← Dry ironing →			

Before use:

Remove any protective sticker from the soleplate (7).

Features of your iron

Your iron can be used for dry ironing. Set the steam switch (2) to '0' and set the temperature dial (8) as desired (see page 3). You won't need water in the tank unless using the water spray or steam boost features.

Vertical steam

Vertical steam is useful for removing creases from hanging clothes, curtains, etc. Hold the iron between

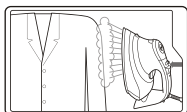

1cm and 2cm away from the item and press the steam boost button (3).

No drip system (certain models only)

This prevents water escaping from the soleplate (7) when the iron is too cold. During

use, the no drip system may emit a loud click, particularly during heat-up or whilst cooling down. This is perfectly normal and indicates that the system is functioning correctly.

Models without No drip system

Do not store the product with water in the tank as water may leak from the soleplate (7) if you forget to turn the steam switch (2) to '0'. Remember to only turn the steam switch (2) to steam when the control dial is set to a temperature within the steam range. Remember: the lower the temperature setting, the lower the steam setting.

Life long anti-scale system (certain models only)

This system reduces scale deposits and helps prolong the life of the iron. Auto shut-off (certain models only) The iron will automatically shut down if stationary in the

horizontal position for 1 minute, or the vertical position for 8 minutes.

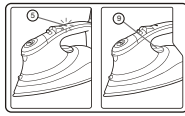

The auto shut-off indicator (5) will flash and an intermittent beep will be audible. Gently shake the iron to reactivate. The temperature indicator light (9) will come on. Wait for the iron to heat-up and continue ironing.

Maintenance

To clean a coated soleplate Do not use scouring powder or solution as this could cause damage to the coating. In the unlikely event of any man-made fibre fusing to the soleplate, set the iron at the MAX position and pass it over a clean piece of cotton which will draw the deposit off the surface. **IMPORTANT:** Do not descale the soleplate with descaling products, proprietary cleaning agents or vinegar when flushing out the soleplate. To clean the exterior Allow the iron to cool and wipe over with a damp cloth and mild detergent, then wipe with a dry cloth.

Important Safety Instructions

Location

- Do not use outdoors or near water.

Children

- Close supervision is necessary when any appliance is used near children.
- Children do not understand the dangers associated with operating electrical appliances.

Personal safety

WARNING: Burns can occur from touching hot metal parts, hot water or steam. Use

caution when you turn a steam iron upside down, there may be hot water in the water tank.

WARNING: To protect against the risk of electric shock, do not put the appliance in water or in any other liquid.

- Do not use the vertical steam feature on clothes that are being worn.
- Do not leave the iron unattended whilst plugged in or on an ironing board.
- Never allow the mains lead to over hang the work surface.
- The socket should always be off before plugging or unplugging from the socket. Never yank the cord to disconnect from the socket, instead, grasp the plug and pull to disconnect.
- Do not allow the cord to touch hot surfaces.
- Let the iron cool completely before putting away. Loop the cord loosely around the iron before storing.
- The iron must not be left unattended while it is connected to the supply mains.

Other safety considerations

- Use the iron only for its intended use.
- Always disconnect the iron from the electrical socket when filling with water or emptying, and when not in use.
- If the supply cord is damaged, it must be replaced by the manufacturer, its service agent or similarly qualified person(s) in order to avoid a hazard.
- Do not operate the iron with a damaged cord, or if the iron has been dropped or damaged and if there are visible signs of damage, or if it is leaking. To avoid the risk

of electric shock, do not disassemble the iron, but telephone Morphy Richards for advice. Incorrect reassembly can cause a risk of electric shock when the iron is used.

Special instructions

- If your iron does not work, check the following points:

Has the temperature control been set to the required temperature? Is the plug in its socket? Is the plug itself or the socket faulty? (Check by plugging in another appliance).

WARNING: When not in use, your iron should never be placed flat and left on an ironing board.

- To prevent damage to the textile being ironed, follow the temperature guide carefully. (Test the inside of the hem of the garment).
- When ironing is complete, remove the plug from the socket, empty any remaining water from the tank, and allow to cool before storage.
- If you drop or severely knock your iron, this could cause internal damage even if the outside appears alright. Have it checked by a qualified electrician.
- It is recommended that you use up one beaker of water by operating your iron's steam and steam boost functions before ironing any clothes as some dripping may occur while your iron's steam system is activated.

Electrical Requirements

Check that the voltage on the rating plate of your appliance corresponds with your house electricity supply which must be 230V A.C. (Alternating Current).

If the socket outlets in your home are not suitable for the plug supplied with this appliance, the plug should be removed and the appropriate one fitted.

WARNING: The plug removed from the mains lead, if severed, must be destroyed, as a plug with a bared flexible cord is hazardous if engaged into a live socket outlet.

WARNING: This appliance must be earthed.

Emptying and storing

When you have finished ironing, unplug and empty all water from your iron and set the steam switch at the

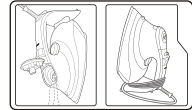

'O' position. When cool, store the iron on its heel with the cord wrapped loosely around the heel.

Technical Data

Power Supply : AC 240V ~ 50Hz

Wattage : 2200W

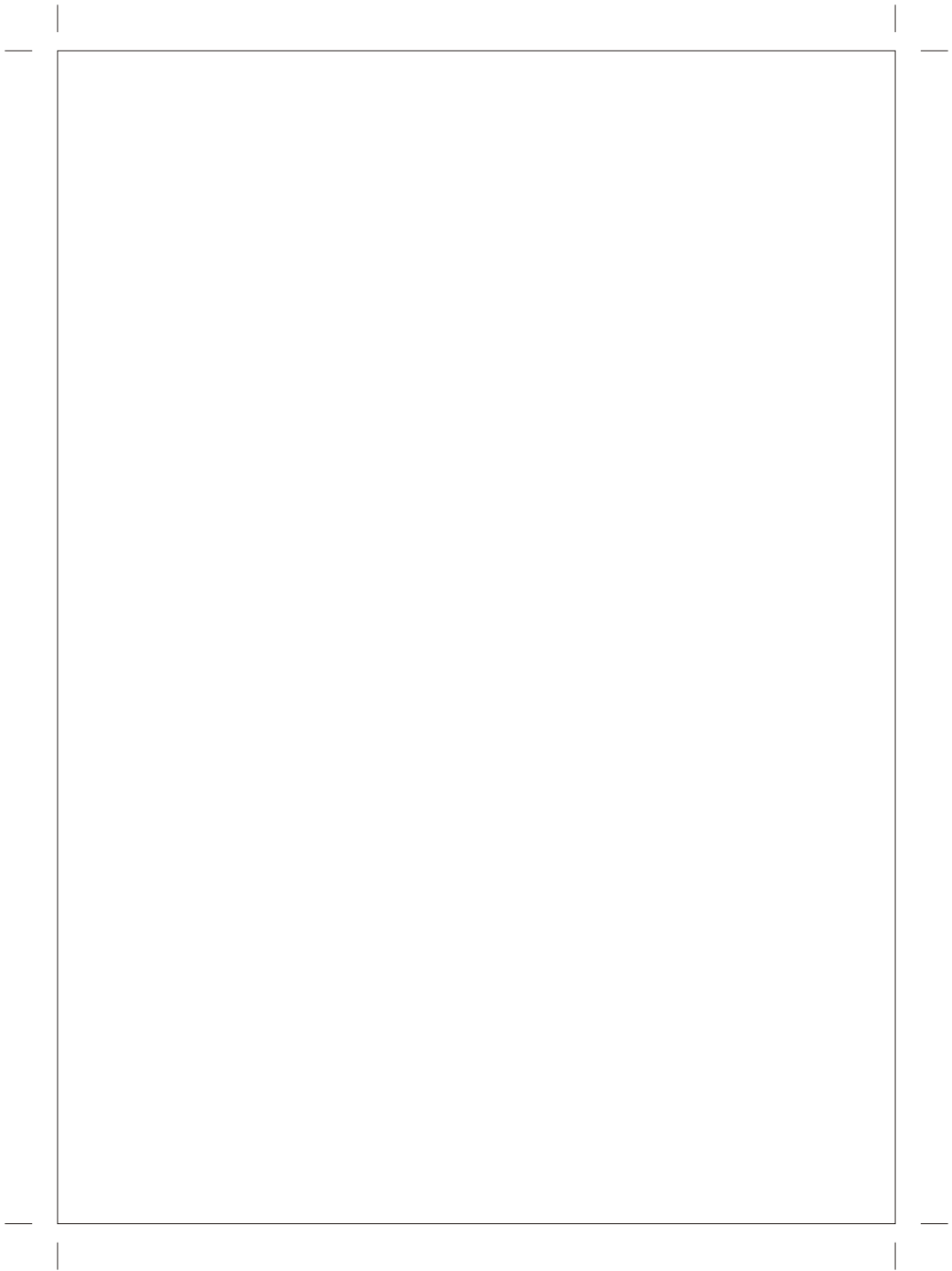

Morphy Richards products are intended for household use only

Morphy Richards has a policy of continuous improvement in product quality and design. The Company, therefore, reserves the right to change the specification of its models at any time.

Products & parts are indicative only, the actual product may differ.

morphy richards

Morphy Richards Ltd, Mexborough,
South Yorkshire, England, S64 8AJ