

**morphyrichards**

# Citrus juicer

## *Citrusmate*



Please read and keep these instructions

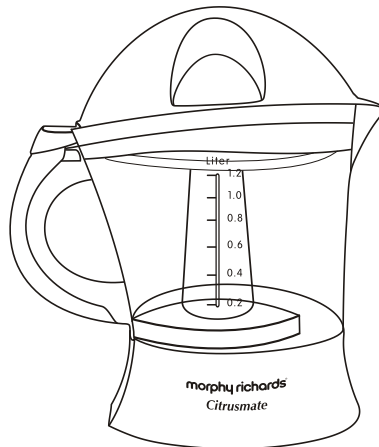

**2year**  
guarantee  
2 ans de garantie / 2 ans de garantie

**1.2 L**

Getting the best from your  
new citrus juicer...

[www.morphyrichards.co.uk](http://www.morphyrichards.co.uk)  
[www.morphyrichardsindia.com](http://www.morphyrichardsindia.com)

## BEFORE FIRST USE

Read and follow all the instructions in this "Use And Care" even if you feel you are familiar with the product, and find a place to keep it handy for future reference.

Your attention is drawn particularly to the sections concerning "IMPORTANT SAFEGUARDS" statements.

For your convenience record the complete

model number (located on the product identification plate) and the date you received the product, together with your purchase receipt and attach to the warranty and service information. Retain in the event that warranty service is required.

NOTE: The rating of this product (as marked on the product identification plate) is based on specific loading tests. Normal use or the use of other recommended attachments may draw significantly less power.

## Structure Illustration:

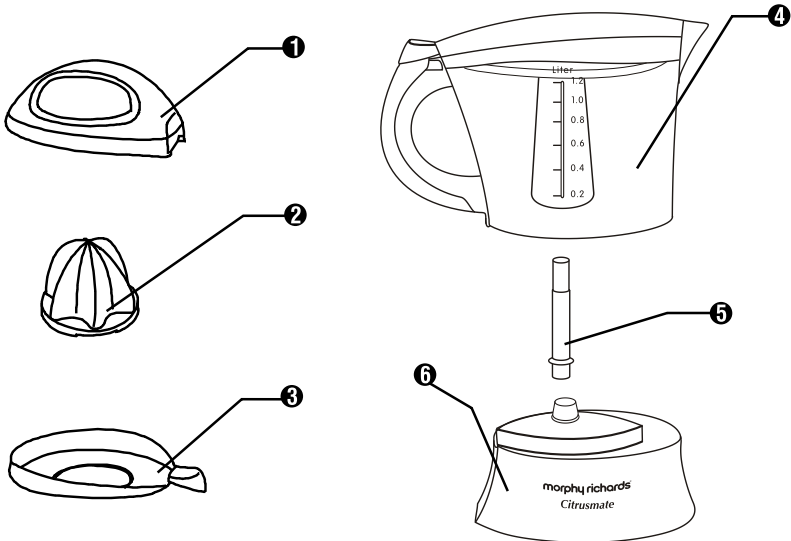

## Description:

- ❶ Dust lid
- ❷ Extractor
- ❸ Fix Filter
- ❹ Container
- ❺ Axis
- ❻ Body

## IMPORTANT SAFEGUARDS

When using any electrically powered product, basic safety precautions should always be followed, including the following:

PLEASE READ ALL INSTRUCTIONS CAREFULLY BEFORE USING THE PRODUCT.

WARNING - to reduce the risk of fire, electrical shock or injury to persons or property:

- Always operate the product from a power source of the same voltage, frequency and rating as indicated on the product identification plate.
- Close supervision is necessary when the product is used by or near children or invalids. Do not allow children to use it as a toy.
- Do not operate any product with a damaged cord or plug, or after the product malfunctions, or is dropped or appears damaged in any way. Return the complete product to the place of purchase for inspection, repair or replacement.
- Do not twist, kink or wrap the power cord around the appliance, as this may cause the insulation to weaken and split, particularly where it enters the unit.
- To reduce the risk of electric shock, do not immerse or expose the product or flexible cord to rain, moisture or any liquid other than those necessary for correct operation of the product.
- This product should not be used in the immediate vicinity of water, such as bathtub, washbowls, swimming pool etc. where the likelihood of immersion or splashing could occur.

- Never install the unit where it could be subject to:
  - Heat sources such as radiators, heat registers, stoves or other products that produce heat.
  - Direct sunlight
  - Excessive dust
  - Mechanical vibration or shock
  - Lack of ventilation, such as bookcase or cabinet
  - Uneven surface.
- Switch off and unplug from outlet when not in use, before assembling or before cleaning. Remove by grasping the plug - do not pull on the cord.
- Do not use the appliance for other than its intended use.
- The use of attachments or accessories not recommended or sold by the product distributor may cause personal or property hazards or injuries.

## Usage

- Unwind the power cord from the bottom of the juicer. Remove the dust lid and connect to power socket.
- Clean the citrus fruits. Halve them and press the fruit on the extractor. Make the extractor turn.
- To remove juice turn the power off. Hold the container handle and remove the filter. Lift the container and transfer the juice.
- This appliance has two extractors - suitable for small and big fruits.
- Do not put the whole or parts of body into water.

- If supply cord is damaged call the nearest morphy richards service center. Do not attempt to repair on your own.

## Clean and care

- While cleaning remove the filter first. Lift thontainer by rotating it to the right. Remove the axis and clean.

## Technical Data

Power Supply	: AC 230V 50Hz
Wattage	: 40W

*Morphy Richards products are intended for household use only*

*Morphy Richards has a policy of continuous improvement in product quality and design. The Company, therefore, reserves the right to change the specification of its models at any time.*

*Products & parts are indicative only, the actual product may differ.*

**morphy richards**

Morphy Richards Ltd, Mexborough,  
South Yorkshire, England, S64 8AJ