

## DYNASYST™ ORFITUBE™ ADJUSTER KIT

### A. GENERAL PRODUCT INFORMATION

The ORFITUBE ADJUSTER is a structural unit for placing onto a hand orthosis, in order to give the orthosis added adjustable and dynamic action. The dynamic orthosis can be defined as 'outrigger with rubber band' type.

The outrigger is adjustable, as biomechanical clues may change over time.

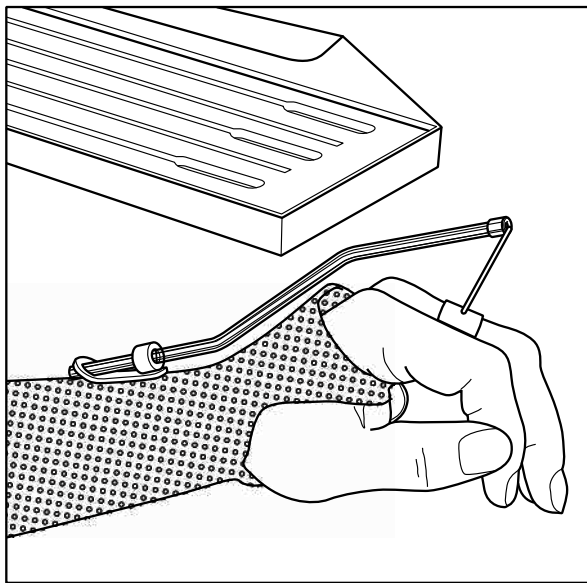

### B. PRODUCT SUMMARY

Art. N°	Description
35305	5x single ORFITUBE ADJUSTER
	5x ORFITUBE
	5x ORFITUBE END
	1x bending rod
	1x ORFITUBE ADJUSTER - SET INSTRUCTIONS FOR USE
	1x allen wrench

### SINGLE ORFITUBE ADJUSTER:

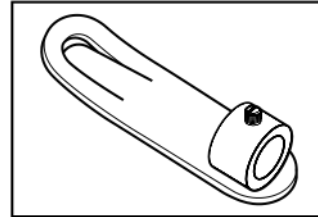

Adjusting screw (stainless steel): Secures the position of the ORFITUBE in the adjusting ring.

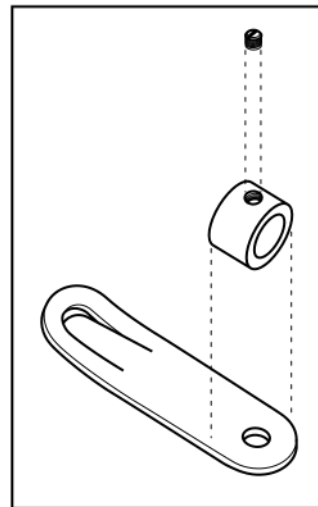

Adjusting ring (Polyacetal): Holds and allows alterations of the ORFITUBE.

Fixation plate (ORFIT): fastens and stabilises the ADJUSTER to an orthosis.

### ORFITUBE™:

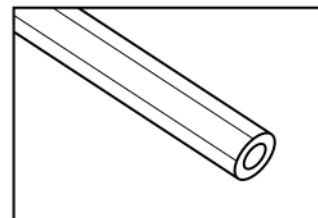

Tube (polycarbonate) into which a braided elastic or extension spring is introduced, provides a spatial suspension point for the finger.

### TUBE END:

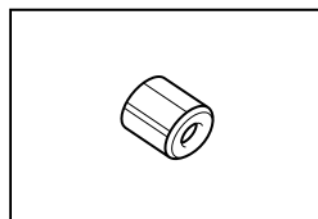

Metal cap (nickel-coated brass) with rounded edges, to reduce friction of the elastic.

### Bending thread:

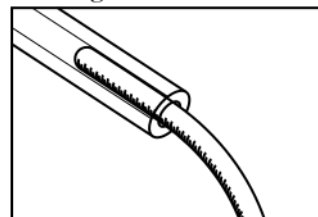

Synthetic thread used to prevent kinks from arising when the ORFITUBE is shaped.

### C. APPLICATION TECHNIQUE

1. Put a basic orthosis on the patient.

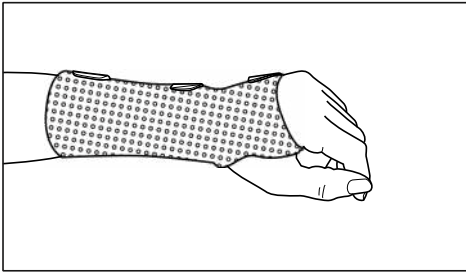

2. Determine in which plane the suspension point needs to be adjustable (A).

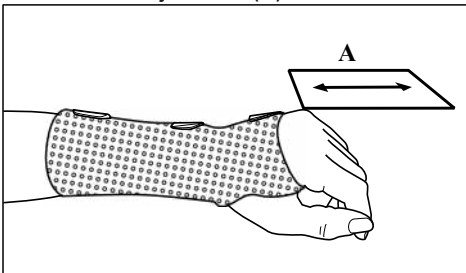

3. Find a location on the orthosis that is  $\pm$  parallel to this plane (A').

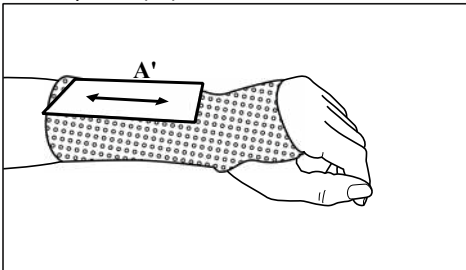

4. Feed the ORFITUBE through the ADJUSTER over the anticipated setting distance and fasten the screw of the adjusting ring.

5. If the ORFITUBE fits the orthosis without bending, then continue with item 10.

6. In order to bend the ORFITUBE, first introduce the bending rod till beyond the adjusting ring.

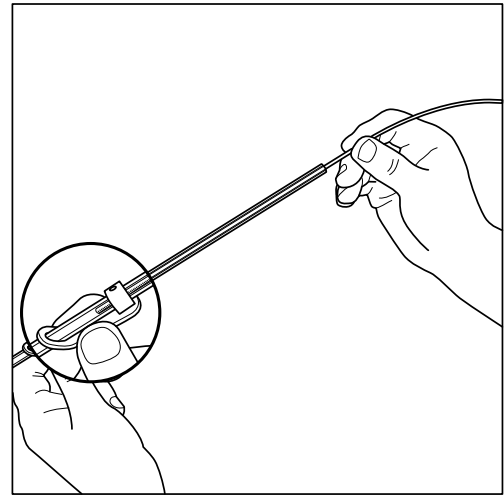

7. Bend the ORFITUBE to the desired angle.

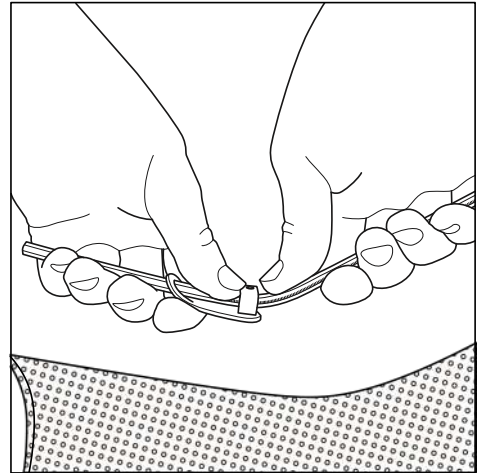

8. Remove the bending rod from the angle and if necessary make additional bends to end up in the adjusting plane again.

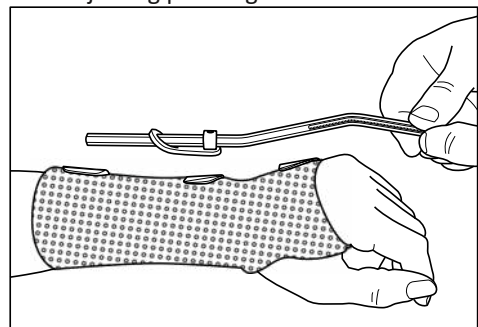

9. Completely remove the bending rod from the tube.

10. Now slide the ORFITUBE into the ADJUSTER up to its most distal position.

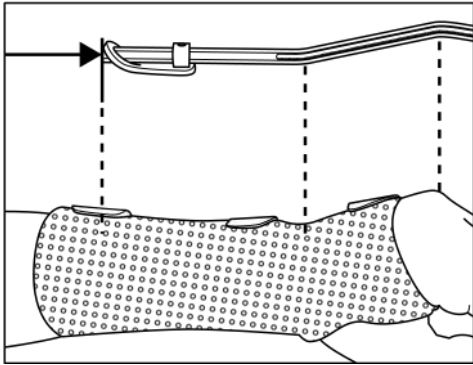

11. For a few seconds, heat the underneath of the ORFITUBE ADJUSTER as well as the attachment location on the orthosis with a heat gun (be careful for overheating).

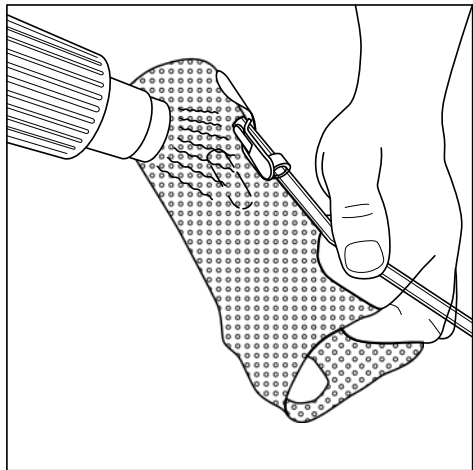

12. Firmly press the ADJUSTER onto the orthosis in the desired position and allow it to cool down completely.

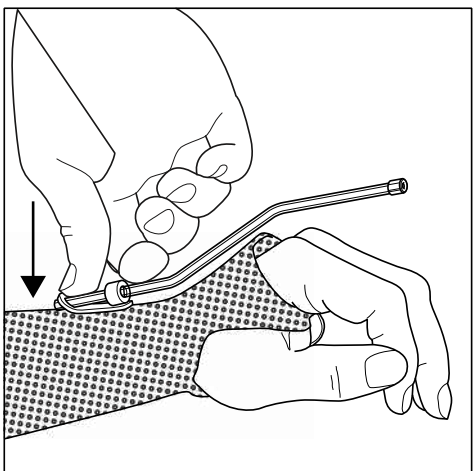

Note:

After heating, the ADJUSTER can be adhered to the following orthotic fabrication materials:

A: All Orfit splinting material, in case of an NS product scratch the surface with scissors to ensure adhesion

B: it is possible to attach the ORFITUBE ADJUSTER onto other, non-adherent orthotic fabrication materials, by using suitable adhesives

D: In some cases, it may be possible to detach the adjusting ring and screw it directly to the orthosis.

13. Cut the ORFITUBE to length using heavy scissors (or by incision and breaking).

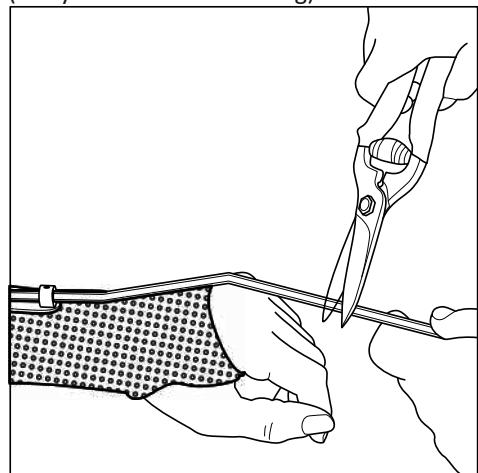

Press the TUBE END firmly onto the ORFITUBE.

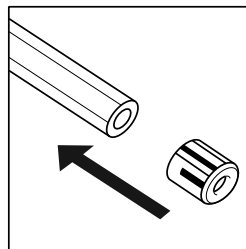

14. Introduce a braided elastic (ref. 35312 - 35313 - 35314) equipped with a finger cuff.

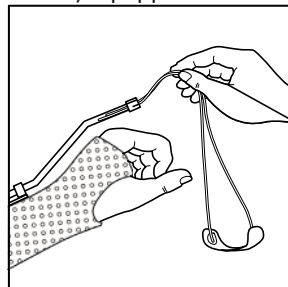

15. Give the required tension to the elastic.

#### D. ADJUSTING THE ORFITUBE

As it should remain possible to vary the elastic's suspension point during the course of rehabilitation, the ORFITUBE can be accurately adjusted.

By loosening the adjusting screw, the ORFITUBE can be rotated and/or translated.

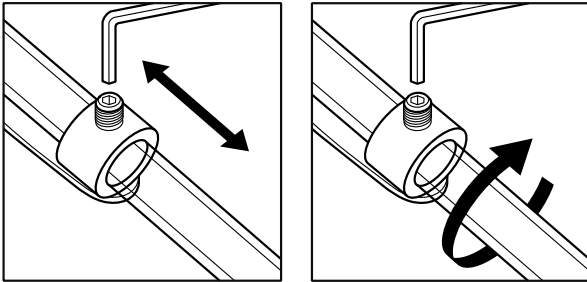

#### E. MAINTENANCE

The ORFITUBE ADJUSTER does not require maintenance. It can be cleaned with lukewarm water and soap.

It is not possible to sterilize an ORFITUBE ADJUSTER in

an autoclave, although it can be sterilized using gas sterilization. It can be disinfected using alcohol.

#### F. WARNINGS

Draw patients' attention to possible consequences of the incorrect action of dynamic orthoses.

- accidental modification of the ORFITUBE set-up.
- fixation plate or tube-end loosening.

Do not use an open flame to heat the ADJUSTER fixation plate.

Only trained medical personnel should make and apply dynamic orthosis using the ORFITUBE ADJUSTER.

#### G. STORAGE TEMPERATURE

Store at

minimum temperature +10°C / +50°F

maximum temperature +30°C / +95°F

#### Note:

It is prohibited to make alterations to this text without prior approval from Orfit Industries. DYNASYST™ and ORFITUBE™ ADJUSTER KIT are trademarks from ORFIT INDUSTRIES N.V.



**ORFIT INDUSTRIES**  
Vosveld 9A | B-2110 Wijnegem | Belgium  
T (+32) (0)3 326 20 26  
welcome@orfit.com

[www.orfit.com](http://www.orfit.com)



Ref. No. 31201  
VERSION 6  
LAST UPDATE: 05/05/2021  
REVISION DATE: 05/05/2023