

M9000

Complete extended accessories to be used with WC for handicapped

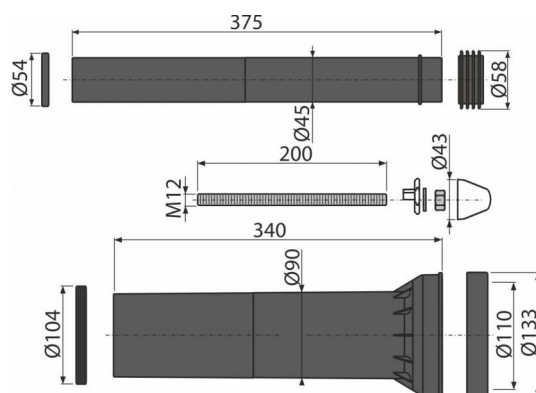
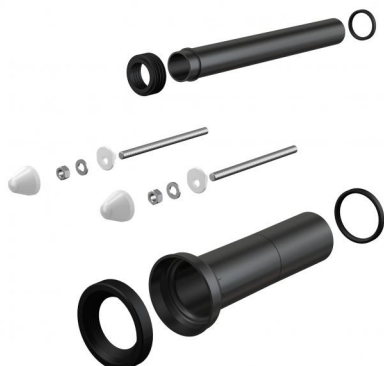

Application

For connecting water and waste to the WC, extended
For pre-wall installation systems

Features

- Material: polypropylene, galvanized

Scope of supply

- Fixation material for fixing the WC pan: threaded rod M12 – 2 pcs, washers – 4 pcs, cover – 2 pcs, nut – 2 pcs, thread protector – 2 pcs
- Direct socket for connecting a wall-hung WC bowl to the waste pipe, polypropylene, Ø90 mm, including seals
- Jumper for connection of wall-hung WC pan to the water supply from the cistern, polypropylene, Ø45 mm, including seals and wrapping seal

Order number, Logistic information

Code	EAN	Weight (piece packing palett)	Dimensions (piece packing)	Quantity (packing palett)
M9000	8595580503963	1,0320 9,7000 155,2000 kg	340x133x133 590x430x390 mm	10 160 pcs
Guarantee 2/2 years	Customs code 39174000	Norms EN 476, EN 12056-5		