

Dimensions

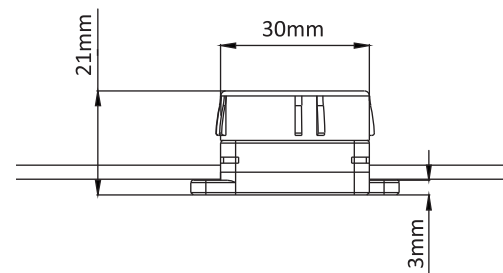
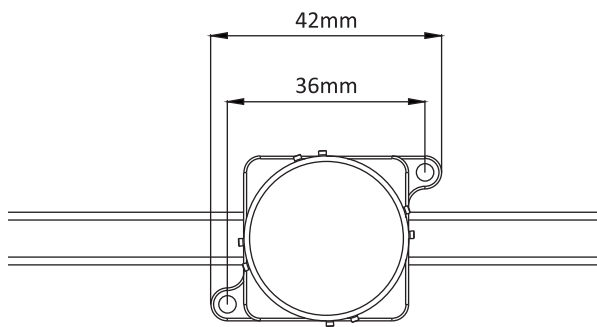

Specifications

Model Number	FD89500	FD89510	FD89520
Input Voltage		DC24V	
Power per Dot	1.2W	1.2W	1.5W
LED Quantity per Dot		8pcs	
LED Type		SMD LED	
Light Output Angle		120°	
Color Temperature	2700K, 3000K, 4000K, 5700K, 6500K	RGB 3-in-1	RGBW 4-in-1
Operation Temperature		-30°C~60°C	
Storage Temperature		-40°C~80°C	
Waterproof Level		IP67	
Wiring	Waterproof multi-core cable and connector		
Housing Material		PC (Polycarbonate)	
Finishing Color		Black / White	
Mounting		Surface mount	
Lense		Clear	
Pitch between Units	150mm, 200mm, 250mm, 300mm and other customized pitch		
Pixel Quantity	1 pixel per fixture (1 channel per pixel)	1 pixel per fixture (3 channels per pixel)	1 pixel per fixture (4 channels per pixel)
Control Signal		DMX512	
Addressing Options		Manual addressing	

Configuration

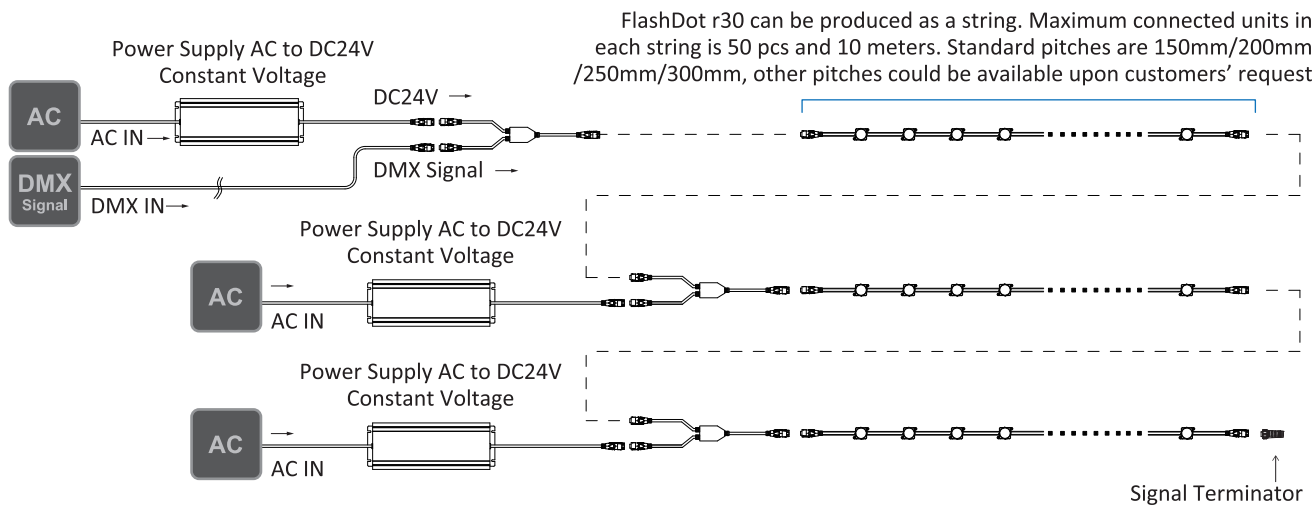



-  1. Maximum lighting fixture’s power core connection between FlassDot r30 is 50 pcs and 10 meters. Any power core connection exceed 50 pcs 10 meters will cause product failure and void the warranty.
2. A specific Y-connector is needed for re-connecting new DC power source back to the loop.
3. A signal terminator must be applied at the end of DMX512 loop for signal stabilization.
4. A standard DMX512 signal supports maximum 32 devices and 512 addresses in one signal loop. Extra DMX512 signal, repeater, splitter may be needed to keep the signal stable when user is constructing a large scale of DMX512 system.
5. In one DMX512 loop, distance from DMX512 signal source output point to the last lighting fixture signal terminator should not exceed 80 meters. Extra DMX512 signal, repeater, splitter may be needed to strengthen the signal for long transmission distance.
6. Distance between lighting fixtures and DC power source is a critical issue, please control the distance and wiring system carefully to avoid voltage drop. Voltage drop may cause product failure and void the warranty.
7. If there is any uncertainty, please contact kalar@iotena.com for further information.

Part Number

FD89500 - P ____ - C ____ - F ____

 To Define Pixel Picth
P 1 5 0 = 150mm L ____ = For Customized Pixel Picth
P 2 0 0 = 200mm
P 2 5 0 = 250mm
P 3 0 0 = 300mm

 To Define Color Temperature
C 2 7 = 2700K C 6 5 = 6500K
C 3 0 = 3000K
C 4 0 = 4000K
C 5 7 = 5700K

 To Define Finishing Color
F B L K = Black
F W H I = White

FD89510 / FD89520 - P ____ - F ____

 To Define Pixel Picth
P 1 5 0 = 150mm L ____ = For Customized Pixel Picth
P 2 0 0 = 200mm
P 2 5 0 = 250mm
P 3 0 0 = 300mm

 To Define Finishing Color
F B L K = Black
F W H I = White