Continuous Flow Through (CFT) Vermicomposting System



OPERATING INSTRUCTIONS & USER MANUAL

Contents

- Safety 3
- Introduction and product overview 4
- In the box: 4
- Assembly instructions..... 5
- Positioning and Operation 6
- Maintenance 6
- Warranty 7
- Troubleshooting 7
- Customer support..... 7
- Product Specifications 7

⚠ CAUTION

- Thoroughly read and understand the information in this product manual before attempting to use this product. If the procedures and instructions in this product manual are not followed, injury could occur.
- To prevent injury:
 - Do not run the red blade position indicators past the marked STOP lines located on either end of the bin.
 - Keep hands and objects clear of the harvesting mechanism during operation.
 - Do not operate the bin on uneven or unstable surfaces.
- The VermiFlow is designed and intended to be used only for its specified purpose as described in the product documentation. Any use of the product outside of its intended purpose may result in damage to property or injury to individuals, and the manufacturer will not be held liable for such incidents. It is the responsibility of the user to ensure that the product is used only as intended and in accordance with the instructions provided.

Introduction and product overview

The Hiwassee Products VermiFlow is a Continuous Flow Through (CFT) vermicomposting system (compost and worms not included). The bin holds 14 cubic feet of compost. Finished vermicompost is harvested from the bottom of the bin using a blade powered by a cordless screwdriver (not included).

In the boxes:

Components		Quantity	Part number	
BOX 1	Harvesting bins	2	TR65	
	Grate assembly	1	LA12	
	28" x 24" paper	2	TY89	
	HARDWARE BOX	Leveling feet	4	JO85
		5/16-18 x 3/4" stainless steel bolts	20	PK55
		5/16-18 x 2 1/4" stainless steel bolts	4	NQ42
		5/16 stainless steel washers	24	CR89
		3/4" hex driver	1	XI59
3/16" hex key assembly tool	1	AD51		
Product Manual	1	CB38		
BOX 2	End panels	2	MN34	
	Side panels	2	SN47	
	Lid	1	JD91	

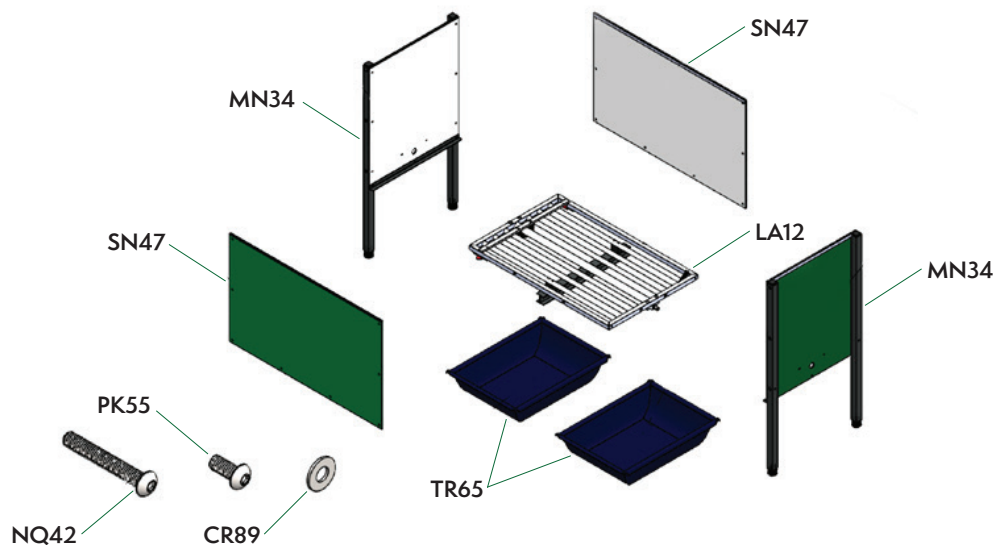

Assembly instructions



See the assembly video here:
hiwasseeproducts.com/products/vermiflow-cft

STEP 1:

Remove all components from the boxes.

Note: A separate box containing hardware, leveling feet, product manual and assembly tool is included within BOX 1.

STEP 2:

Figure 1: Thread the four JO85 leveling feet (A) into the legs, all the way up to the locking nut.

STEP 3:

Figure 2:

1. Place the LA12 grate (D) on its side with a piece of cardboard (included in BOX 2) underneath to protect the red blade indicators (B).
2. Attach one MN34 end panel (C) to the grate (D), green side out, using two 2 ¼" bolts (E) and two ¾" bolts (F) with four washers.
3. Thread the bolts in loosely to secure the panel in place before tightening them using the 3/16" hex key provided.
4. Repeat these steps on the other end.

STEP 4:

Figure 3: Fasten the SN47 side panels to the assembly using the 16 remaining bolts and washers. Start with the bolts at the top corners (G). Thread the bolts in loosely to secure the panel in place before tightening them using the 3/16" hex key provided. The bolts should be tight but not so tight as to indent the surface of the panel.

Figure 4: Slide the two TR65 harvesting bins into the slots under the VermiFlow. Place the paper across the grate, and put the lid in place.

Level the bin by adjusting the four leveling feet using a 9/16" wrench (not included).

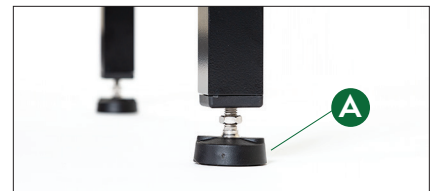

Figure 1

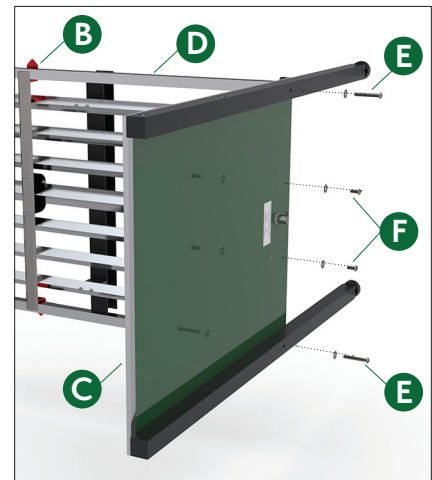

Figure 2

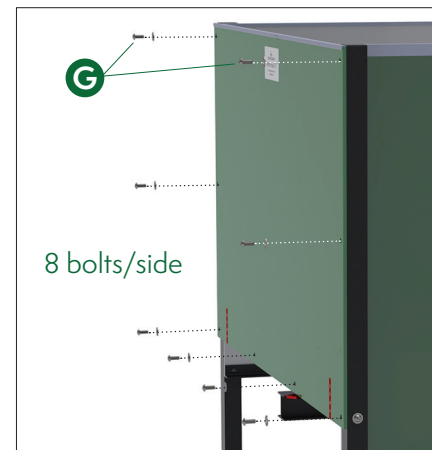

Figure 3



Figure 4

Positioning and Operation

Positioning

Position the VermiFlow in such a way that the harvesting bins can easily be removed, and you can access at least one end of the bin to attach a cordless screwdriver for harvesting.

Operation

Figure 5: To operate the harvesting blade, attach a cordless screwdriver to one of the hex heads on either end of the acme screw using the supplied 3/4" hex drive. Run the knife blade to the far end of the bin until the blade indicator reaches the STOP label, reverse direction and return the blade to the other STOP label. Ensure that two harvesting totes are centered underneath the bin before beginning to harvest.

The lid hangs on the side of the bin when not in use.

NOTICE To avoid damaging the blade, never put rocks, sticks or other large objects into the vermicompost bin.

See the included “For Best Results” document for other vermicomposting tips.



See the document here:

hiwasseeproducts.com/pages/for-best-results-vermiflow

Maintenance

Figure 6: Lubricate the acme screw twice monthly or as necessary to prevent rust and reduce friction. Remove the bins to access the acme screw. Lubricant should also be added to the screw and drive points at both ends. We recommend using a standard grease and lubricant product such as White Lithium Grease, preferably aerosol grease products.



Figure 5

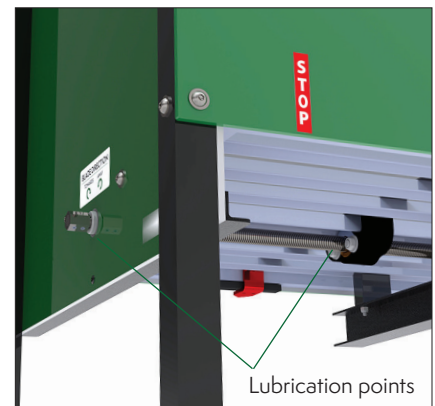

Figure 6



Warranty



See *Hiwasee Products Standard Terms and Conditions Governing the Sale of Products* website for warranty information.

hiwaseeproducts.com/pages/terms-conditions

Troubleshooting Figure 7

Potential problems	Solution
The cordless screwdriver is not able to drive the harvesting blade.	Heavily lubricate the acme screw (A) and let it sit for 5 minutes before trying again (see Figure 6).
	Reverse the direction of the cordless screwdriver a few times. This will aid in freeing up a possible jam in the harvesting blade caused by a larger input material.
The lid does not fit after the bin is assembled.	Uneven surfaces may cause the bin to be out of square. Adjust the leveling feet (B) to square the top of the bin until the lid fits.

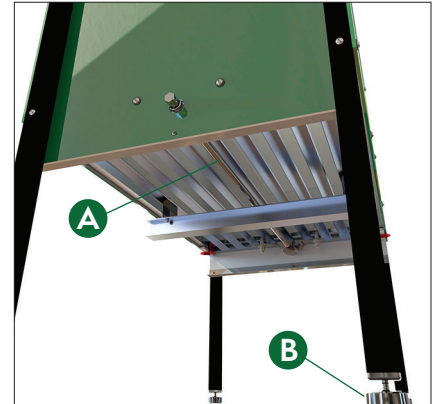

Figure 7

Customer Support:

Phone: (423) 436-0502

Email: info@hiwaseeproducts.com

Product Specifications

- Capacity: 14 cubic feet of compost
- Weight (empty): 90 lbs
- Bin inside dimensions: L 40" x W 25½" x H 25½"
- Outside dimensions: L 43.5" x W 26" x H 46.5"

