

## Wearing and Using of the Hearing amplifier



Before wearing a hearing amplifier, please clean the ear canal, Gently buckle the ear cap direction of the hearing amplifier into the ear canal

After wearing, it can be rotated to adjust and fit into a comfortable position in the ear canal and keep it stable

Program files	Input mode, function features
Program 1 (P1)	Full frequency amplification, too nice
Program 2(P2)	Medium and high frequency amplification too twice
Program 3(P3)	Medium frequency amplification, too three times
Program 4(P4)	Medium and low frequency amplification too four times

## Application Connection Description

1.Download the APP 2.Connection between APP and hearing amplifier

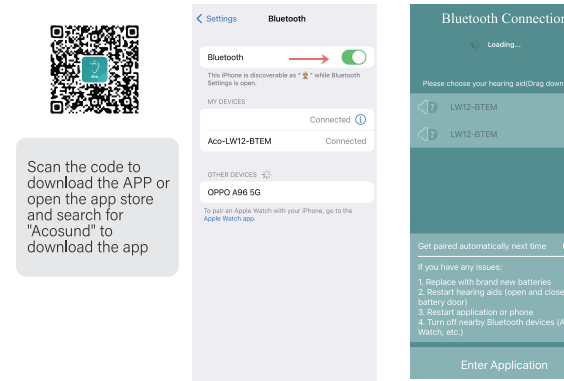

Scan the code to download the APP or open the app store and search for "Acosund" to download the app

Turn on Bluetooth in Settings

Open APP and pull to refresh - Searching surrounding hearing amplifier

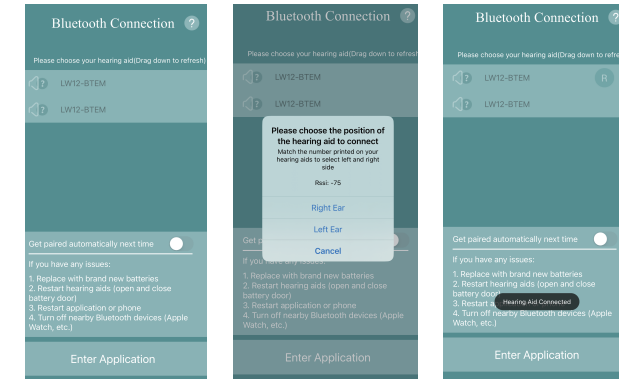

Click connect with hearing amplifier

Select left ear /right ear

click "Start Listening" to enter the adjustment interface

3.Adjust the program and the volume to comfortably suit your own hearing

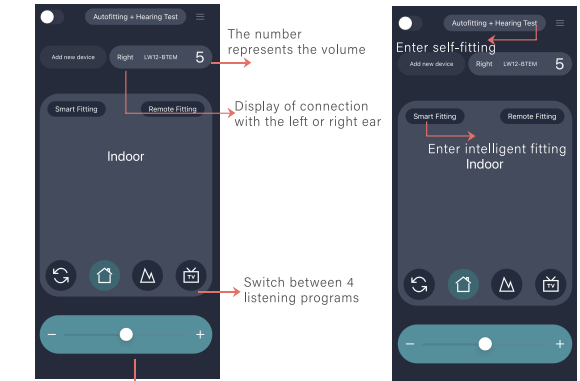

Adjust for the appropriate volume, the maximum or minimum volume will trigger prompt tone)

4. Self-fitting/ Intelligent fitting Suitable to use hearing amplifier after hearing test

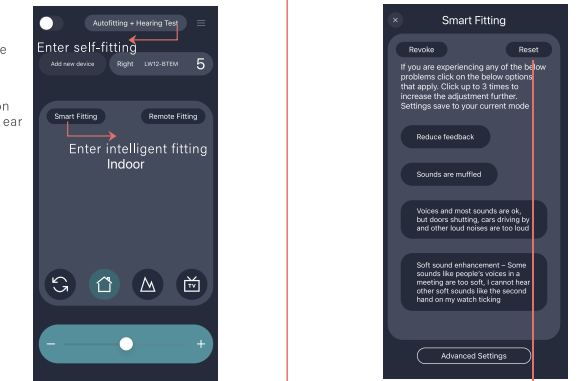

Click reset button to clear the previous fitting modification

self-fitting interface (Wearing hearing amplifier to do the hearing test, only need one click to get all the fitting parameter)

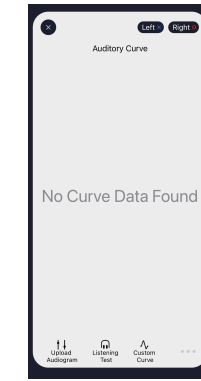

Click hearing test



Prepare to test hearing



Hear the sound then click

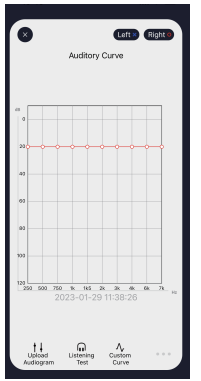

Get the hearing curve

Intelligent fitting interface (Wearing a hearing amplifier, the following problems can be solved with intelligent fitting) Note: At present, the Bluetooth function of hearing amplifier only supports the operation of hearing test, fitting and adjustment, does not support phone calls, audio listening, etc.



Parameter configuration of hearing amplifier

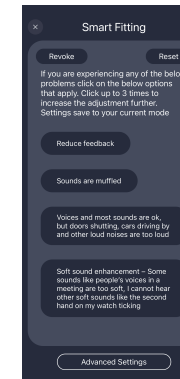

Problems selection

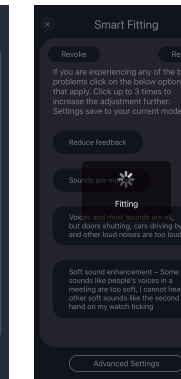

Save data

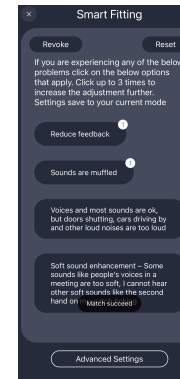

Fitting successfully

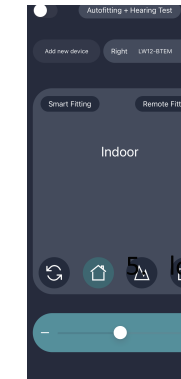

Click "x" to exit and save the data

6. Remote fitting, add new device and logou

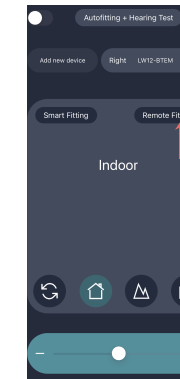

Click: "Remote fitting"

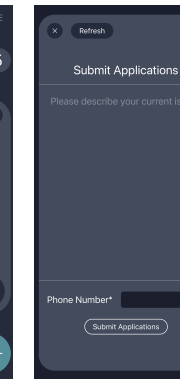

Describe and submit the problem

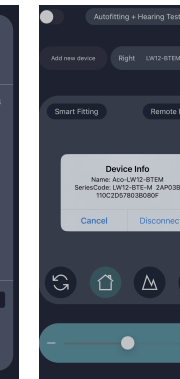

logout

Note: Add New Device - Adjust the connection with new device  
Log Out - Log out the old device  
"About the device/hearing curve/professional fitting" - Only for professional adjustment, please consult customer service staff for details.

If the intelligent fitting does not solve the problem,  
please contact the optometrist  
We will provide personal professional remote fitting

Applicable to AcoSound Sonar series hearing amplifier



AcoSound SonarMax Hearing Amplifier  
《User Manual》