

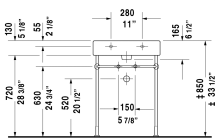

Vero Furniture washbasin # 0454600000 / 0454600087

< 23 5/8" Inch >

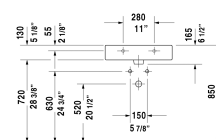
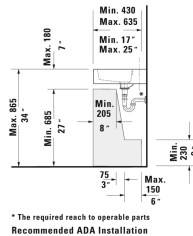
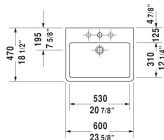

Furniture washbasin	Dimension	Weight	Order number
with faucet deck, underside fully glazed, hardware included, wall-mounted, cUPC® listed*, 23 5/8" Inch			
Colors			
00 White			
Variant			
● with overflow	23 5/8" x 18 1/4" Inch	39.5 lb	0454600000
●●● with overflow	23 5/8" x 18 1/4" Inch	39.5 lb	0454600087
Infobox			
* Complies with following standards: ASME A112.19.2/CSA B45.1, Washbasin is not ADA compliant in combination with pedestal, siphon cover or metal console			
Sanitary ceramics with the special WonderGliss surface finish will remain clean and attractive-looking for a long time to come. When ordering WonderGliss please add a "1" as eleventh digit to the model number.			
Accessory for ceramics			
Push button drain assembly for washbasins with overflow	2" Inch	0.8 lb	005052
Towel rail square tube 1/2", Chrome, for washbasin # 045460, 235060, 235360, 235660, 236860	21 5/8" Inch	0.8 lb	003037
Design Siphon		3.3 lb	005036
Suitable products			
Metal console height adjustable +2", for washbasin # 045460, 235060,			003063

Vero Furniture washbasin  # 0454600000 / 0454600087

| < 23 5/8" Inch > |

Vanity unit wall-mounted 1 pull-out compartment, for Vero # 045460, 21 5/8" x 17 3/8" Inch	21 5/8" x 17 3/8" Inch	KT6686
Vanity unit wall-mounted 2 drawers, upper drawer including cut-out for siphon and siphon cover, for Vero # 045460, 21 5/8" x 17 3/8" Inch	21 5/8" x 17 3/8" Inch	KT6636
Vanity unit wall-mounted 1 pull-out compartment, with compartment inserts that consist of glass dividers and 2 boxes (small/large), for Vero # 045460, 21 5/8" x 17 1/2" Inch	21 5/8" x 17 1/2" Inch	XL6044
Vanity unit wall-mounted 2 drawers, upper drawer including cut-out for siphon and siphon cover, for Vero # 045460, 21 5/8" x 17 1/2" Inch	21 5/8" x 17 1/2" Inch	XL6344

All drawings contain the necessary measurements which are subject to standard tolerances. They are stated in inch & mm and are non-binding. Exact measurements, in particular for customized installation scenarios, can only be taken from the finished ceramic piece.