

# MS854114E(G) & MS854114EL(G)

MS854114E(G)  
CST854E(G)  
CST854E(G)T

MS854114EL(G)  
CST854EL(G)  
CST854EL(G)T

**Eco Ultramax®**  
**1.28 Gpf Toilet, Elongated,**  
**E-Max®, 12" Rough-In,**  
**(including ADA, CeFIONtect™)**

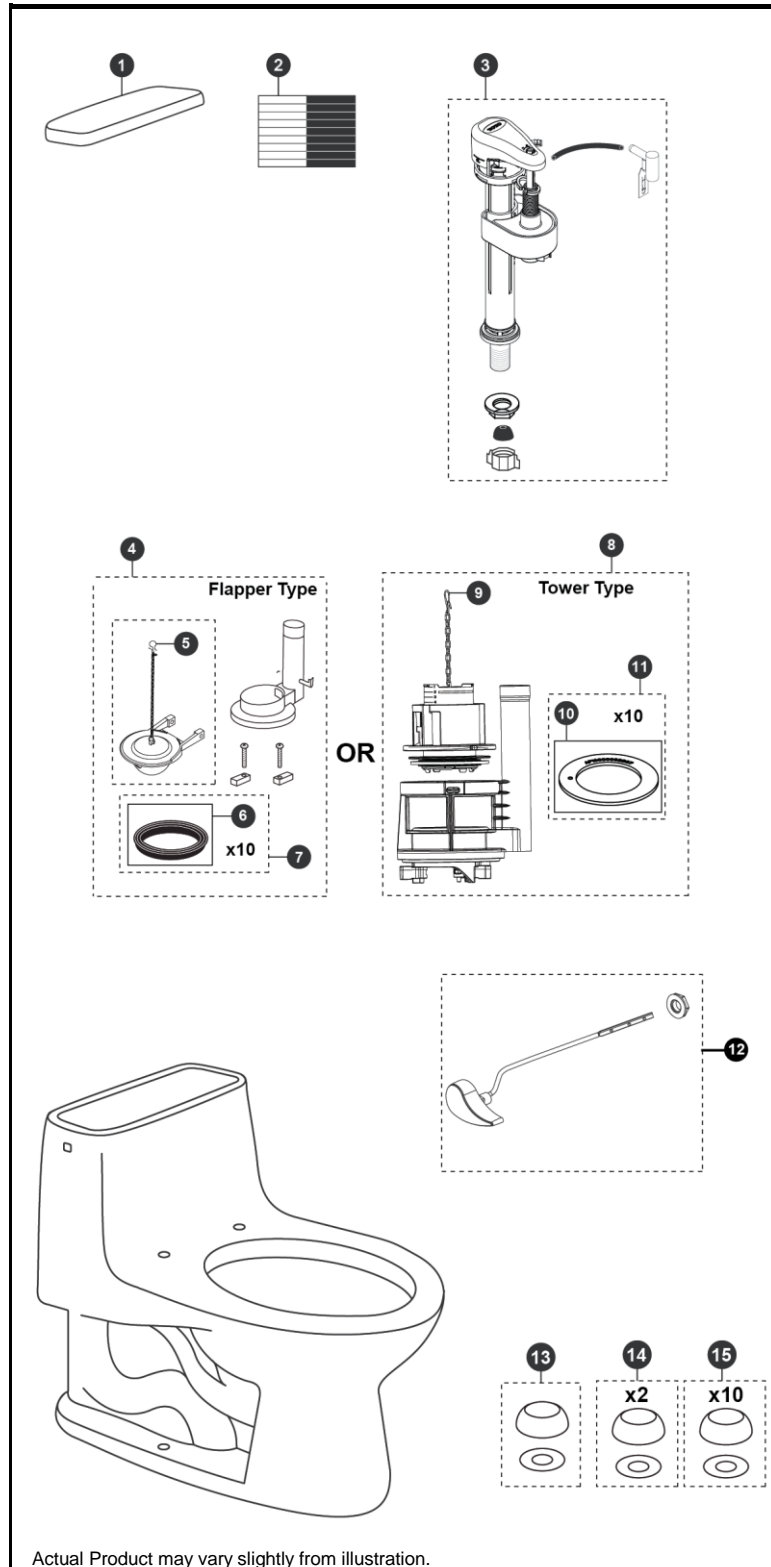

Item	Part	Description
1	TCU854CRE#01	Tank Lid w/ Velcro Tape
	TCU854CRE#03	Tank Lid w/ Velcro Tape
	TCU854CRE#11	Tank Lid w/ Velcro Tape
	TCU854CRE#12	Tank Lid w/ Velcro Tape
	TCU854CRE#51	Tank Lid w/ Velcro Tape
2	THU107	Velcro Tape
3	TSU51A	Fill Valve
4	THU251P	Flush Valve Assembly w/ Flapper
5	THU500S	Flapper w/ Chain
6	9BU002E	Flush Valve Gasket
7	THU097	Flush Valve Gasket (10 pieces)
8	THU453.10C-A	Drain Valve
9	THU440-A	Flush Tower
10	THU407	Seal Gasket (1 piece)
11	THU370	Seal Gasket (10 piece)
12	THU004#01	Trip Lever
	THU004#03	Trip Lever
	THU004#11	Trip Lever
	THU004#12	Trip Lever
	THU004#51	Trip Lever
	THU004#CP	Trip Lever - Chrome Plated
13	THU044#01	Bolt Cap Set - Cotton (1 set)
	THU044#03	Bolt Cap Set - Bone (1 set)
	THU044#11	Bolt Cap Set - Colonial White (1 set)
	THU044#12	Bolt Cap - Sedona Beige
14	THU044S#01	Bolt Cap Set (2 pieces)
	THU044S#03	Bolt Cap Set (2 pieces)
	THU044S#11	Bolt Cap Set (2 pieces)
	THU044S#12	Bolt Cap Set (2 pieces)
	THU044S#51	Bolt Cap Set 2 pieces)
15	THU098#01	Bolt Cap & Base (20 pieces)
	THU098#03	Bolt Cap & Base (20 pieces)
	THU098#11	Bolt Cap & Base (20 pieces)
	THU098#12	Bolt Cap & Base (20 pieces)
	THU098#51	Bolt Cap & Base (20 pieces)

**Note:**

## Product Number Explanations

### One-Piece Toilet

(MS) Toilet & Seat Combination  
(CST) Gravity Type Toilet  
(854) Toilet Model  
(114) Seat Model  
(E) E-Max®  
(L) ADA Compliant  
(G) CeFIONtect™  
(T) Drain Valve Tower

### Colors

(#01) Cotton  
(#03) Bone  
(#11) Colonial White  
(#12) Sedona Beige  
(#51) Ebony