

# Placement Information

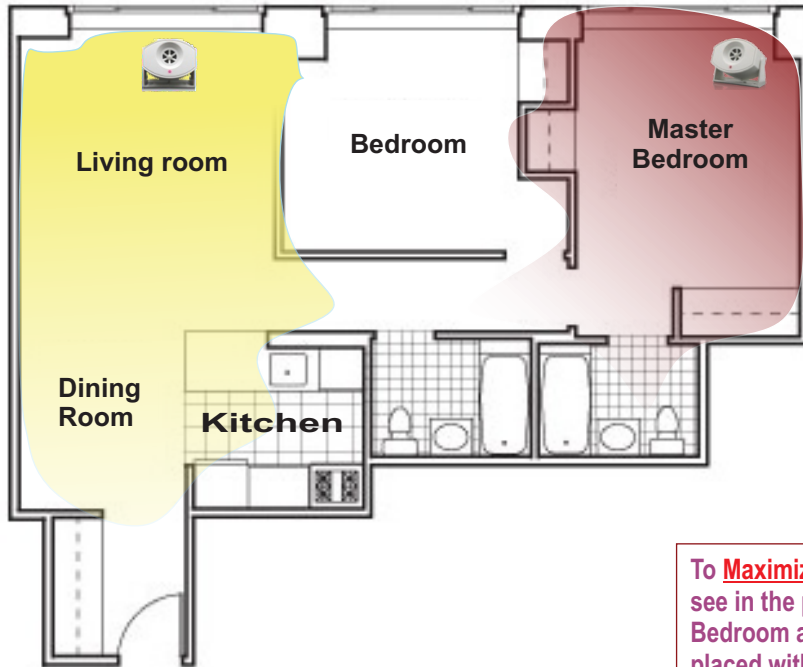

## Example #1: Open Indoor Area Coverage



The EZ-Mount has the ability to Cover up to 5000 Square Feet "Open Area". When placed in confined rooms that content with walls, doors and ceilings the repelling sounds Now Become Less Intense as they encounter these structures.

Now this does not mean one EZ-Mount will not cover your whole home. To start the best thing to do is get your EZ-Mount place in the room that you know is closest to the Rodent Issue.

(facing the most open area of that room)

Allow A Good 14 Days Worth of Repelling. Then at the 14 day mark clean up any signs of dropping/activity and now use this day as your mark. If there is still activity then its Time To Contact Us So We May Help.

To **Maximize Repelling Power** you can see in the picture to the left that the **Master Bedroom and Living Room** have an EZ-Mount placed within them. This **Creates a Surround Sound Worth Of Repelling.**



In this second example, the problem area is located outside the Kitchen. Although the unit outside of the Kitchen almost entirely covers the length of the wall, another EZ-Mount has been placed at the far corner to create an overlapping surround-sound effect along the outside wall. If the issue is not severe, a single unit at one corner may be enough to cover your needs.

To fully maximize the effectiveness of the Cleanrth EZ-Mount device:

Please Remember that the EZ-Mount is not Water Proof, Water Resistant to a Point But Not Water Proof. Please do your Best to Shelter your EZ-Mount when using Outdoors.

- 1) Run 24-hours a day, 7 days a week. This is a low-power consumption device that costs less than 1 ½ cents per day to operate.
- 2) Place your device on a hard surface as carpet and other soft surfaces may absorb the signal.
- 3) Walls also reduce the range of the signal; for best results, place one EZ-Mount in each troubled area.

**REMEMBER: Repelling Power / Sound, Time Repelling and Repelling Change is what Drives Rodents Out and Away**

If your Rodent Problem still persists after the 16-20 day mark. Please Contact us as we will Move to a Stage 2 worth of Help/Repelling

If Ordered Online, it's "**BEST**" to Contact Us via the website you ordered from (e.g., Amazon, Walmart, eBay, etc.) or E-mail: [info@cleanrth.com](mailto:info@cleanrth.com) or Phone: 480-255-5113