

Warning!

DO NOT sanitize the parts in the microwave!



Clean

10 Min.



Dishwasher Safe

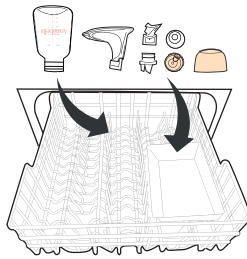

Important notice: the silicone and plastic parts have an expiration date and should be maintained and replaced approximately **every 3 months**.

Which parts should I sanitize?

Below is a list of the parts that can and should be sanitized before your first use:

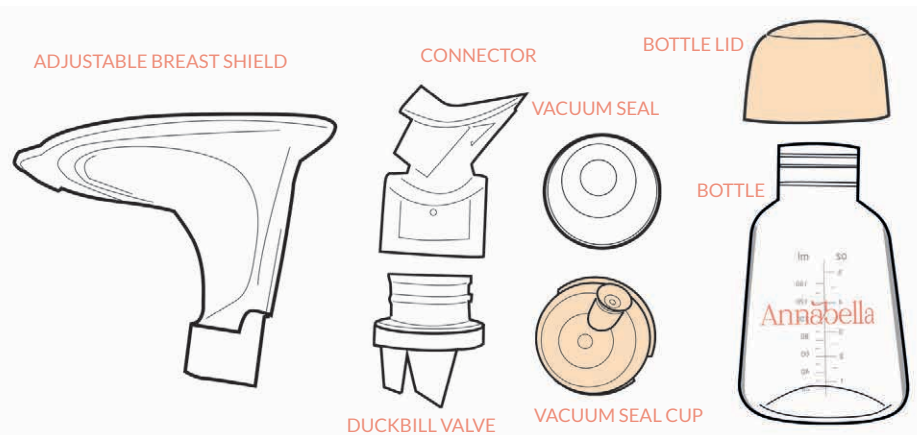

Pumping with Annabella should be pleasant. Feel any pain? We are here to help!

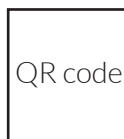

Annabella

Quick User Guide

Assembly

1 | Charge

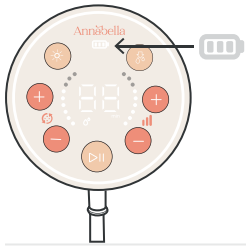

2 | Assemble



3 | Place

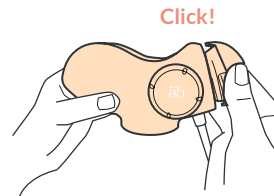

4 | Connect

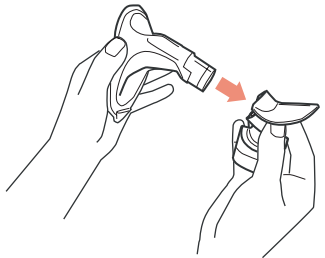

5 | Push

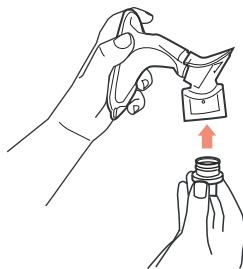

6 | Insert

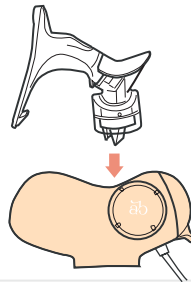

7 | Hold and Click

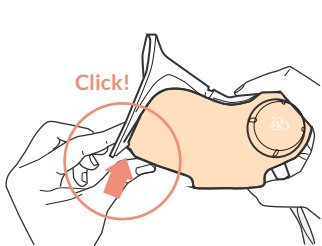

8 | Hold and Turn

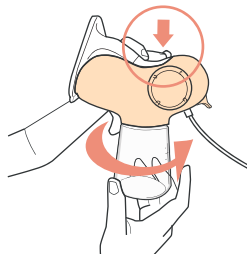

9 | Connect

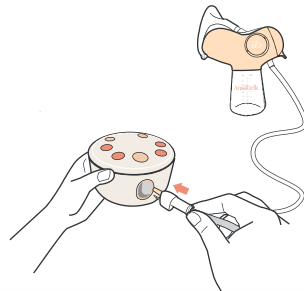

Check Your Fit

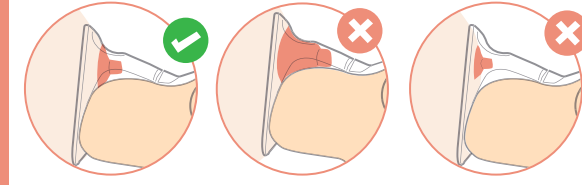

Just Right

Too Big

Too Small

Align

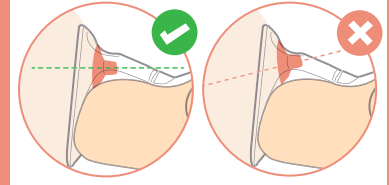

Pumping Session

Unplug from power source before pumping!

1 | Power On



2 | Start

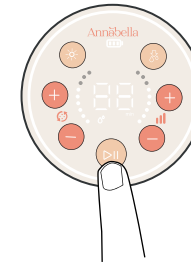

3 | Align

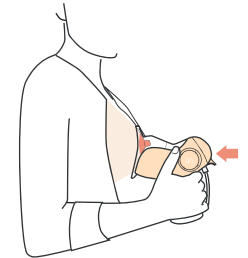

5 | Vacuum (+/-)

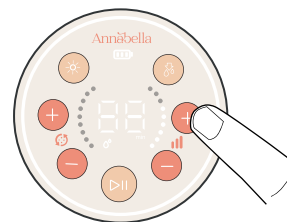

6 | Tongue Pace (+/-)

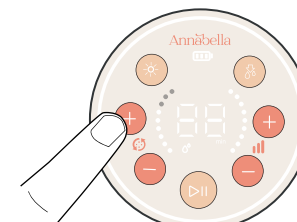

7 | Tongue Height

