

A further innovation  
from our assortment



## Fully-automatic watering system for **INDOOR PLANTS**.

- » The extremely simple Blumat system is the best method for indoor plants that require little water.
- » The water is delivered directly through the ceramic cone. The water is drawn from any optional container via the thin hose.
- » Blumat is ready to use at any time.
- » The plants remain in their normal location.
- » No re-potting required.
- » Blumat is the ideal watering system when on vacation.
- » Can also be used the whole year round.



Weninger GmbH  
& Co KG  
Hag 7 · A-6410 Telfs

## **BLUMAT-CONSULTATION-SERVICE:**

IF YOU HAVE ANY QUERIES OR REQUESTS  
WITH REGARD TO SPECIAL APPLICATIONS, CALL ...

Tel. 0 52 62 / 62 4 35  
Fax 0 52 62 / 62 4 35-7

Tel. 00 43 / 52 62 / 62 4 35  
Fax 00 43 / 52 62 / 62 4 35-7

e-mail: [info@blumat.at](mailto:info@blumat.at) · internet: [www.blumat.info](http://www.blumat.info)



© by **arm** werbeagentur · Innsbruck-Telfs · 0664/308 44 35

## OPERATING INSTRUCTIONS



Fully-automatic watering system



## Congratulations on purchasing Tropf-Blumat

Flowers on balconies and terraces are on the one hand the adornment of every house, but on the other hand also demand constant care and attention. Even vegetable plants in greenhouses are only so-to-speak "crispy fresh" with regular watering.

With Tropf-Blumat you have decided on a watering-system, that assists you in two ways. Since now you will not only be spared the watering, but also, above all, unnecessary water consumption. The plants draw namely only the quantity that they really need.

Since neither a power connection nor control is required for this system, it is also child's play to install. The only tool you require is a pair of scissors. For the precise method of assembly, please refer to our clear and well illustrated assembly guide.

With Tropf-Blumat, you and your plants are guaranteed to have absolute joy.

*Roland Deminger*  
WENINGER GMBH & CO KG

## Content

- » Easy and trouble-free to install 3-6
- » Water tap or elevated tank as source 6
- » Tropf-Blumat function 7
- » How many Tropf-Blumats do your plants require 8
- » What if...? 9
- » Blumat-Sets and supplementary packages 10
- » Using Tropf-Blumat accessories 11

## ▶ Easy and trouble-free to install

### » STEP 1

Unscrew green watering head- and ceramic sensor. Fill to the brim with water.



### » STEP 2

Then screw together tightly again up to the stop ring. Sensor must be sealed air-tight.



### » STEP 3

Immerse the Tropf-Blumat, filled with water and tightly screwed, in water for at least 1 hour, so that the ceramic ball can completely absorb the water.





## Easy and trouble-free to install

### » STEP 4

In the meantime, establish the hose connection to the pressure reducer or elevated tank. If you immerse the feeder hose in hot water for 5 min. or leave in the sun, it will be easier to lay.



### » STEP 5

**IMPORTANT:** Please water the ground generously several times before using the Tropf-Blumat.

Insert the Tropf-Blumat in the ground near the roots to the depth marked at intervals of



approx. 20 to 25 cm. Ensure good contact with the ground (Pic 5). At the end of the system, fit the Tropf-Blumat with the end piece. (if necessary remove T-piece and replace with end piece [Pic 6A])



## Easy and trouble-free to install

### » STEP 6

#### Lay the feeder hose

Cut off appropriately long hose-lengths from the feeder hose and connect the individual Tropf-Blumat units with them. Push the hose-lengths onto the Tropf-Blumat T-connection pieces properly and firmly. Ensure correct hose seating. This is made simple and easy by moistening the T-piece.

**Do not use any lubricant (grease, soap, etc.) when fitting!**

Turn on the tap.

**IMPORTANT:** Before setting, all Tropf-Blumat units must be "closed". Simply turn the brown setting screw in a clockwise direction. No dripping may occur anywhere.



### » STEP 7

Open by turning the setting screw in an anticklockwise direction.

Now water drips from the dripper hose, which must protrude approx. 8 cm from the Tropf-Blumat (See Pic 7).

Then slowly turn the setting screw in a clockwise direction again, so that just a drop of water clings to the dripper hose.

Then close the setting screw further by 2 marking arrows in a clockwise direction (Pic 7A).

**The Tropf-Blumat should not discharge any water when the ground is wet.**



Easy and trouble-free to install

## Water tap or elevated tank as source

### » STEP 8

#### Altering the ground moisture

After the installation you should check the water delivery for about 1–2 weeks at 2-day intervals and adjust if necessary by opening (= more water) or closing (= less water). In most cases a rotation of 1/2 marking arrow is sufficient.

(SEE YELLOW CROSS-HATCHED AREA)



An optimally set water delivery does not need to be altered.



**TIP:**  
Fit a 2-way distributor on the water tap and you have a second outlet.

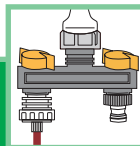

① We recommend that the connection on the water tap is fitted with a pressure reducer. If the water tap is located in the garden, then balcony and hanging flowers at a height of max. 4 m can also be supplied. Consequently, refilling the elevated tank is then unnecessary.



② If only one elevated tank is in question, this must **stand at least 0.5 m higher than the Tropf-Blumat system for each 5 m hose length.** For 10 m hose therefore, at least 1 m.



## Tropf-Blumat function

### » The fully-automatic plant-watering system

**Tropf-Blumat** operates fully automatic. If the ground is dry, then its suction pressure triggers the watering operation. The integrated membrane in the Tropf-Blumat opens and releases the flow of water. When the ground has been

sufficiently moistened, the water delivery ceases independently. Each Tropf-Blumat sensor reacts completely independently. It takes into account the solar radiation, air temperature, humidity and plant growth.



### Maintenance and winter storage

When dismantling the system, clean the ceramic sensor inside and out with water and store protected from frost. Incrustations on the ceramic cone can be removed with sand paper. All hoses can remain in the open air.

### Fertilisation

We recommend long-term fertilisers, that are best added to the ground during planting. Naturally, you can however also give the plants the nutrients with a watering can.

### Guarantee

We provide a 24 month guarantee for all Blumat products from the date of purchase. Should you have cause for complaint, send us the defective component together with the purchase receipt.

## ▶ How many Tropf-Blumat units do your plants need?

One Tropf-Blumat unit waters on average approx. 20–25 cm of ground.

### YOU NEED:

- A** e. g. for watering balcony boxes of:  
 100 cm length: at least 4 Tropf-Blumat units  
 80 cm length: at least 3 Tropf-Blumat units  
 60 cm length: at least 2 Tropf-Blumat units
- B** e. g. for watering plant pots:  
 up to 25 cm  $\varnothing$ : 1 Tropf-Blumat unit (SEE SKETCH B1)  
 of 25 to 40 cm  $\varnothing$ : 2 Tropf-Blumat units (SEE SKETCH B2)  
 of 40 to 50 cm  $\varnothing$ : 3 Tropf-Blumat units (SEE SKETCH B3)
- C** For larger containers or in beds, distribution drippers can also be used instead of additional Tropf-Blumat units. Each single Tropf-Blumat unit and 5 distribution drippers can water e.g. an area of 40 cm width and 50 cm length.
- D** With the 8 mm  $\varnothing$  feeder hose, you can operate a flower arrangement of 60 running metres, that is 250 drippers. If your arrangement is larger, fit the enclosed hose branch in series directly after the pressure reducer. This way you can connect 2 x 60 m flower arrangements or 500 drippers.

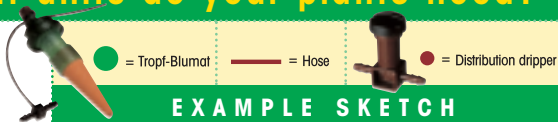

### EXAMPLE SKETCH

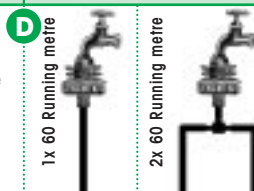
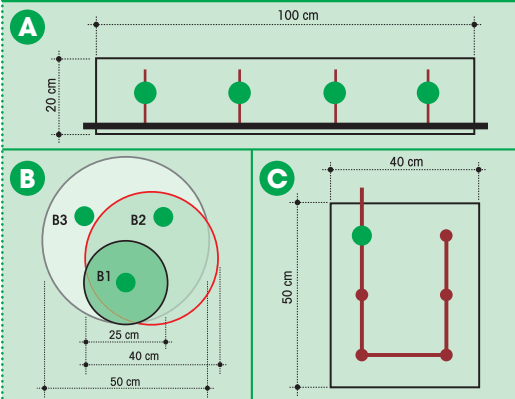

## ▶ What if ...

### » IMPORTANT NOTES:

Always leave the water tap turned on or replenish the water tank in good time. Even when it is raining. With longer interruptions to the water supply, the roots can suck the water out of the sensor. Don't be fooled by a dry ground surface. The water spreads underground like an onion. Often only the ground surface under the dripper hose is visibly moist.

### » TIPS when going on vacation

- Install the system at least 10 days before.
- Support the plants from falling down and do not place in subsoil susceptible to damp.
- Eventual water leaks must also not cause any other damage (e. g. flow into cellars or the like)

### » The sensor runs out of water?

#### POSSIBLE SOURCES OF THE PROBLEM:

Air has entered the system, poorly screwed together, buckled dripper hose, poor ground contact, interrupted water supply.

#### SOLUTION:

Refill the ceramic sensor with water and screw together tightly up to the marking ring.

### » The watering diameter is too small?

#### POSSIBLE SOURCE OF THE PROBLEM:

Dripper hose is too short. The water therefore reaches the ceramic sensor too quickly.

#### SOLUTION:

Extend dripper hose to 8 cm.

### » Tropf-Blumat does not turn off?

#### POSSIBLE SOURCE OF THE PROBLEM:

Membrane has too little tension (can occur after cold nights).

#### SOLUTION:

Close the setting screw approx. 1/2 mark.

### » No water comes out of the dripper hose?

#### POSSIBLE SOURCE OF THE PROBLEM:

Hose is blocked, stuck or supply buckled.

#### SOLUTION:

Withdraw the dripper hose a little and knead the compressed part between the fingers.

The Tropf-Blumat watering system has been specially developed for outdoor plants. Therefore please do not use indoors.

## ▶ Blumat-Sets and supplementary packages

With the Blumat-Sets and supplementary packages, you can install and expand your watering system individually.

					
<b>Pressure reducer</b> ready to connect for water tap	<b>Tropf-Blumat</b> Supplementary package	<b>Feeder hose</b> white / black 10-m-roll, 8 mm Ø	<b>Shut-off valve</b> for feeder hose	<b>Supports</b> for feeder hose and distribution drillers	<b>Tropf-Blumat MAXI</b> for big plants insertion depth between 15 and 18 mm
					
<b>Mini-branch + dripper hose</b> for extending and branching	<b>Hose union</b> for connecting 8 mm Ø feeder hoses	<b>Hose branch and end-piece</b> for branching 8 mm Ø feeder hoses	<b>Elbow</b> for changing the direction of the 8 mm Ø feeder hoses	<b>Distribution dripper + end distribution dripper</b> for watering longer bed rows	<b>Flexible hose security clamp</b> for all hoses including 8 mm T coupler

## ▶ Using Tropf-Blumat accessories

### » CONNECTING THE DISTRIBUTION DRIPPER

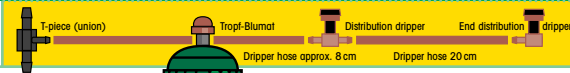

Cut off pieces of hose approx. 20 cm from the thin dripper hose. Then connect max. 5 distribution drippers together. At the end of the chain, fit the distribution dripper to just one connection neck or seal the second outlet with the black stopper. Then connect the chain to the dripper hose end of the

Tropf-Blumat unit. It is important that the distance from the Tropf-Blumat sensor to the nearest distribution dripper is approx. 8 cm. (SEE SKETCH A)

Lay the chain with the distribution drippers according to preference, near the plant roots.



(SEE SKETCH B) In general, the black screw on the distribution dripper does not need to be adjusted, unless a distribution dripper obviously delivers too little water. In this case, open the black screw by one turn. If necessary, unscrew completely and clean (threads possibly soiled).

Method of using distribution drippers:  
Only with similar plants in the same pot or bed row!



Distribution  
dripper  
Support

