



Detection delivered. Reliability assured.
Commercial Series Motion Detectors



BOSCH

Invented for life

Detection is the first step to protecting a home or business and the people and property within its walls. Instant responses to intruders and immunity from false alarms are essential to safety and security.

Our focus on research and development allows us to regularly introduce new technologies to improve the performance and reliability of motion detectors. This innovation engine is driven by decades of experience, world-class engineering, and an unwavering dedication to high-quality and high-performing products. This makes Bosch detectors the best in any class.

Commercial Series builds upon the tradition of our Blue Line Gen2 detectors and again raises the bar in intrusion detection to meet the higher security requirements of commercial applications.



Immunity from false alarms

Protect against environmental challenges. The Commercial Series reduces false alarms by more than 35 percent over other competitor detectors. The superior optics and electronics design ensures the best possible signal quality. This allows for the use of the advanced First Step Processing algorithm for more accurate alarm determinations compared to traditional pulse-count motion detectors. In addition, Microwave Noise Adaptive Processing adjusts to background disturbances, such as a ceiling fan or hanging sign, to easily differentiate intruders from false alarm sources. The sealed optical chamber prevents drafts and insects from affecting the detectors. These detectors also feature small animal immunity up to 4.5 kg (10 lbs).

Excellent catch performance

Detect intruders from wall to wall. Commercial Series motion detectors provide a broad coverage range of 15 x 15 meters (50 x 50 feet).

Make the catch with field-proven technology. Sophisticated First Step Processing delivers an instant response to the first step of an intruder. Dynamic temperature compensation ensures detection of intruders at virtually any temperature, optimizing performance regardless

of room conditions. Active Infrared Anti-mask detects materials being placed in front of or sprayed onto the detector.

Flip a switch for precise sensitivity. Use the same model for multiple applications. Simply select high sensitivity for high-security facilities or standard sensitivity for other commercial environments. Stringent testing ensures catch performance exceeds the requirements of any single country to comply with standards throughout the world.

Bosch detectors vs. competitor pulse count detectors

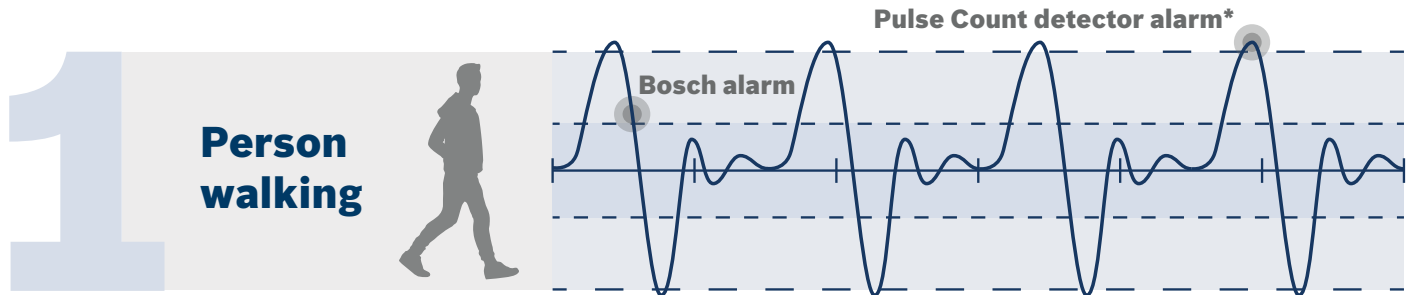

Bosch detector alarms at first zone; Competitor alarm is delayed

*Pulse count set to 4

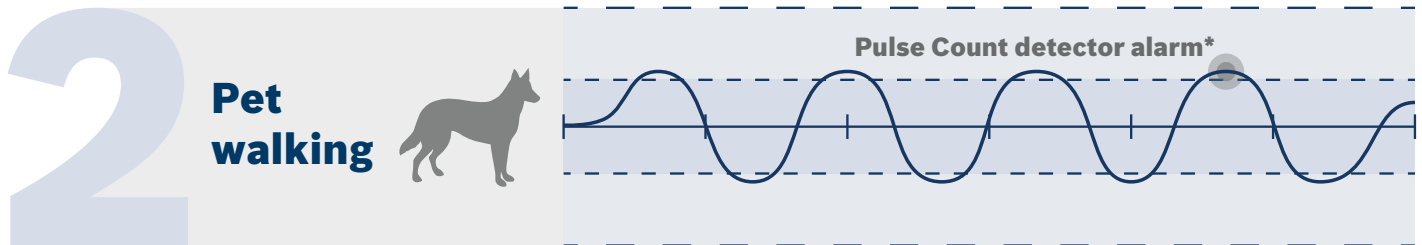

Bosch detector ignores source; Competitor sends false alarm

*Pulse count set to 4

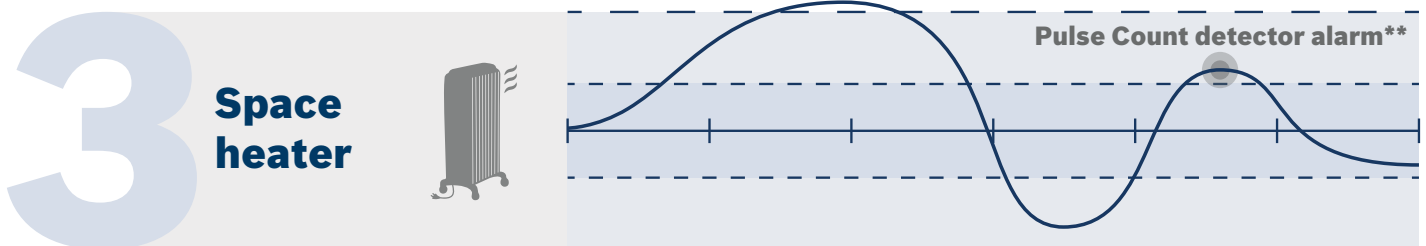

Bosch detector ignores source; Competitor sends false alarm

**Pulse count set to 2

Easy install

Get the job done faster and more accurately. Unique features speed installation by an average of 43 percent compared with detectors from other manufacturers, while ensuring reliable performance.

Mount within seconds. The self-locking, two-piece enclosure, integrated bi-axial bubble level, and removable terminal strip ensure mounting is fast and easy. Position the detectors at 2.3 to 2.75 meters (7.5 to 9 feet) for

wall-to-wall coverage up to 15 meters (50 feet) with no adjustment needed.

Simplify wiring. Designed to eliminate service calls and reduce false alarms, the new integrated end-of-line resistors simplify wiring requirements while the angled lift-gate terminal strip prevents incorrect wiring. This cuts installation time and complexity and ensures compatibility with a range of control panels from Bosch and other providers.

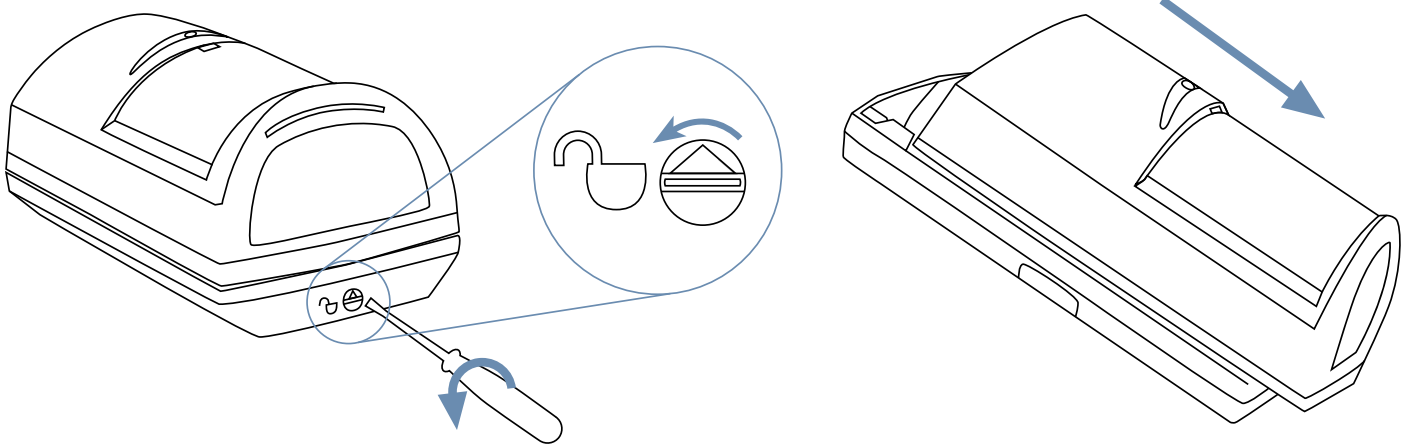

Installation Step	Bosch Detectors	Other Detectors
Open detector	Self-locking cam and sliding cover	Remove screw and hinge cover
Unscrew and remove PCB	Step not required	Required
Open wire holes	Knock-outs	Knock-outs
Level unit with wall or bracket	Integrated bi-axial bubble level	Additional tool required
Mount unit to wall or bracket	Required	Required
Install PCB in base	Step not required	Required
Adjust PCB for mounting height	Step not required	Fasten screw while holding PCB
Adjust sensitivity	Certified to international standards	Only certified in high sensitivity mode
Enable/Disable features	Dip switches	Dip switches, jumpers
Connect wires to terminals	Removable lift-gate, gap free	Crush plate
Install end-of-line resistors	Jumpers	Jumpers
Secure cover to detector	Self-locking cam with sliding cover	Hinge cover and re-insert screw
Total installation time	Less than 6:48 minutes	7:44–10:52 minutes



	Blue Line Gen 2	Commercial Series	Professional Series
Application	Residential/Small Commercial	Standard Commercial	High Security Commercial
Coverage/Range: Standard	Up to 40 ft (12 m)	Up to 50 ft (15 m)	Up to 60 ft (18 m)
Coverage/Range: Curtain	—	—	Up to 100 ft (30 m)
Signal Processing	First Step Processing	First Step Processing	Sensor Data Fusion
PIR Lens and Sensor	Single	Single	Dual
Doppler Radar Processing	Microwave Noise Adaptive Processing	Microwave Noise Adaptive Processing	Range-adaptive Radar
Active White Light Suppression	—	—	■
Dynamic Temperature Compensation	■	■	■
Wall-to-wall Coverage	■	■	■
Look-down Zone	■	■	■
Pet/Small Animal Immunity	Up to 100 lb (45 kg)	Up to 10 lb (4.5 kg)	Up to 10 lb (4.5 kg)
Anti-mask (EN 50131 grade 3)	—	■ (select models)	■ (select models)
Alarm Output/Memory	—	■	■
Integrated EOL Resistor	—	■	—

Choose your detection solution

Meet the requirements for a range of applications. Select from a TriTech motion detector or a TriTech+ motion detector with a selectable anti-mask feature. A common mounting base allows for easy upgrade after installation.



EN50131-2-4
Grade 2

TriTech Detector ISC-CDL1-W15x

The TriTech motion detector uses a combination of passive infrared (PIR) and microwave Doppler radar detection technology with advanced signal processing. Designed to meet the needs of a wide range of commercial applications, it offers selectable LED visibility and an adjustable microwave range to reduce false alarms.



EN50131-2-4
Grade 3

TriTech+ Detector with Anti-mask ISC-CDL1-WA15x

For high-security commercial applications, the TriTech+ motion detector uses a combination of PIR and microwave Doppler radar detection technology and adds the option to select sensitivity and anti-mask capabilities. A flip of a switch increases sensitivity by 20 percent, making this detector suitable for high-risk applications with no other adjustments needed. Active Infrared Anti-mask detects materials being placed in front of or sprayed onto the detector.

Detection delivered. Reliability assured. Get rapid detection of security breaches while ignoring false alarms with the Commercial Series from Bosch!

A Tradition of Quality and Innovation

For 125 years, the Bosch name has stood for quality and reliability. Bosch is the global supplier of choice for innovative technology, backed by the highest standards for service and support.

Bosch Security Systems proudly offers a wide range of security, safety, communications and sound solutions that are relied upon every day in applications around the world, from government facilities and public venues to businesses, schools and homes.

Bosch Security Systems, Inc.

130 Perinton Parkway
Fairport, NY 14450 USA

Phone: 800.289.0096

Fax: 585.223.9180

For more information please visit
www.boschsecurity.us

© Bosch Security Systems, Inc.
2015 Modifications Reserved
Printed in United States | 06/15
BINBR_COM-SERIES_v20150625

