

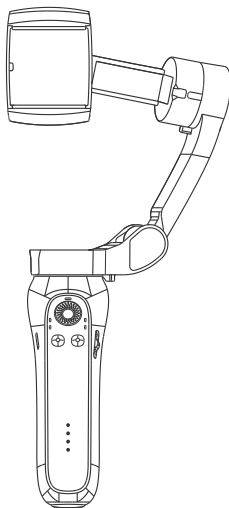

## Sports Tracking Gimbal User Manual

Version 1.4 Oct. 2023



# Contents

<b>Before Use</b>	_____	2
<b>Introduction</b>	_____	3
Auto Tracking	-----	3
Video Tutorial	-----	3
Phone Stabilizer	-----	3
Component Diagram	-----	4
<b>Getting Started</b>	_____	5
Charging	-----	5
Mounting Smartphones	-----	5
Choosing a Recording Location	-----	6
<b>Using XbotGo</b>	_____	8
Buttons and Controllers	-----	8
Adjusting the Gimbal	-----	10
Using Xbot Go app	-----	10
<b>Specifications</b>	_____	13
<b>Cautions</b>	_____	14
<b>Storage and Maintenance</b>	_____	14
<b>Remote Controller</b>	_____	15

# 01/ Before Use

---

Scan the following QR code to download Xbot Go app from app store.



iOS



Android

⚠ The iOS version of Xbot Go supports iOS 15.0 and later.  
The Android version of Xbot Go supports Android 10.0 and later.

## Quick Start Guide

1. Open Xbot Go app
2. Click "User Manual"
3. Watch the "Video Tutorial"

### TIPS

- 1) Fully charge the gimbal before the first use.
- 2) Turn off the power when not in use.
- 3) Mount a mobile phone to the phone holder securely.

## Support

Please contact: [support@blinktech.us](mailto:support@blinktech.us) OR +1 (408) 513 – 6183.

Business Hours: 8:00 – 11:00 AM, 8:00 – 11:00 PM EST ( M – F ).

# 02/ Introduction

---

## ► Auto Tracking

Thank you for choosing XbotGo! To use our gimbal to automatically track, record or stream sports games, please watch the following video tutorial first.

## ► Video Tutorial



## ► Phone Stabilizer

In addition, XbotGo Gimbal is a full functioning phone gimbal that can stabilize video recording of smartphones. If you want to use it as a stabilizer for a mobile phone, please install another app, "Gimbal Pro", from the app store. For more information, refer to the "XbotGo Gimbal User Manual" from the "Xbot Go" page, "Download" section of the Blink Tech official website: [www.blinktech.us](http://www.blinktech.us)

## Contact Us:

Live Chat: <https://blinktech.us/>

Email: [support@blinktech.us](mailto:support@blinktech.us)

Phone: +1 (408) 513-6183



## ► Component Diagram

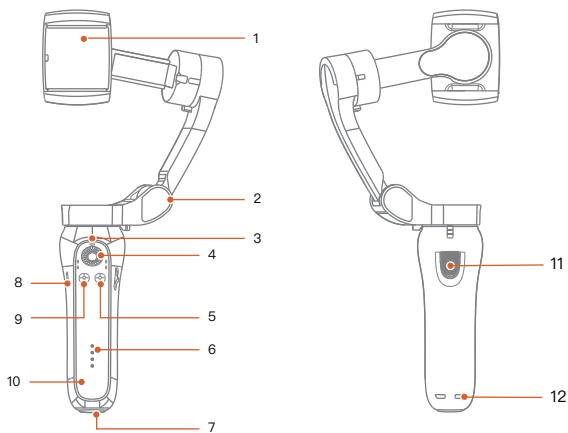

- |                             |                         |
|-----------------------------|-------------------------|
| 1. Smartphone Holder        | 7. ¼" Thread Screw      |
| 2. Folding Shaft            | 8. Type-C Charging Port |
| 3. Bluetooth Indicator      | 9. Mode Button          |
| 4. Joystick                 | 10. Handle              |
| 5. Power Button             | 11. Shutter Button      |
| 6. Battery Level Indicators | 12. Thread Hole         |

# 03/ Getting Started

---

## ► Charging

- To charge XbotGo, connect a USB adapter (not included) to the USB-C charging port using the charging cable (included). This device supports fast charging. It is recommended to use a 5V/2A adapter.

**Charging time:** 80 minutes

**Max. runtime:** 3 ~ 4 hours

- When charging XbotGo, the blue power indicator lights should flash. Otherwise, check if the adapter and the cable are connected properly. All four power lights should turn into solid blue once the charging is completed.

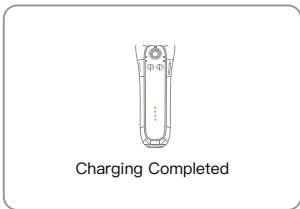
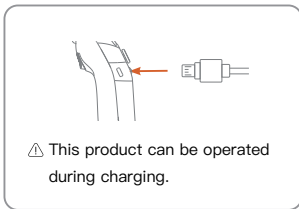

## ► Mounting Smartphone

1. Mount the phone on the holder.
2. It is recommended to remove the phone case before mounting because:
  - (1) The phone will have a better grip with the holder.
  - (2) The phone will dissipate heat better (overheating phones at high temperatures could result in a shutdown).

3. According to the directional indicator of the phone holder, attach the mobile phone into the clamp. Ensure that the mobile phone is centered and snugly attached to the panel of the phone holder to prevent it from slipping off. Please make sure that the phone is properly aligned with the placement position indicated by the red lines on the recording screen of the APP.

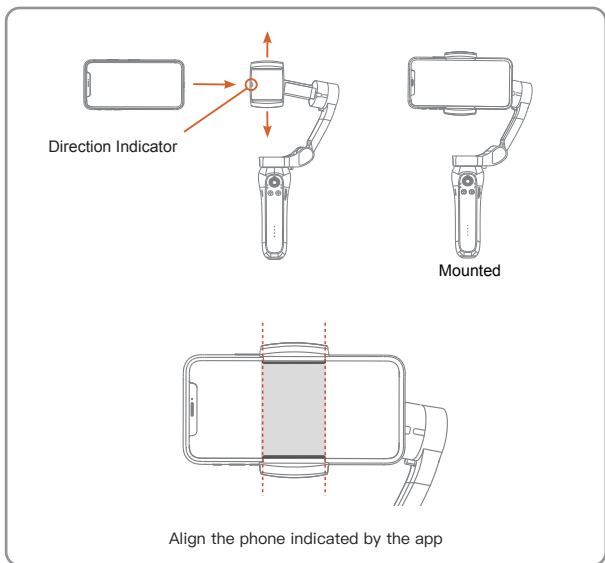

### ► Choosing a Recording Location (Highly Recommended)

When record sport games, for the best tracking performance, it is highly

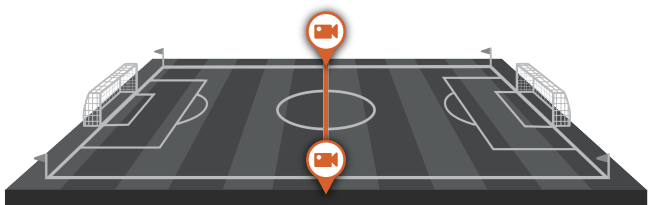

Examples of football fields

recommended to setup the device near the center line of the field (as shown below). If recording in training mode, setup the device near the middle of the field as well.

- Please try to align the back center mark towards the center line of the target field. This applies to all recording modes, except for basketball half court mode. This will make sure the camera covers the whole field.

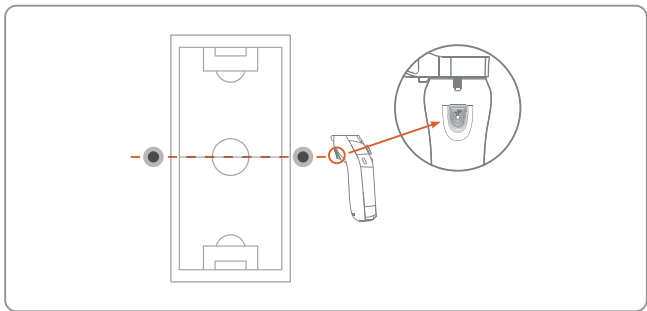

- It is recommended to use a tripod to maintain stability of gimbal during recording and tracking. To record sports in a large field, such as

soccer games, it is highly recommended to use a 12 feet and taller tripod to achieve the best performance.

- Try to avoid any close audience in front of camera blocking the view. It's recommended either to raise the tripod up high, or to setup the tripod close to the side line so no audience will block the camera's view.

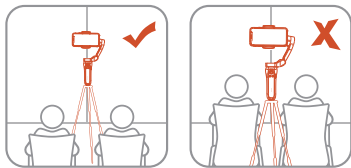

## 04/ Using XbotGo

---

### ► Buttons and Controls

#### 1. Power Button

- **Power on:** press and hold the power button for 1 second until the indicator lights turn on and the gimbal makes a start sound.
- **Power off:** press the power button for 1 second until the indicator lights go off.

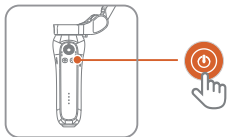

## TIPS

The arms should be folded manually after power down, and the phone holder should get back to the storage position.

- **Single quick press:** quick press the power button to switch between portrait and landscape modes. When the gimbal is jammed, the AF light will flash; reset this with a single quick press.

### 2. Mode Button

**Press twice:** make the gimbal gets back to the center position.

### 3. Shutter

**Reset Bluetooth:** press and hold the power button and the shutter button at the same time for 3 seconds to reset the Bluetooth, which will disconnect the gimbal from the mobile phone currently paired.

### 4. Joystick

Move vertically to tilt and move horizontally to pan the mobile phone.

### 5. Battery Indicator Lights

Charging Status	Battery Level
The first light is flashing	10%–25%
The first light is on, and the second light is flashing	25%–50%
The first and second lights are on, and the third light is flashing	50%–75%
The first three lights are on, and the fourth light is flashing	75%–99%
Four lights are all on	100%

## 6. Bluetooth Indicator Light

Indicator Light Status	Bluetooth Status
Bluetooth indicator breathing (flashing slowly)	Bluetooth is not connected
Bluetooth indicator flashing	Bluetooth is connecting
Bluetooth light is on	Bluetooth is connected

## 7. 1/4" Thread Port

The threaded port on the bottom allows XbotGo to attach to tripods.

### ► Adjusting the Gimbal

1. XbotGo is designed to record in landscape mode. To switch mode, click the power button once to switch the phone from the initial portrait mode to the landscape mode.
2. Before shooting, double-click the mode button to set the gimbal back to the center position. Try to align the shutter button with the center line of the field.

### ► Using Xbot Go App

When used with Xbot Go App, the XbotGo gimbal will be able to support features such as automatic tracking, manual shooting, and live streaming. To connect the gimbal with the app.

Here's the instruction:

1. Enable Bluetooth from the mobile phone settings.
2. Open Xbot Go app.
3. Click the orange  logo button. XbotGo device with name "GP7 XXX"

shall be found. Select to connect to it. If the device cannot be seen, check if the device can be found through bluetooth settings of the mobile phone. It might be paired with other phones and thus cannot be seen by the desired phone.

4. Once connected, select the target scenario and enter recording mode. In recording mode, press the red recording button to start auto sports tracking and recording.

5. The recorded videos will be saved in the app. Select "Manage" and then "Local" to see all the saved videos. Select "Cloud" for uploading videos to the cloud space. Please keep the app running foreground during uploading.



6. To use our cloud storage and live streaming services, please register an account and login the account first.

7. To turn on live streaming, click "Start Live" button on the recording screen.



It will ask for a picture as a cover and a name for streaming.

 The stream will be broadcasted on Xbot's own platform and will be publicly available for everyone with the broadcast link.

## 8. Live Streaming

- 1) To start live streaming, click on "Start Live" button on the recording screen. Select an image as the cover of you live room and put a title for your live. Both will be seen by your audience.
- 2) We support live streaming over Xbot platform, Facebook, YouTube or any links support RTMP. If stream over Xbot platform, users can set a password to protect it.

# 05/ Specifications

---

<b>Gimbal Weight</b>	362g
<b>Payload</b>	280g
<b>Operating Temperature</b>	0°C – 40°C
<b>Voltage</b>	3.4~4.2V (Standard 3.7V)
<b>Compatible Phone Size</b>	Diagonal: ≤ 180mm Width: 55–90mm Thickness: ≤ 9.5mm
<b>Operating Current</b>	150~3000mA (Standard 1500mA)
<b>Dimensions</b>	Unfolded: 260mm×130mm×88mm Folded: 152mm×110mm×46.6mm
<b>Charging Time</b>	80 mins (use 5V/2A adapter)
<b>Run Time</b>	3~4 hours
<b>Input Voltage</b>	5V
<b>Input Current</b>	2A

## 06/ Cautions

---

- Once the gimbal is powered on, make sure its rotation is not blocked by any external forces. Otherwise, it may result in a failure, indicated by a "dinging" sound.
- When the gimbal is powered on, please keep the handle stable. Shaking the gimbal may result in a failure. It is therefore recommended to mount the gimbal on a tripod for use.
- The gimbal is NOT waterproof. Do not expose the product to any liquids, and do not get the product wet or immersed in water. Do not expose it to seawater or corrosive liquids.
- Do not disassemble the gimbal. If you accidentally disassemble it and cause an issue, contact us for repairment.
- Excessive continuous operations may cause the motor to reach a high temperature and damage the device. Please use it with caution.
- Avoid dropping the device. The gimbal is not shockproof, and dropping it may damage it or cause abnormal function.

## 07/ Storage and Maintenance

---

- Please keep this product and battery away from children and pets.
- Please don't put this product near heat sources (stove or heater, etc.), or leave it in.
- cars in hot weather. Do not store the product in an environment above 60°C.

- Please store the product and battery in a dry environment.
- Do not overcharge or discharge the battery, otherwise the battery cell will be damaged.
- Please use this product in an environment with a temperature between 0°C and 40°C.

## 08/ Remote Controller

### ► Remote Controller Specifications



<b>Model</b>	XbotGo RC1
<b>Battery Model</b>	CR2032
<b>Signal Coverage Range</b>	10m
<b>Temperature</b>	-5°C ~ 60°C (23°F ~ 140°F)

### Quick Start Guide

1. Open the battery compartment cover, then remove the insulating plastic sheet from the bottom of the battery and close the battery compartment cover.
2. Press and hold the power button for 3 seconds to turn on/off the remote controller.

3. After turning on, press the function selection button to switch functions.

4. Bluetooth pairing is required before the first use.

a. Press and hold the remote controller's power button. Power on the remote controller, the phone connection indicator flashes red.

b. Open XbotGo APP on your phone and select XbotR-XXXX in the XbotGo APP for pairing. After the connection is established, the phone connection indicator on the remote controller will turn into a solid blue.



#### 5. Exceed the signal range (10 meters):

When disconnected from the APP, the remote controller lights will flash red. If it re-enters the receptive range within 1 minute, blue lights on the remote controller will illuminate, and the connection will be automatically restored.

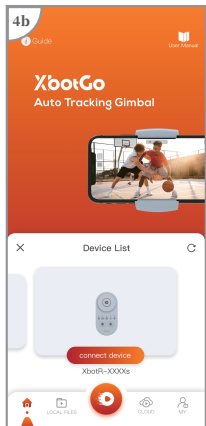

#### 6. Sleep mode and Shutdown:

With no operation for 3 seconds, the remote controller will enter sleep mode. Press any button on the remote controller to exit sleep mode. If the remote controller remains in sleep mode for more than 5 minutes,

it will automatically shut down. Press the power button to turn it on again, and it can be reconnected when close to the device.

⚠ The disconnection of the remote controller during use will not affect the APP running on the phone. If the APP cannot find the remote controller during use, you can reset the remote controller by pressing the power button for 3 seconds, then perform the pairing again.

## ► XbotGo RC1 Remote Controller

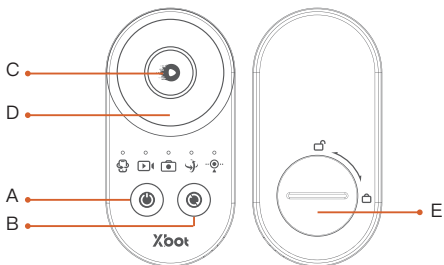

- A. Power Button
- B. Function Selection Button
- C. Confirm Button
- D. Directional Buttons (Circular Disk)
- E. Battery Compartment

## ► Buttons and Functions

Before you use it, get familiar with the remote controller.

## ► Camera Function

Press the Function Selection button to switch to camera mode; press the confirm button in camera mode to control the shooting states.

- **On the remote controller:**

1. One "beep" sound indicates that the APP is in "start recording" status.
2. Two consecutive "beep" sounds indicates that the APP is in "stop recording" status.

- **On the APP side:**

A blue mask will prompt on screen for 3 seconds and will automatically disappear. At this point, it is in camera mode, and you can check the status with corresponding operational commands.

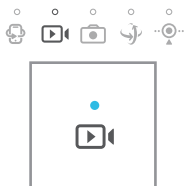

## ► Photo Function

- Press the Function Selection button to switch to the photo mode;
- In photo mode, press the confirm button to take photos.

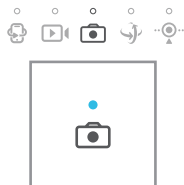

## ► Steering Function

- Press the Function Selection button to switch to the steering mode;
- Press the up, down, left, and right directional buttons to rotate the gimbal in the corresponding direction.

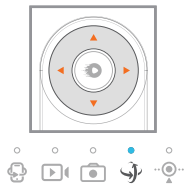

## ► PMark Function

(Available only Remote Controller in Camera Mode)

Mark any moments you want it to be included in highlights. After the recording, follow the instructions in the app, and upload the video to the cloud and our AI technology will automatically generate the highlights based on the moments you marked.



When press the marking button, the circular ring will flash blue. The XbotGo APP will trim the video segments before and after the marked moment.

Highlights can be viewed in XbotGo App/Cloud Management/Cloud Drive.

### Note

If the remote controller's red breathing light flashes, the buzzer alerts, or if the APP displays errors, command execution failures, please follow the prompts on the APP side for operation.





## ► Battery

The remote controller is equipped with a CR2032 button battery.



⚠ **For optimal product performance:**

- Please do not use different types of batteries.
- If you do not intend to use the device for more than two months, please do not leave the battery in the remote controller.

**Battery Disposal:**

- Do not dispose of batteries as unsorted municipal waste. Please refer to local regulations for proper battery disposal.

## ► Notes on Remote Controller

- The remote controller must be used within a range of 10 meters from the device.
- When the remote control signal is received, the App will provide pairing prompts.

⚠ This content is subject to change.  
Download the latest version from [www.blinktech.us](http://www.blinktech.us)

For customer support, please contact: [support@blinktech.us](mailto:support@blinktech.us) OR +1 (408) 513-6183.  
Business Hours: 8:00 – 11:00 AM, 8:00 – 11:00 PM EST ( M – F ).