

Joto Pen Press-

Model No.: E-HP-JPP-01

OPERATOR'S MANUAL



ClamShell Pen Press

JOTOTM
Bringing images to lifeTM

Safety Instructions

For Use By Qualified Personnel Only

When using your Pen Press, basic precautions should always be followed, including the following:

Read all instructions.

Use Pen press only for its intended use.

Always keep the Pen press dry. Do not get the Pen press wet to reduce the risk of electric shock. Avoid storing Pen press in a wet/ damp area.

Never pull the cord to disconnect the power. Instead, grasp plug and pull to disconnect from power outlet.

Make sure you protect the power cord by keeping it away from hot surfaces. Avoid placing objects on top of the cord. This could cause damage to the cord and could be a fire hazard risk.

Do not operate Pen press with a damaged cord or if the equipment has been damaged. To prevent risks of injury, please do not disassemble or attempt to repair the Pen press by yourself if you are not qualify to do so. Instead, call or take it to a qualified service person for examination and repair. Incorrect assembly or repair could increase the risk of fire, electric shock, or injury to persons when the equipment is used.

If Pen press being used by or near children, please make sure that it is supervised. Do not leave equipment unattended while connected.

Metal parts on the press can become hot. Avoid touching the hot metal parts to prevent burns. Proceed with caution when using the Pen press.

To reduce the likelihood of circuit overload, Joto recommends to use a dedicated circuit if possible.

Make sure that the cord is safely secured so it cannot be pulled or tripped over.

If you need to use an extension cord, make sure you use a 20 amperage rated cord. Cords rated below 20 amperage can overheat. Make sure that the extension cord is safely secured so it cannot be pulled or tripped over.

Note: Temperature is in Fahrenheit or Celsius. This Pen press should not be set to exceed 400°F (200°C). Setting the press temperature to above 400°F (200°C) will burn out your Pen element and may cause a fire hazard.

Do not use any other power cords other than the one provided with this machine. Doing so may result in a fire hazard. If you need a replacement cord, please call Joto at 1-800-565-5686 to request one.



PLEASE KEEP THE BOX THAT YOUR PEN PRESS ARRIVED IN, ALONG WITH ALL ORIGINAL PACKAGING.

Congratulations on your purchase of a Joto Pen Press! In order to work professionally with the machine and start production, please make sure you read this manual carefully.

Reproduction of this manual requires written consent from Joto. Errors and amendments of technical details excepted, all rights reserved. Joto is not liable for any direct or indirect damages caused by the use of this product.

Table of Contents

Safety.....	2
Introduction	3
Pen Press Overview	4-5
Machine Parts Diagram	6
Setting Up Pen Press	7
Operating Instructions	8
Maintenance	9
Expanded View	10-11
Circuit Diagram.....	12
Warranty.....	13
Contact Information	14

Pen Press Overview



Technical Specs

Model No.:	E-HP-JPP-01
Machine Type:	ClamShell Pen Press
Machine Size:	17.63"(448mm) x 10.11"(257mm) x 14.37"(365mm)
Printable Articles Max Size:	Up to 13mm Thickness
Voltage:	120V/220V
Power:	350W
Opening Angle:	45 degrees
Gas spring:	20kg \ ϕ 15 \ 164mm x 1 piece
Plate Size:	Pen heater 15 * 10 cm + pen base (6 pieces at a time)
Recommended Settings:	30~280s; 356~400°F or 180~200°C Time Range: 0~999s Maximum Temp: 400°F (200°C)

Note: Temperature is in Fahrenheit or Celsius. This pen press should not be set to exceed 400°F (200°C). Setting the press temperature to above 400° (200°C) will burn out your pen platen and may cause a fire hazard.

Pen Press Overview



FRONT VIEW



SIDE VIEW

Machine Parts Diagram



SIDE VIEW

Setting Up Your Pen Press

Turning On Your Pen Press

Turn the Main Power Switch on. The Main Power Switch is at the back of the heat press.

Current temperature will display. Usually has the value "OFF", indicating low temperature.



How to Read The Display

- 1.) If a number value shows on this display and no lights are lit in the the middle 3 slots, it is displaying the current temperature
- 2.) If the display has a value of "LO" it means low current temperature (under 200°F/ 95°C).

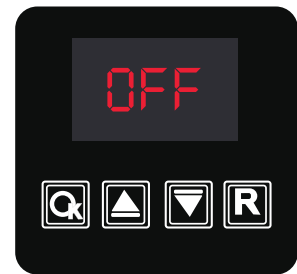

Setting Press Temperature

Press **Q** to start. Use the up and down arrows to choose to display in °F or °C. °F stands for Fahrenheit °C stands for Celsius

Once selection is made, press **Q** to save

Now use the arrow to change the value of the set temperature. The left light in the middle is lit to indicate you are in the set temperature mode.

Note: This pen press should not be set to exceed 400°F/ 200°C. Setting the press temperature to above 400°F/ 200°C will burn out your pen element and may cause a fire hazard.



Setting Press Time

Press the **Q** button to save the set temperature value Now change the set time value with the up and down arrows. Please note, the set time is in seconds.

The middle light in the middle is lit to indicate you are in the set temperature mode. Now Press **Q** to save the set time value.

Wait until the current temperature is the same as the set temperature before using. The press will beep once set temperature is reached. Close and open the press to stop the beeping.

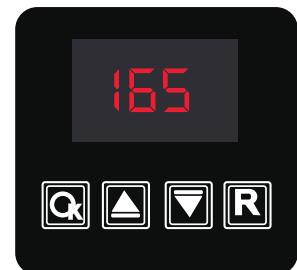

Operating Process

Pressing a Pen

- 1.) Turn ON the Power Switch.
- 2.) Set the appropriate Press Temperature, and Time.
- 3.) Tape your imaged transfer/sublimation paper to your pen with heat tape.
- 4.) Set the pressure. To do this, place a blank drinkware into the element. Adjust the pressure knob until the drinkware fits snugly in the element with the heat shield wrapped around the bottle (just enough pressure so that the drinkware cannot be moved once press is closed).
Turn pressure knob counter-clockwise to tighten and clockwise to loosen.
- 5.) Wait until current temperature is the same as set temperature. Once the pen press is at temperature, place a pen into the press. Close the pen press.
Note: Ensure the timer starts immediately after closing the press. If it does not, take the bottle out & wait for the temperature to go up to the set temp.
- 6.) Timer will start counting down. The press will beep when the set time has lapsed. When pen press beeps, open pen press and take out your drinkware.
- 7a.) For sublimation, peel immediately.
- 7b.) For Hard Surface Papers, wait until the pen is cold before peeling.

Maintenance

General Maintenance

Please switch off the machine and unplug the power cord when the machine is not in use.

To prolong the life of the pen press, do not use excessive pressure when pressing pens. If excessive pressure is used, this may damage the pen press or the pen element and cause it to malfunction

Keep the pen press in a dry place at all times.

Note: Temperature is in Fahrenheit or Celsius. This pen press should not be set to exceed 400°F/ 200°C. Setting the press temperature to above 400°F/ 200°C will burn out your pen platen and may cause a fire hazard.



If your pen press stops working, please contact Joto at 1-800-565-5686 so we can help you troubleshoot.

Expanded Diagram

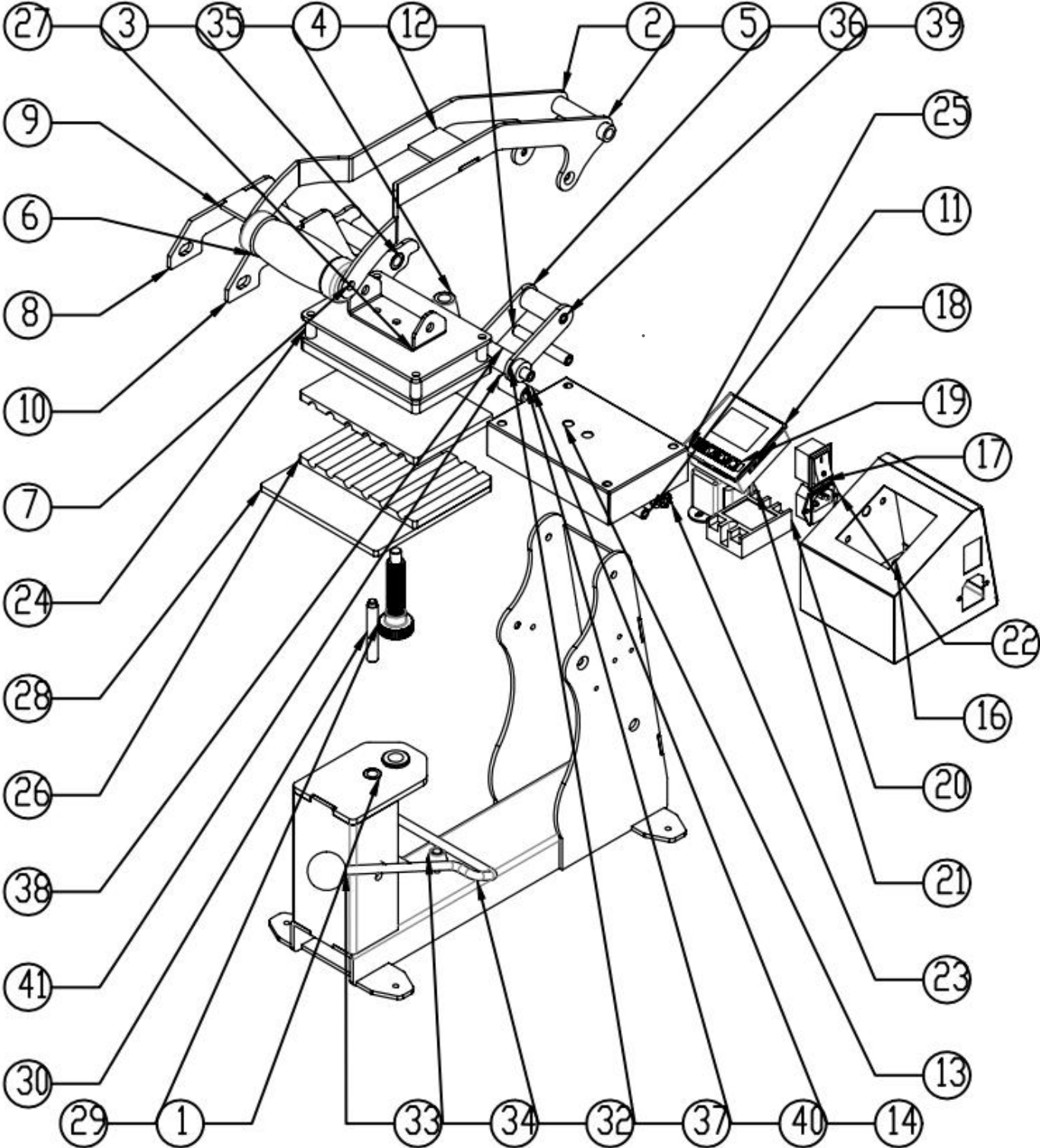

Expanded Diagram

Serial No.	Part Name	Qty		Serial No.	Part Name	Qty
1	Machine Frame Wedling Diagram	1		22	Suffix Power Cord	1
2	Let Lateral Plate of Handle	1		23	Small Faour-Core Aviation Plug	1
3	Handle Sleeve	2		24	Heat Platen Connecting Board	1
4	Limit Spacer	1		25	Heat Platen Cover	1
5	Mirrored Left Lateral Plate of Handle	1		26	Pen Tray Silicon Pad	2
6	Handle	1		27	Cap HEater Connecting Board	1
7	Handle Spindle	1		28	Under Platen	
8	Left and Right Plate of Davit Arm	1		29	Adjusting Screw	1
9	Davit Arm Limit Board	1		30	Positioning Welding Shaft	1
10	Mirrored Left and Rihgt Lateral Place of Davit Arm	2		31	Locating Sleeve of Adjustemnt Screw	1
11	Fixing Bolt of Handle	2		32	Hat Jackstay	1
12	Fixing Bolt of Davit Arm	1		33	Hand Wheel	1
13	Gas Spring Tube	1		34	Machine Feet	1
14	Gas Spring Connector	1		35	Conic Machine Feet	1
15	Gas Spring	1		36	Connecting Board	2
16	Electric Box	1		37	Connecting Board of Distance POM	2
17	prat0155SHY	1		38	Distance Sleeve of Connecting Board	2
18	Case of Digital Controller	1		39	Fixing Bolt of Connecting Board	2
19	Panel of Digital Controller	1		40	Gas Spring POM Bar	2
20	Solid-state Relay	1		41	Gas Spring Shaft	1
21	Transformer	1				

Circuit Diagram

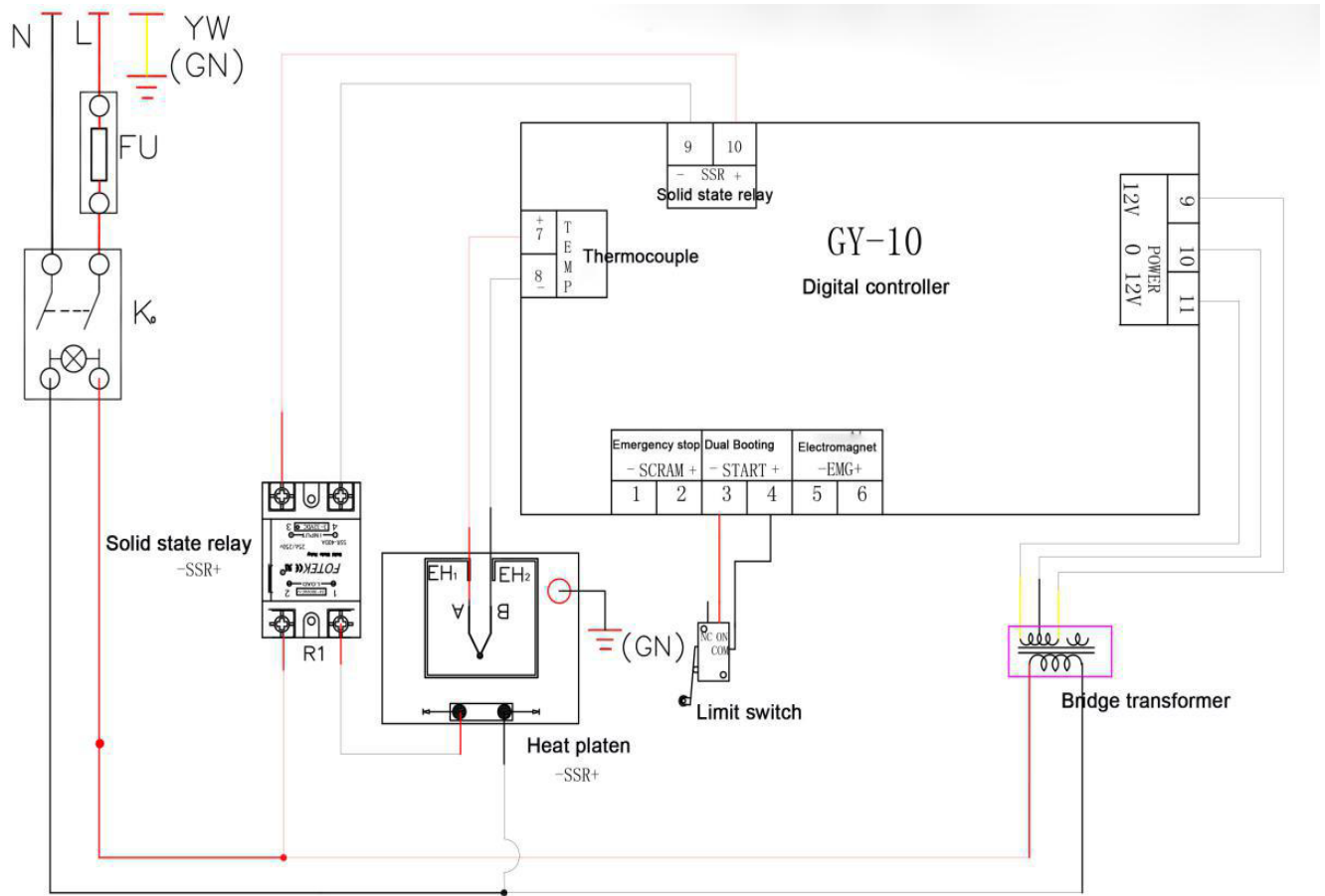

Warranty Statement

Joto warrants to the original purchaser Joto's E-HP-JPP-01 Pen Press or component that such pen press or component is free from defects in materials and workmanship, subject to the limitations set forth below.

IN LIEU OF ALL WARRANTIES, EITHER EXPRESS OR IMPLIED, INCLUDING WITHOUT LIMITATION ANY IMPLIED WARRANTY OF MERCHANTABILITY OR FITNESS FOR A PARTICULAR PURPOSE, WHICH JOTO HEREBY DISCLAIMS, THE OBLIGATIONS OF JOTO UNDER THIS WARRANTY ARE EXPRESSLY LIMITED TO THE FOLLOWING:

- a. Joto will repair or replace at its option, free of charge, any product, component of its products, and any component it sells separately which is installed in Joto's heat presses, within twelve months and six months for the heating element after shipment by same.
- b. This warranty does not apply to damage incurred in shipment. Damage incurred in shipment should be reported to the designated carrier. It is the carrier's responsibility to ensure arrival in undamaged condition.
- c. Service labor, when requested in connection with any of the above items covered by this warranty, will be charged for traveling expenses only.
- d. This warranty applies only if the product or component proves to be defective under conditions of normal use. It does not apply to breakage or to defects resulting from accident, alteration, misuse, or improper installation.
- e. This warranty does not include installation of the product or component.
- f. Prior to any return of a product or component, Buyer must receive written authorization to do so from Joto. After written authorization, Buyer shall return the defective product or component freight prepaid by the original purchaser and Joto will ship the replacement or repaired component freight prepaid by Joto.
- g. This warranty is effective only if the product or component is installed in a location and manner prescribed by JOTO instructions and only if it is maintained in accordance therewith. This warranty shall become ineffective if the product or component is altered by anyone other than JOTO employees. JOTO neither assumes, nor authorizes any person to assume for it, any obligation or liability other than as specified herein.

JOTO WILL IN NO CASE AND UNDER NO CIRCUMSTANCES BE LIABLE FOR SPECIAL OR CONSEQUENTIAL DAMAGES, LOSS OF PROFIT OR COMMISSION, OR FOR LOSS OR DELAY IN PRODUCTION.

Without limiting the generality of the foregoing, Joto will not be liable with respect to furnishing or delay in furnishing any product or component, the use, resale, or other disposition thereof, failure to furnish the same, or any other cause. Joto liability arising out of the supply of any product or component, its use, resale, or other disposition, or out of any guarantee or warranty, express or implied, or any other cause shall in no case exceed the cost to Joto of the product or component which JOTO has agreed to supply. All liability of Joto with respect to any product or component shall terminate upon the expiration of the twelve-month period described above.

-Any controversy or claim arising out of or relating to transactions or orders or breach thereof, including breach of warranty, shall be settled by arbitration in Blaine, Washington, pursuant to the rules of American Arbitration Association. Any award made against Joto shall be limited as provided above. Judgment upon award rendered by arbitration may be entered in any court having jurisdiction thereof. However, at Joto's option, this paragraph shall not apply to collection by Joto of the price of any product sold or any action related thereto.



**PLEASE KEEP THE BOX THAT YOUR PEN PRESS ARRIVED IN,
ALONG WITH ALL ORIGINAL PACKAGING.**

JOTOTM

A red swoosh underline that starts under the 'O' and extends to the right, ending under the 'O'.

Bringing images to lifeTM

www.jotoimagingssupplies.com

Tel: 1-800-565-5686

Fax: 1-800-565-5622

Coquitlam, BC | Brampton, ON

Blaine, WA | Las Vegas, NV | Antioch TN