

C983V01

INSTALLATION INSTRUCTION EZ STEPS

PRODUCT LIST

| PART | DESCRIPTION | QTY | ITEM |
|------|-----------------|-----|---|
| 1 | EZ-Step | 2 |  |
| 2 | Logo Plate | 2 |  |
| 3 | Mounting Screws | 8 |  |

1



Fix the logo plate.

2

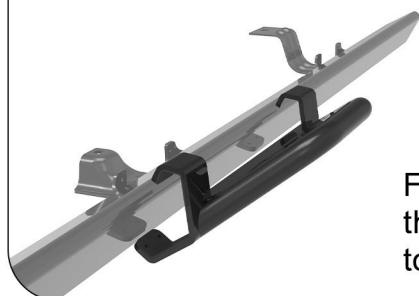

Fix the top first,
then press down
to snap in place.

3



Tighten the screws.

Please feel free to contact seller for any questions.

THANK YOU FOR YOUR SUPPORT.