



LT-230 / COZ HANGER 30

LT-232 / COZ HANGER 32

MANUAL - Ver 1.02

EN

Please be sure to read the manual before using this product. If you have any questions or if there is a problem with the product, please contact the store where you purchased the product or us directly.

## ■ PARTS NAME

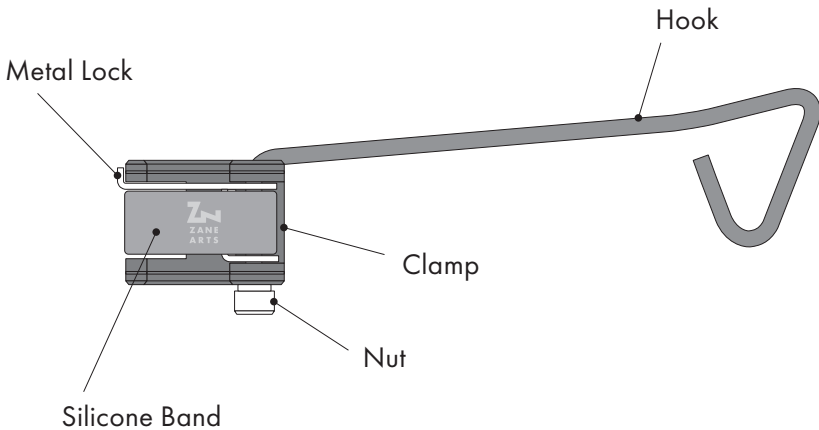

## ■ ABOUT THIS PRODUCT

Please take some time to understand the characteristics of this product before using it.

---

### Maximum Load 2kg

---

The maximum load capacity is 2kg. For fuel-burning lanterns, such as gas or kerosene, the lantern should weigh 2kg or less with fuel.

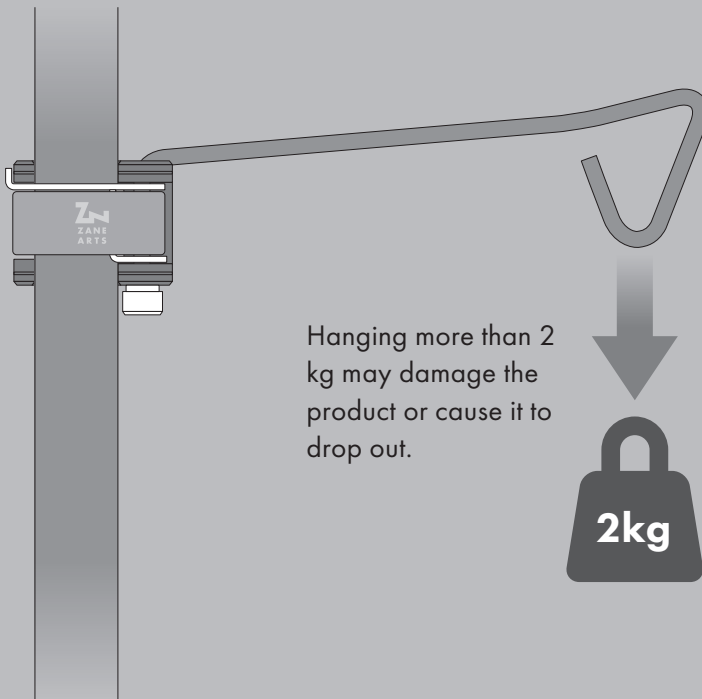

## ■ Handling Precautions

Be sure to read and understand the following contents before use to prevent harm to the user and others, and damage to property.



**DANGER**

---

**INDICATES CONTENT THAT MAY RESULT  
IN DEATH OR SERIOUS INJURY.**

---

- High risk of fire. Never use gas, gasoline, or kerosene lanterns under or near flammable objects such as tents, shelters, tarps, and trees.
- When using this product with gas lanterns, please take extra precaution not to drop the hanger from the pole. The gas lantern may become damaged by the fall, causing fuel to leak and the risk of fire.
- The maximum load capacity is 2kg. For fuel-burning lanterns, such as gas or kerosene, the lantern should weigh 2kg or less with fuel.

- Only attach this product to stable poles. If your poles unstable, please try resetting them, or refrain from using this product.
- Attach to upright poles only. Attaching the hanger to a pole set on an angle is dangerous.
- May slip or not securely attach to wet or oily poles.
- Sand or dirt on the silicone band and clamp may cause the hanger to slip or not securely fix to a pole.
- Do not use in rainy or high wind conditions. There is a higher risk of the hanger falling under such conditions.
- Please use this product with the correct pole size. Use on an incorrect pole size may cause the product to not fasten securely or to become damaged.
- Please confirm that the nut and silicone band are secure before hanging a lantern.
- Remove the lantern when sleeping or when away.
- Please remove your lantern from the hanger before pumping, refueling, or replacing a cartridge.
- Inspect the connecting parts after each use. If any abnormality is found in the product immediately stop using.



---

**INDICATES CONTENT THAT MAY CAUSE  
INJURIES OR PROPERTY DAMAGE.**

---

**WARNING**

- This product is for temporary outdoor use only. Do not install permanently or use in undesignated ways.
- After each use, wipe off any moisture and dry thoroughly before storing. If stored wet or uncleaned the product may corrode.
- Salt accelerates corrosion. When used near the ocean always wash with fresh water and dry thoroughly before storing.
- Please keep out of reach of infants and children.
- Do not modify this product, it may impair its performance.

## ■ SETUP PROCEDURES

### 1 ATTACH TO POLE

A: Check the size on the top of the clamp.

B: Open the silicone band and metal lock.

C: Attach the clamp to the pole.

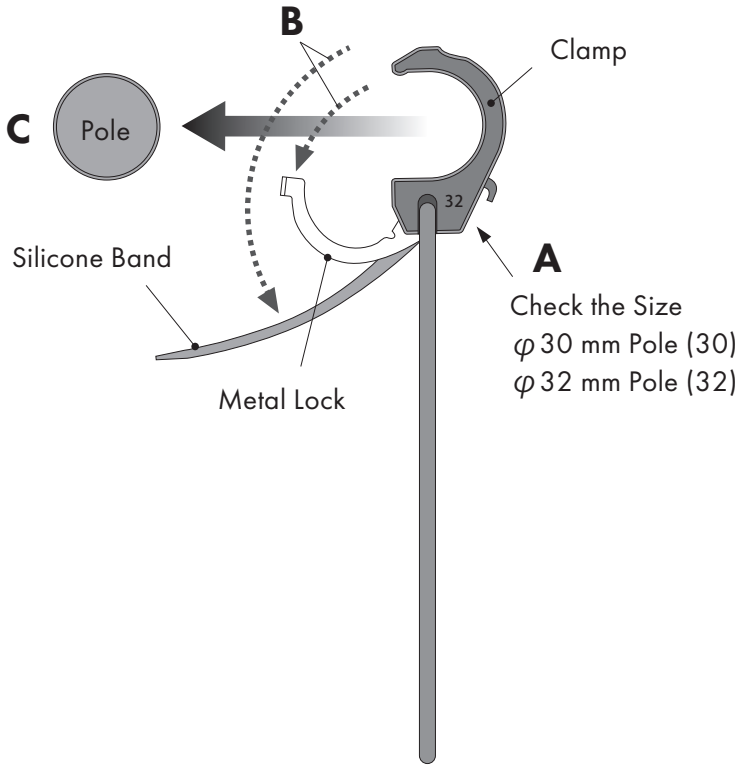
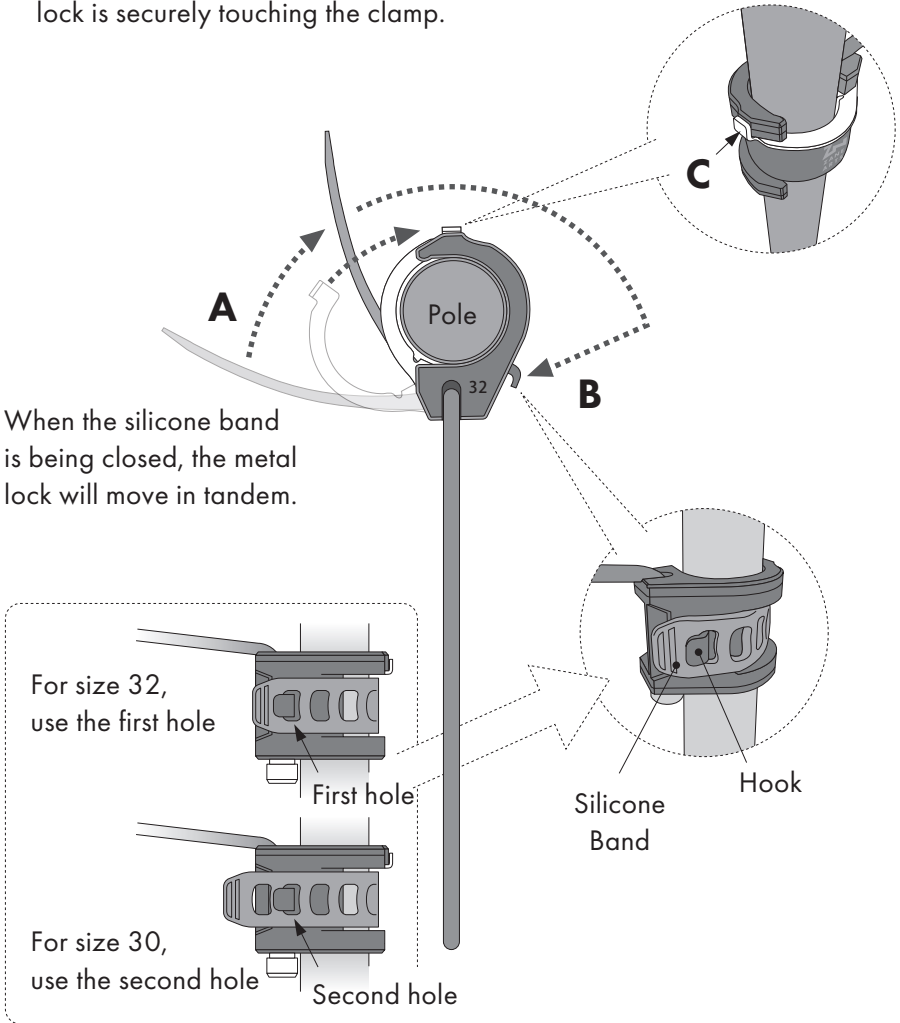

Image of Coz Hanger from above

## 2 FASTEN SILICONE BAND

- A: Wrap the silicone band around the pole.
- B: Lock the silicone band to the hook on the clamp.
- C: Installation is complete when the metal lock is securely touching the clamp.





## ■ PRECAUTIONS DURING REMOVAL

When removing the hanger from the pole, be sure to fully open, not only the silicone band but also the metal clamp.

Removing the hanger while the metal lock is closed may cause the pole to be scratched or the lock to be disfigured.

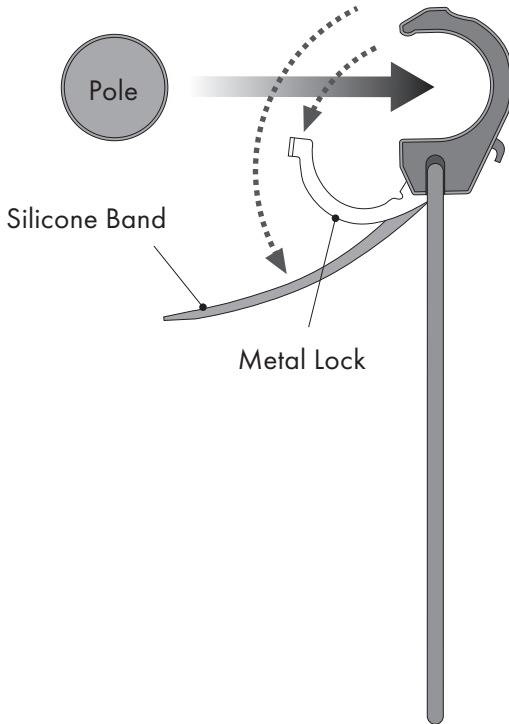

Be sure to open the metal lock before removing.

Image of Coz Hanger from above

## ■ WARRANTY AND REPAIR

If you find any defects in the product, please contact the store where you purchased it or us directly. We will replace or repair any item found to have a manufacturing defect free of charge. We will repair products with damage caused by wear and aging at a reasonable price. Please note that it may be difficult to obtain some materials due to the discontinuation of products and parts, and repairs may not be possible based on the condition of the product.

※ When sending a product for repair, please remove dirt and moisture from the product before sending it. Moisture and dirt may interfere with repairs. Items that are not clean and dry upon arrival for repair will incur additional charges at their own expense for cleaning. Thank you for your understanding.

ZANE ARTS, Inc.

7190-2 Shimauchi, Matsumoto, Nagano 390-0851

info@zanearts.com