

TAB

Product User Manual

Model: T6-Pro

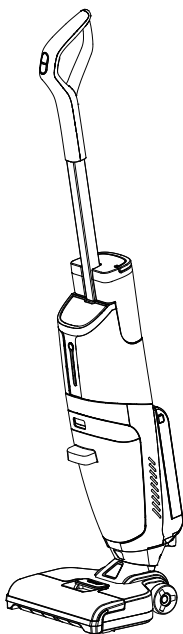

Smart Cordless Wet Dry Vacuum Cleaner and Mop

(Note: Please read this instruction carefully before operation to avoid danger or damage to the product.)



Scan the QR code to get more info.

Contents

1. Safety Instruction	01
2. Packing List	03
3. Packing Icon	04
4. Product Assembly	05
5. How to Use	08
6. Instructions for Icon of Host Screen	11
7. Product Care and Maintenance	12
8. Failure Recovery	14
9. Product Specifications	15

Safety Instructions

Please read the following safety instructions. Make sure all conditions are compliant with the conventional safety precautions before operating the product. Please keep the instructions properly in case of temporary or urgent need. Any inappropriate operation beyond the instructions may cause damage to the product.

Safety precautions related with host and accessories

Cautions:

01. Keep your hands dry or protective during operation in case of electric shock.
02. Operate the product on solid ground instead of high platform of tables, chairs and rooms.
03. Keep the product in shady place in case of damages of the precision electronic equipment.
04. Avoid operation in humid environment, like bathroom.
05. Keep the product away from cigarette butts, lighters and other open flames.
06. Before charging, clean the product first and make sure the charging is disconnected.
07. Remove the battery when it remains unused.
08. In case of damages to the products, make sure the power adapter is connected properly before operation.
09. Remove such items as glasses, lamps, wires and curtains on the ground before operation.
10. Clean the dirty water tank with the product before operation.
11. Cleaning the construction waste is not allowed.
12. Keep the operating temperature range from 0 ° C to 40 ° C.
13. Remove the battery from the machine before scrapping. Do not remove battery before powering off. Please dispose the waste battery safely and environmentally.

Warning:

01. Unauthorized dismantle, repair or modification to the product is strictly prohibited in case of damages or safety risks.
02. Keep the product away from fire in case of explosion.
03. Use the original power adapter only.
04. No standing or sitting on the product in case of product damage or slippery.
05. Wipe metal part of the power plug with a dry rag in case of dust.
06. The AC voltage for power adapter is 100-240V. Place it to somewhere beyond children's reaches.
07. No washing or soaking the host and electronic components.
08. No alteration of the processing power cable, or placing heavy objects on the power cable, or heating the power cable or pulling or bending the power cord.
09. Pay attention to the safety of young children and elders at home to avoid tripping and danger when the product is under operating and cleaning. Touching the wheel and side brush with the hands is not allowed to avoid injury from stranding (Especially, the care to the young children.).
10. No operation outdoor is allowed as it is an indoor product.
11. No contacting the battery with metal and conductive substances, or there will be a risk of short circuit.
12. Children under 8 are not allowed to use the product. Make sure the thorough understanding of the instructions before operation.

Safety Instruction

Safety precautions related to rechargeable battery

Danger!

01. Operating with special battery adapter is highly appreciated. Otherwise, there will be a risk of leakage, heating or cracking.
02. Causing circuit to battery or disassembling the battery is strictly prohibited. Otherwise, there will be a risk of leakage, heating or cracking.
03. Transporting or storing with metal items, including the necklaces and hairpins is strictly prohibited. Otherwise it will lead to short circuit, or causing liquid leakage, heating or cracking.
04. Putting the battery into the fire or heating the battery is strictly prohibited. Otherwise, there will be a risk of leakage, heating or cracking.

Caution!

01. In case of abnormal overheating during charging, you are recommended to stop operating immediately. Otherwise, there will be a risk of leakage, heating or cracking.
02. You are recommended to pull out the battery and place it in a cool and dry environment in case of long time rest, which can prolong the service life of the battery.
03. Immersing in water or contacting with liquid is strictly prohibited. Otherwise, there will be a risk of leakage, heating or cracking.
04. In case of abnormality (including discoloration or deformation), you are recommended to stop operating immediately. Otherwise, there will be a risk of leakage, heating or cracking.
05. You are recommended to apply adhesive tape to insulate the electrode part when recycling or discarding.
06. You are recommended to wipe the battery with a dry rag and recycle it in time or discard it in case of battery's leakage.
07. You are recommended to put the recycled batteries in the battery recycling bins or hazardous garbage cans placed in communities, hotels, schools, large shopping malls, supermarkets, which are collected by professional recycling institutions. The battery must be removed and discarded in accordance with local laws and regulations in case of discarding the product battery.

Warning!

01. You are recommended to wash skin or clothes with clean water immediately in case the battery leakage comes into contact. If failed to handle in time, symptoms of skin inflammation may occur.
02. Applying the rechargeable battery of the product on other equipment is strictly prohibited. The battery is applicable to intelligent floor washer only.
03. Charging or continue to operating is strictly prohibited to avoid that the outer box of the battery is deformed and expanded, and the electrolyte flows out.
04. Strongly impacting or throwing the battery is not allowed. Otherwise, there will be a risk of leakage, heating or cracking.
05. Disassembling to the battery pack is strictly prohibited. Otherwise, there will be a risk of broken battery pack and the electrolyte will flow out, resulting in fire, explosion and other hazards.

Attention:

When first used, the pump is normal to have an odd sound for a few seconds before it actually starts pumping water.

How to remove the battery

You are recommended to hold the key indicated by the arrow in the figure (located at the protruding position on both sides above the battery) tightly with your thumb and index finger. Lift it up with proper force.

(Turn off the power before removing the battery.)

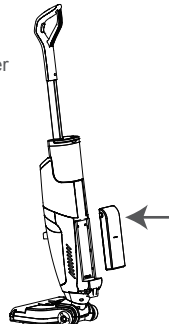

Packing List

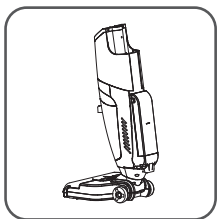

Host

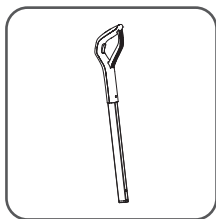

Handle components

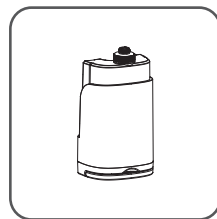

Clean water tank



Charging stand

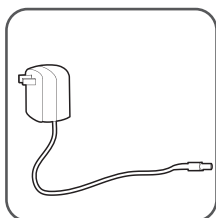

Power adapter

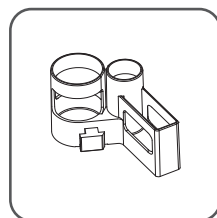

Accessories storage box

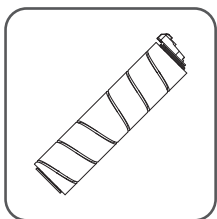

Roller brush

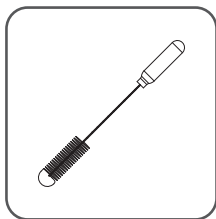

Cleaning tools

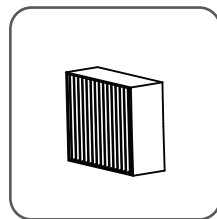

HEPA filter

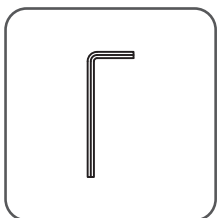

hex key

There might be some differences in the attached accessories, which shall be subject to actual product received.

Packing Icon

Part name

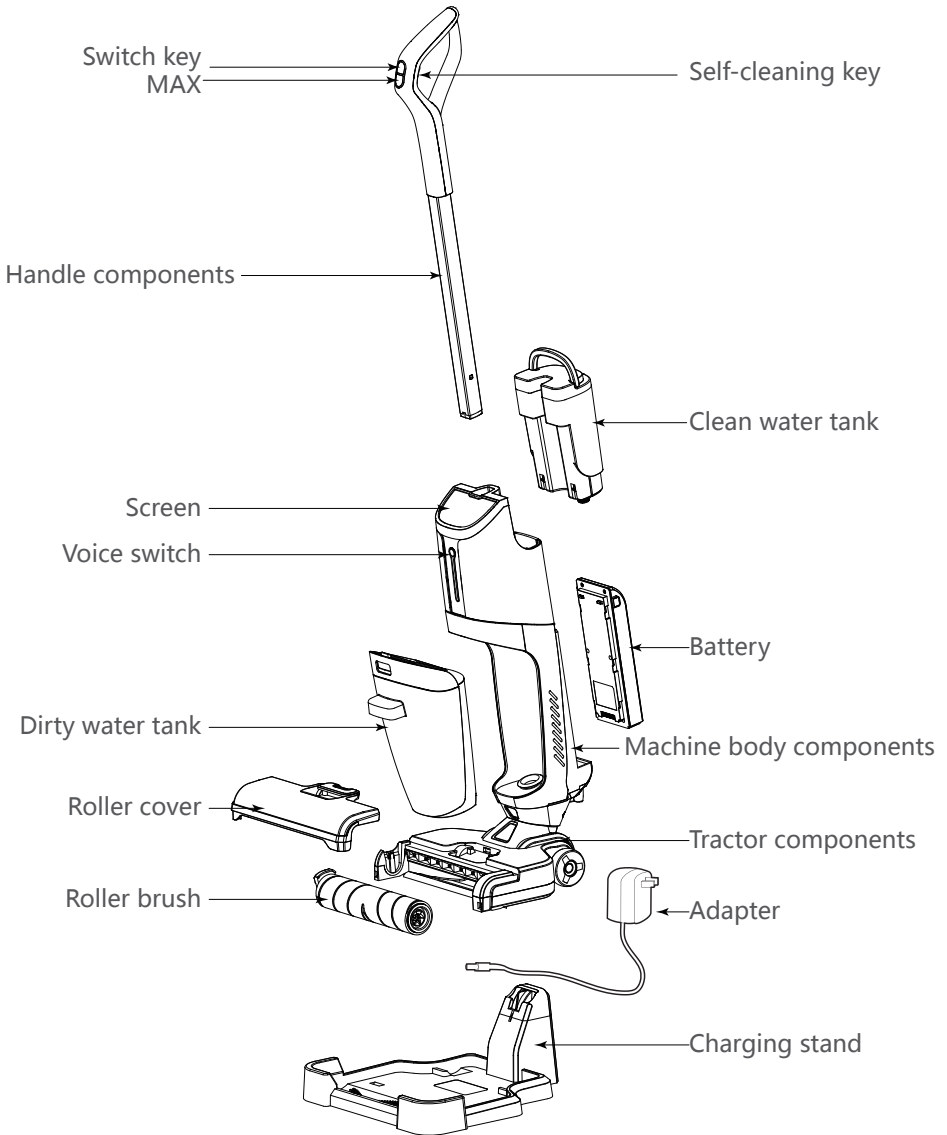

Packing Icon

Tractor components

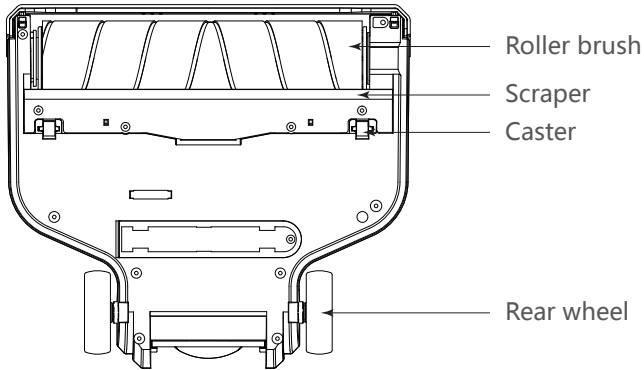

Product Assembly

1. Assembly of Body and Handle Components

As instructed in the Figure, insert the handle component in the top position corresponding to the machine body until you hear a “snap” sound.

When removing, insert the hex key into the snaphole of the body until it reaches the bottom. Please slowly pull out the handle components to be removed by hand at this time.

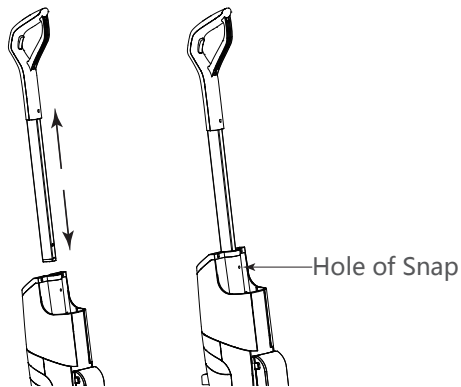

Product Assembly

2.Installation of clean water tank components

Please rotate counterclockwise to open the cover of the clean water tank and add an appropriate amount of clean water, and then rotate clockwise to tighten the cover.

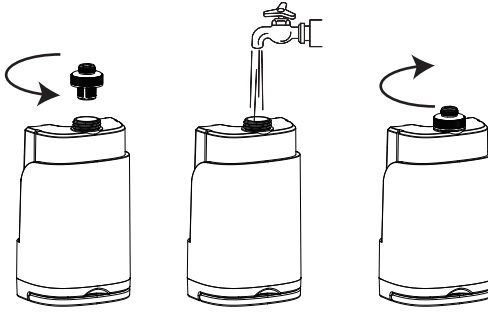

Please plug it in the corresponding position of the body in the direction shown in the figure. There is a snap positioning inside. The assembly shall be completed once you hear the sound of "Click" after plugging in. You can pull up the handle of clean water tank and lift it up slightly to remove the tank.

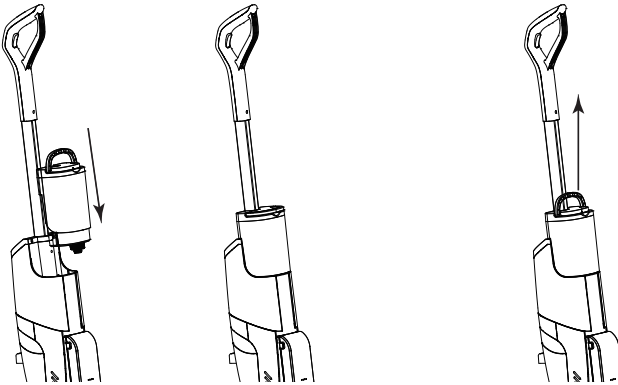

Product Assembly

3.Installation of dirty water tank components

Please plug dirty water tank components into the corresponding position of the body in the direction shown in the figure. There is a snap positioning inside of dirty water tank components. The installation shall be completed once you hear the sound of "Click" after plugging in.

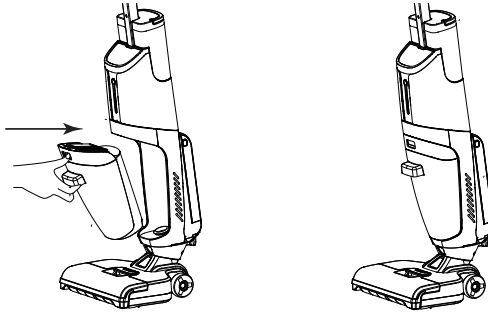

4.Installation of roller brush components

Please plug roller brush components into the corresponding position of the tractor components in the direction shown in the figure. There is a snap positioning inside of roller brush components. The installation shall be completed once you hear the sound of "Click" after plugging in

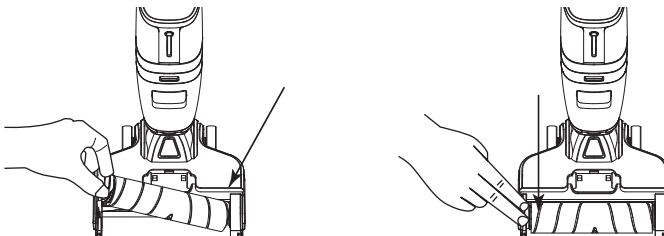

Product Assembly

5. Installation of roller brush cover

Please plug the roller brush cover into corresponding buckle holes at the bottom of both sides of the floor brush components in the direction shown in the figure. The installation shall be completed once you hear the sound of "Click" after plugging in.

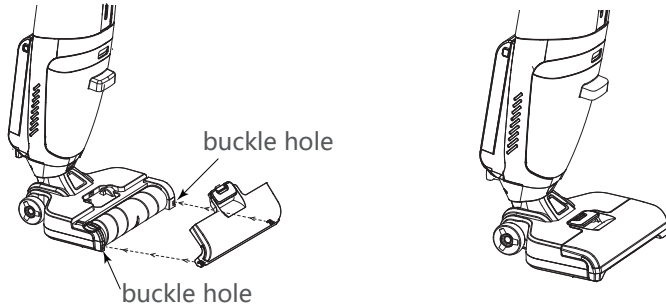

How to Use

*Tip: Please try to complete a complete charging and discharging process before using the product to ensure the accuracy of the electric quantity program.

1. Water injection of clean-water tank

1.1 Pull up the handle of clean water tank and lift it up slightly to remove the tank. (as shown in Figure 1).

1.2 Please rotate counterclockwise to open the cover of the clean water tank and add an appropriate amount of clean water, and then rotate clockwise to tighten the cover. (as shown in Figure 2).

1.3 Plug the tank in the corresponding position of the body. The assembly shall be completed once you hear the sound of "Click" after plugging in.(as shown in Figure 3).

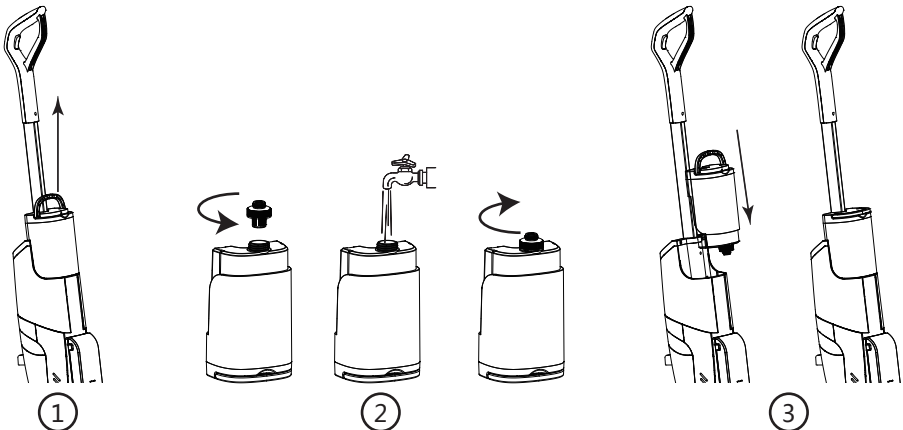

How to Use

Note:

- Please do not add non-designated cleanser or disinfectant to avoid corrosion of the machine.
- Please add special cleanser according to the specified proportion, and do not add too much.
- Please do not add hot water over 60°C to avoid deformation of the clean-water tank.

2.Start using

2.1 Step on the upper cover of the floor brush, tilt the machine body to a suitable angle. When pressing "Switch Key" for 2 seconds, machine starts cleaning. When pressing "Switch Key" again, the machine will be powered off.

2.2 Please do not put the machine body flat or dump it to avoid dirty water flowing out.

3.Switch mode

3.1 Start the automatic mode by default, and press the mode button to adjust the mode (auto mode, max mode).

3.2 The default of machine is always discharging water. Press the "Self-Cleaning" key, machine will stop discharging water, accompanying by the voice prompt "Turn off the water output" . Press the "Self-Cleaning" key again, machine will start to discharge water, accompanying by the voice prompt "Turn on the water output" .

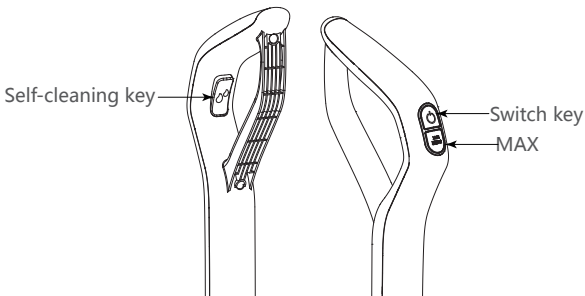

4.Water adding and pouring

During use, when the clean water in the clean-water tank runs out, the machine will prompt by voice and screen: "The water bucket is empty please add water" . At this time, it is necessary to turn off the switch and add clean water. When the amount of water in the dirty-water tank reaches the upper limit, the floor scrubber will automatically stop and prompt by voice and screen: "Please clean the sewage bucket to avoid smell" . At this time, it is necessary to dump the sewage in the dirty-water tank before continuing to use it.

How to Use

5. Dump the dirty-water tank

5.1 Hold down the button for disassembling the dirty-water tank and remove the dirty-water tank. (as shown in Figure 1)

5.2 Hold the handle of the dirty-water tank with one hand, and gently pull out the dirty-water tank cover with the other hand. (as shown in Figure 2)

5.3 After the sewage is poured out, install the dirty-water tank back to the machine body, and it is successfully installed after hearing the click sound.

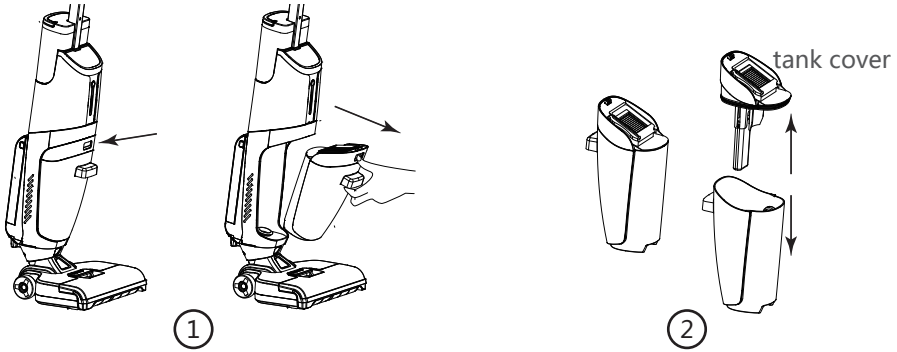

6. Charging and self-cleaning

Lift the machine vertically, put it into the charging base, and hear the voice prompt "Charging", which means that it is in place.

1) Put the floor scrubber into the charging base for charging, and ensure that there is more clean water in the clean-water tank. Press the self-cleaning button at the top of the handle to start self-cleaning, which takes about 80 seconds.

Tips:

1. The "self-cleaning function" can only be selected when it is under charging.
2. To avoid odor, please clean the dirty tank after use and place the roller brush on the charging dock to dry.
3. It is recommended to self-clean after each use.

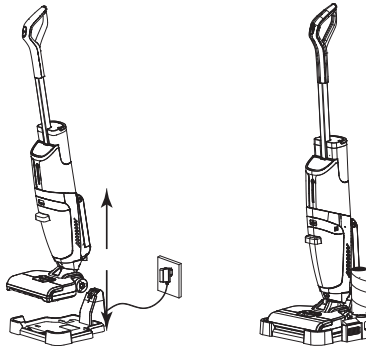

How to Use

7.Voice closing/opening

Press the voice button briefly to turn off/on the voice reminding function.

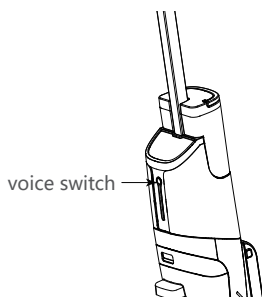

Instructions for Icon of Host Screen

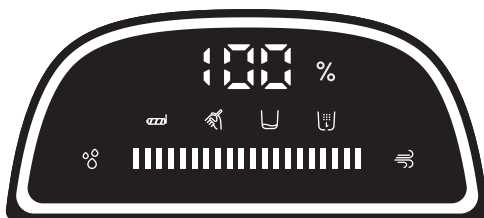

Icon of battery power: The power is displayed in range of "0" to "100" , where "0" means the machine is out of power, while "100" means full power. Normal lighting means working, and flashing means charging.



Icon of self-cleaning: after completing the self-cleaning mode, the icon flashes, reminding to perform the self-cleaning. When the machine is placed on the base and the power of machine is greater than 30%, please press the "Self-cleaning Key" . Afterwards, the icon lights up, indicating that the machine enters self-cleaning mode (the self-cleaning will take 80s in total).



Icon of roller brush winding: In case the roller brush is no installed, or be stuck or entangled, there will be a voice prompt "Please install the roller brush" or "Please check whether the roller brush is entangled" , and the icon of "Roller Brush Winding" lights up.

Instructions for Icon of Host Screen



Icon of water shortage of clean water tank: In case the clean water tank is short of water, the icon of "Water shortage" will flash on the machine interface, and there will be a voice prompt "water shortage". When refilling with water and restarting cleaning, the icon of "water shortage" on the machine interface will be vanished.



Icon of full dirty water tank: when the amount of dirty water tank reaches the warning level, the icon of "Full dirty water tank" will light up and the machine will stop, as well as the voice prompt "Please clean the dirty water tank" will be released. When the cleaning is restarted after cleaning the dirty water tank, the icon of "Full dirty water tank" will be disappeared.



Icon of wet mode: when turning on wet mode, the icon will light up and the machine will start to discharge water.



Icon of dry mode: when turning on dry mode, the water outlet will be turned off upon the lighting-up of the icon.



Icon of suction amount of fan: when turning on energy saving mode, some of the grids will be lighted up. When turning on strong mode, all of the grids will be lighted up, representing the high suction mode.



Icon of light ring: The blue light will be on by default. When charging, the effect will be displayed dynamically according to the charging condition.

Product Care and Maintenance

1.Product care and maintenance

1.1 Please be sure to use the original parts, or you may not enjoy the warranty service.

1.2 If this product is not used for a long time, please unplug the power adapter after being fully charged and put it in a cool and dry place, and do not put it in direct sunlight or humid environment. Charge at least once every 3 months to avoid overdischarge of the battery.

2.Cleaning of the main unit

Wipe and clean the main unit with a soft dry cloth. Before cleaning, please disconnect the power adapter and ensure that the main unit stops working.

Product Care and Maintenance

3. Cleaning of dirty-water tank and filter screen

- 3.1 Remove the dirty-water tank, pull out the dirty-water tank cover, and take out the filter frame inside of dirty water tank slowly and clean up the solid waste inside of filter frame.
- 3.2 Brush the dirt on the dirty-water tank, dirty-water tank cover, filter, and filter frame with the attached cleaning tools, and rinse it with cold water.
- 3.3 Dry all parts thoroughly and put them back.

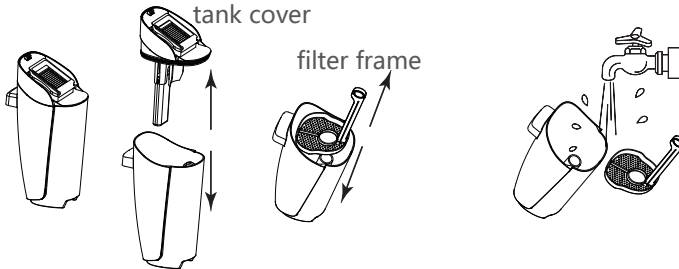

* Tips:

- 1) It is recommended to replace the filter screen once every six months.
- 2) It takes a long time for the filter screens to dry, and two filters can be used alternately.
- 3) It is forbidden to touch the surface of the filter screen with hands, brushes or sharp objects to avoid damaging the filter screen.

4. Cleaning of dirty water pipes

Please remove the dirty-water tank, wipe the dirt in the pipe with a wet rag, and clean the rolling brush tank and dirty water pipe with cleaning tools before using it.

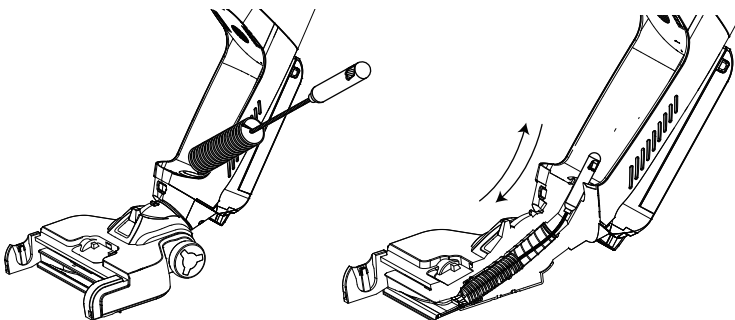

Failure Recovery

Common failure	Possible reason	Solution
Main unit does not work	Handle not installed in place	Please reinstall to ensure that it is in place before use
	The main unit has no power or insufficient power	Please fully charge the main unit before using it
	The rolling brush is not installed in place/the rolling brush is entangled with hair and stops rotating	Reinstall or clean the rolling brush
	Dirty-water tank is not installed in place	Reinstall the dirty-water tank
	Dirty-water tank is full	Dump the dirty water in the dirty-water tank before use
Machine suction is weakened	Filter element blockage	Please clean the filter element
	Rolling brush cover, filter element and clean-water tank are not installed in place.	Confirm whether it is installed in place before use
	The rolling brush is entangled with hair	Remove the winding of the rolling brush before use
	Foreign matter or blockage in the pipeline	Please clean the pipeline
There is abnormal noise in motor operation	Excessive dirty water in the dirty-water tank	Dump the dirty water in the dirty-water tank before use
	The suction port is blocked	Clear the obstacles in the suction port
When charging, the screen power prompt icon is not displayed	The power adapter is not connected to a power socket	Check whether the power adapter is plugged in
	The connection between the power adapter and the charging base is not in place	Check whether it is in good connection
	The docking between the main unit and the charging base is not in place	Please confirm that the main unit is placed correctly
No water from the main unit	Clean-water tank is not installed in place/clean-water tank is short of water	Reinstall or add water to the clean-water tank
Water leakage from air outlet	The filter element is not dried after cleaning	After cleaning, make sure to dry it before use
Self-cleaning does not work	The rolling brush may get stuck by large particles	Open the rolling brush cover for inspection and cleaning
	The machine is not charging	Ensure that the main unit starts the self-cleaning function again when it is in the charging state
	The power of the machine is less than 10% and cannot start self-cleaning	In the charging state, start the self-cleaning function when the power is greater than 10%
	Dirty-water tank is not installed in place/dirty-water tank is full of water	Reinstall or dispose of the dirty-water tank

Product Specifications

Product specification	
Rated voltage	DC 25.2V
Overall power	255W
Adapter parameters	29.5V \approx 1A
Battery capacity	3800mAh
Working hours (regular mode)	\geq 45min
Working time (maximum suction mode)	\geq 15min
Charging time	240min
Effective capacity of dirty water tank	700ml
Capacity of clean water tank	900ml
Net weight of product	5.2Kg
Size of product	330(l) x 350(w) x 1,190(h) (Unit: mm)

Official website URL : www.tabhome.com
Customer Service Email : service@tabhome.com