



Thermostatic Radiator Steam Traps Series TA

Operation:

Tunstall Associates, Inc. produces a complete line of thermostatic radiator steam traps with ratings up to 125 psi. Each unit is tested and inspected before leaving the factory guaranteeing years of trouble free service. All units are "normally open" to expel air and water and will "close" at saturated steam temperature thereby preventing steam entering into condensate return lines. Each Tunstall Steam Trap features the Tunstall Capsule® which has become the best steam trap replacement bellows available today.



Features:

Chrome-plated heavy duty forged brass

TIG welded stainless steel Tunstall Capsule® with balanced pressure stainless steel bellows

Calibrated, inspected and tested

Ratings from 25" Hg vacuum to 125 psi

Available in 1/2" & 3/4" straight or angle, 1/2" x 3/4" angle, 1/2" vertical and 1" angle patterns

Benefits:

Simple installation

Corrosion resistant stainless steel internals

Extended life on low pressure applications



Series TA Engineering Specifications

CAPACITIES*

			DIFFERENTIAL PRESSURE (PSI)									
			Square Feet EDR **							lbs Condensate per hour ***		
Model	Size NPT	PSIG Orifice	1/2	1	1-1/2	2	5	10	25	50	75	125
TA-1/2-A	1/2"	16-May	120	165	200	230	320	500	825	1400	1700	1950
TA-3/4-A	3/4"	16-May	230	330	400	465	730	1050	1700	2375	2680	3300
TA-1-A	1"	1/4	430	590	700	760	1200	1750	4100	4050	4700	5500
TA-1/2x3/4-A	1/2"x3/4"	16-May	230	330	400	465	730	1050	1700	2375	2680	3300
TA-1/2-S	1/2"	16-May	120	165	200	230	320	500	825	1400	1700	1950
TA-3/4-S	3/4"	16-May	230	330	400	465	730	1050	1700	2375	2680	3300
TA-1/2-V	1/2"	16-May	120	165	200	230	320	500	825	1400	1700	1950

*Ratings are in accordance with standards established by The Steam Heating Manufacturers Association (SHEMA). No safety factor required.

**To convert Square Feet EDR to pounds of condensate per hour: Divide the square foot ratings by 4.

One Square foot EDR is equivalent to net emission of 240 BTU per hour with 215°F steam in the radiator surrounded by 70°F air temperature.

***Basic ratings for trap pressures greater than 25 psi are given in lbs of condensate per hour.

One pound of condensate is equivalent to approximately 1000 BTU, 1000 BTU is equivalent to approximately 4 square feet EDR.

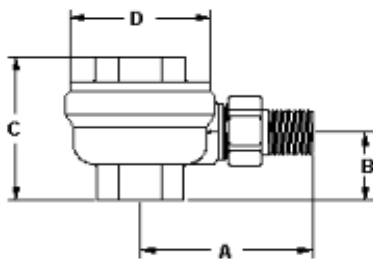

Angle Pattern (A)

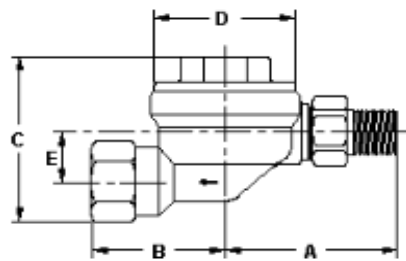

Straight Pattern (S)

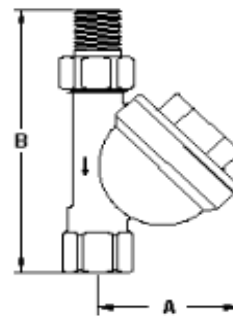

Vertical Pattern (V)

Model No.	Pipe Size	A	B	C	D	E	Weight
TA-1/2-A	1/2" Angle	3	1.25	2.57	2.56	--	1.75 lbs
TA-3/4-A	3/4" Angle	3.38	1.37	2.87	2.56	--	1.84 lbs
TA-1-A	1" Angle	4.13	2	4.12	2.08	--	2.50 lbs
TA-1/2-S	1/2" Straight	3	2.15	3	2.5	1	1.94 lbs
	3/4" Straight	3.38	2.15	3	2.5	1	2.05 lbs
TA-1/2x3/4-A	1/2"x3/4" Angle	3.38	1.25	2.57	2.56	--	1.75 lbs
TA-1/2-V	1/2" Vertical	2.5	4.85	--	--	--	1.65 lbs