

AMBIUS

Microwave Sensor Ceiling Light

Dual Power



3000K

4000K

ACL12-25W2TMIC Q5040460



1200/2500
LUMENS



IP65



IK10

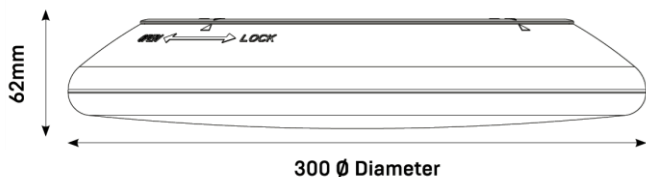

EASY INSTALLATION

Two Power settings:
12W & 25W

3K, 4K
Switch

Removable
Terminal Block

Convenient
Twist on
Mounting Plate

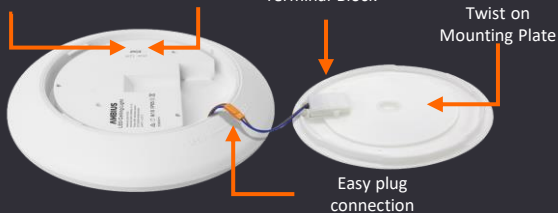

Easy plug
connection

LUMINAIRE SPECIFICATION:

Model.....	ACL12-25W2TMIC
Impact resistance.....	IK10
Microwave Sensor.....	Included
Beam Angle	120 degrees
Lumens.....	1200Lm/2500Lm
Wattage	12W/25W
IP Rating.....	IP65
Colour temperature.....	Switchable 3000K/4000K
Input Voltage.....	220-240 Volts ~ 50/60Hz
Mounting Type.....	Surface Mounted

This light has been designed for quick and simple installation. The fitting comes with a full base plate for separate ease of fixing. The centrally located cable entry, along with easy clip in terminal block, makes for convenient termination. The light then simply plugs into the terminal and twist locks onto the base .

DUAL LUMENS

This light comes with an easily accessible switch so it can be either 1200 lumens (12W) or 2500 lumens (25W)

2 COLOR TEMPERATURES

This light comes with an easily accessible switch so it can be either 3000k or 4000k.

MASTER / SLAVE FUNCTION

This fitting can be used as a master sensor light to run up to 300W of non sensor lights.

OPTIONAL CONDUIT BASE MOUNT

This Conduit base is compatible with all the models in this range. The IP65 base comes complete with both 20mm & 25mm 'pre-threaded' entry points for conduit.



MICROWAVE SENSOR

Sensor provides several combinations using dip switches.

SETTINGS:

- 4 settings for detection range
- 4 settings for Full lumen
- 4 settings for low lumen
- 4 settings for lux

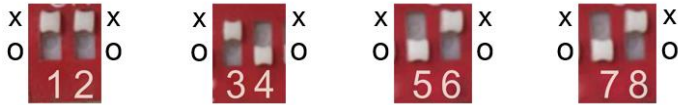

	1	2	3	4	5	6	7	8	
6-8m	X	X	30s	X	X	30s	<10Lux	X	X
4-6m	O	X	3min	O	X	3min	<30Lux	O	X
2-4m	X	O	5min	X	O	5min	<50Lux	X	O
Sensor off	O	O	10min	O	O	10min	Always	O	O
	Detection range		Full lumen		Low lumen		Lux		

FULL LUMEN / LOW LUMEN

This light will activate at full lumen output upon detection of any movement and then switch to a lower lumen mode with only 10% of its full lumen output. If movement is detected again it will activate to full lumen mode again.

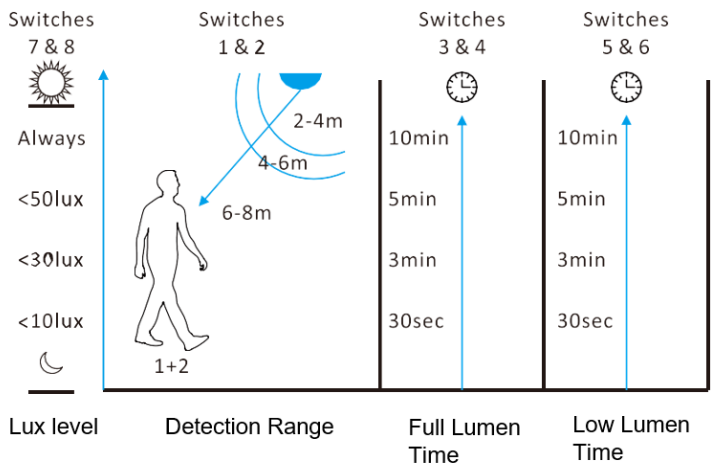

WIRING OPTIONS FOR MASTER SLAVE (Examples)

1. Function A

(One Master Light and Multiple Slave Lights)

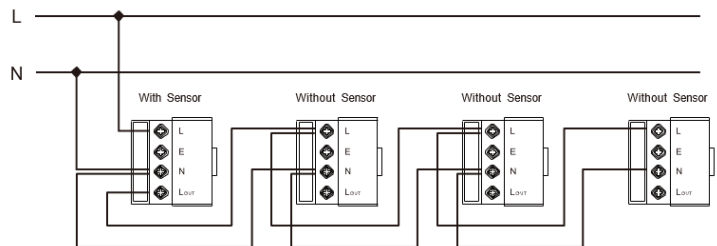

2. Function B

(Two Master Lights and Multiple Slave lights)

