

# FUTUR LIVING

## HOT & COLD WATER PURIFIER

FTL-001



---

## CONTENTS

---

Before Use	Points to Note Before Installation Safety Warnings & Precautions
------------	---

---

During Use	Water Purifier Parts and Accessories Water Piping Overview Water Purifier Features
------------	--

---

Maintenance	Water Filters and Replacement Steps Specification
-------------	--

## Points to Note Before Installation

---

- 01 Please open the raw water supply valve.
- 02 Please check if 220-240V / 50-60Hz is available.
- 03 Please check if the display lamp in the water purifier unit is working.

## Points to Note

---

- 01 Please open the raw water supply valve. The water purifier operates normally only when raw water is supplied.
- 02 Do not use purified water for humidifiers or fish tanks. If purified water is left unattended for a long time, bacteria can proliferate.
- 03 Please ensure that the top cover of Star Water Purifier is closed at all times, as foreign substance may enter.
- 04 When the water purifier is powered on for the first time, the first cup of water being dispensed will directly be purified water.
- 05 When the water purifier is not in use for more than 24 hours, water being dispensed may have bubbles appearing. This happens due to the air pockets within filters, especially for a fresh set of filters. This is not a filter abnormality.
- 06 Make sure to replace the filter on a regular basis. If the filter is used beyond its life span, the water purifier's performance may deteriorate.
- 07 Recooling time is required when more than 1litre of cold water is dispensed.

- 08 Heating noise may occur during hot water discharge.
- 09 The appliance is not intended for use by persons (including children) with reduced physical, sensory or mental capabilities, or lack of experience and knowledge, unless they have been given supervision or instruction concerning the use of the appliance by a person responsible for their safety.
- 10 Children should be supervised to ensure that they do not play with the appliance.
- 11 If the supply cord is damaged, it must be replaced by the manufacturer, its service agent or similarly qualified persons in order to avoid a hazard.
- 12 The water inlet of this appliance shall not be connected to inlet water obtained from any other water heating system.

## SAFETY WARNINGS & PRECAUTIONS

---

| The following instructions are intended to prevent unexpected risks or damage

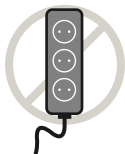

Use it by inserting it into a wall-only socket. Do not insert multiple electrical appliances into one outlet at the same time. There is a risk of electric shock and fire.



Do not use damaged or loose power plugs or outlets. There is a risk of electric shock and fire.



Do not bend the power cord excessively or press it against heavy objects to damage or deform. There is a risk of electric shock and fire.



Do not touch the power cord with wet hands. There is a risk of electric shock.



When water enters the power supply, remove the plug and dry it completely before using it. There is a risk of electric shock and fire.



Insert the power cord properly to the inside of the power outlet. Otherwise, it can cause a fire.



Do not arbitrarily process the power cord and connect it if damaged. It can cause a fire.



Do not use this product except 220-240v. It causes electric shock and fire.



Do not install it near flammable materials, in snowy or rainy places, and in humid places. There is a risk of electric shock and fire.



Do not install it in a place where the ambient temperature is less than 5 degrees Celsius. It causes poor performance and failure.



Do not install it on sloping or unstable places. It causes poor performance and failure.



Do not supply water above 35°C to the product. Causes failure and poor performance.



Connect the inlet/outlet pipes correctly. When the inlet/outlet pipe is switched and plugged in, it cannot operate, and an error occurs.

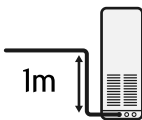

Install the drain line where no bend, press, or clog, and the height should not exceed 1M. It causes failure and abnormal operation.



Do not arbitrarily open, modify, or repair the product. There is a risk of product damage and electric shock.

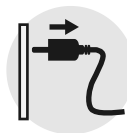

Make sure to remove the power plug when cleaning. There is a risk of electric shock and fire.

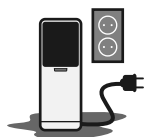

If water flows out of the product or water accumulates around it, remove the power plug, lock the raw water supply valve, and contact the service center. There is a risk of electric shock.

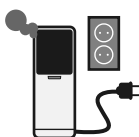

If the product smells burning, smokes, or makes a strange sound, remove the plug and contact the service center. There is a risk of electric shock.



Hot water is very hot, so be careful not to touch your body directly. There is a risk of burns.



Avoid children using hot water and use the hot water lock function if necessary. There is a risk of burns.



Don't put water-filled bowls or medicines on top of the product. There is a risk of electric shock or fire.



Do not put hot items such as pots or candles on the product. There is a risk of fire.



Do not spray water to clean or wipe the product using benzene, sinna, etc. There is a risk of electric shock and fire.



Make sure to connect the drain line so that water does not overflow.



Please replace the filters as per the exchange cycle to drink clean water. If you use a filter that is out of life, the water purification performance decreases.



Don't apply shock or excessive force to the product. There is a risk of product damage.



Use it in an environment where water vapor does not directly touch the product. It can cause malfunction and failure.



# WATER PURIFIER PARTS & ACCESSORIES

## Parts

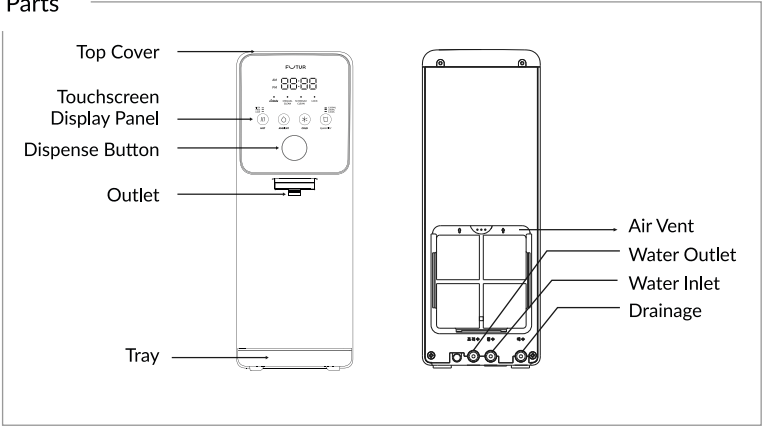

## Accessories

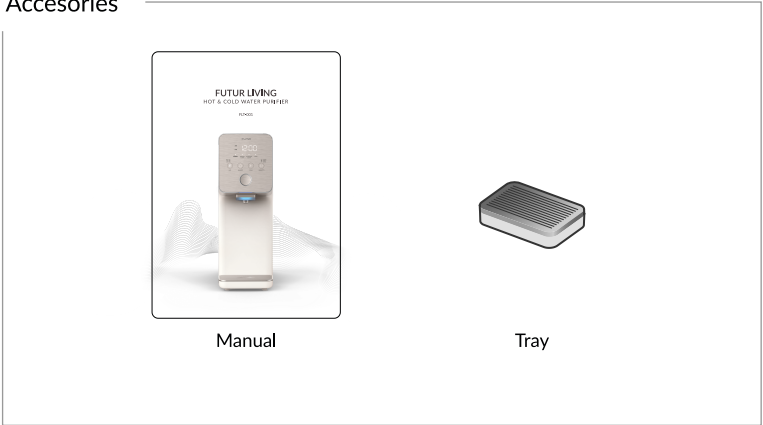

# WATER PIPING

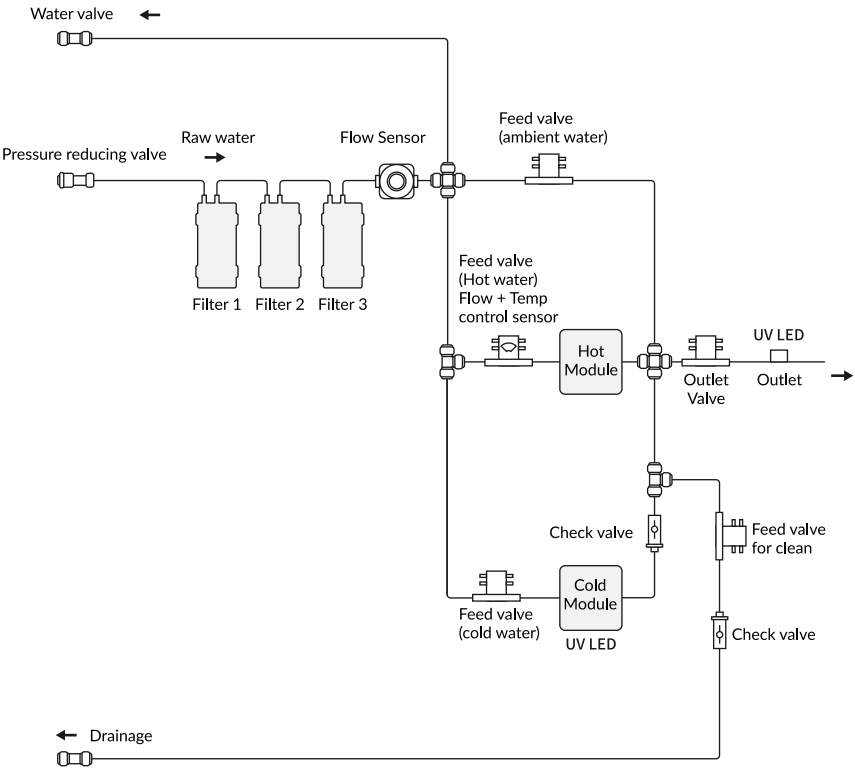

# WATER PURIFIER FEATURES

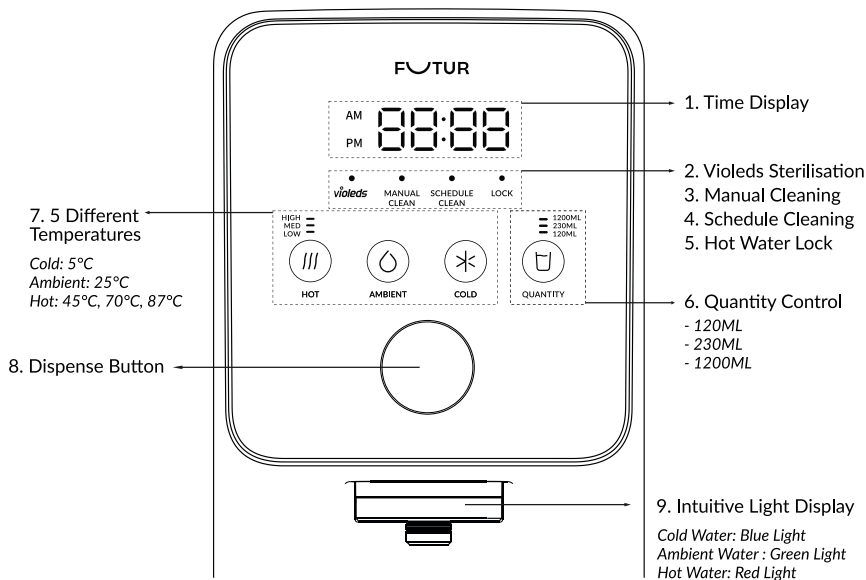

## 1. TIME DISPLAY

AM 00:00  
PM 00:00

This displays the time in your residing country.

To make adjustments to Time Display, please press and hold the Violets Button for 3 Seconds. Navigate with the "Cold" and "Quantity" buttons to adjust time.

Once done, press and hold Violets Button for 3 seconds to exit the setting.

## 2. VIOLEDS STERILISATION



This button has 3 functions:

### 1. Violeds Sterilisation

When the LED light blinks, the unit is undergoing Violeds Sterilisation.

### 2. Check Water Filter's Remaining Lifespan

Each set of filters is due for a change after 2,000 liters of water has been dispensed. Star Water Purifier has a filter lifespan indicator to show users the remaining water quantity with the existing filter.

Simply press and hold "Violeds" button for 1 second to see the remaining water quantity.

### 3. Adjustment to Time Display

To make adjustments to Time Display, please press and hold the "Violeds" Button for 3 seconds. Navigate with the "Cold" and "Quantity" buttons to adjust time.

Once done, press and hold "Violeds" Button for 3 seconds to exit the setting.

---

## 3. MANUAL CLEANING (HIGH-SPEED FLUSHING)



Press and hold for 5 seconds to activate pressurized flushing of the internal system at high velocity with purified water.

Cleaning takes about 3-5 minutes for completion.

## 4. SCHEDULE CLEANING (HIGH SPEED FLUSHING)

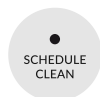

Choose to schedule your preferred time for pressurised flushing of the internal system daily.

This button houses 2 functions:

### **1. Schedule your Preferred Time for Daily Cleaning**

Please press and hold for 6 seconds to schedule the preferred time of cleaning.

Navigate with the “Cold” and “Quantity” buttons to adjust the time.

Once done, press and hold the “Schedule Clean” button for 6 seconds to exit the setting.

### **2. Deactivate Schedule Clean Function**

For users who prefer to manually trigger this cleaning feature, simply turn the schedule clean feature off. Please press and hold for 3 seconds to turn off the schedule clean feature.

You can still be able to access manual cleaning via “Manual Clean” button.

---

## 5. HOT WATER LOCK



Press and hold the button for 3 seconds to lock the hot water feature.

This can prevent accidental burns, and ensure that it's safe for child use.

## 6. QUANTITY CONTROL



We provide 3 preset quantity selections for users who prefer a fixed quantity - 120ML, 230ML, 1200ML.

Tap on the button to select the desired amount of water to be dispensed.

- Tap once to get 120ML
- Tap twice to get 230ML
- Tap thrice to get 1200ML

---

## 7. 5 DIFFERENT TEMPERATURES



### Hot Water (45°C, 70°C, 87°C)

Tap on button to select desired temperature for hot water.

- Tap once to get 45°C
- Tap twice to get 70°C
- Tap thrice to get 87°C



### Ambient Water (25°C)

Tap on button to select ambient water.



### Cold Water (5°C)

Tap on the button to select cold water.

To deactivate cold water function, please press and hold "Cold" Button for 8 seconds.

## 8. DISPENSE BUTTON

Please press this button to dispense water, or to stop dispensing water.

## 9. INTUITIVE LIGHT DISPLAY

When selecting different temperature settings, the intuitive light display will also change accordingly, serving as a visual cue.

- When Cold Water is selected, the light display will be in Blue.
- When Ambient Water is selected, the light display will be in Green.
- When Hot Water is selected, the light display will be in Red.

# WATER FILTERS & REPLACEMENT STEPS

## 1. FILTER INFORMATION

Star Water Purifier works with 3 filters to provide comprehensive 8-stage water filtration. Do refer to the below table to each filter and its information.

	Pre Multi Carbon Filter	KX Nano-Fact Filter	Post Silver Carbon Filter <i>(Alkaline/Non-Alkaline Option Available)</i>
Change Cycle	6 months	6 months	6 months
Materials	Sediment, Carbon block	Cellulose, Carbon	Silver compressed activated carbon
Function	Removes rust, dirt, residual chlorine, volatile organic compounds	Removes norovirus & harmful organisms down to 0.001 micron	Volative organic compounds. Adding in natural minerals <i>(*alkaline and non-alkaline option available)</i>

## 2. FILTER CHANGE INDICATOR

Each set of filters is due for a change after 2,000 liters of water is being dispensed to ensure good water quality. The Star Water Purifier has a built-in Filter Change Indicator which has the following features.

- **Informs User When a Change of Filter is Due**

After 2,000 liters of water has been dispensed, the filter is due for a change.

The “Ambient” Button LED will start to blink, and there will be a sound signal for the first time it alerts you. Subsequently, only the “Ambient” Button will remain blinking, indicating that filters need to be changed. You will still be able to dispense water normally despite the blinking “Ambient” Button.

Please note to replace the filter as per the stipulated change cycle. When a filter is used longer than its intended lifespan, it can reduce and compromise the water quality.

*Do refer to the next few pages for the step-by-step guide on filter changing, and what to do after the filter has been changed. If you require any help, do contact our customer service team at [support@futurliving.com.sg](mailto:support@futurliving.com.sg)*

- **Allows User to Check Remaining Filter**

Star Water Purifier has a filter lifespan indicator to show users the remaining water quantity with the existing filter. Simply press and hold “Violeds” button for 1 second to see the remaining water quantity.

- **Reset Filter Change Indicator**

After you have changed the filter, press and hold the “Ambient” & “Violeds” Button at the same time for 5 seconds to activate filter flushing and reset the filter indicator.

Do kindly note that this will also activate the filter flushing function, which helps to do a flush of new filters. Water discharged will be expelled from the system via water outlet/drainage.



### 3. STEP-BY-STEP GUIDE ON FILTER REPLACEMENT

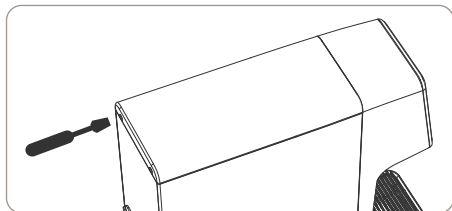

#### Step 1:

Please remove the bolt that secures the filter cover with a screwdriver.

*Screwdrivers are provided in our complimentary filter-changing kit.*

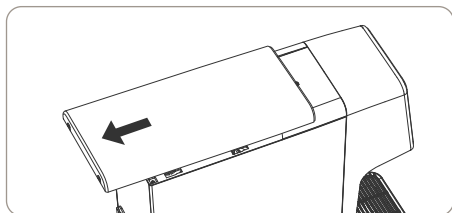

#### Step 2:

Slide top-cover out in the direction as per image on the left.

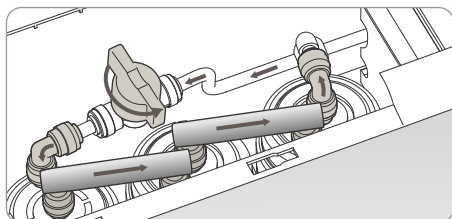

#### Step 3:

Please turn the water valve to close it.



Close



Open

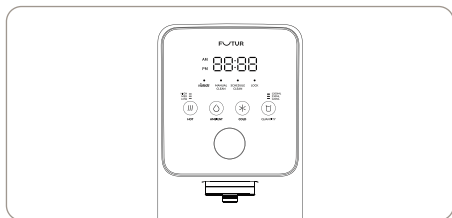

#### Step 4:

Press the water discharge button to remove the remaining water in the unit.

Then, please pull out the power cord to turn off the power.

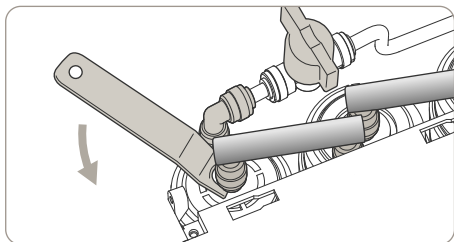

#### Step 5:

Separate the fitting using a fitting separator provided

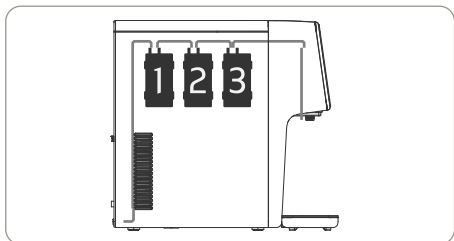

#### Step 6:

Remove the used filter and replace it with a new set of filters.

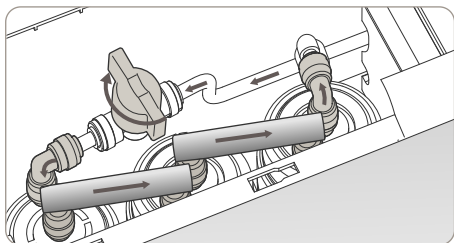

#### Step 7:

After completing the filter replacement, please open the valve, plug in the power cord, and turn on the power.

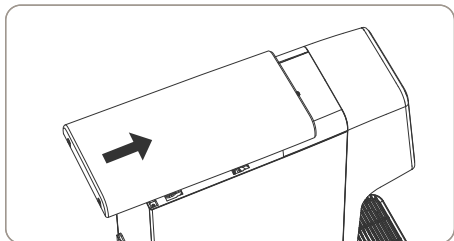

#### Step 8:

Slide top cover back and secure it with the screwdriver.

Press and hold the "Ambient" & "Violeds" Button at the same time for 5 seconds to activate filter flushing and reset the filter indicator.

## SPECIFICATIONS

---

Model Number	FTL-001
Power	220-240V/ 50hz
Power Consumption	Cold 0.8A / Hot 2,800W
Size	150MM (Width) x 442MM (Depth) x 406 MM (Height)
Weight	7.4KG
Filter	Pre Multi Carbon Filter
	KX Nano-Fact Filter
	Post Silver Carbon Filter
Cold Module	Semiconductor
Hot Module	Ceramic heater
Recommend Water Pressure	137kPa~827kPa(20psi~120psi)
Raw Water Temp	5°C~35°C
Use Environment	5°C~35°C
Filter Life	2000 Litres
Website	<a href="http://www.futurliving.com.sg">www.futurliving.com.sg</a>

WWW.FUTURLIVING.COM.SG

