

# FUTUR

## LUNA UV AIR PURIFIER

USER MANUAL



## 01 POINTS FOR ATTENTION

Before using, please read this user manual carefully and keep it for future reference.

### Danger warning

1. To avoid electric shock and fire, do not allow water, liquid or any flammable detergent to get into or to clean the product.
2. Do not spray insecticide, perfume or other flammable spray around the products.

### Safety warning

1. Before connecting the power supply, please check whether the voltage of the product is consistent with the local power supply voltage.
2. When the power cord is damaged, it must be replaced by electrical technicians or professional personnel to avoid danger.
3. Do not use when the plug, power cord or the product is damaged
4. Do not block the air inlet and air outlet, for example, do not place objects on or in front of the air outlet.
5. Do not insert foreign matter into the product through the air inlet.
6. This product should not be used by persons (including children) with physical disabilities, mental disabilities or lack of relevant experience and skills, unless they are given instructions by the person responsible for their safety. Do not allow children to play with the product or to clean and maintain the product unsupervised.

### Notice

1. This product is not a substitute for normal ventilation, daily vacuuming or cooking range hoods.
2. Make sure the connected power socket is in good contact, or the plug may become very hot.
3. Do not place anything on the product.
4. Ensure the product is used in condition of a stable and horizontal level.

5. Please leave at least 30cm of space on the back and sides of the product, and at least 50cm of space above the product when using.
6. Do not put the product directly under the air conditioner to prevent condensation from dripping into the product.
7. Before turning on the power supply, make sure that the filter and filter cover are properly installed.
8. Please use the filter specially designed for this product.
9. Burning the filter may cause irreversible human harm or endanger other lives. Do not use the filter for fuel or similar purposes.
10. Do not hit the product with hard objects (especially the air outlet and air inlet).
11. Do not insert finger or other things into the air outlet/inlet to prevent physical damage or trouble.
12. Do not use this product when using indoor aerosol repellent or in places filled with oil, flammable gas or chemical fumes.
13. Ensure the device is power-off and unplugged before cleaning, maintaining and replacing filter.
14. Please unplug the product before moving it. Do not move the product by pulling the power cord.

## 02 PRODUCT OVERVIEW

### Components

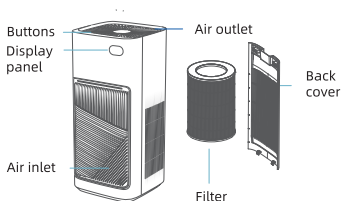

## Control panel



Wind speed  
button

Timer  
button

Power  
button

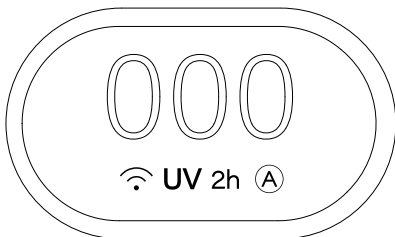

## 03 SPECIFICATION

Model	Luna UV Air Purifier
Dimension	700x310x310mm
Weight	8.3kg
Rated voltage	220V-240V / 50Hz
Power	60W
Noise	25-56dB
Coverage area	875QM / 936SQFT

Plug the air purifier into the power socket, the device will ring a sound, then the screen and background lights flash once, indicating that the air purifier is ready for use.

## Button instruction

### Power button

The device will ring once every time you touch the power button. Press the power button to turn on/off the device. After the device is turned on, it works in Auto mode by default, and the background light displays the corresponding color according to PM2.5 detection value. The display screen displays the status of corresponding function icons and PM2.5 values.

**Notice:** When the air purifier is turned off without unplugging the power plug, when turned on again, the device will work in the state before shutdown by default.

If the HEPA 13 Filter is not installed properly or not installed, the device will have alarm sound and display alarm icon when turned on.

### Wind Speed / WiFi button

When in use, tap this button to select the Wind Speed mode. You can select between: Auto mode, Sleep mode, Medium speed, and High speed.

Press and hold this button to set or reset WiFi connection.

### Timer button

When tapping on the timer button, the device will beep softly. The timer can be set to your desired schedule. You can select between: 2hrs, 4hrs, 6hrs, 8hrs, 10hrs, 12hrs, and 24hrs.

To cancel the scheduled time, press & hold the timer button for 5 seconds.

## UV button

When in use, tapping on the UV button can activate/deactivate UV function.

## 05 WIFI MANUAL

Use your mobile phone to scan the QR code below to download the "Smart Life" APP. You can also search for "smart life" in the APP store or Google Play to install the APP.



2. Open the "Smart Life" APP and use your phone number or e-mail to register your "Smart Life" account, then login.
3. Connect the mobile phone to the home wireless network, and turn on the mobile phone Bluetooth (please select 2.4GHz WiFi network).

### Open the "Smart Life" APP

Enter the homepage of the "Smart Life" APP. Click "+" to select to add a device, the APP will display manual addition and automatic discovery.

**Automatic discovery:** When the corresponding authority is turned on, the device can be automatically discovered, and the device needs to be in the network configuration state and turned on.

**Manually add:** select the name corresponding to the product, WIFI+Bluetooth mode.

**Bluetooth configuration:**

When confirming that the WIFI indicator of the device is flashing quickly, click OK, and then wait for the connection. (Recommended,) When "Successfully add 1 device" appears, it means the connection has been completed and your device will be listed in your APP list.

**Hotspot configuration network:**

Click on the WIFI quick connection in the upper right corner to select the hotspot distribution network (AP Mode), Confirm that the WIFI indicator of the device flashes slowly, click OK, and enter your home WIFI and WIFI password.

Next, click to connect to go to the WLAN setting interface of the phone, and then select the Wi-Fi network "SmartLife\_XXXX" to connect it

Your device will be listed in your APP list. Now, you can control your smart device through the mobile APP anytime and anywhere (make sure your mobile phone and smart device are connected to the network, make sure your router name is changed to SmartLife\_XXXX).

## 06 FILTER REPLACING

The filter will display the remaining filter capacity and provide an inside of when it is needed to be replaced.

Please use the filter specially designed for this product.

### Notice:

- Please do not wash the filter.
- Please turn off the device and unplug from the power before replacing filter.

When the air purifier runs for 3,000 hours, the screen will display filter capacity at 0%. The indicator will also flash in Yellow for your attention.

### Steps to change filter

STEP 1: Kindly turn off the device and ensure it is unplugged from power before changing filter.

STEP 2: Open the back cover.

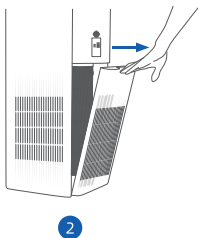

STEP 3: Remove the used filter.

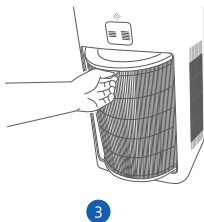



STEP 4: Remove the protective packaging of new filter.



4

STEP 5: Install the new filter in the air purifier and lock it by rotating the bottom cover in the direction marked "Close".

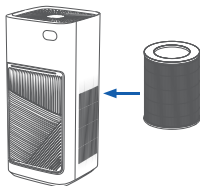

5

STEP 6: Close the back cover.

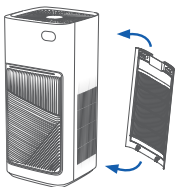

6

STEP 7: Reset filter lifespan.

- After replacing the filter, plug in the air purifier into power socket.
- Tap power button to turn it on.
- The screen will display filter capacity as 0%, and the indicator will still flash in Yellow.
- Please press and hold Power button to reset filter lifespan.
- The icon should now display filter capacity at 100% and indicator should resume normalcy.
- The filter has successfully replaced.

## 07 MAINTENANCE

### Notice:

- Ensure the device is unplugged before maintenance.
- Do not immerse the air purifier into water or any liquid.
- Do not use abrasive, corrosive or flammable cleansers (such as bleach or alcohol) to clean any part of the unit.
- Do not wash the filter.
- Do not use a vacuum cleaner to clean the filter.

### Clean:

- Ensure the device is power-off and unplugged.
- Remove the filter from device, gently wipe the dust absorbed on the pre-filter (outer layer of the filter) using tissue.
- Use a soft cloth with neutral cleanser to clean away any dust or debris from the surface of the device and air inlet/outlet.

### Storage:

- Turn off the device and unplug the power supply, arrange and bundle the power cord.
- Remove the filter, clean the dust adsorbed on the outer surface of the filter
- Clean the air inlet/outlet, wipe the body with a neutral detergent and a soft cloth.
- After the device is completely dried, put on a dust cover/bag and place it in a well-ventilated place not exposed to direct sunlight.
- If you do not use it for a long time, please turn on the device for a few minutes from time to time to ensure a good performance.

## 08 FAQ

Problem	Solution
Not Working	<ul style="list-style-type: none"><li>• Is it plugged into a power socket? Is there a power outage?</li><li>• Is the home leakage switch or fuse cut off?</li></ul>
The air volume becomes smaller	<ul style="list-style-type: none"><li>• Is there any dust in the surface of original filter?</li><li>• Is the air inlet/outlet of the device blocked by something?</li></ul>
Significant noise	<ul style="list-style-type: none"><li>• Is there anything stuck on the fan in the air outlet?</li><li>• Is the device tilted?</li></ul> <p>If not the situation above, you can adjust the device to a lower wind speed.</p>
Unpleasant smell	<ul style="list-style-type: none"><li>• Overtime, when filters accumulate dust and pollutants, the air purifier may give off unpleasant smell. Please replace or clean filter in this situation.</li><li>• If the device emits burning smell, please unplug device from power socket and contact customer service at <a href="mailto:support@futurliving.com.sg">support@futurliving.com.sg</a>.</li></ul>
The reminder of replacing filter keeps flashing after new filter has been replaced	<ul style="list-style-type: none"><li>• If the filter has been replaced, it may be that you have not reset the filter's lifespan on device.</li></ul> <p>To reset filter lifespan, please press and hold Wind Speed button to reset filter lifespan. The icon should now display filter capacity at 100% and indicator should resume normalacy.</p>

**Note:** If the above FAQ can not solve your problems and need maintenance, please contact the customer service. Please do not disassemble the machine to maintain by yourself.