

MARQUIS Pier

Customer name _____

PO# _____

Salesperson _____

Store _____

All Marquis products are made to order therefore they cannot be returned. Contact sales@marquis.com.au

1 CONFIGURATIONS Standard features: soft close drawers

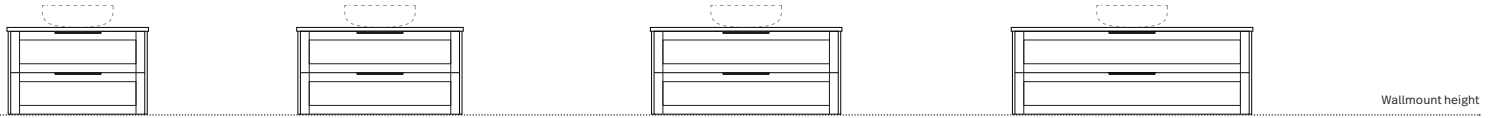

Wallmount height

Kick/leg height

Pier 1
600mm
centre bowl

Pier 2
750mm
centre bowl

Pier 3
900mm
centre bowl

Pier 4
1200mm
centre bowl

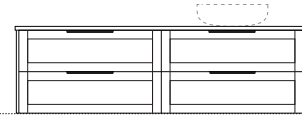
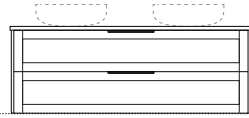
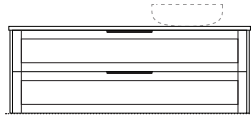

Wallmount height

Kick/leg height

Pier 5
1200mm
off centre bowl

Pier 6
1200mm
Double bowl

Pier 7
1500mm
off centre bowl

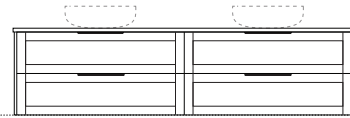
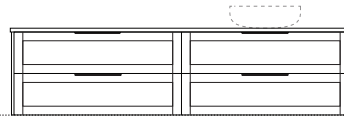
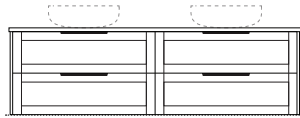

Wallmount height

Kick/leg height

Pier 8
1500mm
double bowl

Pier 9
1800mm
off centre bowl

Pier 10
1800mm
double bowl

2 BASE OPTIONS

Wallmount LED lighting under vanity

2 CABINET FINISHES Vertical grain only

Natural Oak*

Antico Oak

Black Ply

Coastal Oak*

Empire Oak

Florentine Walnut

Prime Oak*

Tasmanian Oak

Angora Oak

Notaio Oak

Bottega Oak

Estella Oak

Ligurian Walnut

Quartiera Maple

Boston Oak

3 HANDLES For full range of handles, see marquis.com.au/handles-legs

Handle name: _____ **No Handle** Do not drill. Attach your own.

4 TOP

Above Counter Basin only

1 tap hole 3 tap holes No tap holes

12 o'clock 10 o'clock 2 o'clock

Select basins from Marquis Bathroom Book. Note: Tap hole options will vary. Refer Marquis office

Top finish

Symphony colour* (3 week lead time) _____

Caesarstone colour _____

Dekton colour _____

Marquis above counter basin range

Basin name _____

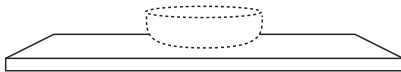

NOTE: OPTIONS MARKED WITH * HAVE A LEAD TIME OF 3 WEEKS. GENERAL FACTORY LEAD TIMES APPLY TO ALL OTHER OPTIONS.

Additional info _____

Customer signature _____

Date _____

Production commences within 24 hours of order placement. Cancellations or changes to orders after 24 hours will incur charges.