

Laundry

COLLECTION 24

*Australian Designed
Globally Inspired*

**CURATED IN
AUSTRALIA**

— AUSTRALIAN INSPIRED

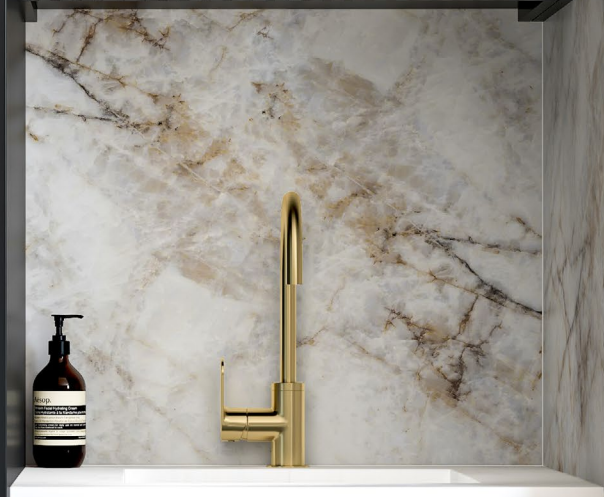

10 Year
Warranty

otti
australia



What Makes a Otti Laundry Outstanding

The Otti brands Quality and Sustainability are the cornerstone of Otti Australia.

Our products are backed by a comprehensive warranty, ensuring that you purchase with confidence. And because we believe that sustainable construction is essential for the future of our planet, we use recyclable materials and materials that last the test of time.

10 YEAR WARRANTY

It is with pure confidence that we guarantee all our laundry cabinets for a full 10 years.

We believe in what we do!

Connect and Share your projects with us!



Know the Difference

At Otti Australia, we curate and design our products with only the best materials in mind. While quality and sustainability are our focus, it is partnered with industry met compliancy and warranty, knowing there is intergrity in every product we offer.

What Makes Us Different

What makes us different is our process towards "thoughtful design" and use of materials that boast many benefits, The thoughtful design process leans towards a more sustainable future for a

All Otti joinery are using plywood, that host the natural properties of layed timber sheeting that are laminated together using low VOC materials making for the best material to use in wetspaces. Waste is managed responsibly through recycling efforts encompassing packaging, waste and supporting the community through goodwill support and disaster relief efforts.

On going maintainace such as sealants, polish or wax are not required with Otti Australia cabinets making for a more sustainable product, unlike timber vanities.

Benefits of Plywood -

- **Water Resistant**
- **Durable, long lasting and strong**
- **Sustainable**
- **No maintenance required.**

While others use inferior PVC, Chipboard or MDF.

- Chipboard or MDF are:-**
- **Not water resistant**
 - **Damage easily**
 - **Shorter life span**
 - **Not environmentally friendly.**
 - **Toxic glues and plastics used to manufacture these.**

While Solid Timber need restaining every year once it is exposed to water, using chemicals required to maintain, polish or seal.

With many years experience in manufacturing bathware, the benefits of plywood vanities out weigh and out perform any other materials.

Standard Features:-

- Soft Close Doors and Drawers
- High Quality detailed construction
- Perfect laminated edging



LED Cabinet Light Strip

CURATED IN AUSTRALIA

— AUSTRALIAN INSPIRED

With obsession to detail, our designers are inspired by the young and vibrant spirit of Australia.

Inspired by the latest trends in interior design, we bring you the latest collection by Otti Australia.

Being in the industry as an interior designer in the building industry for many years, understanding that quality, design and price entwined makes all the difference.



MIX AND MATCH

You can mix and match your selections from our huge range of cabinet colours and handles. Personalise your items to create the perfect look!

EASY DIY INSTALLATION

DIY Installation is easy with our modular system. Each module is built ready for you to install. No flat packs here!!



Designing the best room in your home.

When it comes to the laundry, this space always takes a backseat to the stars of the home, Bathrooms and Kitchens. The laundry has always been a difficult space to design for and find the materials to get the designer look.

At Otti we have designed a modular system that will make designing your laundry easy. We have done all the planning for you with our



*Australian Designed
Globally Inspired*



Laundry Packages
or you can



Build Your Own design using the individual items.

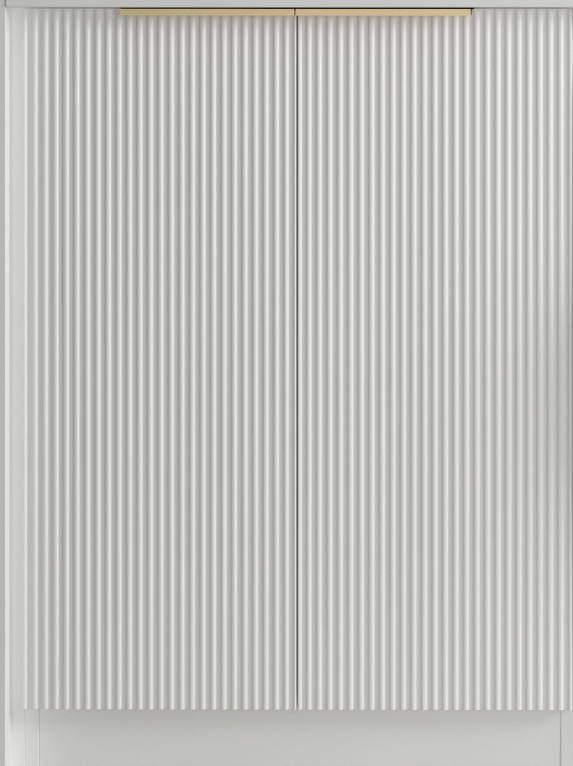



CONTENTS

Getting Started	01
Choose Your Style	02
Measure your Space	03
Base Cabinet Sets	04
Layout Using 1305mm Package	11
Layout Using 1715mm Package	15
Layout Using 1960mm Package	19
Cabinet Technical Drawings	23
Kitchen Accessories	27
Laundry Top Collection	29
Laundry Cabinet Finishings Collection	30
Sketch your Layout and Order Form	31
Laundry Warranty	34

Getting Started

- Step 1. Style** - Choose your style and finishes
- Step 2. Measure** - Measure out the space for your Laundry
- Step 3. Layout** - Select from the Packages to fit your space - On Page 04
- Step 4. Plan** - Use the planner on page 31 to ensure a great fit or build your own laundry.
- Step 5. Order** - Place your order with our stockists or call our sales team to assist you.



Cabinet Colour & Finishes

Timber Grain

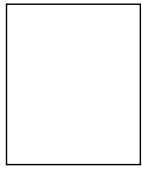

Byron



Black Oak



Natural Oak

Panelled

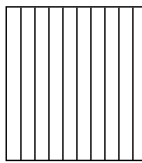

Marlo&Noosa



Marlo Matte Black



Noosa Matte White

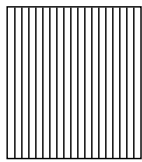

Bondi



Matte White

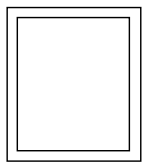

Hampshire



Matte White

Handle Options

Finish Electroplated PVD Handles

Byron, Bondi

Brushed Gold (Optional Colours available as extra) Included in Packages / RRP:\$20 Each



Matte Black
BOHANDLE-B200



Brushed Gold
BOHANDLE-G200



Brushed Nickel
BOHANDLE-BN200

Marlo

Matte Black (Optional Colours available as extra) Included in Packages / RRP:\$20 Each



Matte Black
MLHANDLE-B



Brushed Gold
MLHANDLE-BG



Chrome
MLHANDLE

Hampshire

Bevel Finger pull

Laundry Stone Tops



Quartz Stone
Pure White
20mm Stone Top



Natural
Carrara
18mm Stone Top

Laundry & Kitchen Sinks Options



Axon 52S M-CBS-810-52

Outer Dimension:
520X440X220mm
Basket Wastes Included

Included in Packages
RRP:\$250



Axon 52S M-CBS-810-52BG

Brushed Gold
Outer Dimension:
520X440X220mm
Basket Wastes Included

Upgrade to Brushed Gold Extra \$118
RRP \$368



Axon 52S M-CBS-810-52GM

Gun Metal
Outer Dimension:
520X440X220mm
Basket Wastes Included

Upgrade to Gun Metal Extra \$118
RRP \$368



Byron Black
Package D shown fits into a 1305mm space

Step 2 Measure Your Space

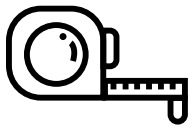

MEASURE YOUR SPACE

- Measure your laundry space
- Measure you floor - add doors and windows.
 - Walls that your laundry will be fixed to. Draw in Windows, doors and ceiling height.
- Considerations:-
- Doors - Allow for the door swing and architraves.
 - Windows - Ensure you have allowed for your cabinets to clear window frames.
 - Wall to wall - Allow for tile thickness.
- Mark out your waste points, drainage, plumbing and electrical positions.

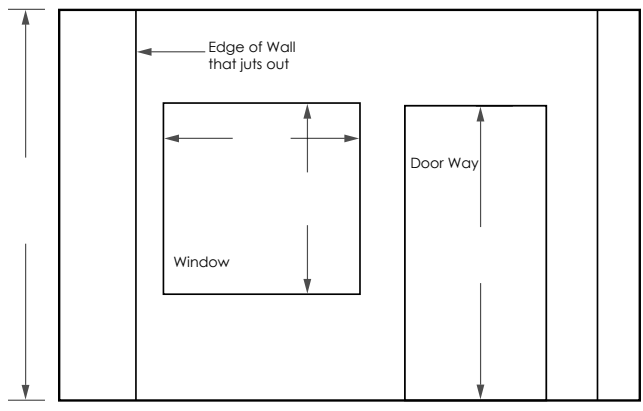
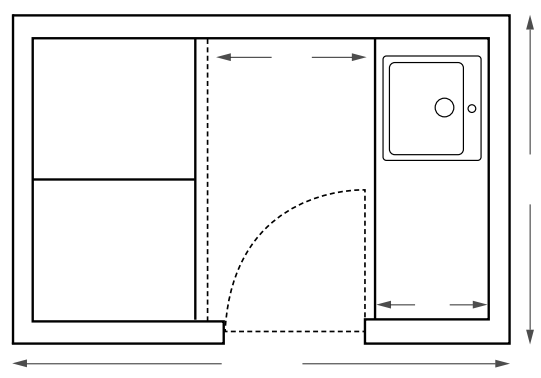

Choose Your Layout

Once you know how much space you have to work with, think about the desired layout of the Laundry.

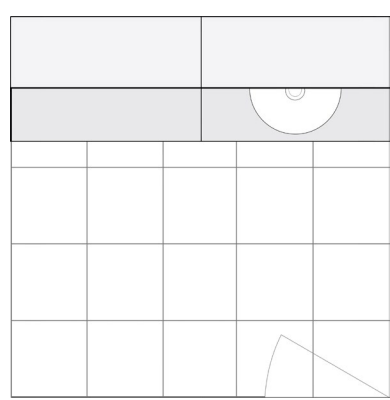

Straight Run Layout
Ideal for narrow spaces making for a simple and practical laundry

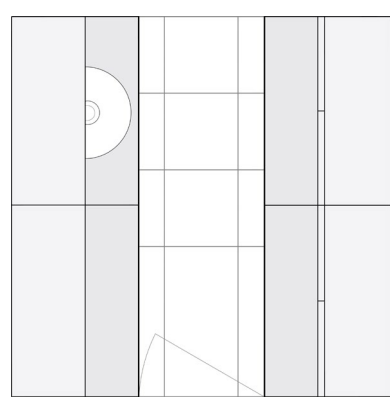

Galley Layout
Ideal for wide room, add cabinets on opposing walls to benefit from maximum storage space.



Refer to Page 31



Pro Tip - Consider Your Appliance Size

Note the width and depth of your appliances when designing your new laundry. Most appliances are 600mm wide, but allow for 650mm so air flows around your appliances to avoid humidity to build up.

- Allow for air to flow around your appliances

While depths may vary depending on brands and makes. The deeper they are they may protrude out from the benchtop when installed, rather than sit flush with the top edge.

NOTE: Always check with the manufacturers specifications for the required space around your appliance.

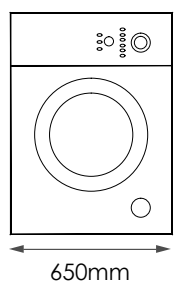
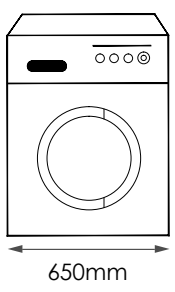
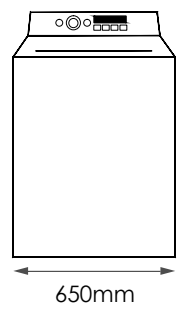



BASE CABINET SETS
Floor Standing Joinery

Step 3
Choose a Package

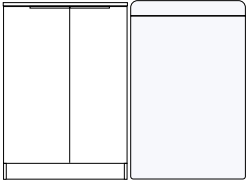

650mm

Base Cabinet 632mm x1
Quartz Stone Top L650xD600xH20mm
Laundry Sink Stainless Steel x1

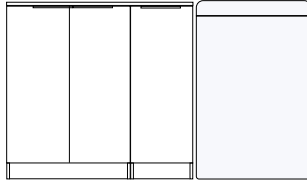

1060mm

Base Cabinet (Double Door)632mm x1
Base Cabinet (Single Door)416mm x1
Quartz Stone Top L1060xD600xH20mm
Laundry Sink Stainless Steel x1

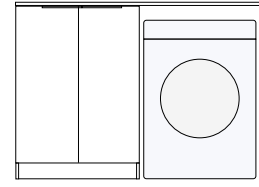

1300mm

Base Cabinet 632mm x1
Quartz Stone Top L1300xD600xH20mm
End Panel x1
Laundry Sink Stainless Steel x1



650mm
MINI
LAUNDRY
SET

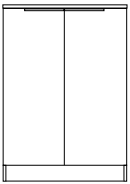
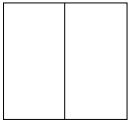

Base Cabinet 632mm x1
Wall Cabinet 632mm x1
Quartz Stone Top L650xD600xH20mm
Laundry Sink Stainless Steel x1



1305mm
LAUNDRY
SETS

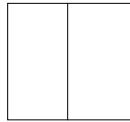

A

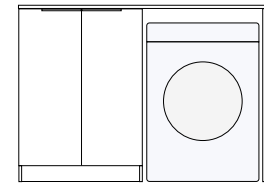

Base Cabinet 632mm x1
Wall Cabinet 632mm x1
Quartz Stone Top L1300xD600xH20mm
End Panel x1
Laundry Sink Stainless Steel x1



B

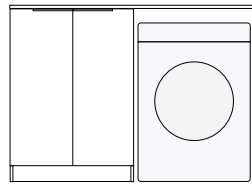

Base Cabinet 632mm x1
Wall Cabinet 632mm x2
Quartz Stone Top L1300xD600xH20m
End Panel x1
Laundry Sink Stainless Steel x1



C

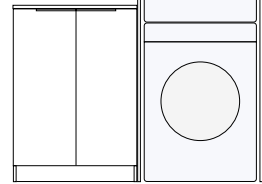

Base Cabinet 632mm x1
Wall Cabinet 632mm x1
Tall Washing Machine Cabinet
L652xD700xH2100mm x1
Quartz Stone Top L650xD600xH20m
Laundry Sink Stainless Steel x1



1715mm
LAUNDRY
SETS

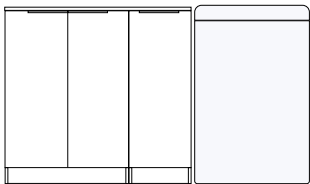
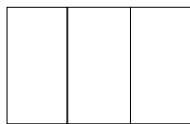

A

Base Cabinet (Double Door)632mm x1
Base Cabinet (Single Door)416mm x1
Wall Cabinet (Double Door) 632mm x1
Wall Cabinet (Single Door) 416mm x1
Quartz Stone Top L1060xD600xH20mm
Laundry Sink Stainless Steel x1

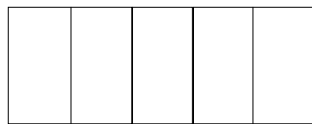

B

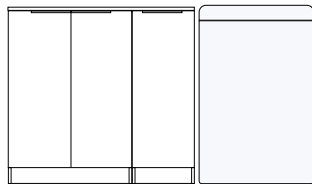

Base Cabinet (Double Door)632mm x1
Base Cabinet (Single Door)416mm x1
Wall Cabinet (Double Door) 632mm x2
Wall Cabinet (Single Door) 416mm x1
Quartz Stone Top L1060xD600xH20m
Laundry Sink Stainless Steel x1



C

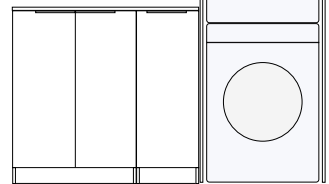

Base Cabinet (Double Door)632mm x1
Base Cabinet (Single Door)416mm x1
Wall Cabinet (Double Door) 632mm x1
Wall Cabinet (Single Door) 416mm x1
Tall Washing Machine Cabinet
L652xH2100mmxD700 x1
Quartz Stone Top L1060xD600xH20m x1
Laundry Sink Stainless Steel x1

1960mm LAUNDRY SET

Once you know how much space you have to work with, think about the layout of the laundry.

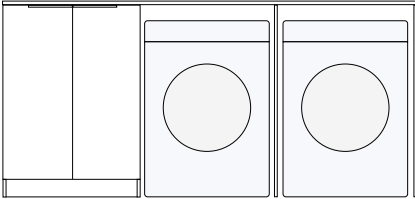
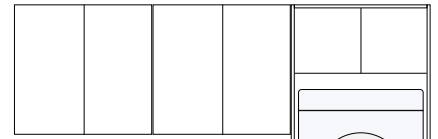
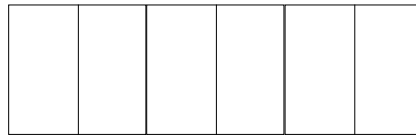
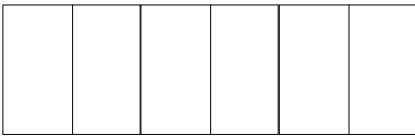

A

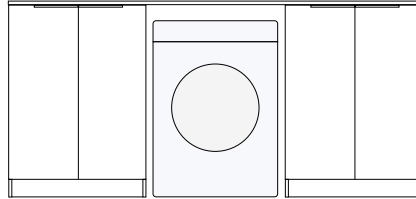

B

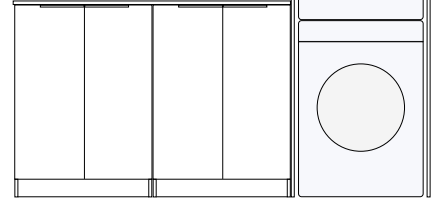

C

Included In Package

Base Cabinet (Double Door) 632mm x1
 Wall Cabinet (Double Door) 632mm x3
 Quartz Stone Top L1980xD600xH20mm
 End Panel x2
 Laundry Sink Stainless Steel x1

Base Cabinet (Double Door) 632mm x2
 Wall Cabinet (Double Door) 632mm x3
 Quartz Stone Top L1980xD600xH20mm
 Laundry Sink Stainless Steel x1

Base Cabinet (Double Door) 632mm x2
 Wall Cabinet (Double Door) 632mm x2
 Tall Washing Machine Cabinet L652xD700xH2100mm x1
 Quartz Stone Top L1300xD600xH20mm
 Laundry Sink Stainless Steel x1



FILLER AND END PANELS

Customise:- Use cabinets to fill majority of your space, then use our filler & end panels and end panels to fill the gaps. Remember to allow for air to flow around your appliances.

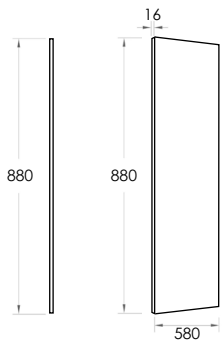
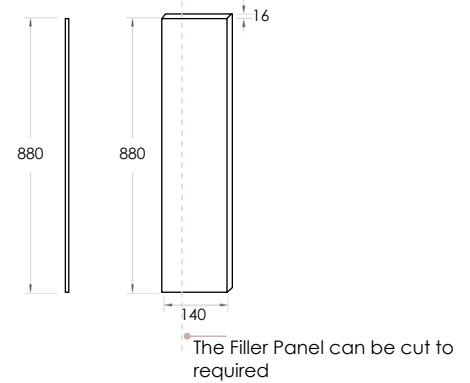
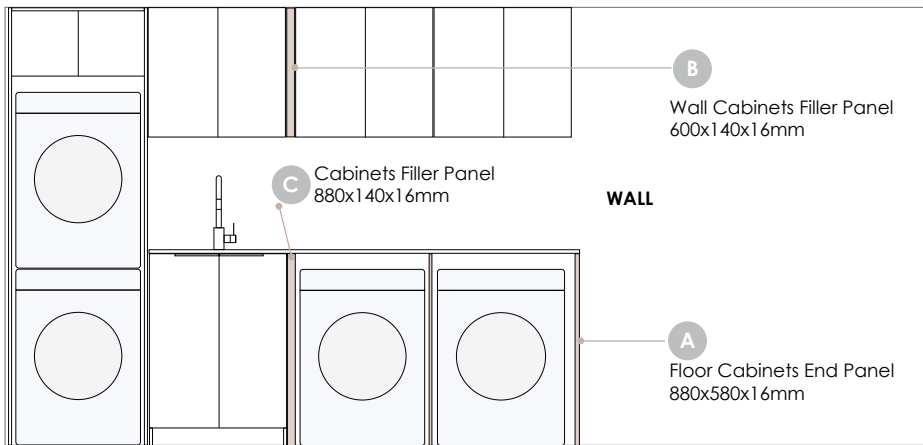

A Floor Cabinets End Panel 880x580x16mm

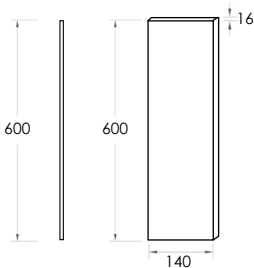

B Wall Cabinets Filler Panel 600x140x16mm Cut to Size on Site

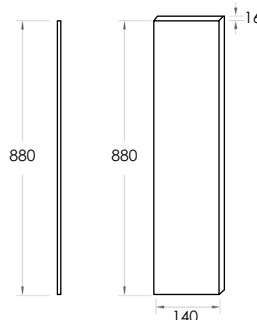

C Wall Cabinets Filler Panel 880x140x16mm Cut to Size on Site

Finishes:

Available in all finishes



Natural Oak



Black Oak



Matte White



Matte Black

GET THE LOOK

Complete laundry
cost as pictured
\$2,090*

* Excludes :- Mirror, Tapware
appliances and accessories





Noosa Matte White



Mini 650mm

For those on a Budget the Mini Laundries are ideal for those laundries that need just simple tidy up!

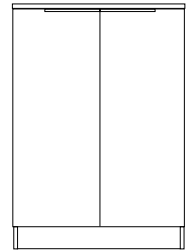
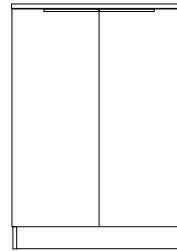
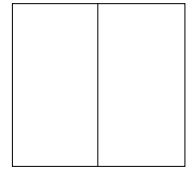

Byron Natural Oak



Byron Black Oak



Bondi MatteWhite

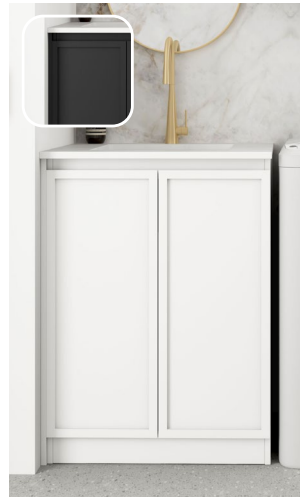

Hampshire Matte White&Matte Black



Marlo Matte Black



Base Cabinet 632mm x1
Quartz Stone Top 650x600x20mm
Laundry Sink Stainless Steel x1

Byron Natural & Black Oak RRP: \$1,230

LA-650-BYN-PW
LA-650-BYN-NCA
LA-650-BYB-PW
LA-650-BYB-NCA

Noosa RRP: \$1,375

LA-650-NSW-PW
LA-650-NSW-NCA

Marlo RRP: \$1,375

LA-650-MA-PW
LA-650-MA-NCA

Bondi RRP: \$1,375

LA-650-BOW-PW
LA-650-BOW-NCA

Hampshire White & Black RRP: \$1,375

LA-650-BOHW-PW
LA-650-BOHW-NCA
LA-650-BOHB-PW
LA-650-BOHB-NCA

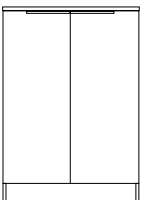

Base Cabinet 632mm x1
Wall Cabinet 632mm x1
Quartz Stone Top 650x600x20mm
Laundry Sink Stainless Steel x1

Byron Natural & Black Oak RRP: \$1,680

LA-650A-BYN-PW
LA-650A-BYN-NCA
LA-650A-BYB-PW
LA-650A-BYB-NCA

Noosa RRP: \$1,975

LA-650A-NSW-PW
LA-650A-NSW-NCA

Marlo RRP: \$1,975

LA-650A-MA-PW
LA-650A-MA-NCA

Bondi RRP: \$1,975

LA-650A-BOW-PW
LA-650A-BOW-NCA

Hampshire White & Black RRP: \$1,975

LA-650A-BOHW-PW
LA-650A-BOHW-NCA
LA-650A-BOHB-PW
LA-650A-BOHB-NCA

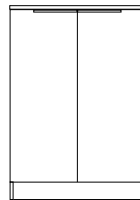
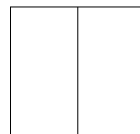



Base Cabinet Set 1060mm
Floor Standing Modules

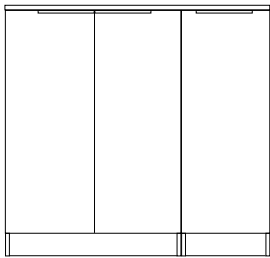

Marlo Matte Black



Byron Natural Oak



Byron Black Oak



Bondi Matte White



Noosa Matte White



Hampshire Matte Black & Matte White

Base Cabinet (Double Door) 632mm x1
Base Cabinet (Single Door) 416mm x1
Quartz Stone Top L1060xD600xH20m
Laundry Sink Stainless Steel x1

Byron Natural & Black Oak RRP: \$2,000

LA-1060-BYN-PW
LA-1060-BYN-NCA
LA-1060-BYB-PW
LA-1060-BYB-NCA

Noosa RRP: \$2,250

LA-1060-NSW-PW
LA-1060-NSW-NCA

Marlo RRP: \$2,250

LA-1060-MA-PW
LA-1060-MA-NCA

Bondi RRP: \$2,250

LA-1060-BOW-PW
LA-1060-BOW-NCA

Hampshire White & Black RRP: \$2,250

LA-1060-BOHW-PW
LA-1060-BOHW-NCA
LA-1060-BOHB-PW
LA-1060-BOHB-NCA



Base Cabinet Set 1300mm Floor Standing Modules

- Base Cabinet 632mm x1
- Quartz Stone Top 1300x600x20mm
- End Panel x1
- Laundry Sink Stainless Steel x1

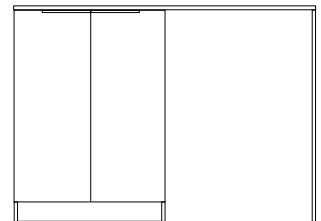

Noosa Matte White & Matte Black



Byron Natural Oak



Byron Black Oak



Noosa Matte White



Bondi Matte White



Marlo Matte Black

Byron Natural & Black Oak RRP: \$1,639
 LA-1300-BYN-PW
 LA-1300-BYN-NCA
 LA-1300-BYB-PW
 LA-1300-BYB-NCA

Noosa RRP: \$1,785
 LA-1300-NSW-PW
 LA-1300-NSW-NCA

Marlo RRP: \$1,785
 LA-1300-MA-PW
 LA-1300-MA-NCA

Bondi RRP: \$1,785
 LA-1300-BOW-PW
 LA-1300-BOW-NCA

Hampshire White & Black RRP: \$1,785
 LA-1300-BOHW-PW
 LA-1300-BOHW-NCA
 LA-1300-BOHB-PW
 LA-1300-BOHB-NCA



Base Cabinet Set 1960mm Floor Standing Modules

Base Cabinet (Double Door) 632mm x1
Quartz Stone Top L1960xD600xH20mm
End Panel x2
Laundry Sink Stainless Steel x1

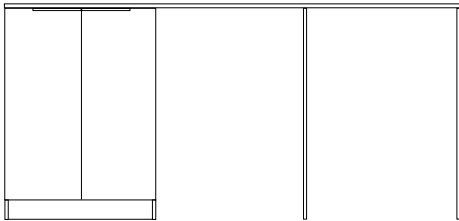

Byron Natural Oak & Black Oak RRP: \$2,456

Marlo, Bondi, Hampshire White & Black RRP: \$2,601



Design your Own Laundry!!!

Create your dream laundry with the Otti Australia Laundry modular range of joinery, by mixing and matching the different products to fit your space and style.

Use the Sketch Page, Order Form and Component Pages on pages 23-33 to guide you in planning your laundry layout.

Start with:-

1. Drawing your layout to fit your space.
2. Consider the appliances you will use, place them in a location near you power point and near the sink for drainage and water connection for your washer.
3. Then select your storage options starting with base cabinets.
4. Add wall units for extra storage to match.
5. Add filler panels and end panels to fill the gaps.
6. Select your finishes - cabinet, handle and stone top colours.
7. Place your order!



STEP 3 Choose your size to fit into | 1305mm

Pictured Package
Starts from
\$2,389*

* Excludes :- Tapware, appliances,
mirror and accessories



BONDI WHITE Package A shown fits into a 1305mm space
(To install Wall to Wall - Please add extra Filler Panels)

Layout using 1305mm Package

Once you know how much space you have to work with, choose your layout.

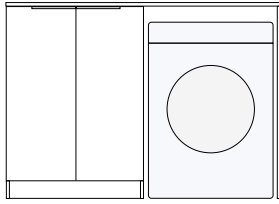
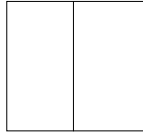

A

Base Cabinet 632mm x1
 Wall Cabinet 632mm x1
 Quartz Stone Top 1300x600x20mm
 End Panel x1
 Laundry Sink Stainless Steel x1

Byron Black Oak RRP: 2,090
 LA-1305A-BYB-PW
 LA-1305A-BYB-NCA

Byron Natural Oak RRP: 2,090
 LA-1305A-BYN-PW
 LA-1305A-BYN-NCA

Hampshire White RRP: 2,389
 LA-1305A-BOHW-PW
 LA-1305A-BOHW-NCA

Hampshire Black RRP: 2,389
 LA-1305A-BOHB-PW
 LA-1305A-BOHB-NCA

Bondi White RRP: 2,389
 LA-1305A-BOW-PW
 LA-1305A-BOW-NCA

Marlo Black RRP: 2,389
 LA-1305A-MA-PW
 LA-1305A-MA-NCA

Noosa White RRP: 2,389
 LA-1305A-NSW-PW
 LA-1305A-NSW-NCA

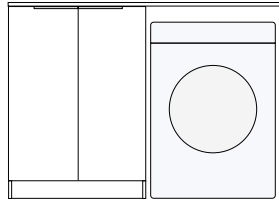

B

Included In Package

Base Cabinet 632mm x1
 Wall Cabinet 632mm x2
 Quartz Stone Top 1300x600x20mm
 End Panel x1
 Laundry Sink Stainless Steel x1

Byron Black Oak RRP: 2,540
 LA-1305B-BYB-PW
 LA-1305B-BYB-NCA

Byron Natural Oak RRP: 2,540
 LA-1305B-BYN-PW
 LA-1305B-BYN-NCA

Hampshire White RRP: 2,988
 LA-1305B-BOHW-PW
 LA-1305B-BOHW-NCA

Hampshire Black RRP: 2,988
 LA-1305B-BOHB-PW
 LA-1305B-BOHB-NCA

Bondi White RRP: 2,988
 LA-1305B-BOW-PW
 LA-1305B-BOW-NCA

Marlo Black RRP: 2,988
 LA-1305B-MA-PW
 LA-1305B-MA-NCA

Noosa White RRP: 2,988
 LA-1305B-NSW-PW
 LA-1305B-NSW-NCA

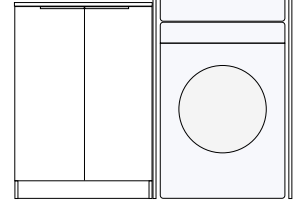

C

Base Cabinet 632mm x1
 Wall Cabinet 632mm x1
 Tall Washing Machine Cabinet L652xH2100mmxD700 x1
 Quartz Stone Top 650x600x20mm x1
 Laundry Sink Stainless Steel x1

Byron Black Oak RRP: 2,905
 LA-1305C-BYB-PW
 LA-1305C-BYB-NCA

Byron Natural Oak RRP: 2,905
 LA-1305C-BYN-PW
 LA-1305C-BYN-NCA

Hampshire White RRP: 3,200
 LA-1305C-BOHW-PW
 LA-1305C-BOHW-NCA

Hampshire Black RRP: 3,200
 LA-1305C-BOHB-PW
 LA-1305C-BOHB-NCA

Bondi White RRP: 3,200
 LA-1305C-BOW-PW
 LA-1305C-BOW-NCA

Marlo Black RRP: 3,200
 LA-1305C-MA-PW
 LA-1305C-MA-NCA

Noosa White RRP: 3,200
 LA-1305C-NSW-PW
 LA-1305C-NSW-NCA

* Excludes :- Mirror, Tapware and accessories



Note: Sink is available as an undermount only.

Layout using 1305mm Package

Complete laundry
cost as pictured
\$2,988*

* Excludes : Tapware appliances
and accessories



Hampshire Matte White
Package B shown fits into a 1305mm space



Layout using 1305mm Package



Complete laundry
cost as pictured
\$2,905*

* Excludes :Tapware appliances
and accessories

Byron Black Oak
Package C shown fits into a 1305mm space

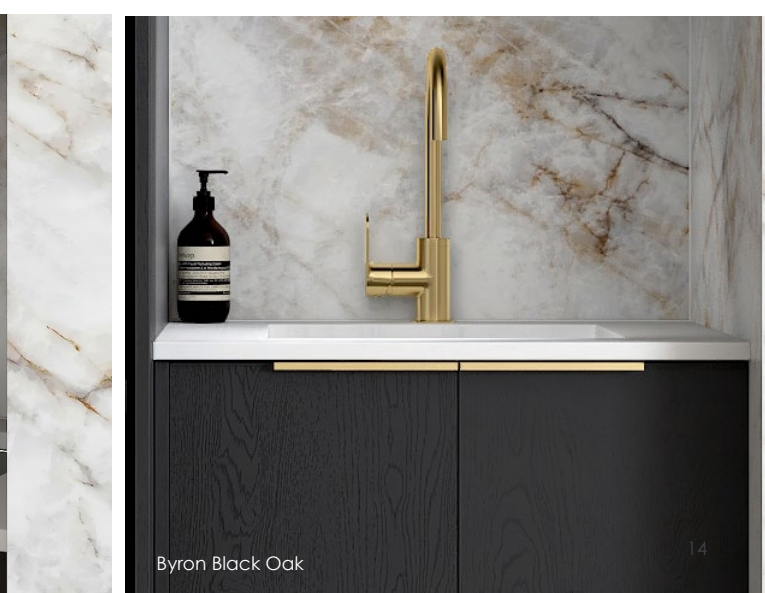
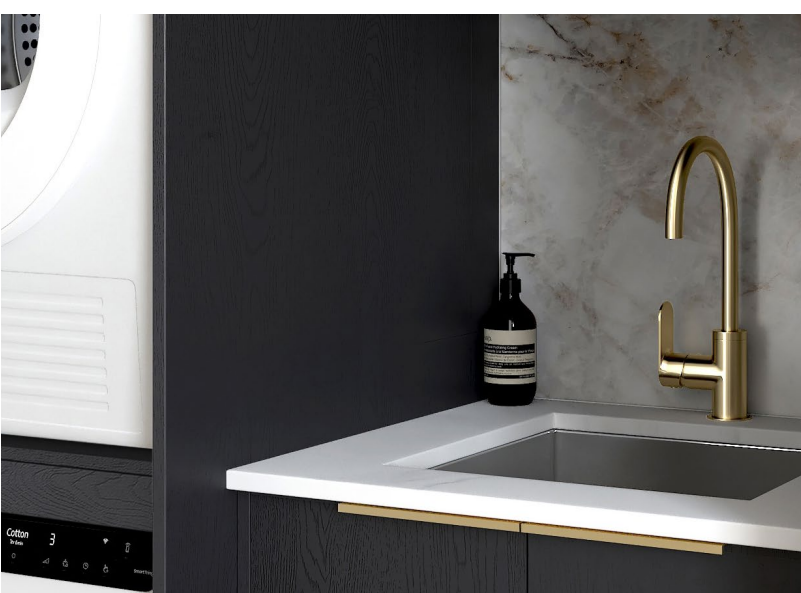

STEP 3 Choose your size to fit into | 1715mm



Complete laundry
cost as pictured
\$4,535*

* Excludes :- Tapware appliances,
Bulkhead, and accessories

BONDI Fluted Matte White
Package C shown fits into a 1715mm space
Excludes :- Tapware, appliances and accessories

Layout using 1715mm Package

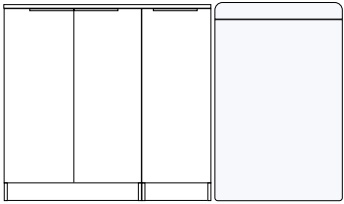
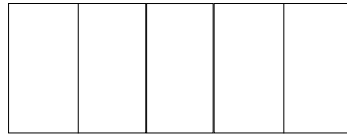

A

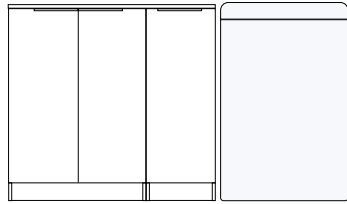

B

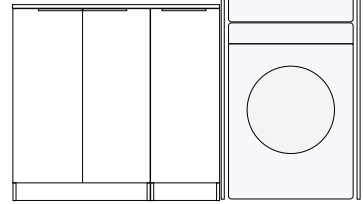

C

Included In Package

Base Cabinet (Double Door) 632mm x1
 Base Cabinet (Single Door) 416mm x1
 Wall Cabinet (Double Door) 632mm x1
 Wall Cabinet (Single Door) 416mm x1
 Quartz Stone Top L1060xD600xH20mm
 Laundry Sink Stainless Steel x1

Base Cabinet (Double Door) 632mm x1
 Base Cabinet (Single Door) 416mm x1
 Wall Cabinet (Double Door) 632mm x2
 Wall Cabinet (Single Door) 416mm x1
 Quartz Stone Top L1060xD600xH20m
 Laundry Sink Stainless Steel x1

Base Cabinet (Double Door) 632mm x1
 Base Cabinet (Single Door) 416mm x1
 Wall Cabinet (Double Door) 632mm x1
 Wall Cabinet (Single Door) 416mm x1
 Tall Washing Machine Cabinet
 L652xH2100mmxD700 x1
 Quartz Stone Top L1060xD600xH20m x1
 Laundry Sink Stainless Steel x1

Byron Black Oak RRP: 2,825
 LA-1715A-BYB-PW
 LA-1715A-BYB-NCA

Byron Natural Oak RRP: 2,825
 LA-1715A-BYN-PW
 LA-1715A-BYN-NCA

Hampshire White RRP: 3,310
 LA-1715A-BOHW-PW
 LA-1715A-BOHW-NCA

Hampshire Black RRP: 3,310
 LA-1715A-BOHB-PW
 LA-1715A-BOHB-NCA

Bondi White RRP: 3,310
 LA-1715A-BOW-PW
 LA-1715A-BOW-NCA

Marlo Black RRP: 3,310
 LA-1715A-MA-PW
 LA-1715A-MA-NCA

Noosa White RRP: 3,310
 LA-1715A-NSW-PW
 LA-1715A-NSW-NCA

Byron Black Oak RRP: 3,275
 LA-1715B-BYB-PW
 LA-1715B-BYB-NCA

Byron Natural Oak RRP: 3,275
 LA-1715B-BYN-PW
 LA-1715B-BYN-NCA

Hampshire White RRP: 3,910
 LA-1715B-BOHW-PW
 LA-1715B-BOHW-NCA

Hampshire Black RRP: 3,910
 LA-1715B-BOHB-PW
 LA-1715B-BOHB-NCA

Bondi White RRP: 3,910
 LA-1715B-BOW-PW
 LA-1715B-BOW-NCA

Marlo Black RRP: 3,910
 LA-1715B-MA-PW
 LA-1715B-MA-NCA

Noosa White RRP: 3,910
 LA-1715B-NSW-PW
 LA-1715B-NSW-NCA

Byron Black Oak RRP: 4,055
 LA-1715C-BYB-PW
 LA-1715C-BYB-NCA

Byron Natural Oak RRP: 4,055
 LA-1715C-BYN-PW
 LA-1715C-BYN-NCA

Hampshire White RRP: 4,535
 LA-1715C-BOHW-PW
 LA-1715C-BOHW-NCA

Hampshire Black RRP: 4,535
 LA-1715C-BOHB-PW
 LA-1715C-BOHB-NCA

Bondi White RRP: 4,535
 LA-1715C-BOW-PW
 LA-1715C-BOW-NCA

Marlo Black RRP: 4,535
 LA-1715C-MA-PW
 LA-1715C-MA-NCA

Noosa White RRP: 4,535
 LA-1715C-NSW-PW
 LA-1715C-NSW-NCA

Excludes :-Mirror, Tapware appliances and accessories



* Mirror, accessories and tapware sold separately

Layout using 1715mm Package

Complete laundry
cost as pictured
\$3,910*

* Excludes : Tapware appliances
and accessories



MARLO Matte Black
Package B shown fits into a 1715mm space.

Layout using 1715mm Package

Complete laundry
cost as pictured
\$3,310*

* Excludes : -Tapware appliances
and accessories



BONDI Fluted Matte White
Package A shown fits into a 1715mm space



STEP 3 Choose your size to fit into | 1960mm

Complete laundry
cost as pictured
\$4,255*

* Excludes :Tapware appliances
and accessories



Byron Natural Oak
19 Package C shown fits into a 1960mm space

Layout using 1960mm Package

Once you know how much space you have to work with, choose your layout.

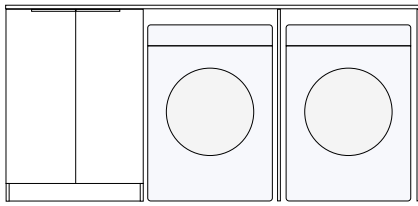
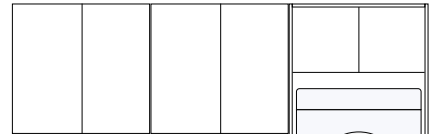
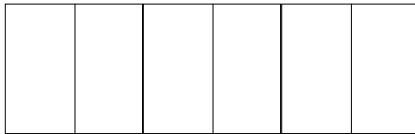
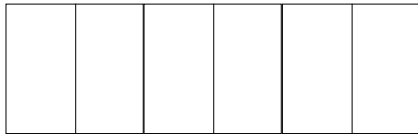

A

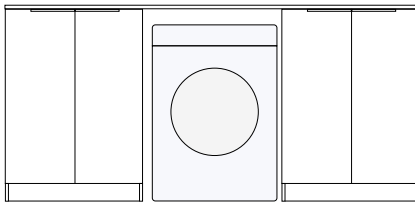

B

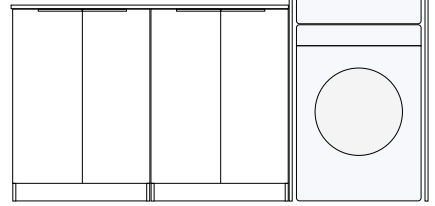

C

Included In Package

Base Cabinet (Double Door) 632mm x1
 Wall Cabinet (Double Door) 632mm x3
 Quartz Stone Top L1960xD600xH20mm
 End Panel x 2
 Laundry Sink Stainless Steel x1

Base Cabinet (Double Door) 632mm x2
 Wall Cabinet (Double Door) 632mm x3
 Quartz Stone Top L1960xD600xH20mm
 Laundry Sink Stainless Steel x1

Base Cabinet (Double Door) 632mm x2
 Wall Cabinet (Double Door) 632mm x2
 Tall Washing Machine Cabinet L652xH2100mmxD700 x1
 Quartz Stone Top L1960xD600xH20mm
 End Panel x1
 Laundry Sink Stainless Steel x1

Byron Black Oak RRP: 3,805
 LA-1960A-BYB-PW
 LA-1960A-BYB-NCA

Byron Natural Oak RRP: 3,805
 LA-1960A-BYN-PW
 LA-1960A-BYN-NCA

Hampshire White RRP: 4,399
 LA-1960A-BOHW-PW
 LA-1960A-BOHW-NCA

Hampshire Black RRP: 4,399
 LA-1960A-BOHB-PW
 LA-1960A-BOHB-NCA

Bondi White RRP: 4,399
 LA-1960A-BOW-PW
 LA-1960A-BOW-NCA

Marlo Black RRP: 4,399
 LA-1960A-MA-PW
 LA-1960A-MA-NCA

Noosa White RRP: 4,399
 LA-1960A-NSW-PW
 LA-1960A-NSW-NCA

Byron Black Oak RRP: 4,158
 LA-1960B-BYB-PW
 LA-1960B-BYB-NCA

Byron Natural Oak RRP: 4,158
 LA-1960B-BYN-PW
 LA-1960B-BYN-NCA

Hampshire White RRP: 4,898
 LA-1960B-BOHW-PW
 LA-1960B-BOHW-NCA

Hampshire Black RRP: 4,898
 LA-1960B-BOHB-PW
 LA-1960B-BOHB-NCA

Bondi White RRP: 4,898
 LA-1960B-BOW-PW
 LA-1960B-BOW-NCA

Marlo Black RRP: 4,898
 LA-1960B-MA-PW
 LA-1960B-MA-NCA

Noosa White RRP: 4,898
 LA-1960B-NSW-PW
 LA-1960B-NSW-NCA

Byron Black Oak RRP: 4,255
 LA-1960C-BYB-PW
 LA-1960BCBYB-NCA

Byron Natural Oak RRP: 4,255
 LA-1960C-BYN-PW
 LA-1960C-BYN-NCA

Hampshire White RRP: 4,845
 LA-1960C-BOHW-PW
 LA-1960C-BOHW-NCA

Hampshire Black RRP: 4,845
 LA-1960C-BOHB-PW
 LA-1960C-BOHB-NCA

Bondi White RRP: 4,845
 LA-1960C-BOW-PW
 LA-1960C-BOW-NCA

Marlo Black RRP: 4,845
 LA-1960C-MA-PW
 LA-1960C-MA-NCA

Noosa White RRP: 4,845
 LA-1960C-NSW-PW
 LA-1960C-NSW-NCA

* Excludes :- Tapware and accessories



Layout using 1960mm Package



Complete laundry
cost as pictured
\$4,399*

* Excludes :-Tapware appliances
and accessories

Layout using 1960mm Package

Complete laundry
cost as pictured
\$4,158*

* Excludes :-Tapware appliances
and accessories



Package B shown fits into a 1960mm space

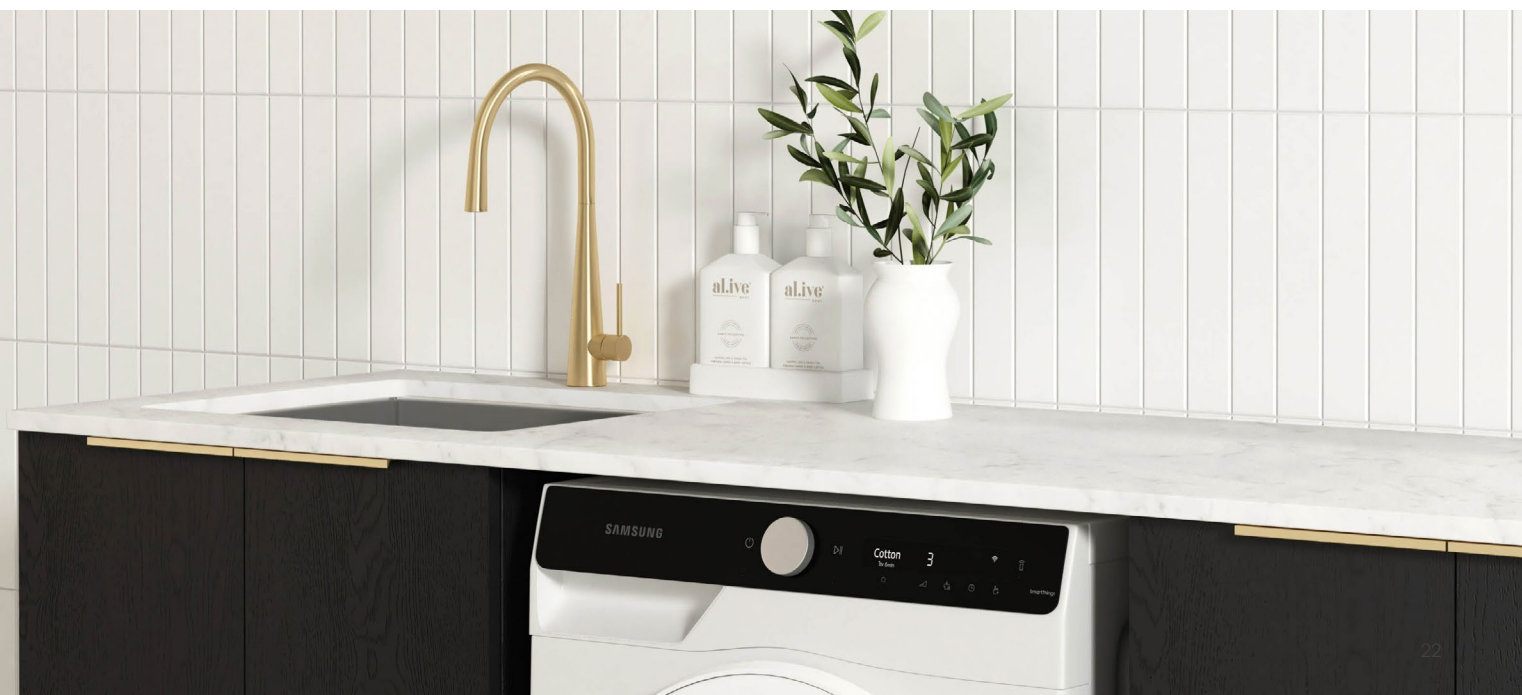

Floor Cabinets Double Door

Bevel Finger Pull or Handle options
632mm

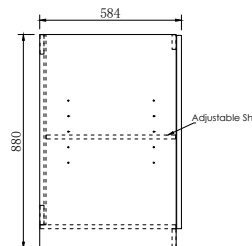
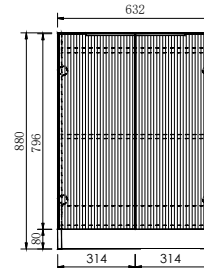
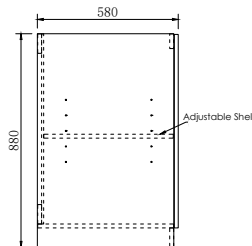
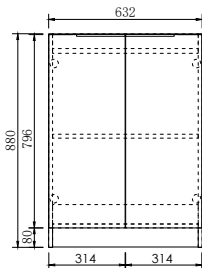
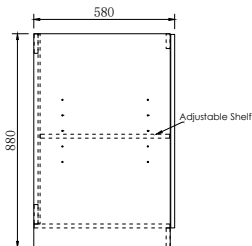
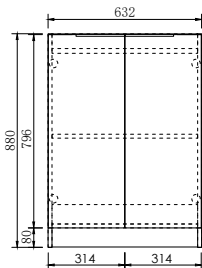
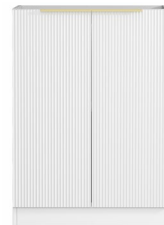

Byron Natural Oak Floor Cabinet 632mm
2 Doors With Handles

LA-BY600N Natural Oak RRP: \$630

Byron Black Oak Floor Cabinet 632mm
2 Doors With Handles

LA-BY600B Black Oak RRP: \$630

Bondi Floor Cabinet 632mm
2 Doors With Handles

LA-BO600W Matte White RRP: \$775

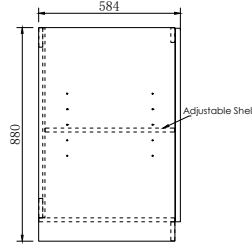
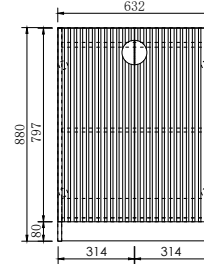
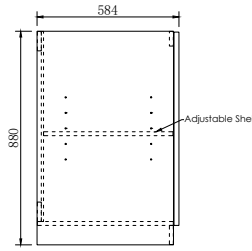
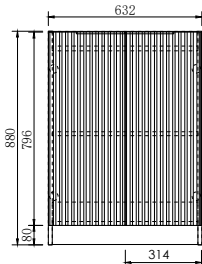
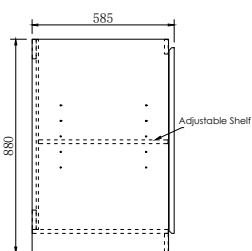
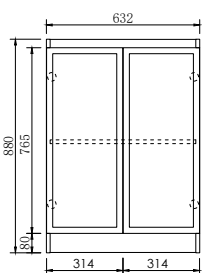

Hamshire Matte White & Matte Black
Floor Cabinet 632mm 2 Doors Bevel Finger Pull

LA-BOH600W Matte White RRP: \$775

LA-BOH600B Matte Black RRP: \$775

Noosa Matte White Floor Cabinet 632mm
2 Doors With Handles

LA-NS600W Matte White RRP: \$775

Marlo Floor Cabinet 632mm
2 Doors With Handles

LA-MA600B Matte Black RRP: \$775

End Panel Floor Cabinets 880x580x16mm

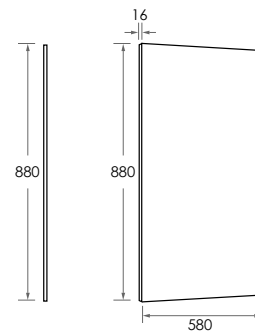
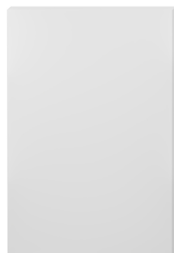

Natural Oak
LA-EP880N RRP: \$139

Black Oak
LA-EP880BO RRP: \$139

Matte White
LA-EP880W RRP: \$139

Matte Black
LA-EP880B RRP: \$139

Floor Cabinets Single Door

Bevel Finger Pull or Handle options
416mm

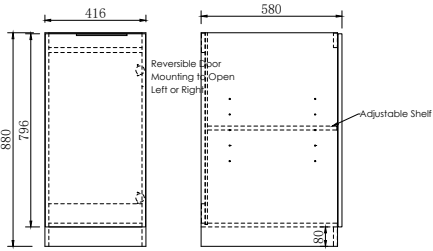

Byron Natural Oak Floor Cabinet 416mm
1 Door With Handle

LA-BY400N Natural Oak RRP: \$595

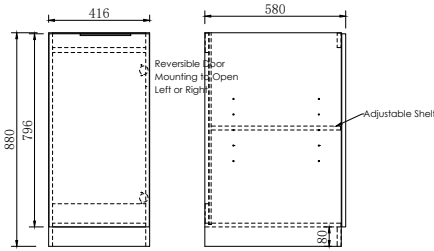

Byron Black Oak Floor Cabinet 416mm
1 Door With Handle

LA-BY400B Black Oak RRP: \$595

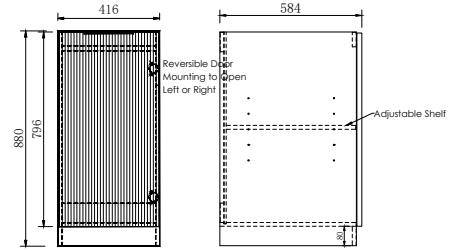

Bondi Floor Cabinet 416mm
1 Door With Handle

LA-BO400W Matte White RRP: \$700

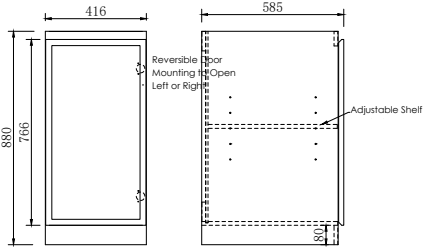

Hampshire Matte White & Matte Black
Floor Cabinet 416mm 1 Door Bevel Finger Pull

LA-BOH400W Matte White RRP: \$700
LA-BOH400B Matte Black RRP: \$700

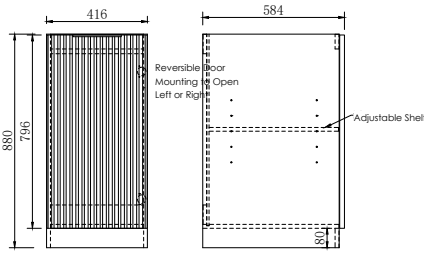

Noosa Matte White Floor Cabinet 416mm
1 Door With Handle

LA-NS400W Matte White RRP: \$700

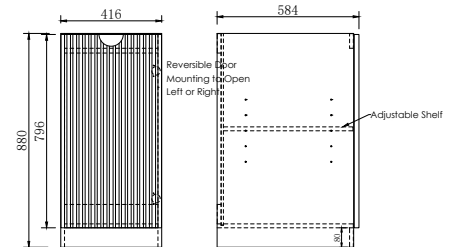

Marlo Floor Cabinet 416mm
1 Door With Handle

LA-MA400B Matte Black RRP: \$700

Filler Panel

Floor Cabinets 880x140x16mm



Natural Oak
LA-FL140N RRP: \$37



Black Oak
LA-FL140BO RRP: \$37



Matte White
LA-FL140W RRP: \$37



Matte Black
LA-FL140B RRP: \$37

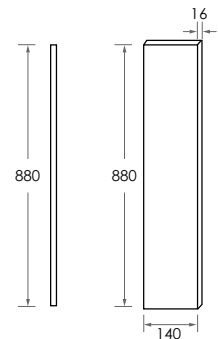

Wall Cabinets Double Door

Bevel Finger Pull
632mm



- When using 2 different designer cabinets, note that the depths vary so it is important to pack out the back of each cabinet to ensure the facings are all level and flush.

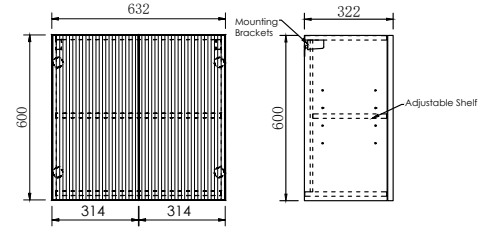
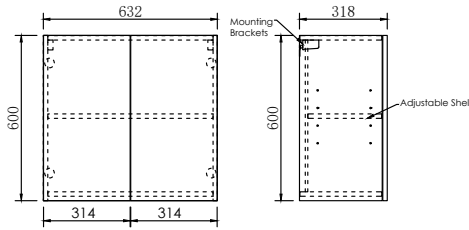
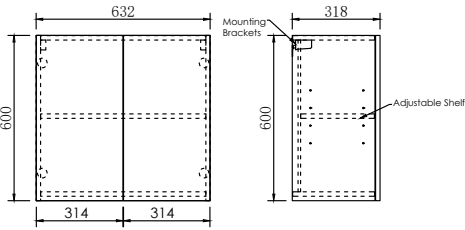

Byron Natural Oak Wall Cabinet 632mm
2 Doors Bevel-Grip Finger Pull

LA-WCBY600N Natural Oak RRP: \$450

Byron Black Oak Wall Cabinet 632mm
2 Doors Bevel-Grip Finger Pull

LA-WCBY600B Black Oak RRP: \$450

Bondi Wall Cabinet 632mm
2 Doors Bevel-Grip Finger Pull

LA-WCBO600W Matte White RRP: \$600

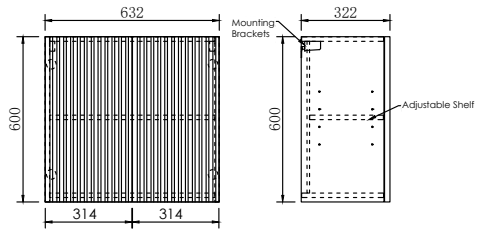
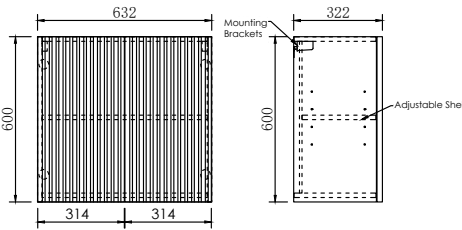
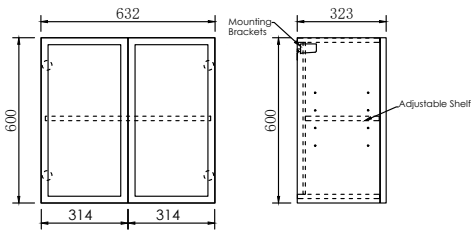

Hampshire Matte White & Matte Black Wall Cabinet 632mm
2 Doors Bevel Finger Pull

LA-WCBOH600W Matte White RRP: \$600
LA-WCBOH600B Matte Black RRP: \$600

Noosa Matte White Wall Cabinet 632mm
2 Doors Bevel Finger Pull

LA-WCNS600W Matte White RRP: \$600

Hampshire Matte Black Wall Cabinet 632mm
2 Doors Bevel Finger Pull

LA-WCBOH600B Matte Black RRP: \$600

Wall Cabinets Single Door

Bevel Finger Pull
416mm

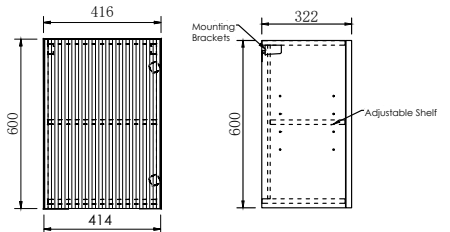
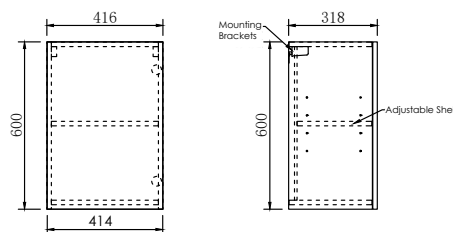
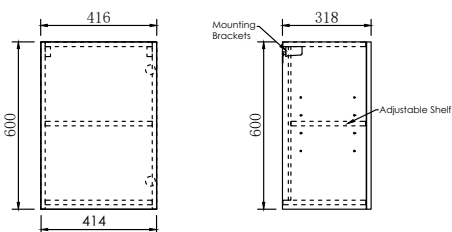

Byron Natural Oak Wall Cabinet 416mm
Single Door Bevel Finger Pull

LA-WCBY400N Natural Oak RRP: \$380

Byron Black Oak Wall Cabinet 416mm
Single Door Bevel Finger Pull

LA-WCBY400B Black Oak RRP: \$380

Bondi Wall Cabinet 416mm
Single Door Bevel Finger Pull

LA-WCBO400W Matte White RRP: \$460

416mm

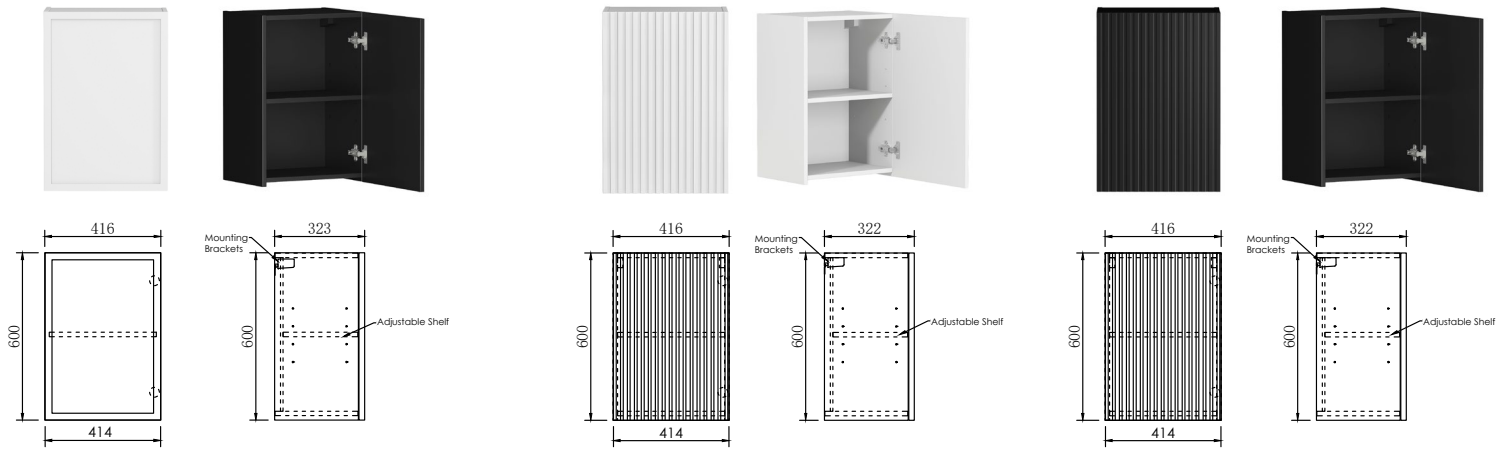

Hampshire Matte White & Matte Black
Wall Cabinet 416mm Singer Door Bevel Finger Pull

LA-WCBOH400W Matte White RRP: \$460
LA-WCBOH400B Matte Black RRP: \$460

Noosa Matte White Wall Cabinet 416mm
Singer Door Bevel Finger Pull

LA-WCNS400W Matte White RRP: \$460

Marlo Wall Cabinet 416mm
Singer Door Bevel Finger Pull

LA-WCMA400B Matte Black RRP: \$460

Filler Panel

Wall Cabinets 600x140x16mm



Natural Oak Black Oak Matte White Matte Black

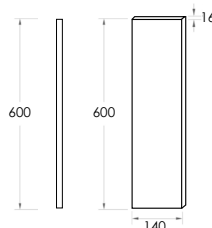

Wall Cabinets Filler
600x140x16mm

LA-FL140BO-W Black Oak RRP: \$29
LA-FL140N-W Natural Oak RRP: \$29
LA-FL140B-W Matte Black RRP: \$29
LA-FL140W-W Matte White RRP: \$29

Washing Machine Cabints Bevel-Grip Finger Pull Double Door

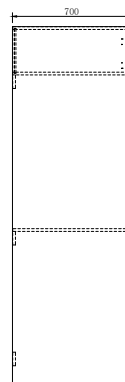
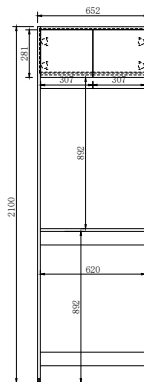

Washing Machine
Cabinet 652mm - 2 Doors
Bevel-Grip Finger Pull

LA-TWBY652B Black Oak RRP: \$1,225
LA-TWBY652N Natural Oak RRP: \$1,225

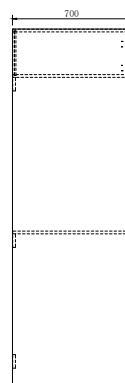
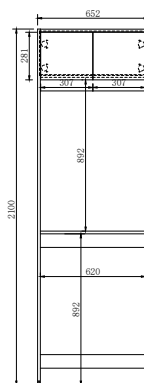

Washing Machine
Cabinet 652mm - 2 Doors
Bevel-Grip Finger Pull

LA-TW652W Matte White RRP: \$1,225
LA-TW652B Matte Black RRP: \$1,225

Cabinet Colour & Finishes

Timber Grain

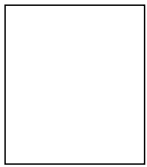

Byron



Black Oak



Natural Oak

Panelled

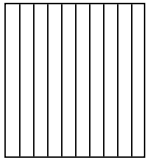

Marlo&Noosa



Marlo Matte Black



Noosa Matte White

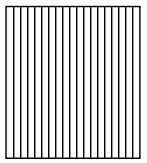

Bondi



Matte White

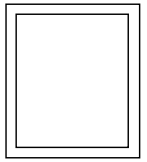

Hampshire



Matte White

Handle Options

Finish Electroplated PVD Handles

Byron, Bondi RRP: \$20 Each
Brushed Gold (Optional Colours available as extra)



Matte Black
BOHANDLE-B200



Brushed Gold
BOHANDLE-G200



Brushed Nickel
BOHANDLE-BN200

Marlo RRP: \$20 Each
Matte Black (Optional Colours available as extra)



Matte Black
MLHANDLE-B



Brushed Gold
MLHANDLE-BG



Chrome
MLHANDLE

Hampshire
Bevel Finger Pull

Laundry Stonetop

20mm Stone Top



Quartz Stone
Pure White

18mm Stone Top



Natural
Carrara



Kitchen & Laundry Accessories

HAND MADE SINK 520X440X220

Pull Out Kitchen & Laundry Mixer

4 Star -7.5L/min
Reg.No.1486

Brushed Finish High Quality
1.2mm 304 Grade Stainless Steel
Radiused Corners for Easy Cleaning
Ideal for Kitchen and Laundry Applications
Basket Wastes Included
Sink is available as an undermount only

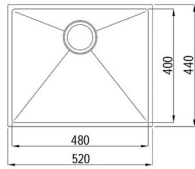

Axon 52S M-CBS-810-52

Outer Dimension:
520X440X220mm
Basket Wastes Included

Included in Packages
RRP:\$250



Axon 52S M-CBS-810-52BG

Brushed Gold
Outer Dimension:
520X440X220mm
Basket Wastes Included

Upgrade to Brushed Gold
Extra \$118 RRP \$368



Axon 52S M-CBS-810-52GM

Gun Metal
Outer Dimension:
520X440X220mm
Basket Wastes Included

Upgrade to Gun Metal
Extra \$118 RRP \$368

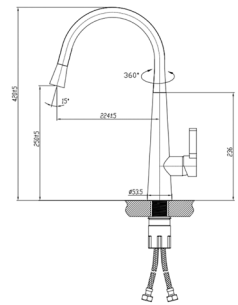

Chrome	PKM004	RRP:\$377
Black	PKM004-B	RRP:\$416
Brushed Nickel	PKM004-BN	RRP:\$450
Gun Metal	PKM004-GM	RRP:\$536
Brushed Gold	PKM004-BG	RRP:\$536



LAUNDRY STONE TOP COLLECTION

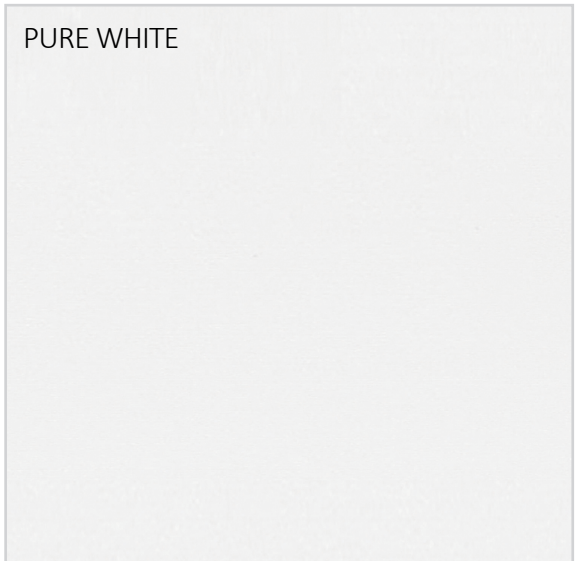
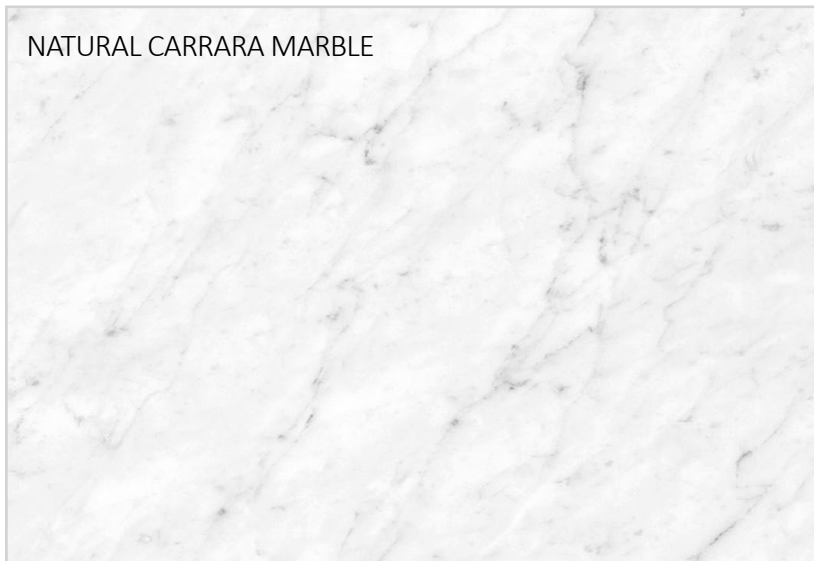

NATURAL CARRARA MARBLE

PURE WHITE

- STLA650-NCA: 650X600X18mm Natural Carrara vanity top RRP: \$350
- STLA1060-NCA: 1060X600X18mm Natural Carrara vanity top RRP: \$525
- STLA1300-NCA: 1300X600X18mm Natural Carrara vanity top RRP: \$620
- STLA1960-NCA: 1960X600X18mm Natural Carrara vanity top RRP: \$1,298

- STLA650-PW: 650X600X20mm Ultra Deluxe vanity top RRP: \$350
- STLA1060-PW: 1060X600X20mm Ultra Deluxe vanity top RRP: \$525
- STLA1300-PW: 1300X600X20mm Ultra Deluxe vanity top RRP: \$620
- STLA1960-PW: 1960X600X20 mm Ultra Deluxe vanity top RRP: \$1,298

Features: Material:- Natural Stone Carrara
Universal Pre-Drilled Taphole

Features: Material:- Solid Surface Stone Matte
Universal Pre-Drilled Taphole

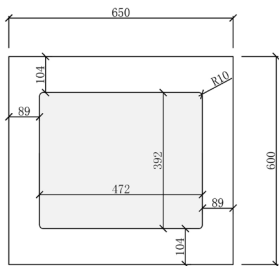

Top View

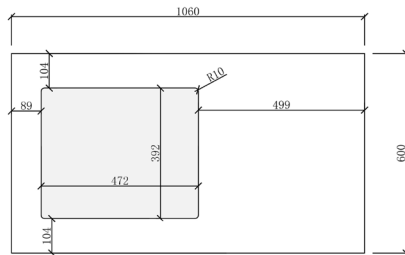

Top View

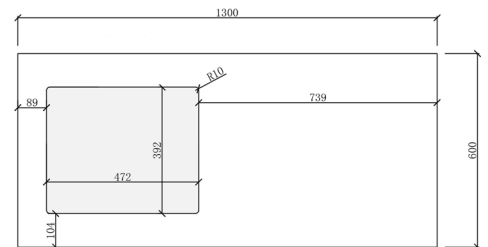

Top View

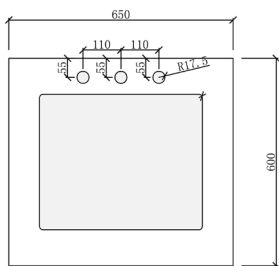

Back View
Pre Semi-Drilling Tapholes

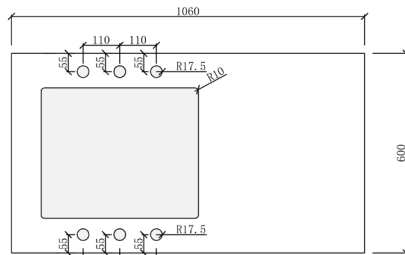

Back View
Pre Semi-Drilling Tapholes

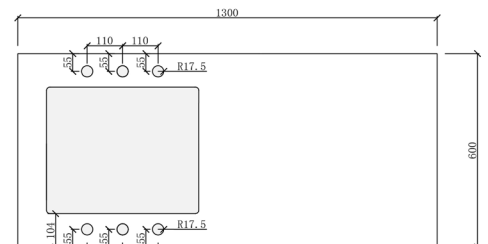

Back View
Pre Semi-Drilling Tapholes

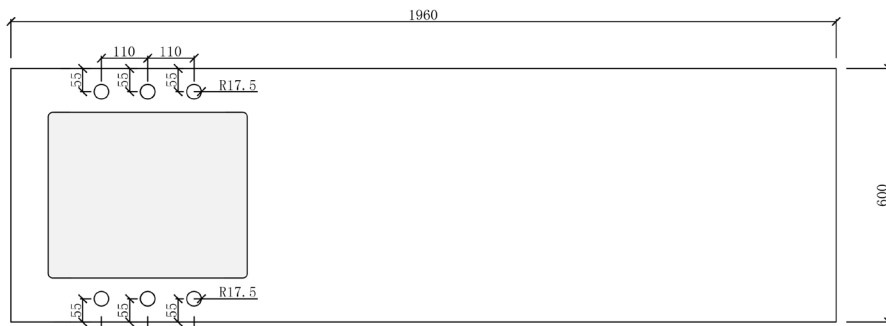

Back View
Pre Semi-Drilling Tapholes

TIPS

Polished All Four-Sided Stone tops can be installed with kitchen sink on left or right, (650mm only 3 Sided). Sink not included

Note: Sink is available as an undermount only.

LAUNDRY CABINET FINISHINGS COLLECTION

Laminated Wood Grain Texture Natural Oak, Black Oak, Matte Black or Matte White + Moisture Resistant Plywood

MARLO
Polyurethane Matte Black
Moisture Resistant Plywood

HAMPSHIRE, BONDI WHITE
Polyurethane Matte White
Moisture Resistant Plywood

BYRON/BONDI
Natural Oak
Moisture Resistant Plywood

BYRON
Black Oak
Moisture Resistant Plywood



Sketch your Layout

Using your measurements, and our module units you can customise your layout.

- Draw in floor, windows, doors, into the grid.
- Each square represents 10cm or 10 x squares = 1 metre
- Draw in plumbing, light switches and electrical points.
- Make sure you have access points for installing - will your joinery fit through your door.
- Draw in water and electrical connections, mark out drainage points.

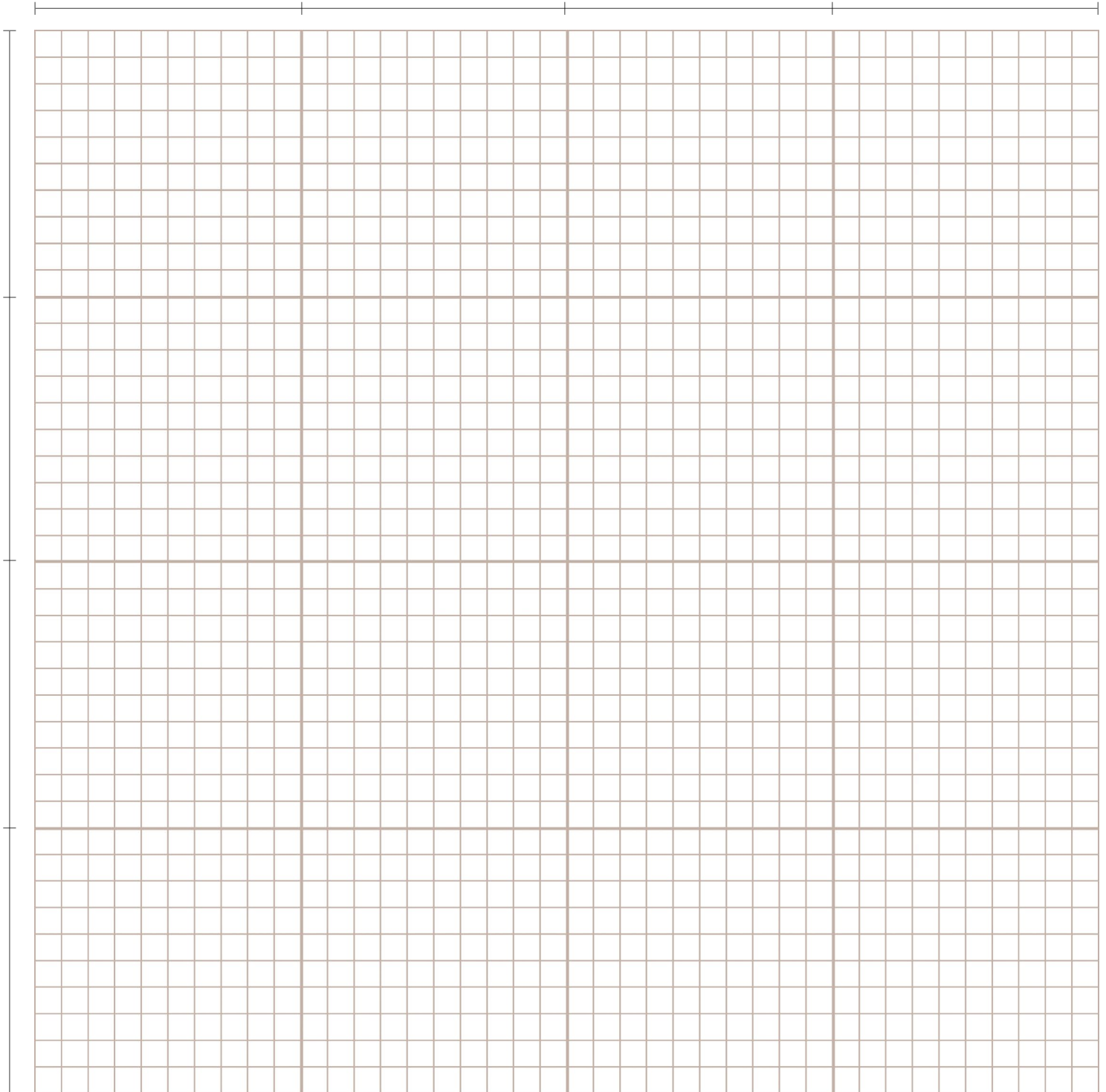

10cm or 10 x squares = 1 metre

MODULAR LAUNDRY SYSTEM ORDER FORM

To make life easy, fill this form, enter quantities in correspondin boxes below.

Email orders@ottiaustralia.com.au

STORE

Store Name	<input type="text"/>	Completed By	<input type="text"/>
Purchase Order No	<input type="text"/>	Date	<input type="text"/>

CUSTOMER DETAILS

Name	<input type="text"/>	Customer Contact No.	<input type="text"/>
Customer Signature	<input type="text"/>	Customer Email	<input type="text"/>

MODULAR LAUNDRY SYSTEM

TIMBER GRAIN RANGE

Bondi /Byron Natural Oak

Bondi /Byron Black Oak

HANDLE

Bondi Matte Black

Bondi Brushed Gold

Bondi Brushed Nickel

PANELLED RANGE

Hampshire Matte White

Hampshire Matte Black

PANELLED RANGE

Noosa Matte White

Bondi Matte White

Marlo Matte Black

HANDLE

Finger Pull

HANDLE

Bondi Matte Black

Bondi Brushed Gold

Bondi Brushed Nickel

Marlo Matte Black

Marlo Brushed Gold

Marlo Brushed Nickel



MODULAR LAUDRY SYSTEM

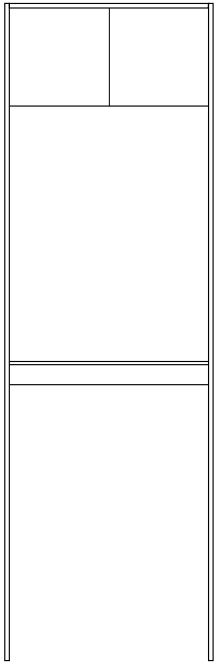

Tall Tower Cabinet

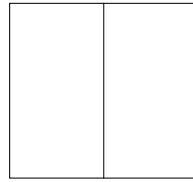

Wall Cabinet 630



Wall Cabinet 416

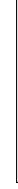

Wall End Panel



Wall Filler Panel

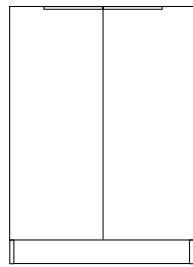

Floor Cabinet 630



Floor Cabinet 416



Floor End Panel

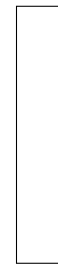

Floor Filler Panel



STONE TOP

STONE

Natural Carrara



Pure White



STONE SIZE

650mm



1060mm



1300mm



1960mm



SINK

SINK - Undermount

Stainless Steel



Brushed Gunmetal



Brushed Gold



WARRANTY

NOTE: Unless otherwise stated warranties for Otti Australia products are as follows:-

PRODUCTS	DOMESTIC WARRANTY Product Replacement	COMMERCIAL WARRANTY Product Replacement
Laundry Cabinet	10 years	12 Months
Kitchen Sink	10years	12 Months
Stone Tops	10 years	12 Months

All products Parts and labour - 12 Months

This warranty only applies to defects which have arisen solely from faulty materials or workmanship in the Products. Our products come with guarantees that cannot be excluded under the Australian Consumer Law. A replacement or refund will be offered for any major failure, upon inspection by an authorised representative where a product is found to be defective in construction, material or assembly. Goods maybe repaired or replaced if the goods fail to be of acceptable quality and the failure does not amount to a major failure.

The warranty does not apply to other defects which may have arisen as a result of, without limitation, the following: accidental damage, abnormal stress or strain, harsh or adverse weather conditions, abuse, misuse, mistreatment including excessive water pressure, temperature, or neglect of any kind of the products. Alterations and repairs of the Products other than by an accredited and licensed service agent or technician are not covered.

CONDITIONS

1. Items must be installed by a licensed tradesperson.
2. Failure is due to a fault in the manufacture of the product.
3. Proof of purchase is provided.
4. The installation of the product is in accordance with the instructions provided.

EXCLUSIONS

To the fullest extent permitted by law, the manufacturer excludes all liability for damage or injury to any person, damage to any property and any indirect consequential or other loss or damage. Manufacturer will not be liable for the cost of installation or removal of any unit and the warranty will be VOIDED if damage occurred during or after INSTALLATION or a damaged or incorrect unit has been installed. Door and drawer adjustment; Unsuitable or improper use; Incorrect installation or installation not in accordance with the instructions provided; Installation or part installation by the purchaser or any person other than a LICENSED tradesperson; Normal wear and tear; Inadequate or complete lack of maintenance; water damage; chemical, electrochemical or electrical influences; excessive heat damage or Harsh detergents or abrasive cleaners used on product finishes, are NOT considered a warranty issue.

To Make a claim:-

For all warranty queries customers are to contact the branch where the product was purchased. These details can be found on your purchase invoice. Please provide them with photos or/video or issue if applicable, to illustrate issue clearly.

Login to our website portal and entry you details into the Customer Warranty Request Form.

<https://www.ottiaustralia.com.au/page/5/warranty>

SERVICE CALL OUT FEES & CHARGES

In the event of a call out for issues covered under the OTTI manufacturer warranty, no call out fees apply.

If Otti Australia is called out and the cause of the issue falls within the warranty exclusions or the installation instructions have not been adhered to, the following charges will apply:

- Call out fee: \$200.00 initial cost, first 15 minutes included.
- Service time onsite: \$30/ billed in 15 minute increments.
- Call out times: Business hours 9am - 5pm.

Note: Response time will depend on technician availability.

PRODUCT CARE AND MAINTANCE

Solid Surface Basins

Everydaycare cleaning of Otti Australia Solid Surface products, to remove dirt and grime that may build up on the surface, can be removed with a simple wipe using a damp soapy sponge or cloth,

Joinery

Everydaycare cleaning of Otti Australia cabinets products, to remove dust or dirt that may build up on the surface, can be removed with a simple wipe using a damp soapy sponge or cloth.



otti
australia

VOGUE

ArchiPro.

www.ottiaustralia.com.au

Available from all leading bathroom retail stores. Go to www.ottiaustralia.com.au/ stockists to find a stockists near you. Due to limitations in the printing process the colours in this catalogue are guide only. All measurements within this catalogue are nominal and are subject to change. Specifications correct at time of printing 02/2023. Please visit www.ottiaustralia.com.au for most current technical information.



@ottiaustralia