

CARITA WALL HUNG

Code: CAWH47-750

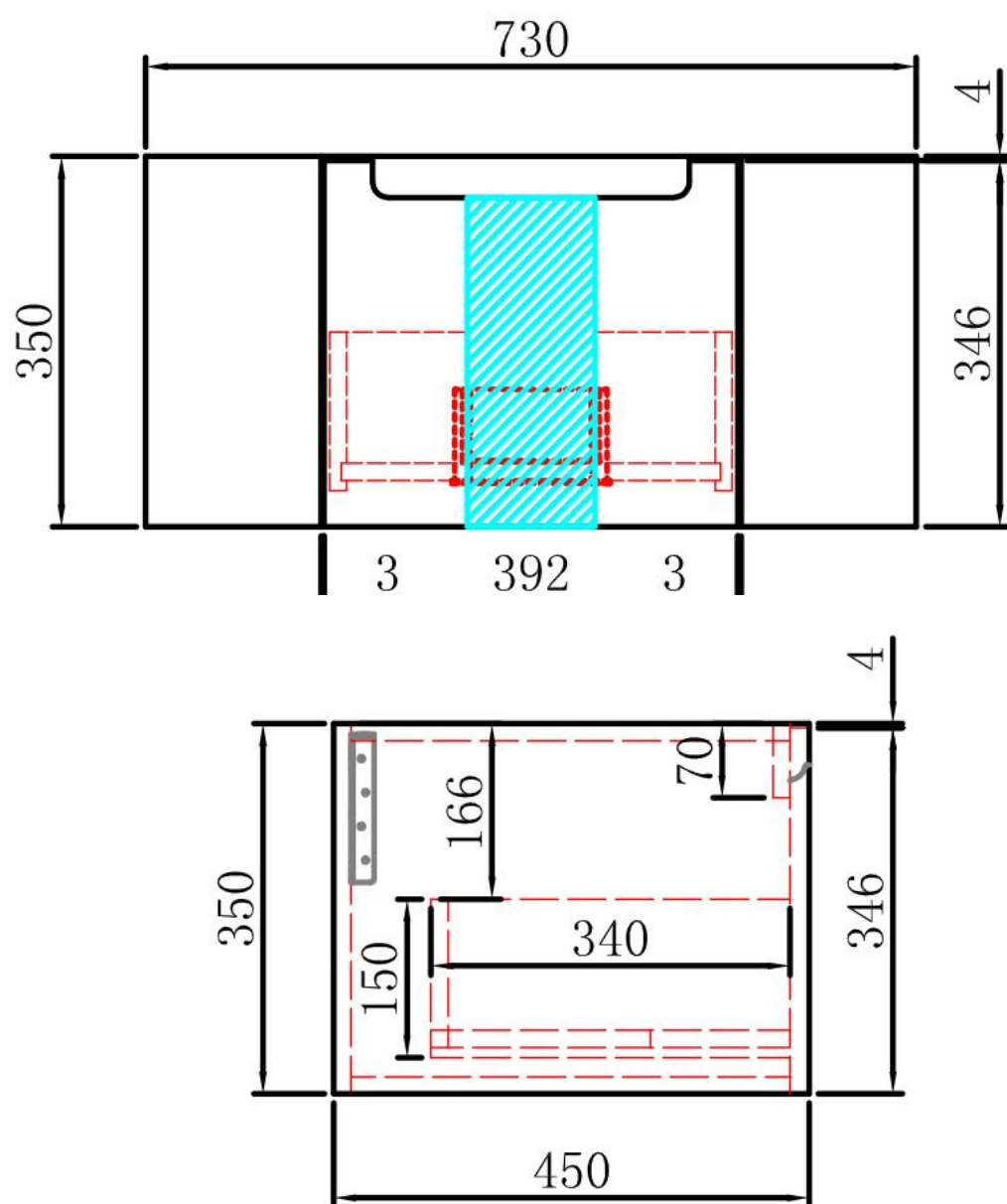

Features:

- All-drawers model with curved feature ends.
- Premium-grade, durable timber plywood
- Natural Timber grains with hard wearing laminate finish
- Hettich Quadro S full extension, soft close drawer runners
- Minimalist L-rail design finger pull drawers
- Drawer Organiser included
- Premium graphite interior



CARITA WALL HUNG

Code: CAWH47-900

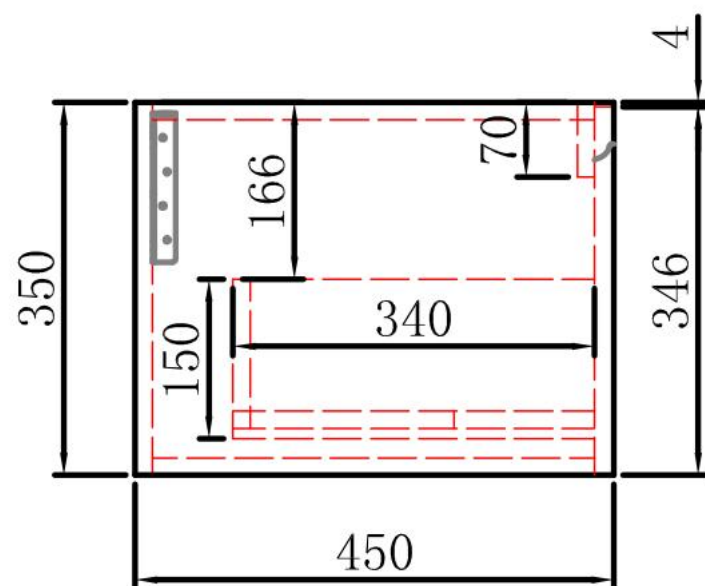
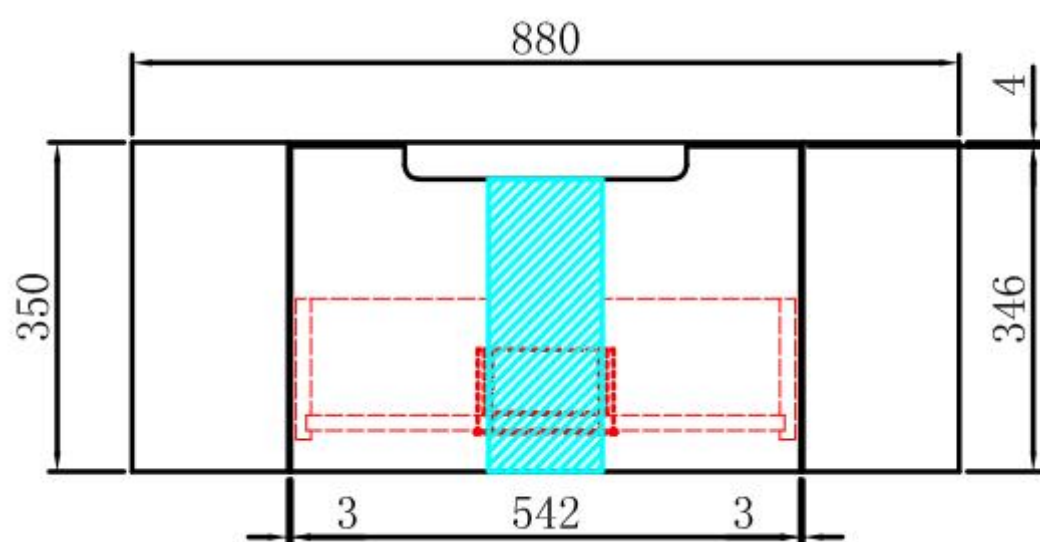

Features:

- All-drawers model with curved feature ends.
- Premium-grade, durable timber plywood
- Natural Timber grains with hard wearing laminate finish
- Hettich Quadro S full extension, soft close drawer runners
- Minimalist L-rail design finger pull drawers
- Drawer Organiser included
- Premium graphite interior



CARITA WALL HUNG

Code: CAWH47-1200

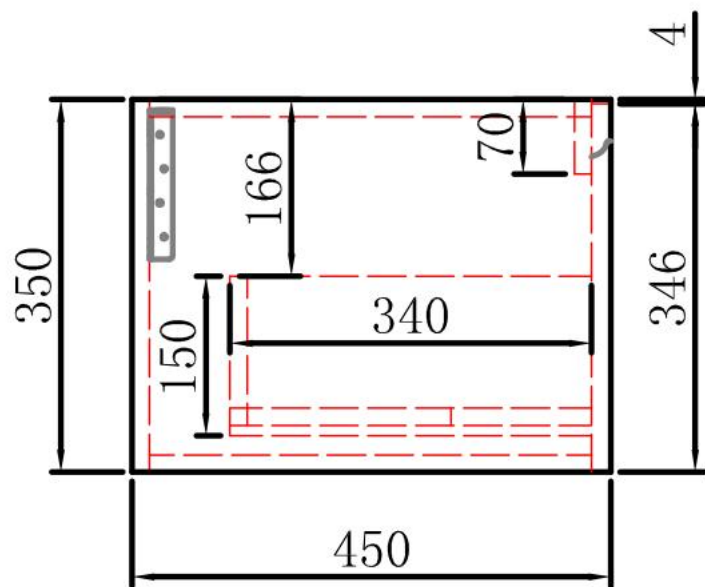
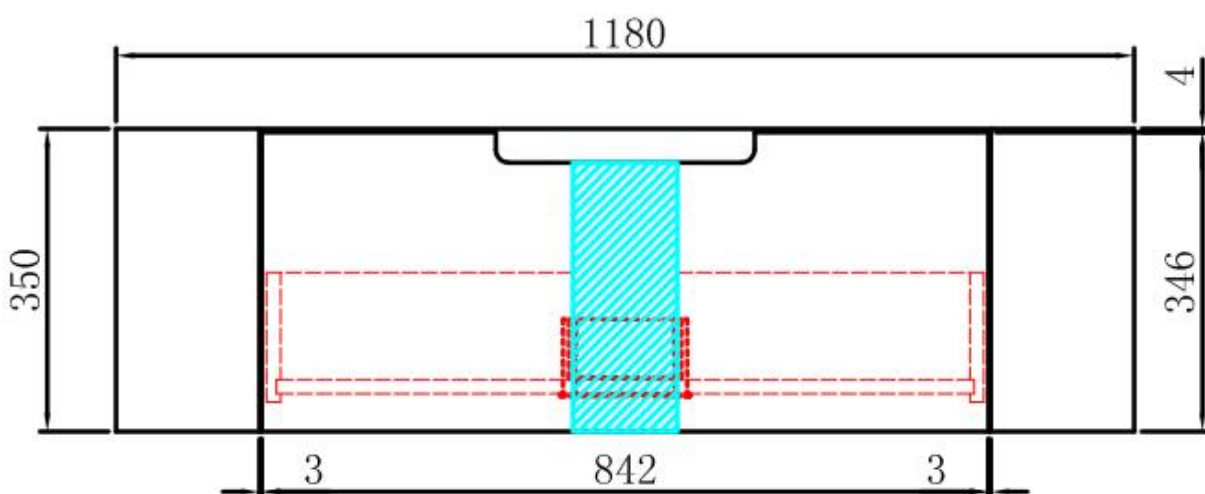

Features:

- All-drawers model with curved feature ends.
- Premium-grade, durable timber plywood
- Natural Timber grains with hard wearing laminate finish
- Hettich Quadro S full extension, soft close drawer runners
- Minimalist L-rail design finger pull drawers
- Drawer Organiser included
- Premium graphite interior



CARITA WALL HUNG

Code: CAWH47-1500

Features:

- All-drawers model with curved feature ends.
- Premium-grade, durable timber plywood
- Natural Timber grains with hard wearing laminate finish
- Hettich Quadro S full extension, soft close drawer runners
- Minimalist L-rail design finger pull drawers
- Drawer Organiser included
- Premium graphite interior

