

SAVIO WALL HUNG

Code: CAWH45-750

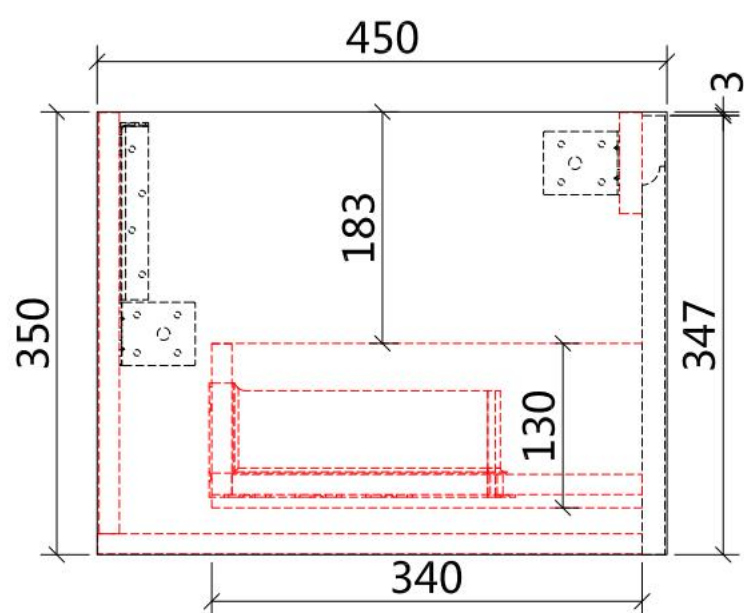
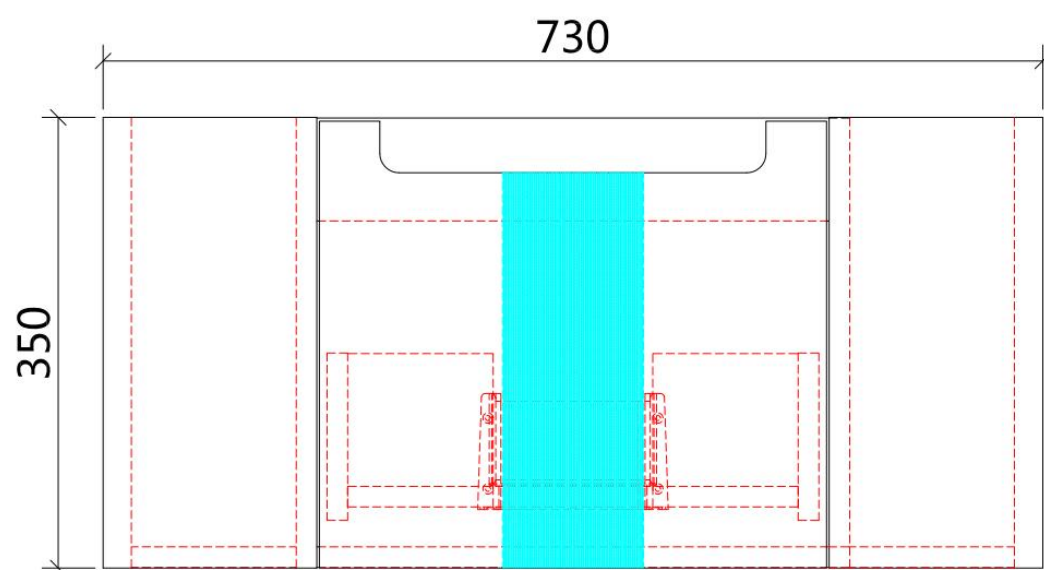

Features:

- All-drawers model with curved feature ends.
- Premium-grade, durable timber plywood
- Contemporary V-groove in matte white polyurethane finish
- Hettich Quadro S full extension, soft close drawer runners
- Drawer Organiser included
- Hettich Quadro S full extension, soft close drawer runners
- Premium graphite interior



SAVIO WALL HUNG

Code: CAWH45-900

Features:

- All-drawers model with curved feature ends.
- Premium-grade, durable timber plywood
- Contemporary V-groove in matte white polyurethane finish
- Hettich Quadro S full extension, soft close drawer runners
- Drawer Organiser included
- Hettich Quadro S full extension, soft close drawer runners
- Premium graphite interior

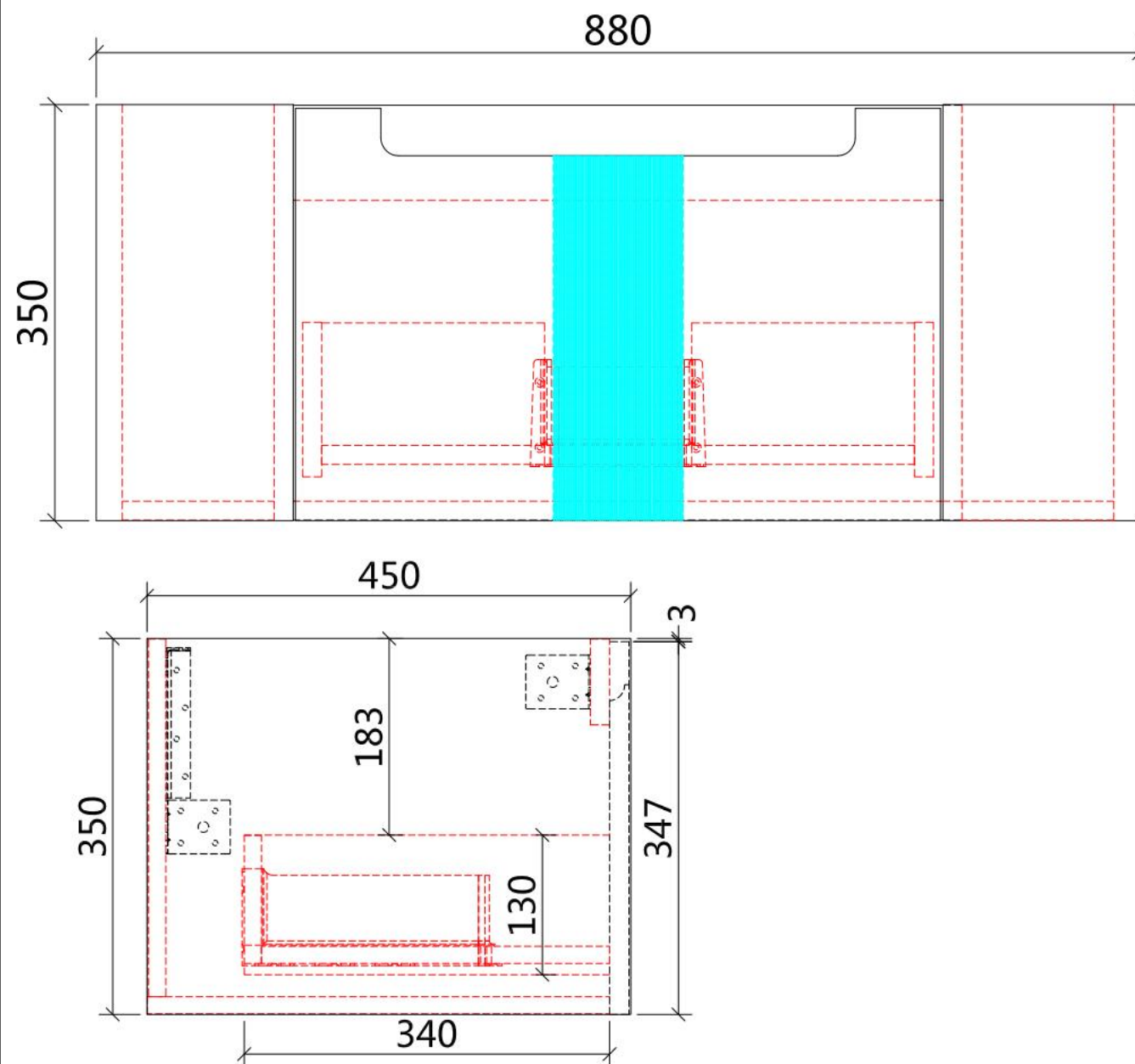

SAVIO WALL HUNG

Code: CAWH45-1200

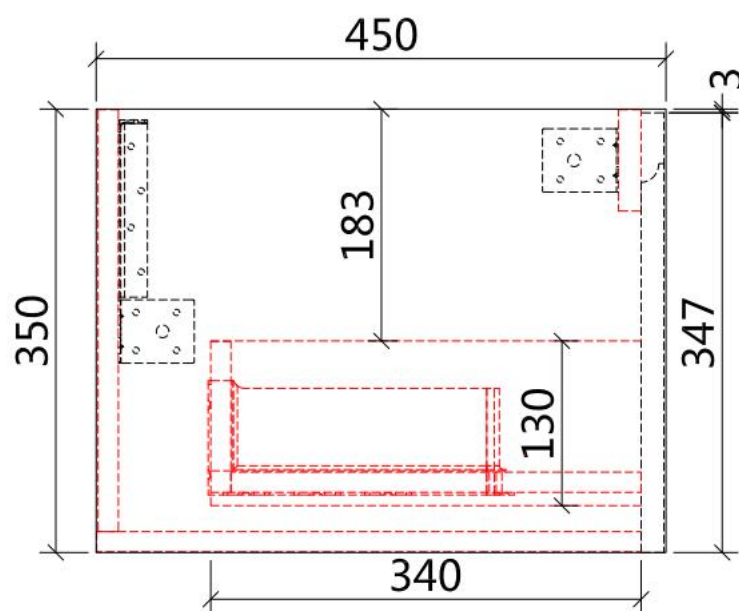
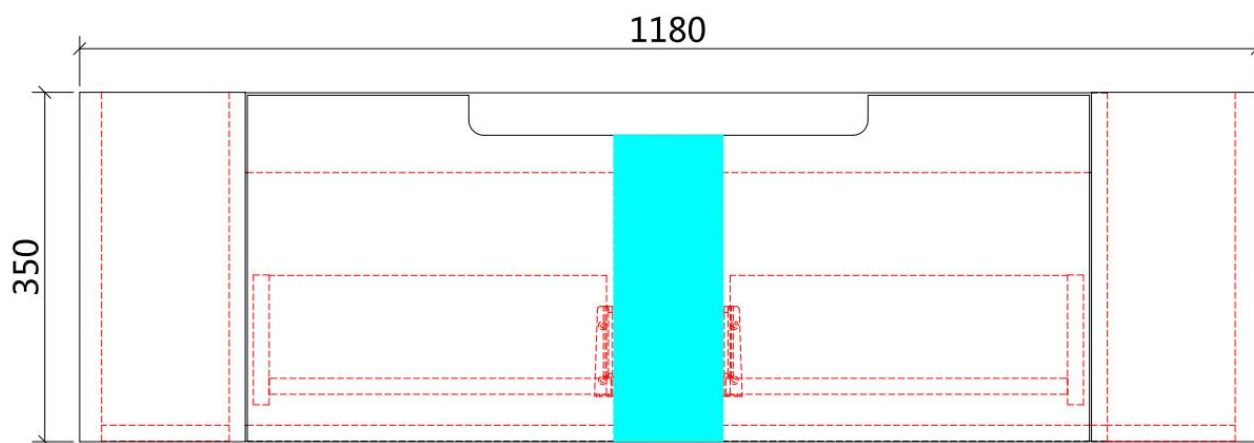

Features:

- All-drawers model with curved feature ends.
- Premium-grade, durable timber plywood
- Contemporary V-groove in matte white polyurethane finish
- Hettich Quadro S full extension, soft close drawer runners
- Drawer Organiser included
- Hettich Quadro S full extension, soft close drawer runners
- Premium graphite interior



SAVIO WALL HUNG

Code: CAWH45-1500

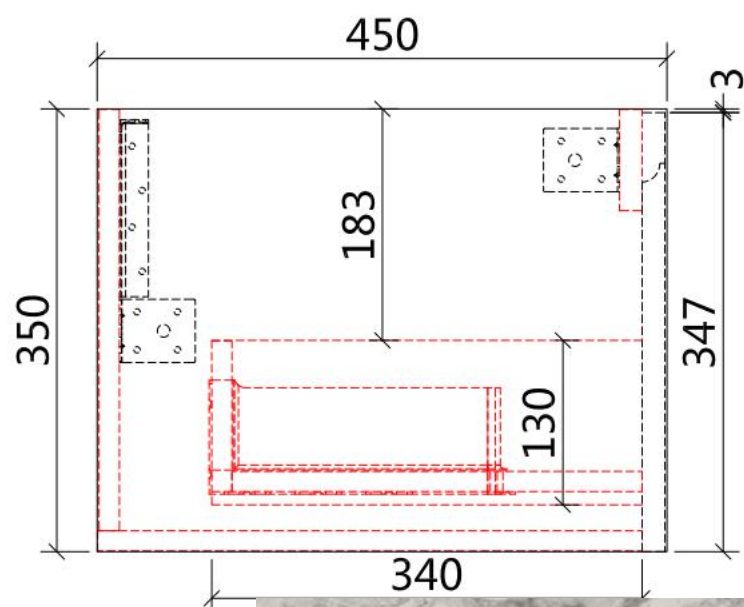
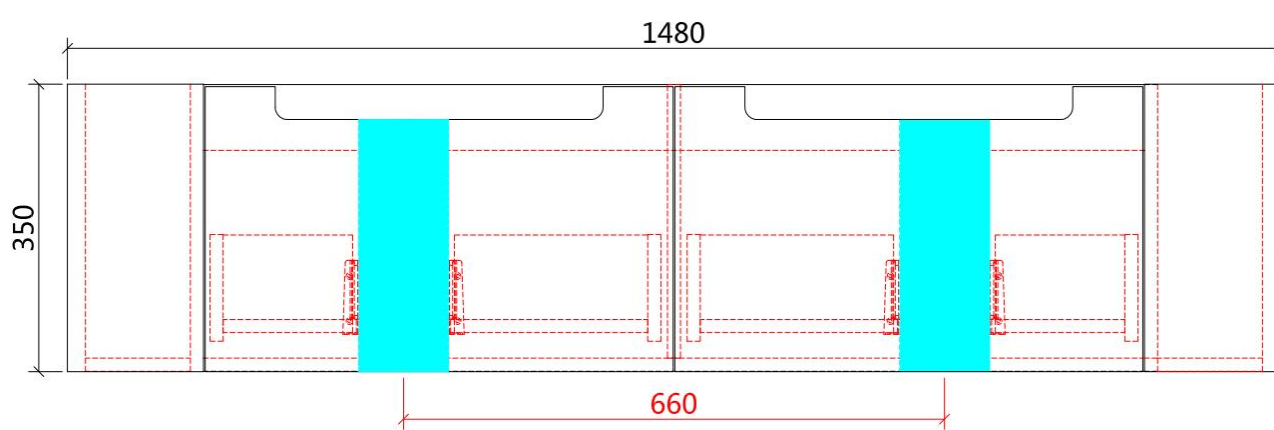

Features:

- All-drawers model with curved feature ends.
- Premium-grade, durable timber plywood
- Contemporary V-groove in matte white polyurethane finish
- Hettich Quadro S full extension, soft close drawer runners
- Drawer Organiser included
- Hettich Quadro S full extension, soft close drawer runners
- Premium graphite interior

