

尺寸 : 90\*130mm 双面印刷

157g铜版纸

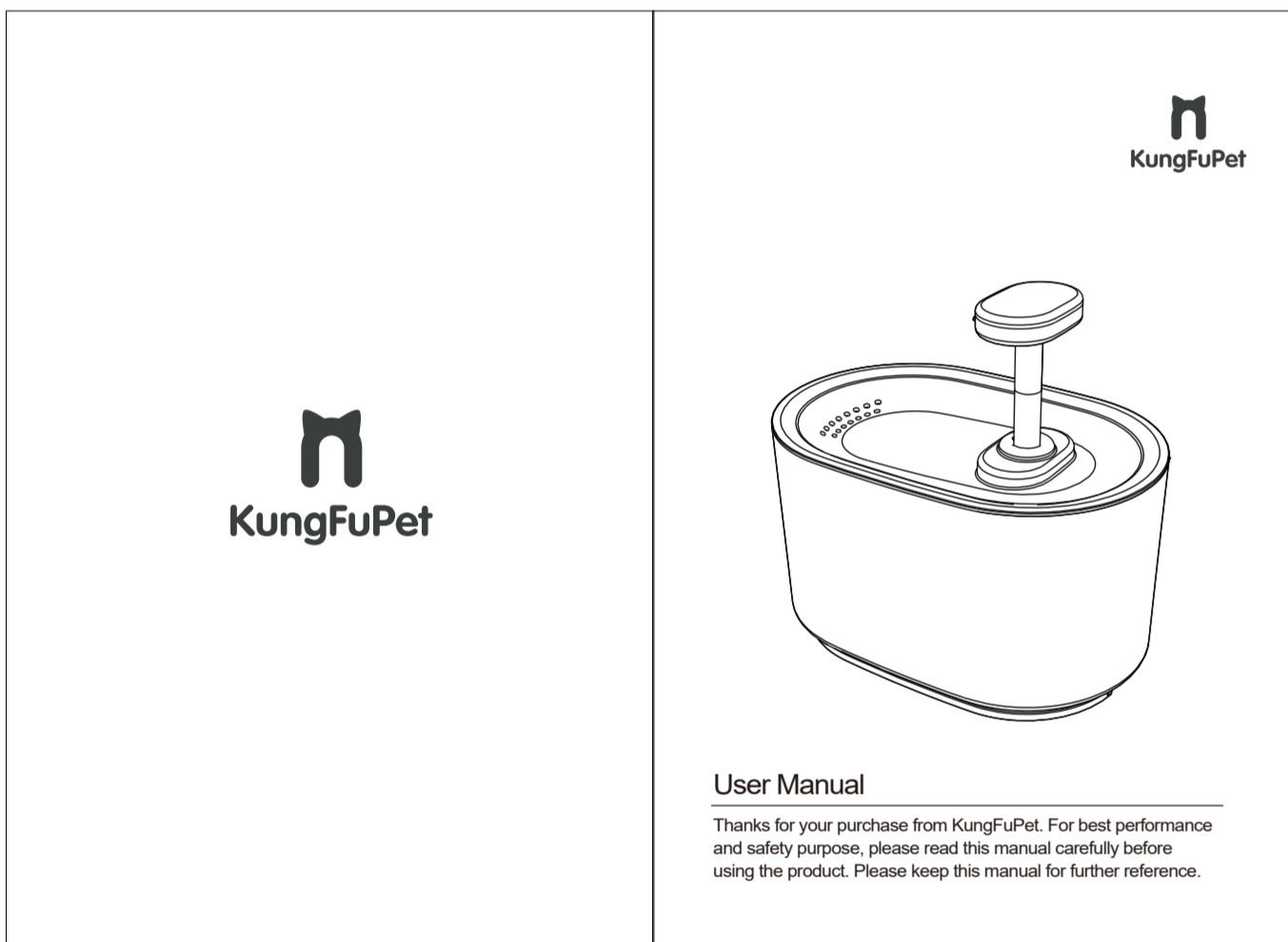

**PRODUCT STANDARD**

PRODUCT NAME Source of purity fountain  
 INPUT VOLTAGE DC 5V  
 OUTPUT VOLTAGE 5V  
 WATER PUMP Charging water pump  
 POWER 0.5-1.6 W  
 PRODUCT SIZE 240mm(L)x160mm(W)x225(H)  
 PRODUCT WEIGHT 0.8 kg  
 LINE LENGTH 1.5 m  
 SHELL MATERIAL PC  
 FILTRATION SYSTEM Coconut shell activated carbon with high iodine content + ion exchange resin  
 CAPACITY 3.5 L

**IMPORTANT REMINDERS**

FOR INDOOR USE ONLY!  
 To avoid the possibility of the plug or outlet getting wet. Put power adapter in higher position of pet fountain unit. Runs on AC12V power adapter, other brand power adapter is prohibited.  
 Do not allow the water level to fall below the pump under the bottom, or the pump may run dry and burn out.  
 Make sure the cord does not have any frayed or exposed wires due to pet's possibly chewing the cord.  
 Place the pet fountain on a protective surface to guard floor against possible water damage from spillage.  
 In the process of transportation, the ionic resin and granular activated carbon contained in the filter element are easy to cause dust due to the bump friction. It is recommended to add water and electricity the cycle for cleaning for half an hour before use to prevent the phenomenon of black and yellow caused by dust.

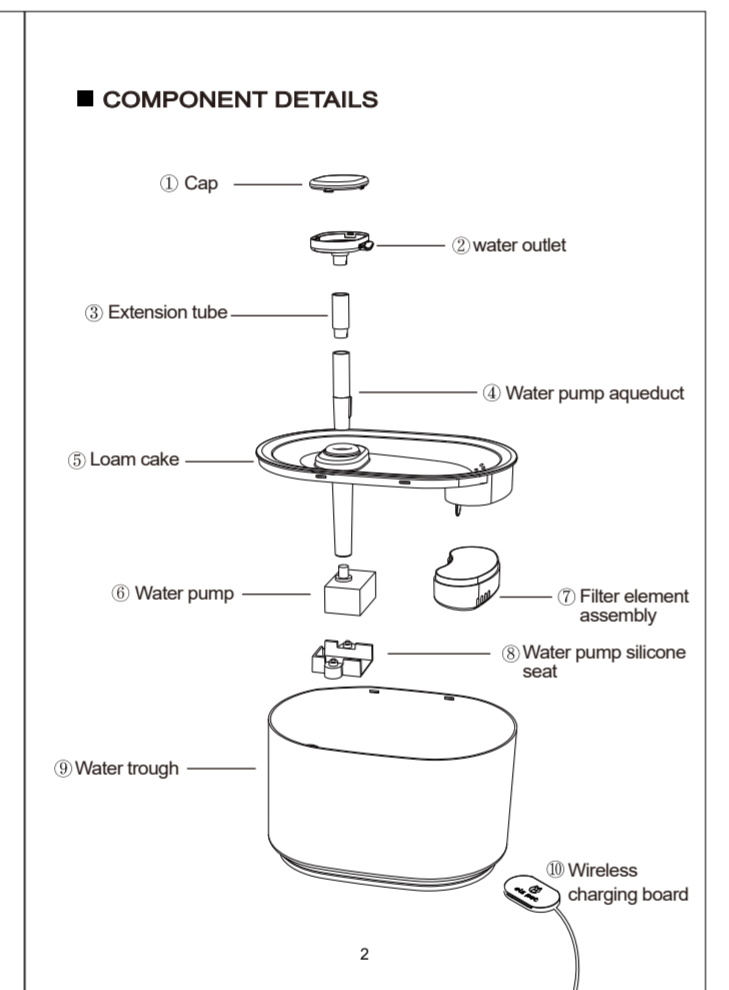

**Q & A TROUBLESHOOTING**

**How frequently do I need to change the filter?**  
 The charcoal filter and foam filter should be changed every 2 to 4 weeks, depending on the number of pets using the fountain. Having more pets that use the fountain will increase the saliva content and debris in the water, so the filter will need to be changed more frequently.

**Why am I finding small black particles in my pet's fountain?**  
 It is common for some residual charcoal dust to seep from the filter. This is perfectly normal and not harmful to your pet in any manner. To help prevent the charcoal dust from shedding, rinse the filter thoroughly under running water before placing inside the fountain.

**How often should I clean the fountain?**  
 Fountain should be clean at least every two weeks. Please clean it once a week if you living in hard water.

**How long will the fountain pump last?**  
 The fountain runs on long life AC Pump. The pump normally last between 2.5-4 years (>20,000 hours). \* the pump has been in regular use for approximately this time period, it may be old and need replacing. We provide full 1-year warranty for pump.

**What's the fountain power consumption?**  
 Fountain runs on a super low power AC pump with power adapter. The power consumption for total unit is about 2.0 Watts so the total power consumption is about 1.5 kWh per month or 18 kWh per year.

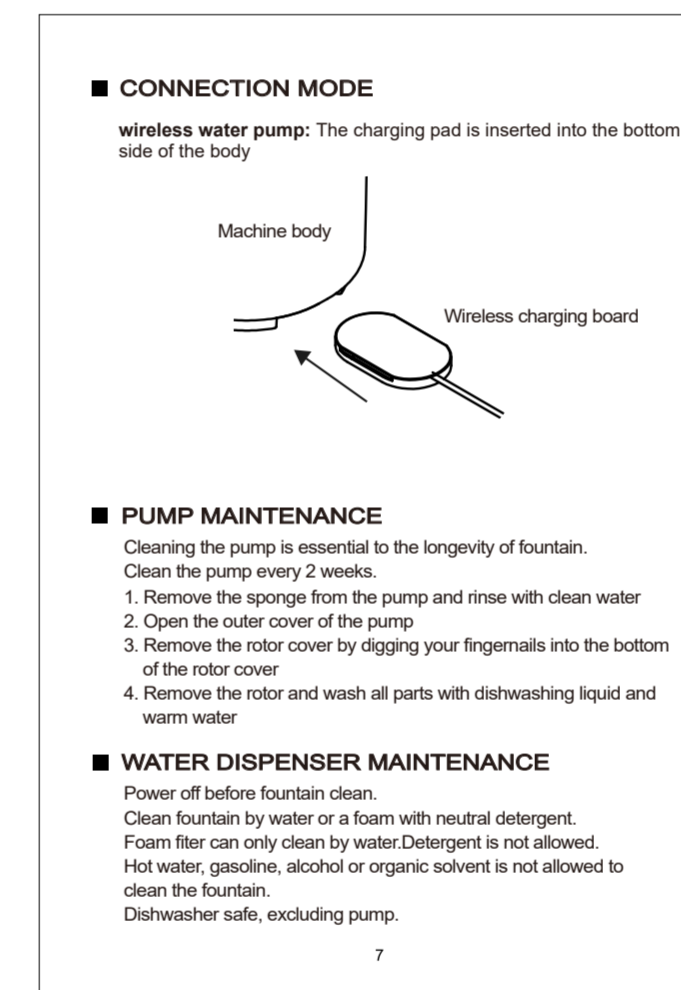
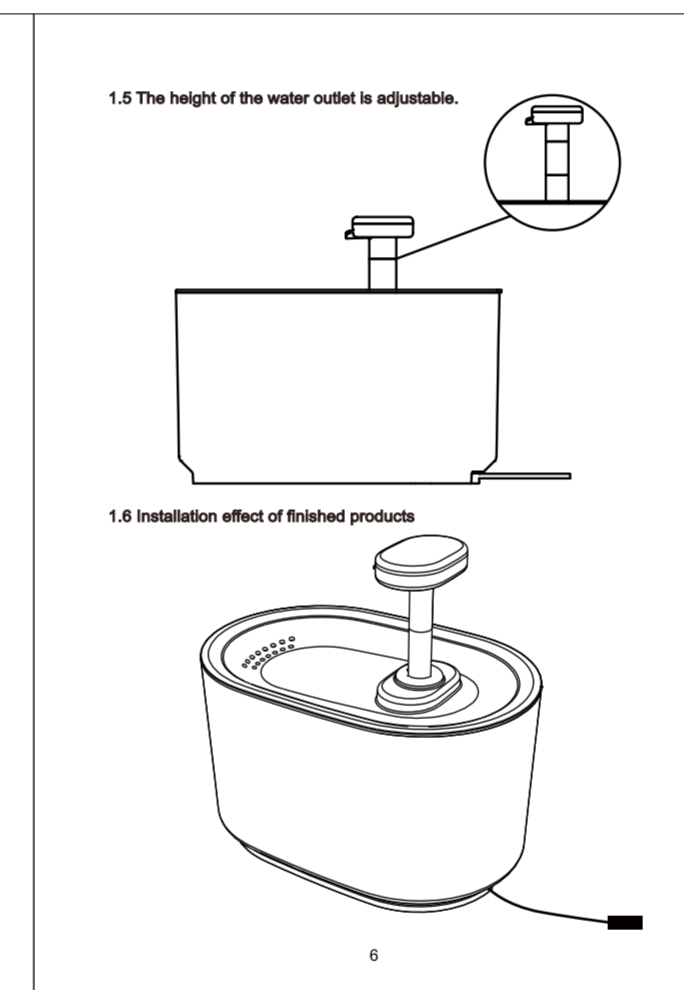
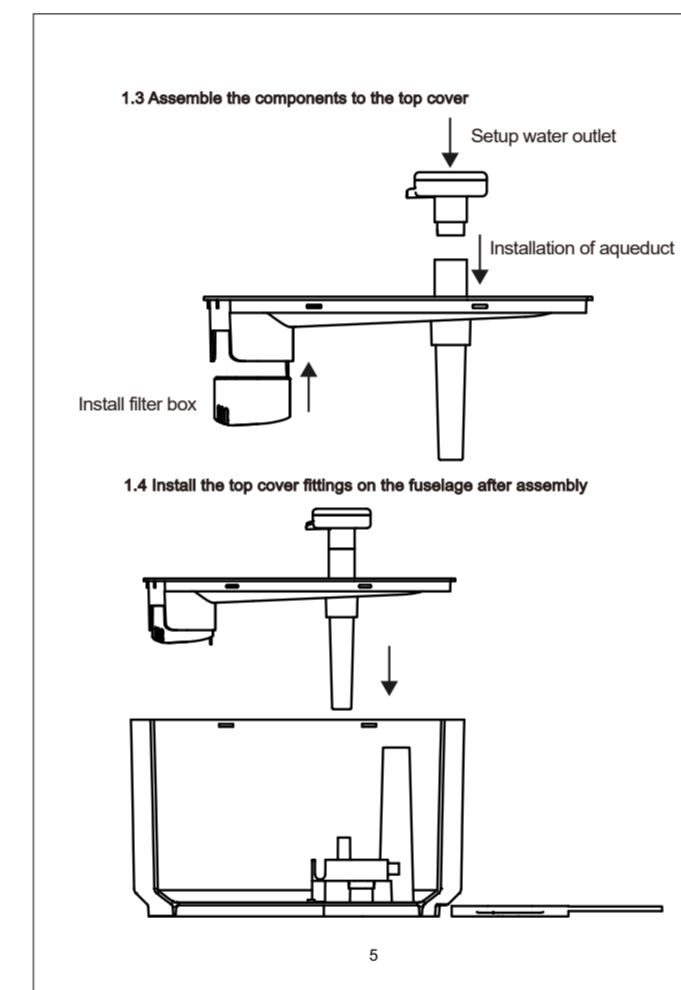
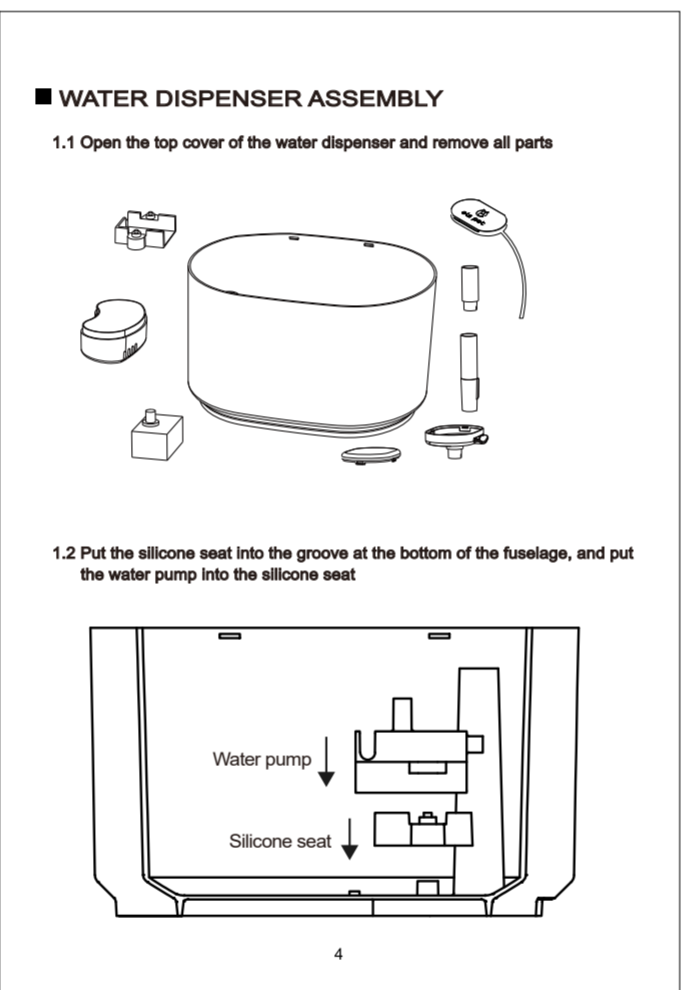

**About product quality issues**

If there is any problem with pet water fountain, please contact us by followed email firstly, we will provide 100% refund or other solutions that satisfy you.  
 Customer service email : support@us-kungfupet.com

**QUALITY ASSURANCE**

During the warranty period, the product performance failure caused by non-human damage can receive the following three packages of services:

- If the product has quality problems within 7 days from the date of purchase, consumers can choose according to the invoice price one-time refund return or replacement of the same model with the same specification of the product
- If the product has any quality problems within 15 days of purchase, consumers can choose replace the products of the same model and specification;
- The warranty period of this product is three months;
- The warranty period of the pump is one year
- This certificate shall not be modified, otherwise it will be deemed invalid;
- This license will become effective only if it is approved by the distributor.

**IT'S NOT WARRANTY POLICY**

The "Three Guarantees" shall not be covered by the following circumstances (but not limited to the following):

- No "Three Guarantees" vouchers or valid invoices are missing or the validity period of "Three Guarantees" service has exceeded;
- Damage caused by failure to use, maintain and keep in accordance with the requirements of the user manual;
- Irresistible damage due to fire, lightning, flood, etc.;
- The product model or serial number on the warranty card is not consistent with the real product.
- Damage caused by demolition and repair by non-One authorized service provider;
- Normal discoloration, wear and wear during the use of the product is not a fault covered by the warranty;
- Improper use by people or bitten by pets.

NAME : \_\_\_\_\_

MAINTENANCE RECORD : \_\_\_\_\_

\_\_\_\_\_

\_\_\_\_\_

\_\_\_\_\_

\_\_\_\_\_

\_\_\_\_\_

SIGNATURE OF REPAIRMAN \_\_\_\_\_ INSPECTION CERTIFICATE \_\_\_\_\_

PRODUCTION DATE: \_\_\_\_\_

SURVEY NUMBER: \_\_\_\_\_