

# AFTER-SALES MAINTENANCE RECORD

For after-sales warranty services, please fill in the warranty card.

S/N	FAULT	ON-SITE	DATE	TIME	CUSTOM	AFTER
1						
2						
3						
4						
5						
6						
7						
8						
9						
10						
11						
12						

Name: .....

Address: .....

Phone: .....

Installation time: .....

# Installation & Instruction Manual

## EV WALL CHARGER



Model No: SETX-1-22-7-AC-02

Item No: 20091

**VORSPRUNG**



**VORSPRUNG**

## 1. TECHNICAL PARAMETERS

S/N	PROJECT	PARAMETERS
1	Project Model	SETX-1-22-7-AC-02
2	Input Voltage	230VAC±10%
3	Current Rating	32A
4	Power Rating	7KW
5	Frequency Rating	50Hz±5%
6	IP Grade	IP55 (Outdoor)
7	Working Temperature	-40°C~+65°C
8	Ambient Humidity	0~95% non-condensation
9	Altitude Permission	≤2000m
10	Operating Instructions	LED

## 2. PRODUCT STRUCTURE

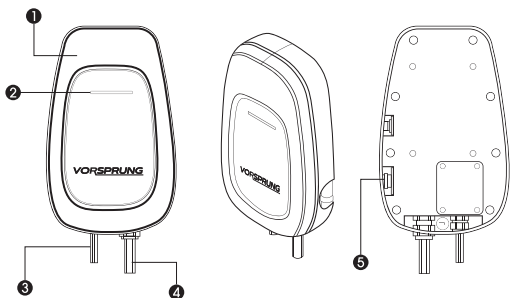

1. UPPER COVER	2. LED LIGHT	3. POWER CABLE
4. CHARGING CONNECTOR	5. EMERGENCY STOP BUTTON	

**NOTE:** Do not use the emergency stop button as a stop switch. If the emergency stop button is pressed, please reset it by twisting the button clockwise.

## 3. OPERATING INSTRUCTIONS

### STEP 1: INSERT CHARGING CONNECTOR

Remove the charging connector from the wall charger and connect to the vehicle inlet. When the connection is successful, it will display a steady blue light.

### STEP 2: CHARGING

When the charging process starts, the light on the wall charger will begin to flash blue.

### STEP 3: CHARGING COMPLETE

When blue light stops flashing the charging is complete. Pull the charging connector out of the car and position it back on the wall charger. The indicator on the wall charger will display a steady green light.

## 4. LIGHT DESCRIPTION

S/N	ACTION/STATUS	LIGHT	LIGHT RESOLUTION
1	Standby	Steady Green	Standby
2	Plug in the gun	Steady Blue	Connected to the car end
3	Charging	Blue Flashing	Charging
4	Fully Charged	Steady Blue	Charging is complete
5	Pull out the connector	Steady Green	Standby
6	Emergency stop	Failure Red light flashes (1 fast and 1 slow)	Emergency stop is pressed
7	CP abnormal failure	Red light flashes (2 fast and 2 slow)	CP voltage is abnormal
8	Short circuit fault	Red light flashes (5 fast and 2 slow)	Output short circuit
9	Overcurrent fault	Red light flashes (2 fast and 1 slow)	Abnormal current
10	Overvoltage fault	Red light flashes (4 fast and 1 slow)	Abnormal voltage
11	Under-voltage fault	Red light flashes (3 fast and 2 slow)	Abnormal voltage
12	Adhesion failure	Red light flashes (6 fast and 2 slow)	Output adhesion
13	Leakage fault	Red light flashes (3 fast and 1 slow)	Leakage
14	Leakage self-test failure	Red light flashes (5 fast and 1 slow)	Leakage self-test failure

## 5. FACTORY INSPECTION LIST

S/N	ITEM	ACCEPTANCE CRITERIA	RESULTS
1	Interior Appearance	The writing is correct, the screws are fastened	OK
2	Overall Appearance	Visually free of appearance defects, fully identified	OK
3	Electrical Inspection	General on check, short-circuit check, ground check	OK
4	Safety Check	Insulation resistance and dielectric strength	OK
5	Function Check	Power-on light with on-board charging	OK
6	Charging Connector	IEC 62196-2	OK
7	Accessories Package	Complete materials, no omissions	OK
8	Package Inspection	Complete materials, no visual defects	OK

## 6. PACKAGE LIST

S/N	NAME	SPECIFICATIONS	NUMBER	NOTE
1	AC Wall Charger		1	
2	Product description		1	
3	Ziplock bag		1	
4	Anti-theft screws	M4 x 10 with lock core	2	
5	Combining screws	M6 x 12	4	
6	Bolt	M6 x 16	4	
7	Internal forced expansion anchor	M6 x 25	4	
8	Mounting board	145 x 145 x 250	2	
9	Hook	75 x 45 x 60	1	
10	Plastic expansion tube	M6 x 30	3	
11	Self-tapping screw	M4 x 30	3	

## 7. INSTALLATION GUIDANCE

### 7.1 Installation Precautions

Before installing, read the installation instructions carefully, paying special attention to the following:

**1)** This wall charger installation needs to be carried out by a professional in strict accordance with the installation steps and standards of construction. Non-qualified installers may cause damage to the wall charger and improper installation of the wall charger will invalidate the warranty.

**2)** If the site to be installed is under construction do not install immediately, to avoid damage to wall charger with building materials, dust, paint, etc.

**3)** Before wiring ensure the power is turned off.

**4)** Wall charger uses a dedicated power supply or interface. Must be good ground and fire zero wiring is strictly prohibited to reverse.

**5)** When installing, wear protective gloves to prevent injury.

**6)** Please use correct attachments for installation, the installation of expansion bolts and wall holes must be closely coordinated.

**NOTE:** Before installation, please follow the packing list and check the components are complete. If not complete, please contact the company in a timely manner.

### 7.2 Installation Tool List

S/N	NAME
1	Electric impact drill
2	Scale (5m)
3	Electrician gloves
4	Cross screwdriver
5	Inner hex wrench (5mm)
6	PVC insulation tape
7	T15 Anti-theft wrench

### 7.3 Positioning Installation

The corresponding fastening bolts should be prepared prior to installation, with the following parameters:

SCREW MODEL	NUMBER	USE
M6 x 25 (Inside Force Expansion Anchor)	4	Installation of wall panels to wall or column to the base

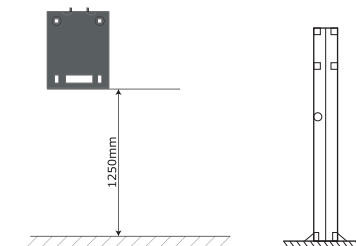

Use the wall mount or column to determine the installation position (recommended height of 1250mm). Then screw the mounting board onto the wall or column and fix the wall charger onto the plate.

## 8. INSTALLATION & WIRING INSTRUCTIONS

Needs to meet the following requirements:

**1)** The wall charger should have a separate distribution circuit and should not be shared with other electrical products.

**2)** 7.0KW inlet cable requirements of 6mm inlet crimping terminal.

**3)** In order to prevent electric shock, ensure the input ground is securely grounded in accordance with the installation instructions. Prohibit use of multiple core plugs in front of the wall charger.

**NOTE:** Must be installed and fitted by a qualified fitter.