

**In Common With**

Augustus Mirror  
*Technical Specifications*



# Augustus Mirror



## Technical Specifications

Materials	Ceramic, mirrored glass, brass
Product weight	40 lb
Lead time	16 weeks
Bulbs included	Low Voltage Flexible LED Module/ 2300lm/ 1800K-3000K/ warm on dim
Dimmer	ELV dimmer
Max wattage	38 W
Certifications	UL listed, damp-rated



## Notes

1. This fixture is handmade, and may exhibit variability within the same piece. We do our best to maintain a consistent product, but honor the handmade craftsmanship.
2. Dimensions may vary within an inch.

Updated February 28, 2023

Front View

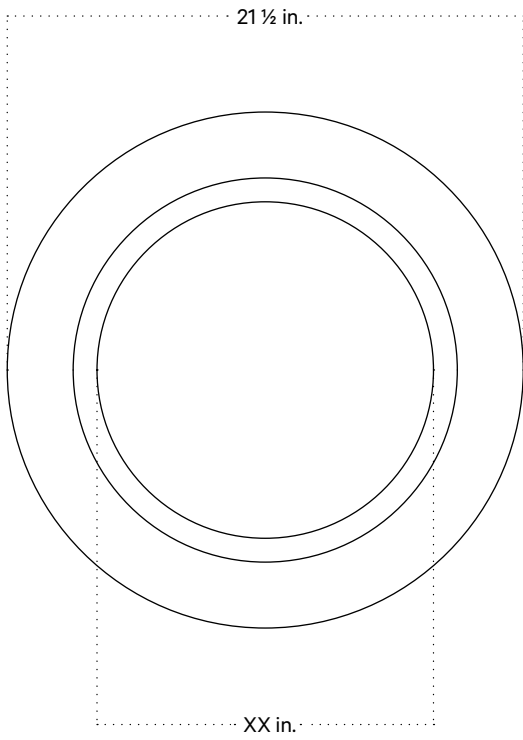

Side View



Top View

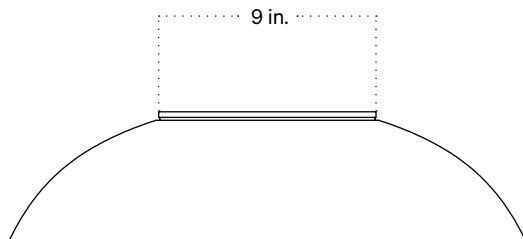

Isometric View

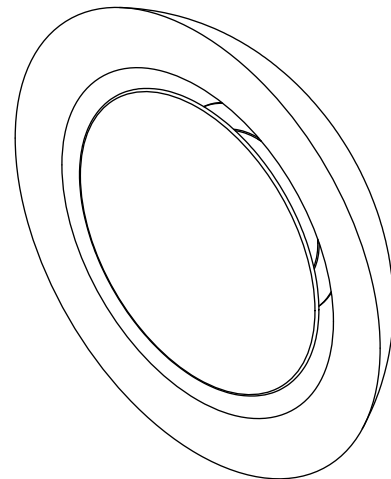

## Finish Options

*Brass, glass, and ceramic samples made or finished by hand may exhibit variability. Available for purchase at [incommonwith.com/finishes](http://incommonwith.com/finishes).*

---

### Ceramic



Stone



Anthracite



Chestnut



Ivy



Lapis



Terrasig

---

### Brass



Brass



Patina Brass

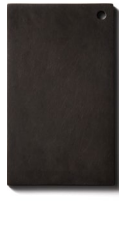

Blackened Brass