

Fitting Instructions: Day and Night Blinds

YOU SHOULD HAVE:



Brackets



Tie down Safety Clip

TOOLS NEEDED:



Metal tape measure



Pencil



Drill



Crossheaded screwdriver

INSTRUCTIONS

1.

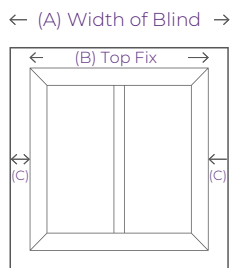

THE INSTALLATION OF THIS PRODUCT SHOULD BE CONDUCTED BY SOMEONE COMPETENT IN DIY.

OUTSIDE RECESS

If the blind is to be fitted outside the window ensure that measurement C is the same. Follow instructions for FACE FIXING. To calculate C $(A-B)/2$.

INSIDE RECESS

TOP FIX to the lintel. FACE FIX bracket to the window frame.

FACE FIXING

Hold each bracket into place and mark the hole positions. Fit each bracket using suitable screws. Please ensure fixings are suitable for the wall/surface to which you are mounting the brackets.

Open

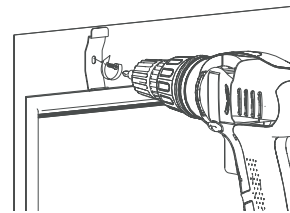

Cassette

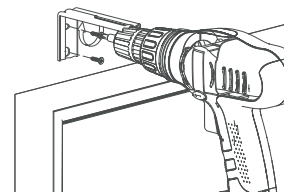

Open/cassette

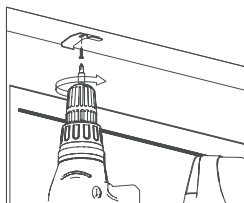

2.

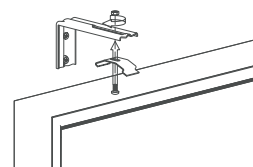

TOP FIXING

Position the brackets allowing for obstructions like handles that protrude into the recess area. Hold each bracket into place and mark the hole positions. Fit each bracket using suitable screws. Please ensure fixings are suitable for the wall/surface to which you are mounting the brackets.

Fitting Instructions: Day and Night Blinds

INSTRUCTIONS

3.

Face Fix

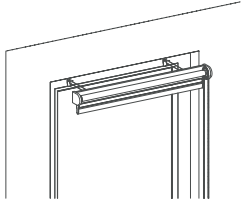

Top Fix

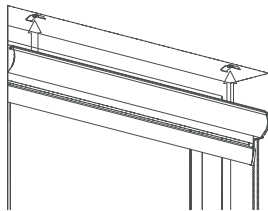

OPEN

4.

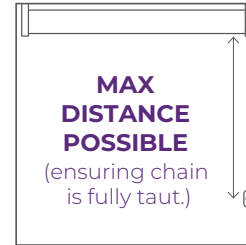

SAFETY DEVICE

The safety device must be installed at the maximum distance possible from the control mechanism to prevent looped chain becoming slack. Place the safety device on the wall and mark the positioning of the 2 screw holes. Drill holes using a suitable drill bit. Place device into position ensuring the chain is fully taut.

Insert the blind into the brackets until it clicks into position.

Top Fix

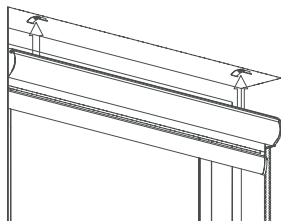

Face Fix

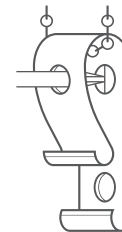
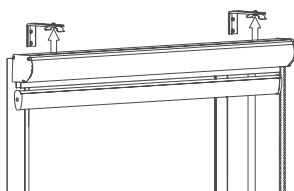

Screw the safety device securely into the wall using suitable fixings.

CASSETTE

WARNING

Young children can strangle in the loop of pull cords, chains and tapes that operate window coverings. They can also wrap the cords around their necks. To avoid the risk of strangulation and entanglement, keep cords out of the reach of young children. Move beds, cots and furniture away from window covering cords.