

# INSTRUCTION GUIDE

## PORTABLE GAS STOVE PARTS DESCRIPTION

### Find a suitable place where there is no strong wind.

If you use the Gas Burner where the wind is blowing, the flame may be scattered or extinguished.

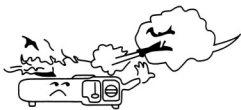

### Outdoor Use

Avoid it from being exposed to the sunlight directly.



### Find a strategic place.

Avoid the place where near flammable items and keep away from the wall about 15cm or more.



### Place the trivet in a right position.

The ignition knob unable to be turned if the holder is not in the right position or upside down.



### Technical Feature & Data

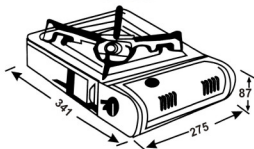

Product	Portable gas stove
Size	341x275x87mm
Weight	1380g
Fuel	Butane gas
Fuel consumption	166g/h

The design and standard may be changed for the improvement of quality without previous notice.

### Trivet

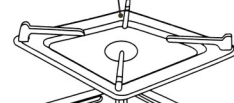

**Gas Can**  
Sold separately

### Electronic Lighter

To ignite the burner  
Keep it clean for smooth ignition

**Gas Can case**

### Lock lever knob

Push it down to lock the gas can and pull it up to unlock the gas can.

**Gas Can Cover**

**Lid Hole**  
To open the gas can cover.

### Ignition Knob

Knob is designed for anti-clockwise ignition.

# OPERATION

- 1 Install the trivet in the right position and open the gas can cover.

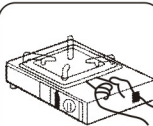

- To open the trivet, pull it up smoothly from the gap.

- 2 Put the gas can in the gas can case.

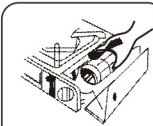

- Make sure the size of the gas can is suitable for the stove.

- 3 Push down the lock lever knob.

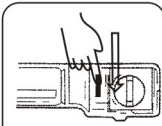

- Make sure the gas can has been fixed into the right position.

- 4 Close the gas can cover.

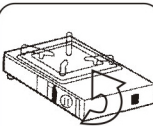

- Refer to the picture.

- 5 Ignite the burner by turning the ignition knob to the left.

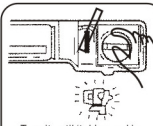

- Turn it until 'tak' sound is heard.
- Make sure the ignition knob in "off" position when turning the lock lever knob.

- 6 Put on the fry pan and adjust the flame by turning the ignition knob.

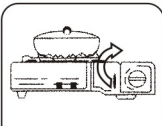

- Turn the ignition knob from high to low to adjust the flame.

- 7 When finished cooking .

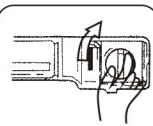

- Turn the ignition knob to the "off" position.

- 8 Pull up the lock lever knob .

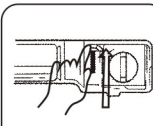

- Make sure to pull up the lock lever knob to the "Off" position when it not in use.

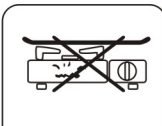

- Don not cover entire stove.
- Do not pots or pans with max diameter bigger than 270mm.

# IMPORTANT SAFEGUARDS

## After use up the gas of the cartridge.

Do not throw the used gas can into the fire. It is a must to make a hole in the used gas can either with nail or drill before you throw it away.



## Keep the Soup from overheating.

Keep the soup from overflowing into the burner. If the soup flowed into the burner, wipe it off with a dry towel.



## The product is only for cooking purpose.

Do not use gas stove for other purpose such as burning coals or drying clothes as it may cause fire.



## If an accident happens while using

Switch off the ignition knob and unlock the gas can.



## Keep the range from overheating.

Using two ranges side or putting big pan on the range may cause overheating.



## Make sure the gas do not outflow.

Put the gas can in the gas can case in the right position and make sure it fits the hole as in the diagram below.

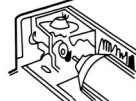

While installing the gas can, if you hear a hissing sound, take the gas can out and reinstall. Do not ignite the appliance when the gas can is not in the right position.