

DABBSSON

Dabbsson DBS2300 User Manual

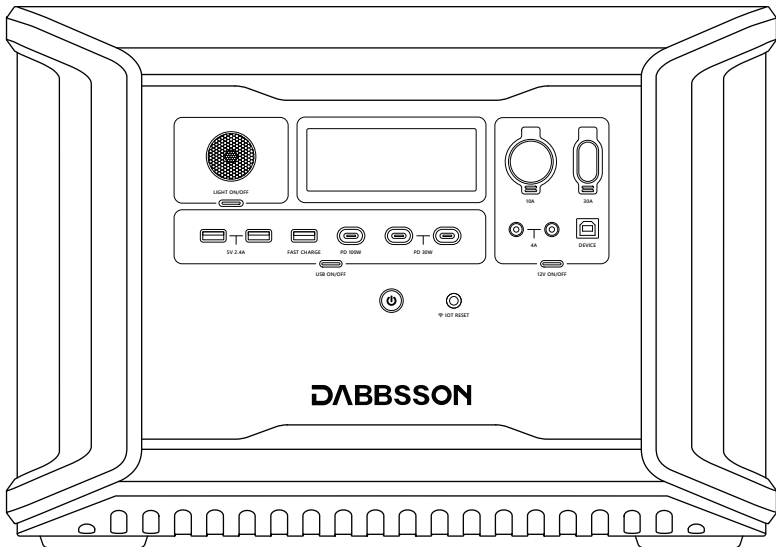

DISCLAIMER



Read all safety tips, warning messages, terms of use, and disclaimers carefully. Refer to the terms of use and disclaimer at <https://www.dabbsson.com> and stickers on the product before use. Users take full responsibility for all usage and operations. Familiarize yourself with the related regulations in your area. You are solely responsible for being aware of all relevant regulations and using Dabbsson products in a way that is compliant.

CONTENTS



1.Specifications	1
2.Safety Instructions	2
2.1 Usage	2
2.2 Disposal Guide	3
3.Product Details	4
3.1 Over View	4
3.2 LCD Screen	5
4.General Product Usage	6
4.1 Charging DBS2300	6
AC Charging	Car Charging
Solar Charging	Using Smart Extra Battery
4.2 Control the product	12
Power On/Off	
4.3 Charging Your Devices	13
AC outlets	P-Boost and EPS
DC outlets	
5.App Control	15
6.FAQs	22
7.Troubleshooting	23
8.What's in the Box	24
9.Storage & Maintenance	24
10.Fcc Statement	25

1.Specifications



General Info

Net Weight	Approximately 24.1kg (53.1lbs)
Dimensions	432x254.5x303.5mm (17x10x12in)
Capacity	2330Wh (44.8V \approx 52Ah)
Wi-Fi	Supported
BT	Supported
Certification	ETL CE FCC PSE RCM WEEE ROHS TELEC

Output Ports

AC (x2)	Pure Sine Wave, 2200W total (surge 4400W), 120V~ (50/60Hz)
USB-A (x2)	5V \approx 2.4A, 12W Max Per Port, Total 12W
USB-A Fast Charge (x1)	5V \approx 3.0A 9V \approx 2A 12V \approx 1.5A, 18W Max
USB-C (x1)	5/9/12/15V \approx 3A, 20V \approx 5A 100W Max
USB-C (x2)	5/9/12/15/20V \approx 1.5A, 30W Max Per Port, Total 60W
Car Charger	12.6V \approx 10A, 126W Max
DC5521 Output (x2)	12.6V \approx 4A, 50.4W Max Per Port
Anderson Output	12.6V \approx 30A, 378W Max
LED	2W

* The car charger shares power with the DC5521 output port, offering a maximum output of 126W.

Input Ports

AC Charge	1800W
AC Input Voltage	120V~ 15A, 50/60Hz
Solar Charger	12-60V \approx 12A Max, 600W Max
Car Charger	Supports 12V/24V \approx Battery, Default 10A
Add-on	Extra Battery DBS3000B*2, Total 8330Wh

Battery Info

Cell Chemistry	LiFePO4
Cycle Life	4000 Cycles to 80%+Capacity

Protection

Over Voltage Protection	Overload Protection
Over Temperature Protection	Short Circuit Protection
Low Temperature Protection	Low Voltage Protection
Overcurrent Protection	

Environmental Operating Temperature

Optimal Operating Temperature	0°C~40°C(32°F ~104°F)
Discharge Temperature	-20°C~55°C(-4°F ~131°F)
Charging Temperature	-5°C~50°C(23°F ~122°F)
Storage Temperature	-10°C~45°C(14°F ~113°F) (Optimal: 20°C~30°C(68°F ~86°F))

* Whether the product can be charged or discharged depends on the actual temperature of the battery pack.

2.Safety Instructions



2.1 Usage

- 1.Do not use the product near a heat source, such as a fire source or a heating furnace.
- 2.Avoid contact with any liquid. Do not immerse the product in water or get it wet. Do not use the product in rain or humid environments.
- 3.Do not use the product in an environment with strong static electricity or magnetic fields.
- 4.Do not disassemble the product in any way or pierce the product with sharp objects.
- 5.Avoid using wires or other metal objects that may result in a short circuit.
- 6.Do not use unofficial components or accessories. If you need to replace any components or accessories, visit official Dabbsson channels to check for relevant information.

7. It is highly recommended that third-party accessories are purchased from reliable distributors and that they match your product's specifications. Dabbsson is not liable for abnormality, inconvenience, losses or expenses resulting from defective third-party accessories.
8. When using the product, please strictly follow the operating environment temperature specified in this user manual. If the temperature is too high, it may result in a fire or explosion; if the temperature is too low, the product performance may be severely reduced, or the product may cease to work.
9. Do not forcibly lock the fan during use or place the product in an unventilated or dusty area.
10. Avoid impact, falls, or severe vibrations when using the product. In case of a severe external impact, turn off the power supply immediately and stop using the product. Ensure the product is well fastened during transportation to avoid vibrations and impacts.
11. If you accidentally drop the product into water during use, place it in a safe open area, and stay away from it until it is completely dry. The dried product should not be used again, and should be properly disposed of according to Section 2.2 below. If the product catches fire, we recommend that you use the fire extinguishers in the following order: water or water mist, sand, fire blanket, dry powder, and finally a carbon dioxide fire extinguisher.
12. Use a dry cloth to clean off dirt on the product ports.
13. Rest the product on a flat surface to avoid damage caused by the product falling over. If the product is overturned and severely damaged, turn it off immediately, place the battery in an open area, keep it away from combustible matter and people, and dispose of it in accordance with local laws and regulations.
14. Ensure that the product is kept out of reach of children and pets.
15. DO NOT connect the smart extra battery to another smart extra battery.

2.2 Disposal Guide

1. If conditions permit, make sure that the battery is fully discharged before disposing of it in a designated battery recycling bin. The product contains batteries with potentially dangerous chemicals, so it is strictly prohibited to dispose of it in ordinary trash cans. For more details, please follow the local laws and regulations on battery recycling and disposal.
2. If the battery cannot be fully discharged due to a product failure, do not dispose of the battery directly in the battery recycling box. In such cases, contact a professional battery recycling company for further processing.
3. Please dispose of over-discharged batteries that cannot be recharged.

3. Product Details



3.1 Over View

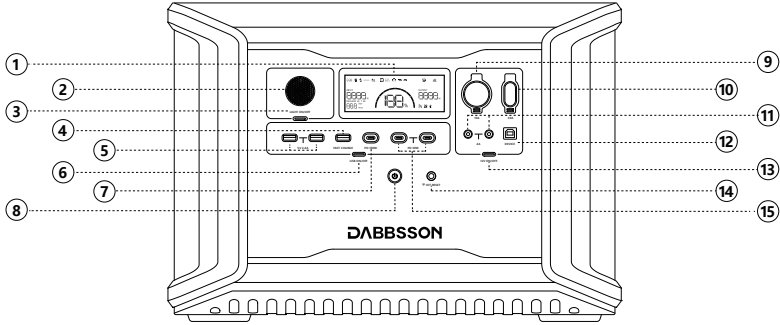

- ① LCD Screen
- ② LED
- ③ LIGHT ON/OFF
- ④ USB-A Fast Charge Output Port
- ⑤ USB-A Output Port (x2)
- ⑥ USB ON/OFF
- ⑦ USB-C 100W Output Port
- ⑧ Main Power Button
- ⑨ Car Port
- ⑩ Anderson Port (12V/30A)
- ⑪ DC5521 Output Port
- ⑫ DEVICE Control Port*
- ⑬ 12V DC Power Button
- ⑭ IOT Reset Button
- ⑮ USB-C 30W Output Port (x2)

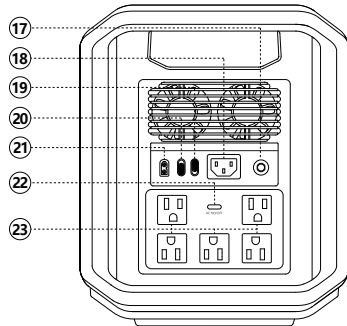
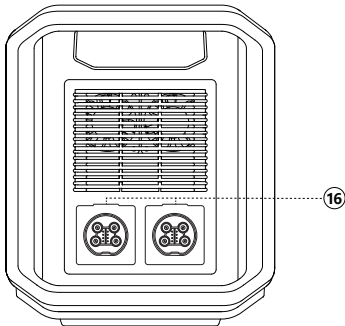

- ⑬ Extra Battery Port
- ⑭ Overload Protection
- ⑮ AC Charging Input Port
- ⑯ Standby/ECO Mode Switch
- ⑰ AC Charge Speed Switch
- ⑱ Solar/Car Charging Input Port
- ⑲ AC Power Button
- ⑳ AC Output Port (x5)

* "Device control port" is only used by the manufacturer for upgrading.

3.2 LCD Screen

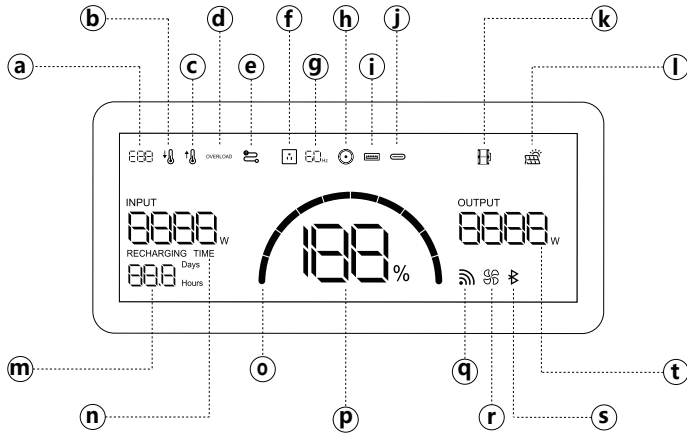

- a** Error Code
- b** Low Temperature Warning
- c** High Temperature Warning
- d** Overload Warning
- e** Connection Failed
- f** AC Output
- g** AC Output Frequency
- h** DC Output
- i** USB-A Output
- j** USB-C Output
- k** Extra Battery Indicator
- l** Solar Panel Indicator
- m** Remaining Charge/Discharge Time
- n** Input Power
- o** Battery Level Indicator
- p** Remaining Battery Percentage
- q** Wi-Fi Status
- r** Fan Indicator
- s** Pairing Indicator
- t** Output Power

Battery Level Indicator

The indicator ring fills up from left to right while charging. If the battery is at 0% charge, the indicator ring will flash. If the battery degree is at 100% charge, the indicator will be full.

Wi-Fi Status

Press and hold the IOT button for 3 seconds, and the Wi-Fi icon will flash, indicating that the product is ready for pairing. If the product pairing is completed, the Wi-Fi icon will stay on.

4. General Product Usage



4.1 Charging DBS2300

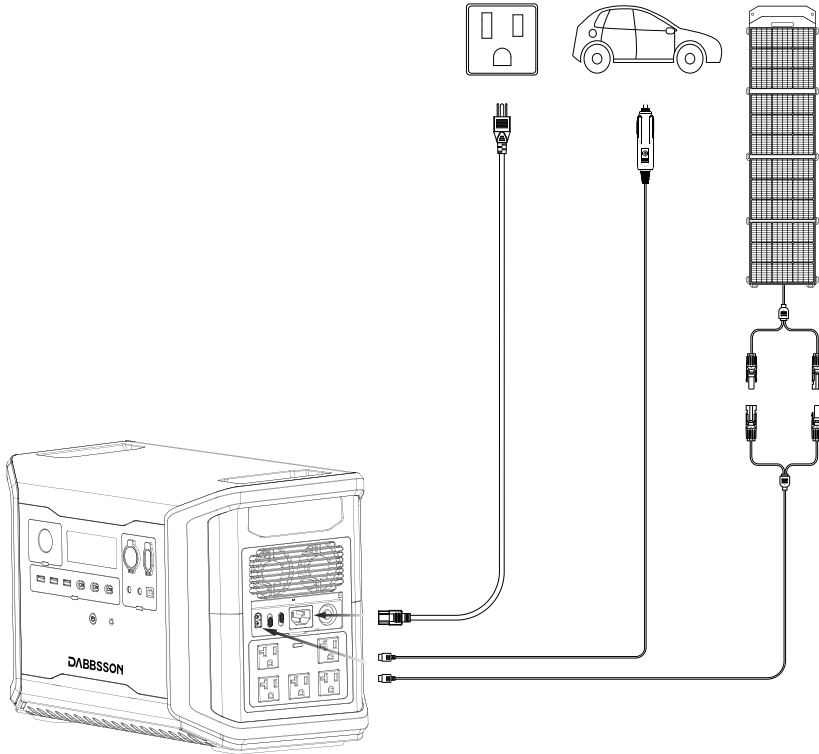

AC Charging

Dabbsson fast charge technology is specifically for AC charging, offering 1800W of max input power. You can control the charging power through the AC Charge Speed Switch. The default max input power for the AC charging speed is 600W, which can be modified in the Dabbsson app.

In case of unusual situations where the AC input current remains higher than 20A, the charging input port will initiate a self-protection function, and the Overload Protection Switch on the product will automatically pop up. After confirming that there is no product failure, you can press the Overload Protection Switch to resume charging.

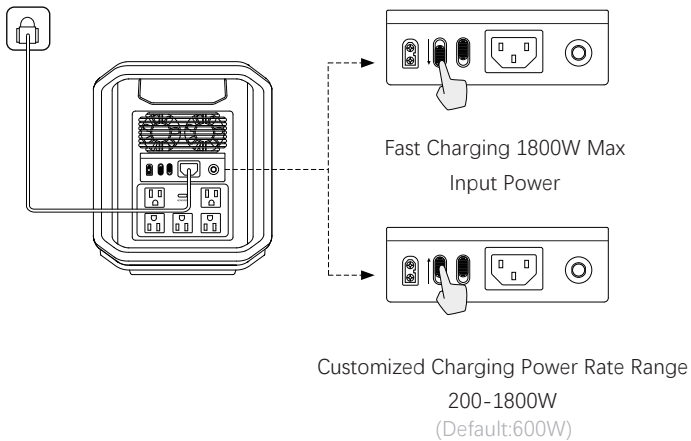
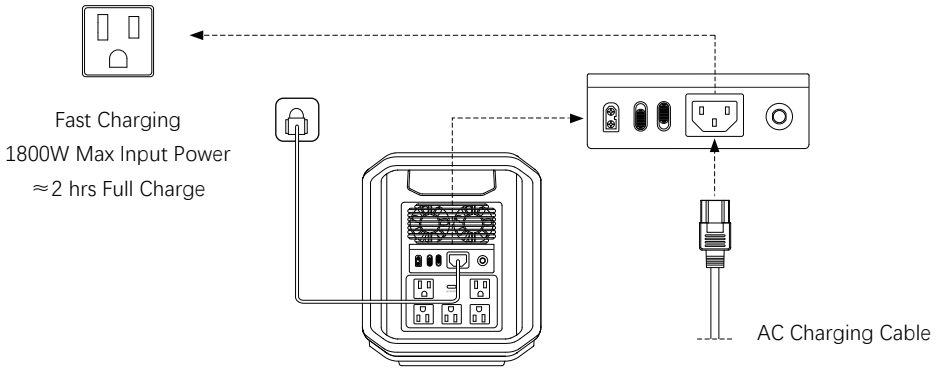

The charging power can be adjusted through the AC Charge Speed Switch on the back of the product. You can set the charging power range in the Dabbsson App.

Please use the AC Charging Cable included in the package for fast charging. Do not use other cables to charge. Plug directly into an AC wall outlet and make sure that the wall output current is more than 15A. Otherwise, reduce the unit charging speed with the AC Charge Speed Switch. Dabbsson takes no responsibilities for any consequences caused by failures to follow instructions, including but not limited to charging with other AC charging cables.

Solar Charging

Users can connect solar panels in series as shown in the figure to recharge the product. The product supports 12-60V DC input, 25A max current, and 600W max charging power.

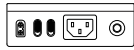

Connect XT60 Port

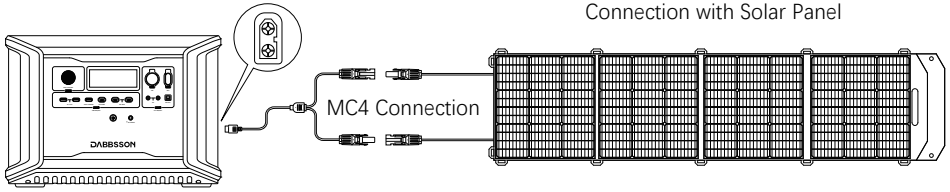

Connection with Solar Panel

200W Solar Panel

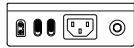

Connect XT60 Port

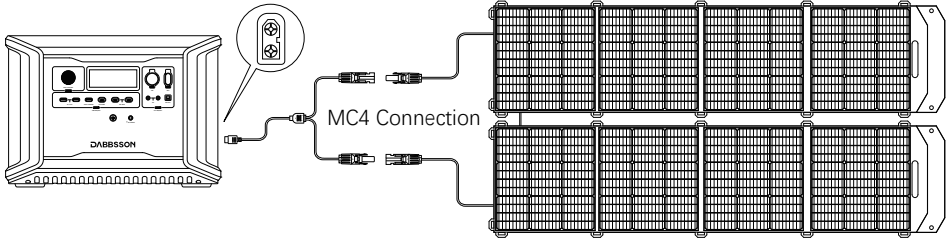

Connection with Solar Panel

200W Solar Panel (x2)

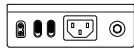

Connect XT60 Port

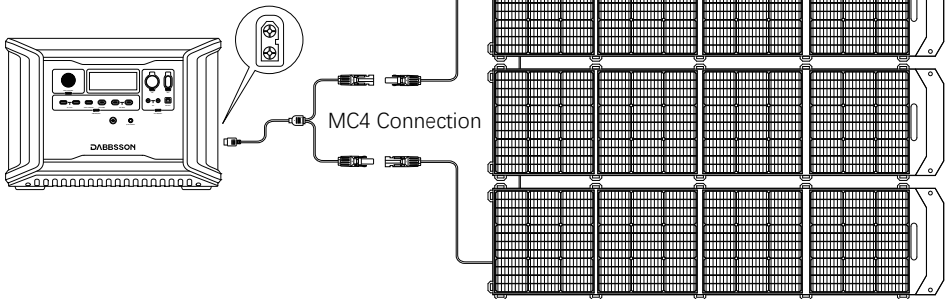

Connection with Solar Panel

200W Solar Panel (x3)

When using an Dabbsson solar panel to charge the product, please follow the instructions that come with the solar panel. Before connecting the solar panel, please ensure that the solar panel's output voltage is within 60V to avoid product damages.

Car Charging

Users can recharge the product through the Car Outlet. It supports 12V/24V car chargers and an 8A default charging current.

Only charge using the car charger after you've started the car. This prevents the car from failing to start due to insufficient battery power. In addition, please make sure that the cigarette lighter of the Car Outlet and the Car Charger Input Cable are in good condition. Dabbsson takes no responsibilities for any losses or damage caused by failures to follow instructions.

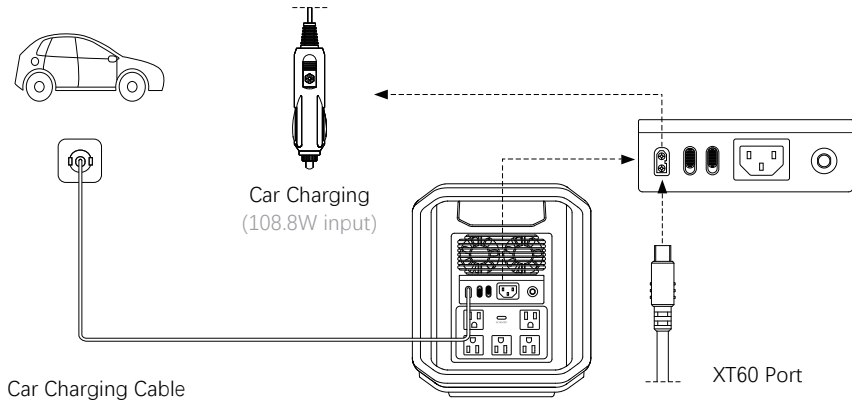

Using Extra Battery

A single DBS2300 can be connected to two DBS3000B extra batteries for added capacity. Refer to the Extra Battery DBS3000B user manual for detailed instructions.

- DBS2300 can expand the capacity by 1 DBS3000 battery pack to 5330Wh.
- DBS2300 can expand the capacity by 2 DBS3000 battery pack to 8330Wh.

Please refer to Dabbsson support youtube channel for detailed installation instructions.

Precautions

1. Turn off both the Extra Battery DBS3000B and DBS2300 before plug or unplug the extra battery.
2. Before using, make sure both DBS2300 and Extra Battery DBS3000B display the extra battery icon on their LCD screens.

- 3. Do not touch the metal terminals of the Extra Battery DBS3000B connector. If the metal terminals need to be cleaned, gently wipe them with a dry cloth.
- 4. When the DBS2300 power station and DBS3000B expandable battery are not in use, please remove the connecting cable

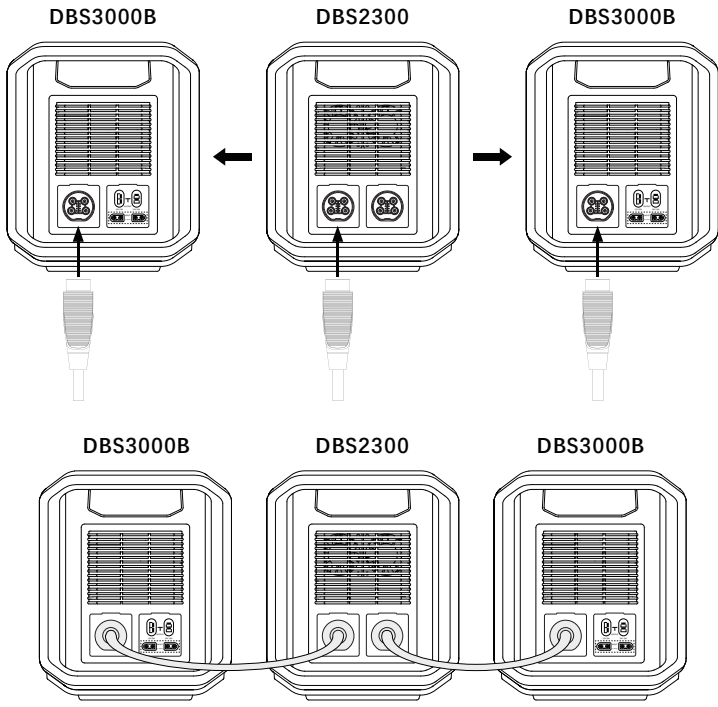
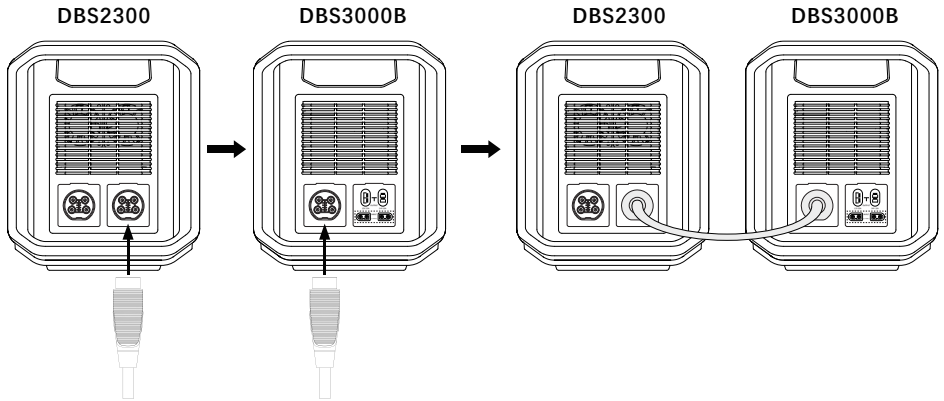

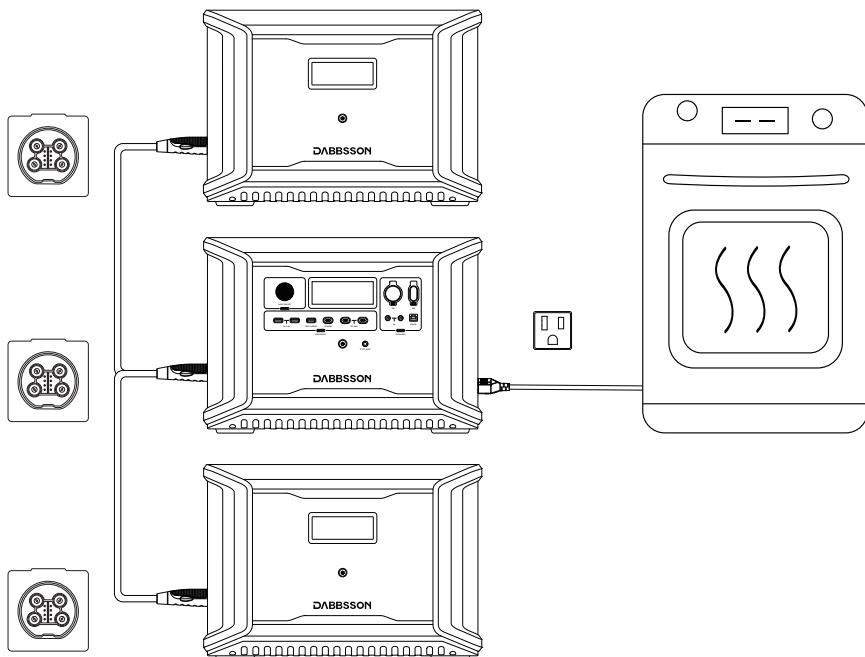
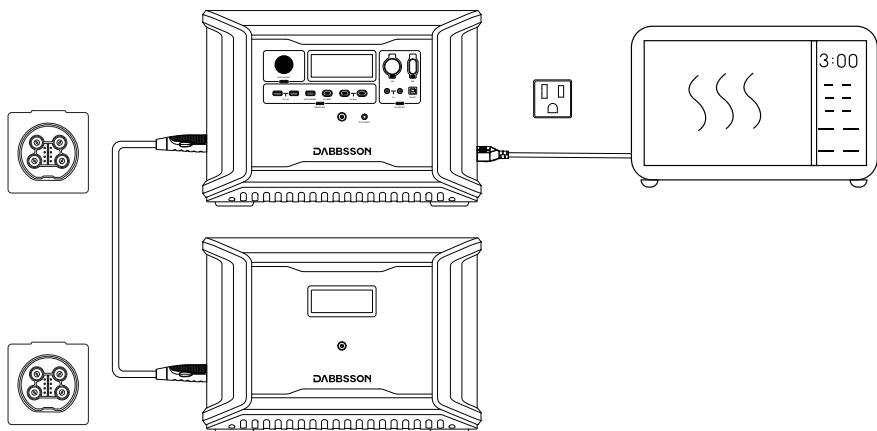

4.2 Control the product

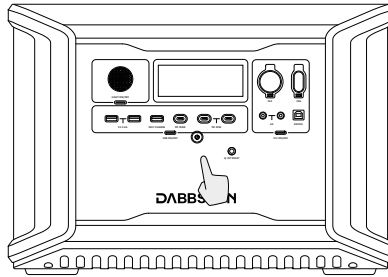

Short Press to Turn On/Long Press to Turn Off

Product On, Product Off, LCD Screen On

Short press the Main Power Button to start the product, the LCD screen lights up and displays an icon. It will automatically turn off after the product is idle for 30 seconds. When the device senses any load change or operation, the display screen will automatically light up. To turn the display on or off, briefly press the Main Power Button. To turn off the device, long press the Main Power Button. The default standby time is 2 hours. The device will automatically shut down when other power buttons are turned off and no other power source is detected within 2 hours. Standby time of AC and DC can be set via the Dabbsson APP.

STANDBY MODE/ECO MODE

Default ECO MODE will be on.

You can choose STANDBY MODE, the AC and DC power buttons will not be automatically turned off after being turned on, and can only be controlled manually or through App.

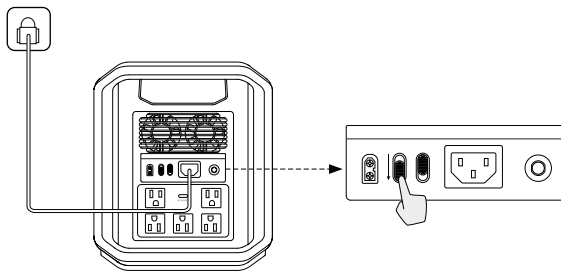

4.3 Charging Your Devices

AC Output Port

After turning on the main power button, short press the AC power button to use the AC output port. Press the button again will turn it off. The default standby time for the AC output port is 12 hours.

The AC power will be automatically turned off if no load access for 12 hours. When the product is not in use, turn off the AC power button to save power.

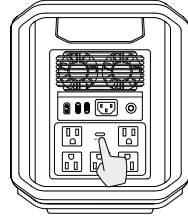

Short Press
AC Power Button

12V DC Output Port

After turning on the main power button, short press the 12V DC power button to use the 12V DC output port. Press the button again will turn it off. When the 12V DC power button is turned on, the product does not automatically turn off.

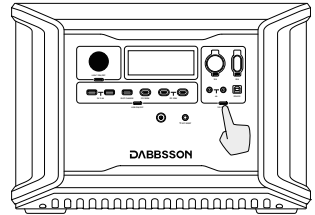

Short Press
12V DC Power Button

P-Boost

With Dabbsson P-Boost technology, the product can power a 3000W Max device while the rated output power remains 2200W, avoiding operation failure due to overload protection.

P-Boost Tips

- 1.P-Boost is not available when the AC output is turned on in a recharging state.
- 2.P-Boost is not applicable for all electrical appliances; it's incompatible with appliances with strict voltage requirements and a rated power over 2200W. Appliances with voltage protection (such as precise instruments) are not supported. P-Boost mode is more suitable for heating devices. Please conduct your own tests with your devices with P-Boost enabled.

Emergency Power Supply (EPS)

The product supports EPS. When you connect the grid power to the AC Input Port of the product through an AC cable, you can power electrical devices through the AC Output Port (AC power will come from the grid and not the power station in this situation). In case of a sudden blackout, the product can automatically switch to the battery powered supply mode within 15ms. As a basic UPS function, this function does not support 0ms switching. Please do not connect the product to any device that requires 0ms UPS, such as data servers and workstations. Please test and confirm the compatibility before using the product. We recommend that you only charge one device at a time and avoid using multiple devices at the same time to avoid overload protection. Dabbsson takes no responsibilities for any device failures or data losses caused by failures to follow instructions.

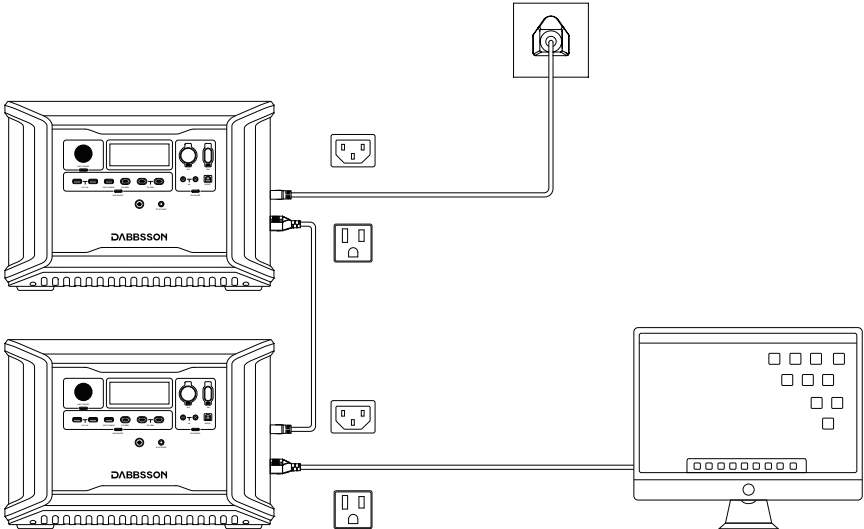
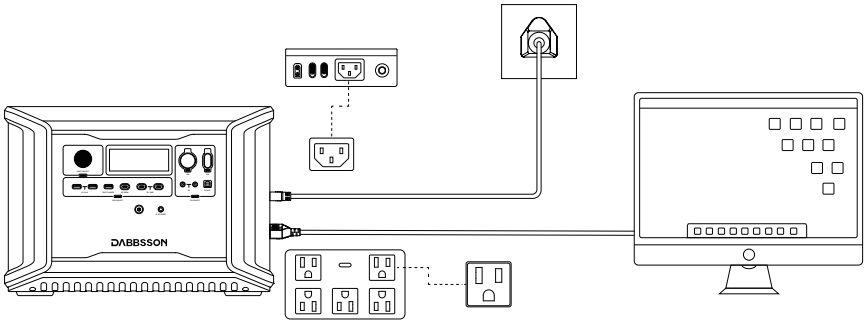

5.App Control



Download Dabbsson APP

1.Search for “Dabbsson” in the APP Store (for iOS devices) or Google Play (for Android devices) to download the Dabbsson App.

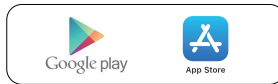

2.You can download the app on the App Store and Google Play by scanning the QR codes below.



Android



iOS

3.Download the Dabbsson APP on the official website: www.dabbsson.com

* The Dabbsson App can only control AC and DC parameters setting in ECO or STANDBY open mode.

Connecting the APP to DBS2300

When there is network around

1.Long press the Wi-Fi reset button of the device for 3 seconds until the Wi-Fi icon flickers on the screen, then the device is prepared for pairing.

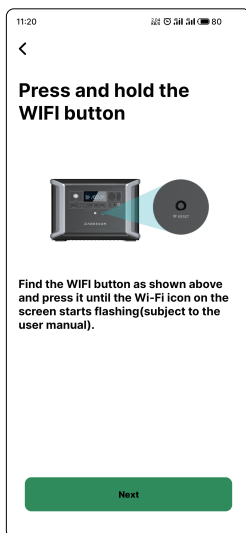

2. Open the Dabbsson APP and select the symbol “+” on the top right corner of the homepage. Then select the model name of the device you are using. In the next page, select “Next” to enter the page of connecting your mobile phone to the device's hotspot.

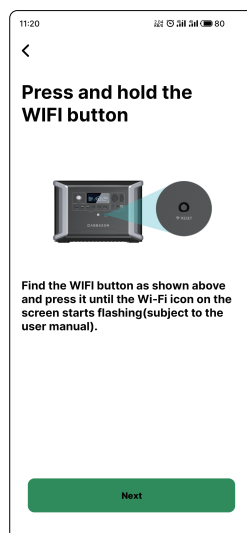
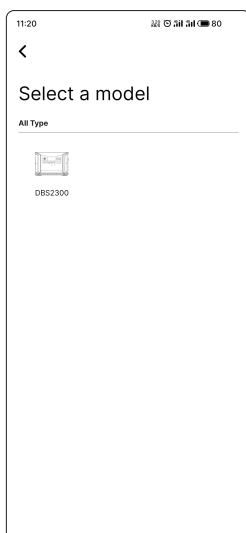
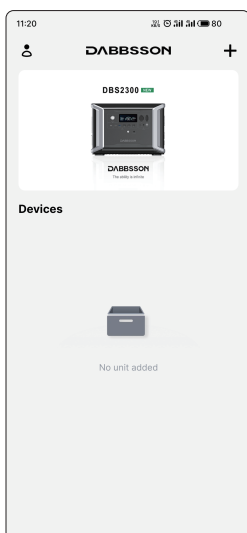

3. Select "Go to Connect" and then connect your mobile phone to the device's hotspot (the default hotspot name of the device is SmartLife-xxx).

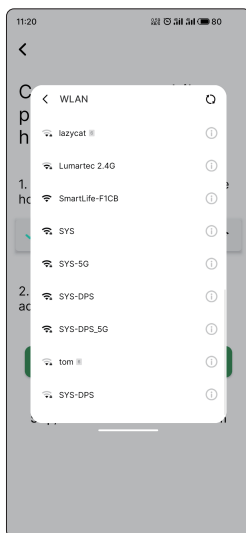
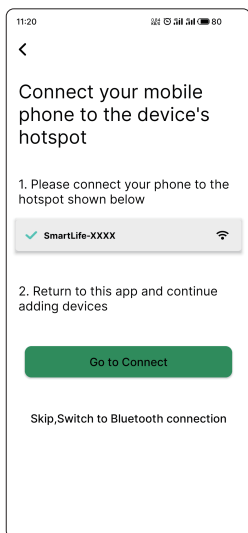

4. In the "Internet setup" page, enter the name and password of a available external WiFi, or you can drop down the WiFi selection button and choose a WiFi and enter the password. Then select "Add" to connect your device to the external WiFi. (Note: Only 2.4G WIFI hotspots are supported).

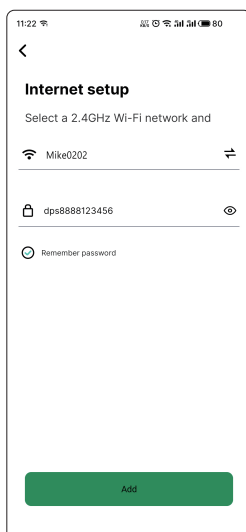

5.Wait while the APP is adding your device. If successful, the device will appear under the device list in the APP.

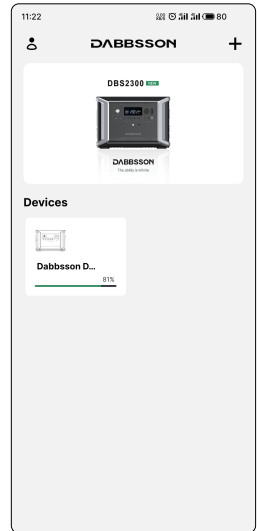
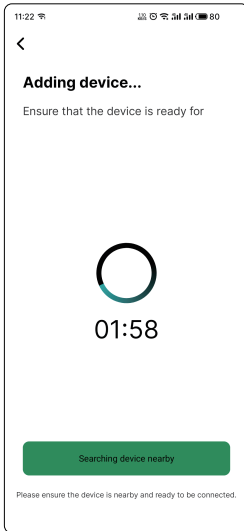

When there is not network around

1.Open the personal hotspot on your mobile phone, then remember the hotspot name and password.(Note: Only 2.4G WIFI hotspots are supported).

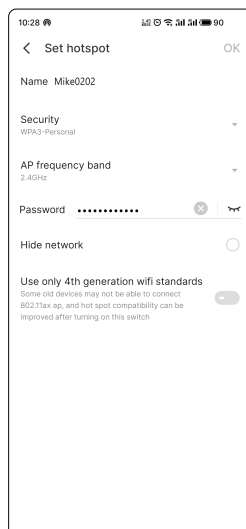

2. Open the Dabbsson APP and select the symbol “+” on the top right corner of the homepage. Then select the model name of the device you are using. In the next page, select “Next” to enter the page of connecting your mobile phone to the device’s hotspot.

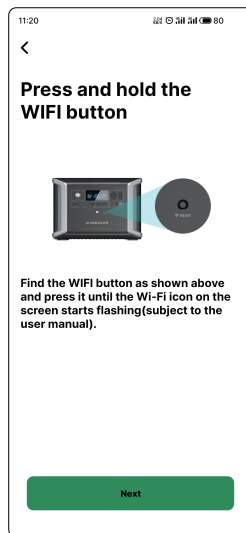
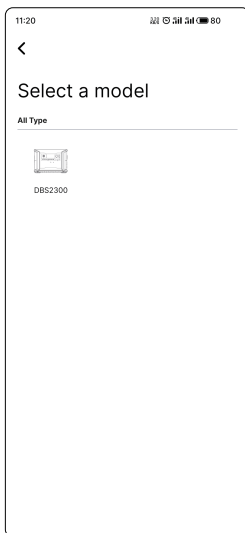
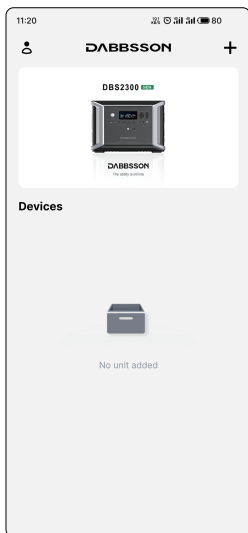

3. In this page, select “ Skip, Switch to BT Connection”, then open the BT of your mobile phone and you will enter the “Internet setup” page.

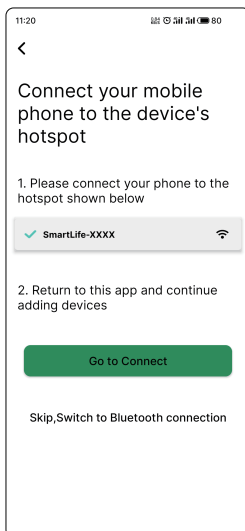

4. Enter the name and password of your mobile phone's hotspot, and then select "Add" to connect your device to the hotspot of your mobile phone.

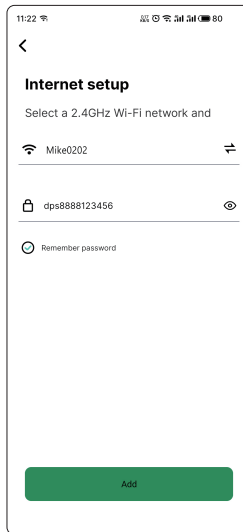

5. Wait while the APP is adding your device. If successful, the device will appear under the device list in the APP.

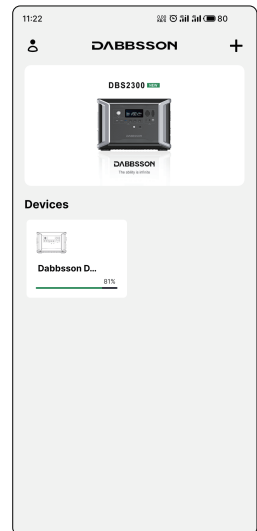
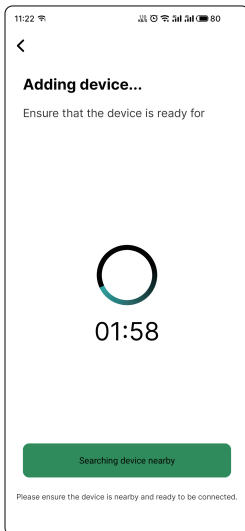

If the device appear under the device list successfully, you can turn off the hotspot of your mobile phone. Then the device will be connected to the APP via BT. Turn off the external Wi-Fi or hotspot the device is connected to, the device will disconnect from the Wi-Fi network or hotspot and automatically switch to local BT control after 3-5 minutes.

Note: In BT mode, you can remotely control your device within a distance of about 10 meters due to the limitation of the effective transmission distance of BT signals.

Privacy Policy

By using Dabbsson Products, Applications and Services, you consent to the Dabbsson Term of Use and Privacy Policy, which you can access via the "About" section of the "User" page on the Dabbsson App or on the official Dabbsson website at <https://www.dabbsson.com>



6.FAQS



1.What type of batteries does the product use?

This product uses high-quality LiFePO4 battery.

2.What devices can use the product's AC output port power?

With 2200W rated power and 4400W peak power, the product's AC output port can power most household appliances. Before using we recommend you check the power of the appliances first and ensure the power sum of all loaded appliances is lower than the rated power.

3.How long does it take for the product to charge my devices?

The charging time is shown on the product's LCD Screen, which can be used to estimate the charging time of most appliances with stable power usage.

4.How can I tell if the product is charging?

The remaining charging time will be shown on the LCD Screen. The charging indicator will display remaining battery percentage, while current input power is shown to the right of the charging indicator.

5.How do I clean the product?

Please gently wipe it with a dry, soft, clean cloth or paper towel.

6.How should I store the product?















Before storing, turn off the product first, and then store it in a dry,ventilated area at room temperature.Do not place it near water sources. For long-term storage, discharge the battery to 30% and recharge it to 60% every three months to extend its battery life.

7.Can I bring the product on a plane?

No

7.Troubleshooting



Indicator	Problem	Solution
OVERLOAD  (Flashing)	USB-A Overload Protection	Resume normal operation by removing the electrical device connected to the USB-A port.
 RECHARGING TIME (Flashing)	High Temperature Charge Protection	Charging will automatically resume after the battery cools down.
 (Flashing)	High Temperature Discharge Protection	Power supply will automatically resume after the battery cools down.
 RECHARGING TIME (Flashing)	Low Temperature Charge Protection	Charging will automatically resume after battery temperature rises above -5°C(23°F).
 (Flashing)	Low Temperature Discharge Protection	Power supply will automatically resume after the battery temperature rises above -15°C (5°F).
OVERLOAD   (Flashing)	AC Output Overload Protection	Normal operation will automatically resume after you remove the overloaded device and restart the product.
   (Flashing)	AC High Temperature Protection	Check whether the fan inlet and/or outlet are blocked. If not, normal operation will automatically resume after the product cools down.
 (Flashing)	Fan Blockage	Please check if the fan is blocked.
OVERLOAD  (Flashing)	DC Output Overload Protection	The product will automatically resume normal operation after you remove the device connected to the DC outlet.
  (Flashing)	DC Output High Temperature Protection	The product will automatically resume normal operation after it cools down.
	Others	Contact Dabbsson Customer Service

8.What's in the Box

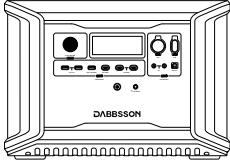

DBS2300



Solar Charging Cable



Car Charging Cable



AC Charging Cable



User Manual



Warranty Card



Warning Card

9.Storage & Maintenance



1. Ideally, you should use and store the product at an ambient temperature between 20°C - 30°C (68°F - 86°F), and always keep it away from water, intense heat, and sharp objects. Do not store in temperatures above 45°C (113°F) or below -10°C (14°F) for an extended period.
2. Storing a battery with a low charge for a long period shortens its lifespan. DBS2300 mitigates the damage by putting the battery into hibernation mode. To get the most out of the battery, make sure it is at about 60% before putting DBS2300 into long-term storage. While in storage, it is recommended to discharge the battery to 30% and recharge it back to 60% every three months.

10.Fcc Statement



This device complies with Part 15 of the FCC Rules. Operation is subject to the following two conditions:

- (1) This device may not cause harmful interference.
- (2) This device must accept any interference received, including interference that may cause undesired operation.

Warning:

Changes or modifications not expressly approved by the party responsible for compliance could void the user's authority to operate the equipment.

NOTE:

This equipment has been tested and found to comply with the limits for a Class A digital device, pursuant to Part 15 of the FCC Rules. These limits are designed to provide reasonable protection against harmful interference when the equipment is operated in a commercial environment. This equipment generates, uses, and can radiate radio frequency energy and, if not installed and used in accordance with the instruction manual, may cause harmful interference to radio communications. Operation of this equipment in a residential area is likely to cause harmful interference in which case the user will be required to correct the interference at his own expense.

FCC Radiation Exposure Statement:

This equipment complies with FCC radiation exposure limits set forth for an uncontrolled environment. This equipment should be installed and operated with minimum distance of 20cm between the radiator & your body.

