

Schlüter®-KERDI-SHOWER

Drainage
floor level showers

8.6

Product data sheet

Application and Function

Schlüter®-KERDI-SHOWER is a modular system for the construction of floor level showers with ceramic tiles.

The sloped trays, which have optional levelling boards, are available in different dimensions.

The matching floor drain system **Schlüter®-KERDI-DRAIN-BASE** is available as a set. Depending on the conditions of the construction site, other variants of **Schlüter®-KERDI-DRAIN** may be used as well. Various sets of **Schlüter®-KERDI** are available for waterproofing the wall areas.

The surface of the sloped trays already has the necessary gradient of $> 2\%$ (except for long sides of sloped trays with the dimension 180 x 90 cm).

The drain body and the drainage pipe are inserted into the levelling board, which represents the lowest possible construction height and can be adjusted, for example with a mortar layer.

The available base dimensions are:

90 x 90 cm

100 x 100 cm

120 x 120 cm

150 x 150 cm

90 x 180 cm

Smaller dimensions can easily be cut to size with a utility knife. The material features prepared cutting grooves for circular cuts.

The matching floor drain for the system, **Schlüter®-KERDI-DRAIN-BASE** (for horizontal drainage), has a drain capacity of 0.4 l/s.

Matching variants of **Schlüter®-KERDI-DRAIN** are available for special cases with higher drain capacity needs, vertical drains, or other requirements.

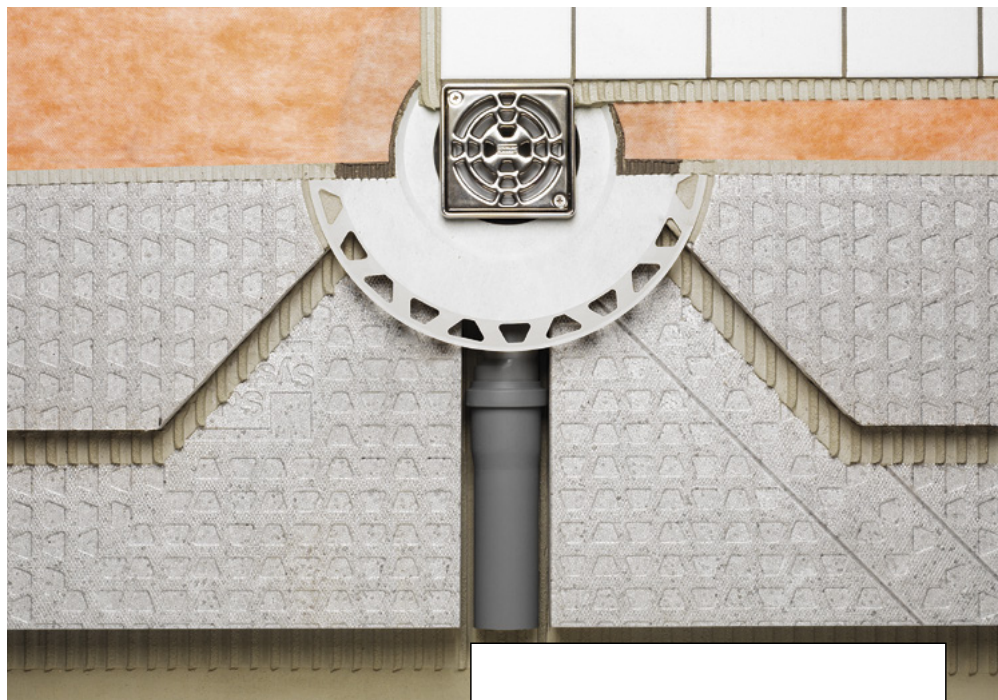

Schlüter®-KERDI-SHOWER stands out for its particularly easy and reliable installation. Together with **Schlüter®-KERDI** waterproofing component, this meets the requirements of the German Certificate of National Technical Approval (abP) for Category A waterproofing assemblies. The system components of **Schlüter®-KERDI-SHOWER** are packaged as a set and can easily be combined as required.

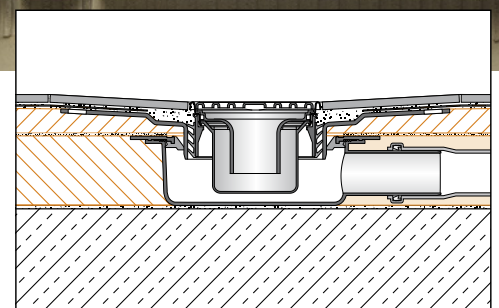

Horizontal drainage

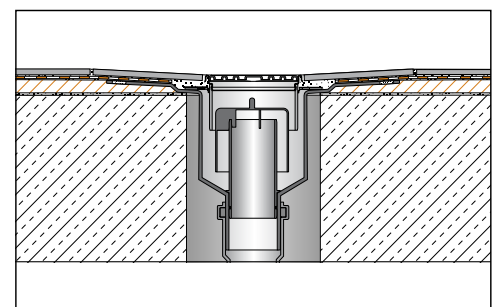

Vertical drainage



Re 1. and 2.
Set levelling board in place, if required.



Re 3.
Insert drain body



Re 4.
Place sloped tray on top

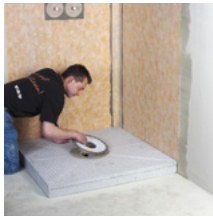

Re 5.
Install bonding flange

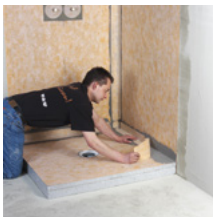

Re 7.
Install waterproofing assembly



Re 9.
Insert the stainless steel grate and frame at the appropriate height as part of the installation

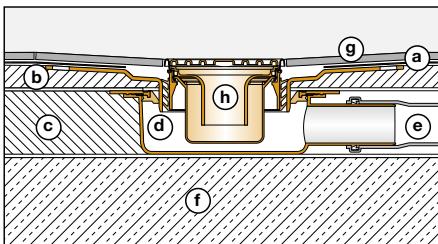

a	Schlüter®-KERDI waterproofing collar
b	Schlüter®-KERDI-SHOWER sloped tray
c	Schlüter®-KERDI-SHOWER levelling board
d	Schlüter®-KERDI-DRAIN-BASE floor drain set
e	Drainage pipe
f	Substrate
g	Tiles
h	Grate and frame set with drain body with integrated odour trap



Material

The levelling board and the sloped board consist of pressure resistant, expanded polystyrene foam (EPS). The drain body is made of high impact polypropylene (PP). The bonding flange consists of acryl-nitrile butadiene styrene (ABS) and features an attachment flange with a fleece coated surface. The Schlüter®-KERDI collar for bonded waterproofing of the sloped board is a polyethylene waterproofing membrane with fleece fabric laminated on both sides for anchoring in the tile adhesive. The stainless steel grate included in the waterproofing set Schlüter®-KERDI-SHOWER-SKB is made of V2A (material no. 1.4301 = AISI 304).

Material properties and areas of application

The drain body, bonding flange and grates are categorised as load class K3 in accordance with DIN EN 1253 (BS EN 1253) Gullies for Buildings. This class refers to surfaces without traffic loads, e.g. wet rooms in apartments, nursing homes, hotels, schools, public bathroom and shower facilities. In certain cases, the suitability of the selected floor drainage system must be verified based on the anticipated chemical, mechanical and/or other stresses.

Installation

1. The levelling board is installed in dry setting thin bed adhesive on a level substrate. To offset uneven sections or for height adjustment, the levelling board can also be installed and aligned over several sufficiently spaced dabs of adhesive or a layer of levelling screed.

Note:

If the building project is subject to sound insulation requirements, install the levelling board over a sound insulation panel and attach an edge insulation strip along the perimeter.

Observe the maximum compressibility CP4 (< 4mm) when selecting a suitable insulation material.

2. Cut out the necessary openings in the levelling board for the pipes in the appropriate places.
3. Insert the drain body into the corresponding opening of the levelling board and connect it to the wastewater system with a drain pipe, using the supplied adapter piece (DN 40 to BS 40 mm). Perform a leakage test.
4. Now adhere the sloped board to the prepared levelling board with a dry setting thin bed adhesive. Avoid placing the abutting joint of the sloped tray directly over the drain pipe.
5. Fit the bonding flange into the drain body through the opening so that the flange is flush with the surface of the sloped board. Apply thin bed adhesive under the flange for complete attachment and bedding.
6. To integrate the Schlüter®-KERDI collar into the bonded waterproofing assembly, apply the sealing Schlüter®-KERDI-COLL-L to the adhesive flange of the bonding flange insert and use a notched trowel to spread dry setting tile adhesive on the remaining area of the sloped tray to completely embed the Schlüter®-KERDI collar. Press the Schlüter®-KERDI collar in place with the smooth side of the notched trowel or a smoothing trowel by applying oblique pressure. Be careful to avoid the formation of bubbles and observe the curing times of all materials.
7. To waterproof the wall areas, install the waterproofing membrane Schlüter®-KERDI. Where the joints of the membranes abut, in the corner areas, and along the floor to wall transition should

8.6 Schlüter®-KERDI-SHOWER

be sealed with Schlüter®-KERDI-KEBA and Schlüter®-KERDI-COLL-L. Waterproof all pipe sleeves with the pipe collar Schlüter®-KERDI-KM. The corresponding product data sheets 8.1 Schlüter®-KERDI and 8.4 Schlüter®-KERDI-COLL-L must be observed.

Note:

If the wall areas are made of Schlüter®-KERDI-BOARD, the material can also be used for waterproofing the walls (see product data sheet 12.1 Schlüter®-KERDI-BOARD). Abutting joints and corners also have to be sealed with Schlüter®-KERDI-KEBA sealing band, using the adhesive Schlüter®-KERDI-COLL-L.

8. As soon as the bonded waterproofing assembly has been completed as described above, you can begin to install the tiles in the thin bed method. No waiting is required.
9. For the installation of tile, apply dry-setting thin bed adhesive directly over Schlüter®-KERDI and fully embed the tiles in the adhesive. Regardless of the tile format, the floor area can withstand normal foot traffic and is able to bear the weight of wheelchairs. If higher traffic loads are expected, an additional load distribution layer or larger tile formats may be required.

Note:

Use system approved thin bed adhesives for areas that require waterproofing in accordance with general certificate of national technical approval or CE conformity. Please contact us at the address shown in this data sheet for more details. As part of the installation of the floor tiles, press the drain grate frame into the thin bed adhesive until flush with the tile covering. Tile adhesive can be applied below the grate frame for additional support, if required.

10. Other coverings, such as coatings, synthetic coverings etc. may be used in principle, but are not explained in greater detail here. Their use must be clarified in advance. We will be pleased to provide you with further recommendations upon request.

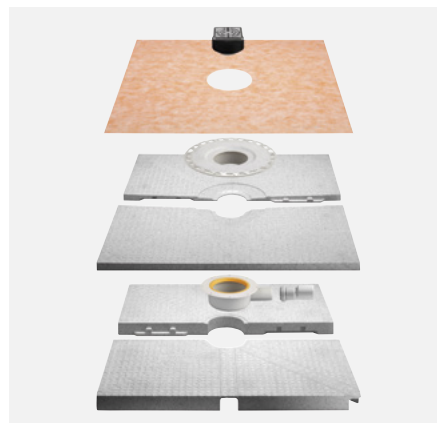

Example:
Assembly with horizontal drain



Product Overview

Assembly heights of Schlüter®-KERDI-SHOWER boards

Dimensions	Sloped tray (b) Height (max.)	Levelling board (c) Height
900 x 900 mm	31 mm	60 mm
1000 x 1000 mm	33 mm	60 mm
1000 x 1000 mm	22 mm (TB)	-
1200 x 1200 mm	35 mm	60 mm
1500 x 1500 mm	39 mm	60 mm
900 x 1800 mm	40 mm	60 mm

Schlüter®-KERDI-SHOWER-T

is a set consisting of the sloped tray (b) and the Schlüter®-KERDI collar (a).

Schlüter®-KERDI-SHOWER-TB

is a sloped tray with a pre-adhered Schlüter®-KERDI waterproofing membrane.

Schlüter®-KERDI-SHOWER-TC

is a set consisting of the sloped tray (b), the levelling board (c) and the Schlüter®-KERDI collar (a).

Note: The drain body and the drainage pipe of the Schlüter®-KERDI-DRAIN-BASE floor drain are inserted into the levelling board (c). The board has a custom fit opening for the drain body. The board also features a pipe cut out that runs at a right angle to the wall and diagonally to the wall corner.

Use a utility knife to make the necessary cut outs along the embossed groove. The board, which is divided into two parts for easier handling, also has a tongue and groove connection.

The sloped tray (b) already has the necessary gradient of > 2 % (except for long sides of sloped trays in the dimension 90 x 180 cm). It features a custom fit opening for the Schlüter®-KERDI-DRAIN bonding flange. The board, which is divided into two parts for easier handling, also has a tongue and groove connection mechanism. Cutting grooves are marked on the back for the construction of circular showers.

The sloped tray (b) is installed in combination with the levelling board or can be used separately, depending on the individual construction site situation (e.g. wood structure, vertical drain, mortar substructure etc.).

The Schlüter®-KERDI collar (a) is available in matching sizes for the sloped tray (or is pre-adhered in the case of the sloped tray Schlüter®-KERDI-SHOWER-TB) and features a matching round cut-out (Ø 175 mm) for the bonding flange insert.

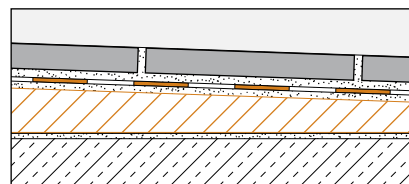

Schlüter®-KERDI-SHOWER-T

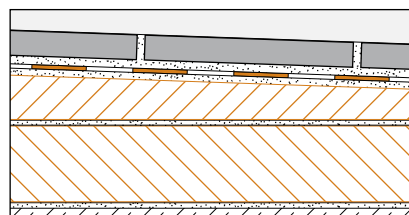

Schlüter®-KERDI-SHOWER-TC



Schlüter®-KERDI waterproofing collar

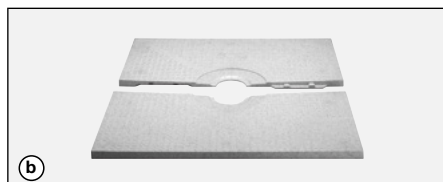

Schlüter®-KERDI-SHOWER sloped board

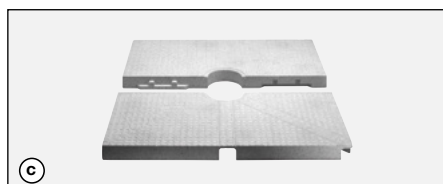

Schlüter®-KERDI-SHOWER levelling board



Schlüter®-KERDI-SHOWER-TB sloped board

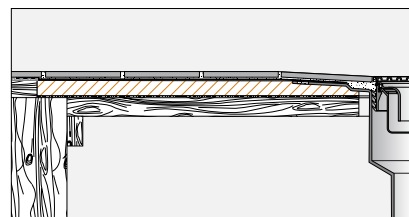

Example Schlüter®-KERDI-SHOWER-TB

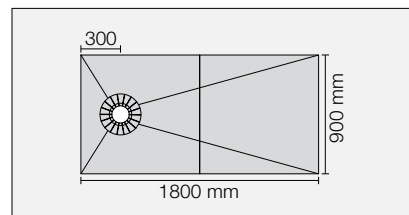
Schlüter®-KERDI-SHOWER sloped board
KSTO 900 1800



Schlüter®-KERDI-SHOWER-SK

is a waterproofing set for floor level showers. Schlüter®-KERDI-SHOWER-SK includes Schlüter®-KERDI (1) for waterproofing the wall areas of showers as well as the corresponding prefabricated parts for internal corners (2) and collars for pipe sleeves (3). The scope of supply also includes Schlüter®-KERDI-KEBA sealing band (4) for covering joints and internal floor to wall connections, corners and the sealing adhesive Schlüter®-KERDI-COLL-L (6).

Schlüter®-KERDI-SHOWER-SK is suitable for combination with the floor components Schlüter®-KERDI-SHOWER-T, -TB, and -TC as well as -L and -LC or for conventional floor level showers installed with screed.

Schlüter®-KERDI-SHOWER-SKB

also includes a Schlüter®-KERDI-DRAIN-BASE floor drain.

Schlüter®-KERDI-SHOWER-SKB is suitable for conventional floor level showers and for combination with the floor elements Schlüter®-KERDI-SHOWER-T, -TB, and -TC.

Note:

***Only the waterproofing set Schlüter®-KERDI-SHOWER-SKB includes Schlüter®-KERDI-DRAIN-BASE.

Item no. KSS 5 and KSS5 KD 10 EH 40* = Waterproofing set for up to 1000 x 1000 mm

Item no. KSS 10 and KSS 10 KD 10 EH 40** = Waterproofing set for up to 2000 x 2000 mm or 900 x 1800 mm

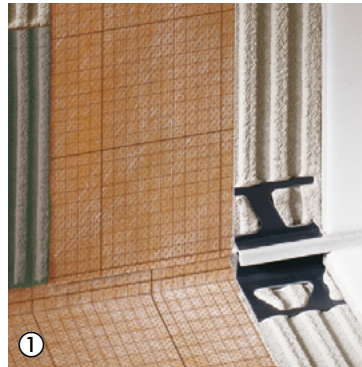

Schlüter®-KERDI-200
(1 m x 5 m*) / (1 m x 10 m**)

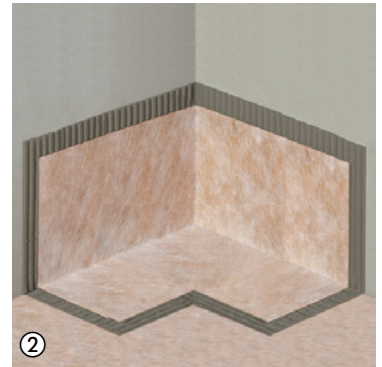

Schlüter®-KERDI-KERECK/FI
(2 pieces)

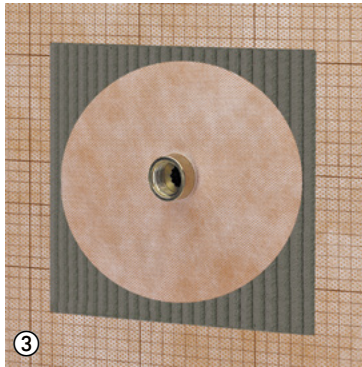

Schlüter®-KERDI-KM
(2 pieces)



Schlüter®-KERDI-KEBA
(12.5 cm x 10 m)

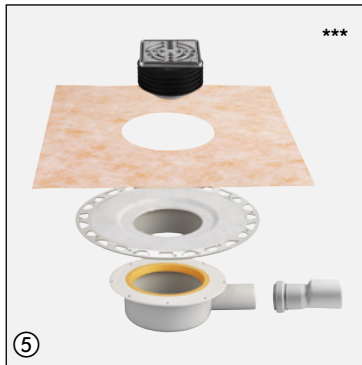

Schlüter®-KERDI-DRAIN-BASE
(1 piece)
incl. grate and frame set



Schlüter®-KERDI-COLL-L
(1.85 kg*) / (4.25 kg**)

**Text template for tenders:**

_____units Schlüter®-KERDI-SHOWER-T as a floor level shower tray of rigid extruded polystyrene foam, suitable for the installation of tiles and able to withstand the weight of wheelchairs, featuring a trapezoid shaped adhesive structure and pre-fabricated slope > 2% (except long side sloped trays 90 x 180 cm) in the dimension

- 90 x 90 cm
- 100 x 100 cm
- 120 x 120 cm
- 150 x 150 cm
- 90 x 180 cm

with the matching Schlüter®-KERDI waterproofing collar made of crack bridging polyethylene waterproofing membrane with anchoring fleece laminated on both sides for bonding with the tile adhesive, to be supplied and professionally installed while observing the manufacturer instructions.

Art.-No.: _____
Material: _____/unit
Labour: _____/unit
Total price: _____/unit

Text template for tenders:

_____units Schlüter®-KERDI-SHOWER-TC as a 2 piece floor level shower tray of rigid expanded polystyrene foam, suitable for the installation of tiles and able to withstand the weight of wheelchairs, featuring a trapezoid shaped adhesive structure and pre-fabricated slope > 2% (except long-side sloped trays 90 x 180 cm) with the matching 2 piece levelling board for insertion of the drain body and the drain pipe, in the dimension

- 90 x 90 cm
- 100 x 100 cm
- 120 x 120 cm
- 150 x 150 cm
- 90 x 180 cm

with the matching Schlüter®-KERDI waterproofing collar made of crack bridging polyethylene waterproofing membrane with anchoring fleece laminated on both sides for bonding with the tile adhesive, to be supplied and professionally installed while observing the manufacturer's instructions.

Art.-No.: _____
Material: _____/unit
Labour: _____/unit
Total price: _____/unit

Text template for tenders:

_____units of Schlüter®-KERDI-SHOWER-TB as a shower tray element for floor level tiling, suitable to bear the weight of wheelchairs, made of expanded rigid polystyrene foam with an existing gradient of > 2% and a pre-adhered Schlüter®-KERDI waterproofing membrane consisting of a crack bridging polyethylene waterproofing membrane with anchoring fleece laminated on both sides for bonding with the tile adhesive, to be supplied in the size

- 100 x 100 cm

and professionally installed while observing the manufacturer's instructions.

Art.-No.: _____
Material: _____/unit
Labour: _____/unit
Total price: _____/unit

Text template for tenders:

_____units of Schlüter®-KERDI-SHOWER-SK bonded waterproofing set, consisting of Schlüter®-KERDI as a crack bridging polyethylene waterproofing membrane with anchoring fleece laminated on both sides for bonding with the tile adhesive, Schlüter®-KERDI-KEBA as a sealing band made of polyethylene foil with anchoring fleece laminated on both sides for covering abutting joints and floor to wall transitions, 2 pieces Schlüter®-KERDI-KERECK as pre-fabricated interior corner pieces made of polyethylene foil with anchoring fleece laminated on both sides for sealing corner areas, 2 pieces Schlüter®-KERDI-KM as a polyethylene pipe collar with a 22 mm opening and anchoring fleece laminated on both sides, 1 piece Schlüter®-KERDI-COLL-L as a two component sealing adhesive based on a solvent-free acrylate dispersion and a cement reactive powder for adhering and sealing the overlaps of Schlüter®-KERDI membranes to construct

- floor level showers with dimensions up to 1.0 m x 1.0 m

■ floor level showers with dimensions up to 2.0 m x 2.0 m and professionally installed while observing the manufacturer's instructions.

Art.-No.: _____
Material: _____/unit
Labour: _____/unit
Total price: _____/unit

Text template for tenders:

_____units of Schlüter®-KERDI-SHOWER-SKB bonded waterproofing set including floor drain, consisting of Schlüter®-KERDI as a crack bridging polyethylene waterproofing membrane with anchoring fleece laminated on both sides for bonding with the tile adhesive, Schlüter®-KERDI-BAND as a sealing band made of polyethylene foil with anchoring fleece laminated on both sides for covering abutting seams and floor-wall transitions, 2 pieces Schlüter®-KERDI-KERECK as pre-fabricated interior corner pieces made of polyethylene foil with anchoring fleece laminated on both sides for sealing corner areas, 2 pieces Schlüter®-KERDI-KM as a polyethylene pipe collar with a 22 mm opening and anchoring fleece laminated on both sides, 1 piece Schlüter®-KERDI-COLL-L as a two component sealing adhesive based on a solvent free acrylate dispersion and a cement reactive powder for adhering and sealing the overlaps of Schlüter®-KERDI membranes and 1 piece Schlüter®-KERDI-DRAIN-BASE as a floor drain with odour trap, horizontal coupling DN 40/DN 50 (40/50 mm) and a bonding flange insert with stainless steel grate 10 x 10 cm (Design 1) to construct

- floor level showers with dimensions up to 1.0 m x 1.0 m

■ floor level showers with dimensions up to 2.0 m x 2.0 m

and professionally installed while observing the manufacturer's instructions.

Art.-No.: _____
Material: _____/unit
Labour: _____/unit
Total price: _____/unit