

BLITZ

MINI CHOPPER

 professional®

INSTRUCTION MANUAL



PLEASE READ THESE INSTRUCTIONS CAREFULLY BEFORE USE

SQIM 5690-5691-5692 10-08-2022 V7 | © 2022 SQ Professional Ltd

FEATURES

- 1 Button
- 2 Motor unit
- 3 Safety cover
- 4 Sealing ring
- 5 Blade
- 6 Glass bowl
- 7 Drive shaft
- 8 Anti-slip rubber base

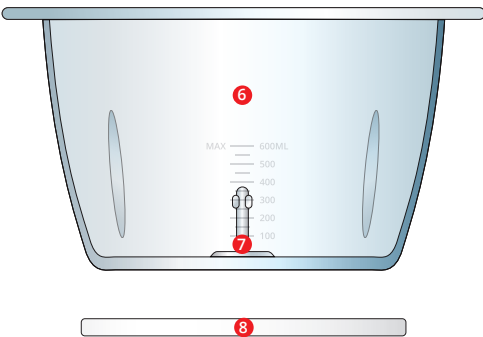
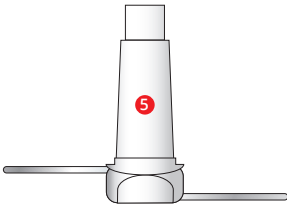
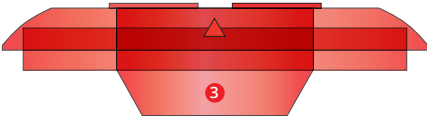

SHARP BLADES!

Due to sharp parts and potential hazards, this appliance should not be used by children under 16 years old unless supervised by an adult.

Please keep the appliance and mains cable out of the reach of children.

This is not a toy!

If used by persons with reduced physical, sensory or mental capabilities, instruction and supervision must be given to understand the use of the appliance and the hazards involved.

Always disconnect the appliance from the power socket if it is left unattended and before assembling, disassembling or cleaning.

If the mains cable is damaged, it must be replaced by qualified persons in order to avoid any hazards.

IMPORTANT SAFEGUARDS

Do not use the appliance in a bathroom, near water, or outdoors. Do not operate the appliance with wet hands or bare feet.

Do not immerse any of the parts (appliance, mains cable, plug) in water or other liquids during use to protect from fire, electric shock and personal injury.

Do not use the appliance if it is damaged or malfunctioning.

Do not leave the appliance unattended whilst in use. Use and store it out of reach of children.

Blade 5 is very sharp, handle with care. Always hold the blade 5 at the top away from the cutting edge when handling or cleaning.

- This appliance is intended for household use only.
- Ensure that the appliance is always placed on a firm and flat surface, away from any edges of the worktop. Do not place the appliance onto a metal tray or metal surface whilst in use. Do not place the appliance on, or near, a hot gas or electric burner or in a heated oven.
- Keep the appliance and mains cable away from the edges of worktops and out of reach of children. Route the mains cable so it does not overhang, and cannot be tripped over or caught.
- Do not let the mains cable run across an open space, such as between a low power socket and a table, or across any hot area, such as a cooker. Heat may damage the mains cable.
- The connections on both sides of the mains cable (the appliance and the power socket) should never be strained. If the mains cable is damaged it must be replaced by a qualified person or service to avoid any hazards.
- This appliance must not be operated by an external timer or a remote control system.
- Ensure safety cover 3 and motor unit 2 are securely locked in place before operating the appliance.
- Unplug the appliance when not in use.
- Ensure that the appliance has come to a complete stop before cleaning and storing away. Keep the all the parts, motor unit 2, mains cable, and plug away from sources of heat. Store in a dry place.
- Use the glass bowl 6 only with the motor unit 2 supplied (and vice versa) and do not tamper the motor unit 2 in any way.
- Read all operating instructions before using the appliance.

SAVE THESE INSTRUCTIONS FOR FUTURE REFERENCE

BEFORE FIRST USE

All parts that come in touch with food are to be thoroughly cleaned before being used for the first time (see section on Cleaning).

ASSEMBLY

- Place the anti-slip rubber base 8 on a flat, dry surface with the curved edges facing upwards.
- Place the glass bowl 6 on the anti-slip rubber base 8 and ensure it is securely nested.
- Fit the blade 5 on the drive shaft 7 and place your ingredients in the bowl.
- Ensure that the sealing ring 4 is correctly attached to the safety cover 3 and fit the assembled cover onto the bowl.
- Align the triangle on the motor unit 2 with the triangle on the safety cover 3 and insert the motor unit 2.
- The appliance will not operate unless the motor unit 2, safety cover 3 and the glass bowl 6 are correctly engaged.

OPERATING INSTRUCTIONS

Do not touch moving parts and keep hands and utensils out of the bowl when the appliance is in operating mode to reduce risk of severe injury to persons and damage to the appliance.

If using warm liquids or ingredients, always ensure that they are cooled down before chopping.

- Plug the mains cable into the power socket. Lightly press and hold down the button 1 on the top of the motor unit 2 to start processing. Release the button 1 to stop the appliance.
- When the processing is finished, unplug the mains cable from the power socket before removing the motor unit 2 from the safety cover 3.
- The maximum capacity of the glass bowl 6 is 600ml. Never exceed 200ml of liquid or 350ml marking of dry ingredients. Best results are obtained by chopping small quantities at one time.
- To chop dry foods such as nuts, bread crumbs, crackers, cookies, etc. cut them in smaller pieces. Ensure that the glass bowl 6, blade 5, safety cover 3 and the food are completely dry.
- When preparing food for babies or infants, always check that the ingredients are thoroughly blended before feeding.

CLEANING

Clean and dry the appliance thoroughly after every use.

- Switch off and unplug the mains cable from the power socket.
- Exercise extreme care when removing the blade ⑤ from the glass bowl ⑥ as it is very sharp.
- Wash the glass bowl ⑥, safety cover ③, sealing ring ④, blade ⑤ and anti-slip rubber base ⑧ in warm, soapy water then dry thoroughly. Alternatively, you can wash these parts on the top rack of the dishwasher.
- Wipe the motor unit ② with a damp cloth and dry thoroughly with a soft, lint-free cloth.

SPECIFICATIONS

Rated Voltage:	AC 220-240V~
Frequency:	50/60Hz
Rated Power:	300W
Capacity:	250g / 600ml

ELECTRICAL

The product must not be used without the fuse cover fitted.

Should the power cable or the power plug become damaged, arrange for these to be replaced by Customer Service or a qualified person before continuing to use the appliance. The appliance is fitted with a 5A fuse (BS1362) in a 5A plug (BS1363).

ENVIRONMENTAL

To reduce environmental and health problems due to hazardous substances in electrical and electronic goods, appliances marked with the symbol below must not be disposed of with unsorted municipal waste. Please repair, reuse or recycle appropriately.



SERVICE

The product is not user-serviceable. If it is not working, read the instructions, check the plug fuse and main fuse/circuit breaker. If it is still not working, consult your retailer.

If that does not solve the problem ring Customer Service – they may be able to offer technical advice. Please have the Model Number to hand, as they will not be able to help you without it.

If you are advised to return the product to us, pack it carefully, include a note with your name, address, day phone number, and description of the problem.

If under a guarantee, say where and when it was purchased and include a valid VAT receipt. Send it to SQ Professional Ltd.

GUARANTEE

The guarantee for this product is covered by SQ Professional Limited. Any faults with this product arising through a manufacturer defect will be covered for 1 year from the date of purchase, subject to a valid vat receipt being presented. This does not include faults or damage caused by misuse of general wear and tear. SQ Professional Ltd will not be held liable for general wear and tear, or eventual damages to persons, animals or objects caused by incorrect installation or deriving from improper, erroneous or unreasonable use.

Please contact customer services on 01992 716 070 or send an e-mail to info@sqprofessional.com, Monday to Friday from 09:30 - 17:30.

This does not affect your statutory rights.



SCAN THE QR CODE TO EXPLORE
OUR FULL PRODUCT RANGE.

Voltage Business Centre, Units 1 - 3
6 Mollison Avenue, Enfield, EN3 7XQ
T: 01992 716 070 | F: 01992 700 538 | info@sqprofessional.com

WWW.SQPROFESSIONAL.COM

