

SKI INSTALLATION INSTRUCTIONS

SKI-DOO
ALL MODELS 1999 & OLDER
DSA
MOUNTING KIT #76000194

1. Remove old ski.
2. Discard unneeded hardware.
3. Install carbide on ski using the manufacturers guidelines & hardware.
4. Place the two spools (top hat shaped) into the inner saddle of the ski and push outward until flush in the saddles, they will fit very tightly. (see Figure 1)
5. Place the rubber dampener in the ski. (dampener is reversible)
6. Recommend greasing spindle bolt.
7. Using remaining hardware, secure ski to snowmobile. (see diagram)
8. Repeat steps 1-7 for other ski.

ITEM#	PART#	DESCRIPTION	QTY
1	76000195	BOLT, 12MM X 130MM HEX	2
2	76000220	WASHER, 1.5" X .479" X .187"	4
3	76000247	BUSHING 12MM	4
4	76000198	NUT, 12MM TOP LOCK	2
5	77000219	DAMPENER - 219	2

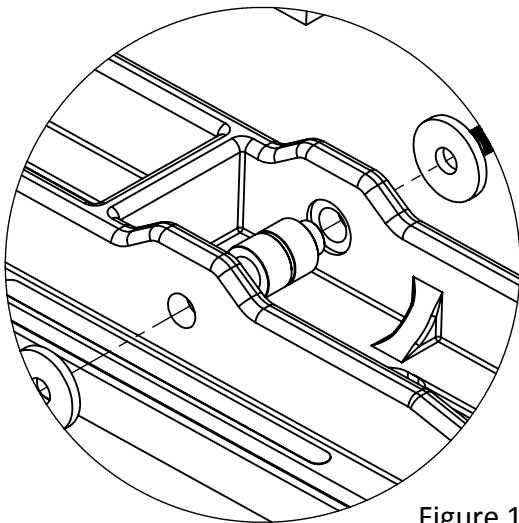

Figure 1

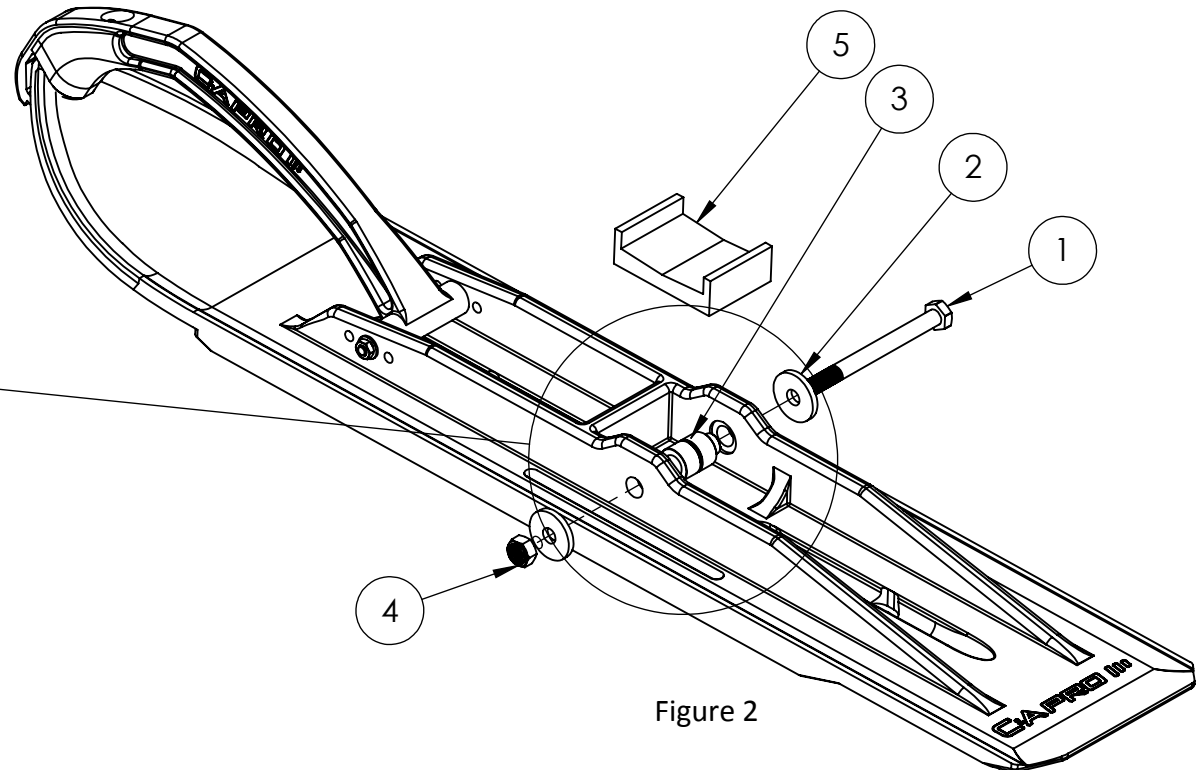

Figure 2

NOTE:
BY DESIGN, THE SKIS ARE MORE AGGRESSIVE THAN
FACTORY STANDARD SKIS. IF FOR TRAIL RIDING YOU
FIND THAT THE SKIS ARE TURNING TO HARD,
YOU MAY WANT TO LIGHTEN SKI PRESSURE FOR EASIER TURNING.
FOR ASSISTANCE ON LIGHTENING SKI PRESSURE, CONSULT YOUR
SNOWMOBILE OWNERS MANUAL OR YOUR SNOWMOBILE DEALER.