



WATER PUMP REPAIR KIT

ALL V10 OUTBOARDS WITH 6.4 IN. GEARCASE

IMPORTANT: This document guides our dealers, boatbuilders, and company service personnel in the proper installation or service of our products. If you have not been trained in the recommended servicing or installation procedures for these or similar Mercury Marine products, have the work performed by an authorized Mercury Marine dealer technician. Improper installation or servicing of the Mercury product could result in damage to the product or personal injury to those installing or operating the product. Always refer to the appropriate Mercury Marine service manual for component removal and installation instructions.

NOTE: After completing installation, place these instructions with the product for the owner's future use.

IMPORTANT: This water pump repair kit will convert engines from green color seal parts to the new purple color seal parts. The purple color seal parts cannot be mixed with green color seal parts. The green seal parts are not serviceable.

Components Contained in Kit

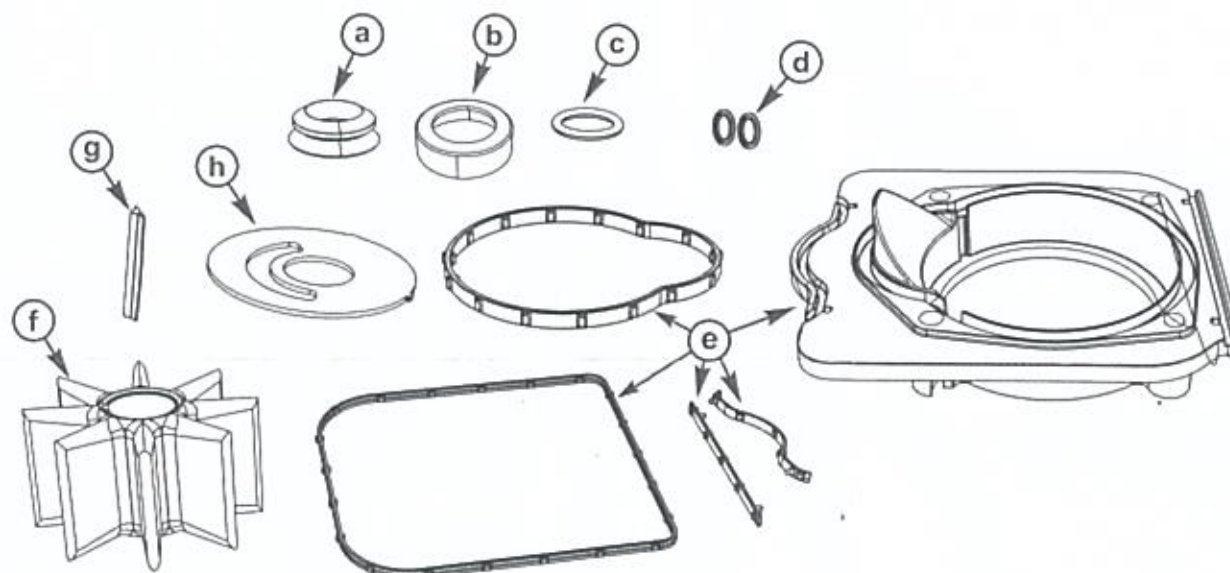

77365

Ref.	Qty.	Description	Part Number
a	1	Face seal	8M0168863
b	1	Face seal setting tool	818769
c	1	O-ring	8M0204645
d	2	Drain plug seal	8M0204693
e	1	Cover assembly	8M0220758
f	1	Impeller	8M0193514
g	1	Drive key	8M0167023
h	1	Faceplate	8M0166313

Water Pump Repair Kit

IMPORTANT: Refer to the Gear Housing section of the appropriate service manual for water pump repair procedures.

Products of Mercury Marine
W6250 Pioneer Road
Fond du Lac, WI 54936-1939

© MERCURY MARINE. All rights reserved. Reproduction in whole or in part without permission is prohibited. Alpha, Axis, Bravo One, Bravo Two, Bravo Three, Bravo Four S™, Circle M with Waves Logo, GO BOLDLY, K-planes, Mariner, MerCathode, MerCruiser, Mercury, Mercury with Waves Logo, Mercury Marine, Mercury Precision Parts, Mercury Propellers, Mercury Racing, MotorGuide, OptiMax, Pro XS, Quicksilver, SeaCore, Skyhook, SmartCraft, Sport-Jet, Verado, VesseView, Zero Effort, Zeus, #1 On the Water and We're Driven to Win are registered trademarks of Brunswick Corporation. Mercury Product Protection is a registered service mark of Brunswick Corporation. All other marks are the property of their respective owners.