

Swing Check Valve Grooved



Technical Features

- Connections: Grooved Ends (AWWA C606)
- Sizes: 2", 2-1/2", 3", 4", 5", 6", 8", 10", 12"
- Approvals: UL, ULC, and FM
- Maximum Working Pressure: 300PSI (Max. Test Pressure: 600PSI)
- Maximum Working Temperature: 250°F (120°C)
- Application: Indoor and Outdoor Use
- Low pressure-drop, Non-slam performance



Parts	Components	Material	Specification
1	Body	Ductile Iron,Epoxy Coated	A536 65-45-12
2	Clapper	Stainless Steel	ANSI 304
3	Coil Spring	Stainless Steel	ANSI 302
4	Nut	Stainless Steel	ANSI 304
5	Bolt	Stainless Steel	ANSI 304
6	Washer	Stainless Steel	ANSI 304
7	Facing Seal	Rubber	EPDM
8	Seat Ring	Stainless Steel	ANSI 304
9	Drain Plug	Ductile Iron	Drain Plug
10	Pin Plug	Ductile Iron	Pin Plug
11	Bushing	AluminumBronze	Bushing
12	Hinge Pin	Stainless Steel	Hinge Pin
13	Hook	Steel	Hook
14	Oil Ring		EPDM
15	Waser		ASTM A-307

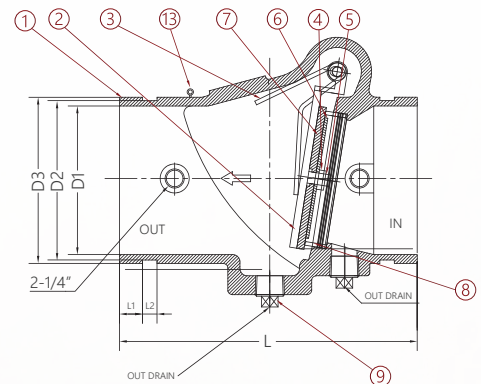

Dimensions

Size	D1		D2		D3		L		L1		L2	
	in	mm	in	mm	in	mm	in	mm	in	mm	in	mm
2"	1.9	49.0	2.2	57.1	2.4	60.3	6.7	170.0	0.6	15.8	0.3	8.7
2-1/2"	2.4	62.2	2.7	69.0	2.9	73.0	7.2	184.0	0.6	15.8	0.3	8.7
3"	2.9	74.0	3.3	84.7	3.5	89.1	7.6	195.0	0.6	15.8	0.3	8.7
4"	3.9	98.0	4.3	109.8	4.5	114.3	8.1	205.0	0.6	15.8	0.3	8.7
5"			5.4	137.0	5.6	141.3	9.8	247.7	0.6	15.8	0.3	8.7
6"	6.1	156.0	6.4	163.7	6.6	168.3	12.6	320.0	0.6	15.8	0.3	8.7
8"	7.9	201.6	8.5	215.8	8.6	218.2	14.6	372.0	0.8	20.1	0.4	10.5
10"			10.6	268.3	10.7	273.0	18.0	457.2	0.8	20.1	0.5	12.7
12"			12.5	318.3	12.8	323.9	21.1	534.9	0.8	20.1	0.5	12.7

