

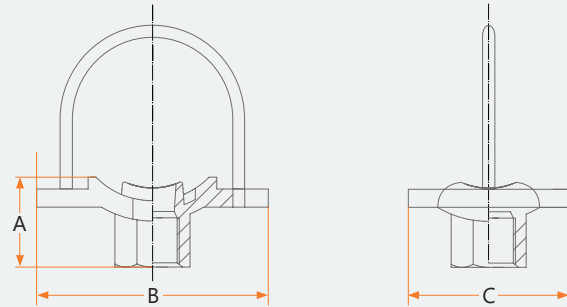

ALUTMT U Bolt Mechanical Tee

- **Model** | ALUTMT
- **Size** | 1 1/4" x 1/2" thru 2 1/2" x 1"
- **Approvals** | UL, ULC, FM
- **Working Pressure** | 300 PSI / 2.07 Mpa
- **Housing** | Ductile Iron ASTM A536 Gr. 65-45-12
- **Gasket** | EPDM - ANSI / NSF 61
- **Bolt / Nut** | Carbon Steel heat treated & zinc electroplated, ASTM A183 Gr. 2; Hex Nuts ASTM A563, Gr. B
- **Paint Color** | Orange Enamel, Optional : Red



U Bolt Mechanical Tee

Nominal Size		Pipe OD.		Hole Dia.		Dimensions						U - Bolt Size	Bolt Torque
in	mm	in	mm	+0.063,-0	+1.6,-0	A		B		C		mm	Lb-ft
				in	mm	in	mm	in	mm	in	mm		N-mm
1 1/4 x 1/2	32 x 15	1.660	42.4	1.18	30	1.69	43	3.54	90	2.2	56	0.375"	20-30
												M10	15-22
1 1/4 x 3/4	32 x 20	1.660	42.4	1.18	30	1.69	43	3.54	90	2.2	56	0.375"	20-30
												M10	15-22
1 1/4 x 1	32 x 25	1.66	42.4	1.18	30	2.01	51	3.54	90	2.2	56	0.375"	20-30
												M10	15-22
1 1/2 x 1/2	40 x 15	1.900	48.3	1.18	30	1.81	46	3.54	90	2.2	56	0.375"	20-30
												M10	15-22
1 1/2 x 3/4	40 x 20	1.900	48.3	1.18	30	1.93	49	3.54	90	2.2	56	0.375"	20-30
												M10	15-22
1 1/2 x 1	40 x 25	1.900	48.3	1.18	30	2.13	54	3.54	90	2.2	56	0.375"	20-30
												M10	15-22
2 x 1/2	50 x 15	2.375	60.3	1.18	30	2.05	52	3.78	96	2.2	56	0.375"	20-30
												M10	15-22
2 x 3/4	50 x 20	2.375	60.3	1.18	30	2.05	52	3.78	96	2.2	56	0.375"	20-30
												M10	15-22
2 x 1	50 x 25	2.375	60.3	1.18	30	2.36	60	3.78	96	2.2	56	0.375"	20-30
												M10	15-22
2 1/2 x 1/2	65 x 15	3.000	76.1	1.18	30	2.36	60	4.41	112	2.2	56	0.375"	20-30
												M10	15-22
2 1/2 x 3/4	65 x 20	3.000	76.1	1.18	30	2.36	60	4.41	112	2.2	56	0.375"	20-30
												M10	15-22
2 1/2 x 1	65 x 25	3.000	76.1	1.18	30	2.68	68	4.41	112	2.2	56	0.375"	20-30
												M10	15-22

* Do not exceed recommended Bolt Torque.