

ALRG Grooved Concentric Reducer

- **Model** | ALRG
- **Size** | 1 1/4" x 1" thru 8" x 6"
- **Approvals** | UL, ULC, FM
- **Housing** | Ductile Iron ASTM A536 Gr. 65-45-12
- **Working Pressure**
 - UL, ULC, FM | 300 PSI / 2.07 Mpa
 - Mechanical | 500 PSI / 3.45 Mpa
- **Paint Color** | Orange Enamel, Optional : Red

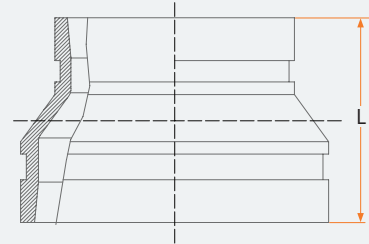

Grooved Concentric Reducer

Nominal Size		Pipe OD		Dimensions		Nominal Size		Pipe OD		Dimensions		Nominal Size		Pipe OD		Dimensions	
in	mm	in	mm	L		in	mm	in	mm	L		in	mm	in	mm	L	
				in	mm					in	mm					in	mm
1 1/4x1	32x25	1.660x1.315	42.4x33.7	2.51	64	4x1 1/2	100x40	4.500x1.900	114.3x48.3	2.99	76	6x2 1/2	150x65	6.500x3.000	165.1x76.1	4.01	102
1 1/2x1	40x25	1.900x1.315	48.3x33.7	2.51	64	4x2	100x50	4.500x2.375	114.3x60.3	2.99	76	6x3	150x80	6.500x3.500	165.1x88.9	4.01	102
1 1/2x1 1/4	40x32	1.900x1.660	48.3x42.4	2.51	64	4x2 1/2	100x65	4.500x3.000	114.3x76.1	2.99	76	6x4	150x100	6.500x4.500	165.1x114.3	4.01	102
2x1	50x25	2.375x1.315	60.3x33.7	2.51	64	4x3	100x80	4.500x3.500	114.3x88.9	2.99	76	6x5	150x125	6.500x5.500	165.1x139.7	4.01	102
2x1 1/4	50x32	2.375x1.660	60.3x42.4	2.51	64	5x2	125x50	5.500x2.375	139.7x60.3	3.5	89	6x2	150x50	6.625x2.375	168.3x60.3	4.01	102
2x1 1/2	50x40	2.375x1.900	60.3x48.3	2.51	64	5x2 1/2	125x65	5.500x3.000	139.7x76.1	3.5	89	6x2 1/2	150x65	6.625x3.000	168.3x76.1	4.01	102
2 1/2x1	65x25	2.875x1.315	73.0x33.7	2.51	64	5x3	125x80	5.500x3.500	139.7x88.9	3.5	89	6x3	150x80	6.625x3.500	168.3x88.9	4.01	102
2 1/2x1 1/4	65x32	2.875x1.660	73.0x42.4	2.51	64	5x4	125x100	5.500x4.500	139.7x114.3	3.5	89	6x4	150x100	6.625x4.500	168.3x114.3	4.01	102
2 1/2x1 1/2	65x40	2.875x1.900	73.0x48.3	2.51	64	5x4	125x50	5.563x2.375	141.3x60.3	3.5	89	6x5	150x125	6.625x5.500	168.3x139.7	4.01	102
2 1/2x2	65x50	2.875x2.375	73.0x60.3	2.51	64	5x2 1/2	125x65	5.563x3.000	141.3x76.1	3.5	89	8x2	200x50	8.625x2.375	219.1x60.3	5	127
2 1/2x1 1/4	65x32	3.000x1.660	76.1x42.4	2.51	64	5x3	125x80	5.563x3.500	141.3x88.9	3.5	89	8x2 1/2	200x65	8.625x3.000	219.1x76.1	5	127
2 1/2x1 1/2	65x40	3.000x1.900	76.1x48.3	2.51	64	5x2 1/2	125x100	5.563x4.500	141.3x114.3	3.5	89	8x3	200x80	8.625x3.500	219.1x88.9	5	127
2 1/2x2	65x50	3.000x2.375	76.1x60.3	2.51	64	6x2	150x50	6.250x2.375	159.0x60.3	4.01	102	8x4	200x100	8.625x4.250	219.1x108.0	5	127
3x1 1/4	80x32	3.500x1.660	88.9x42.4	2.51	64	6x2 1/2	150x65	6.250x3.000	159.0x76.1	4.01	102	8x4	200x100	8.625x4.500	219.1x114.3	5	127
3x1 1/2	80x40	3.500x1.900	88.9x48.3	2.51	64	6x3	150x80	6.250x3.500	159.0x88.9	4.01	102	8x5	200x125	8.625x5.500	219.1x139.7	5	127
3x2	80x50	3.500x2.375	88.9x60.3	2.51	64	6x4	150x100	6.250x4.250	159.0x108.0	4.01	102	8x6	200x150	8.625x6.250	219.1x159.0	5	127
3x2 1/2	80x65	3.500x3.000	88.9x76.1	2.51	64	6x4	150x100	6.250x4.500	159.0x114.3	4.01	102	8x6	200x150	8.625x6.500	219.1x165.1	5	127
4x2 1/2	100x65	4.250x3.000	108.0x76.1	2.99	76	6x5	150x125	6.250x5.250	159.0x133.0	4.01	102	8x6	200x150	8.625x6.500	219.1x165.1	5	127
4x3	100x80	4.250x3.500	108.0x88.9	2.99	76	6x5	150x125	6.250x5.500	159.0x139.7	4.01	102	8x6	200x150	8.625x6.500	219.1x165.1	5	127
4x1 1/4	100x32	4.500x1.660	114.3x42.4	2.99	76	6x2	150x50	6.500x2.375	165.1x60.3	4.01	102	8x6	200x150	8.625x6.625	219.1x168.3	5	127