

# ALC Cap

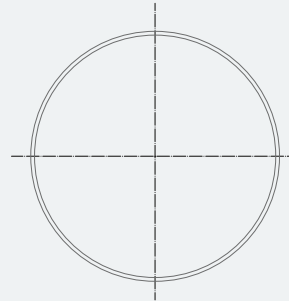

- Model | ALC
- Size | 1" thru 12"
- Approvals | UL, ULC, FM
- Housing | Ductile Iron ASTM A536 Gr. 65-45-12
- Working Pressure
  - UL, ULC, FM | 300 PSI / 2.07 Mpa
  - Mechanical | 500 PSI / 3.45 Mpa
- Paint Color | Orange Enamel, Optional : Red



Cap

Nominal Size		Pipe OD.		Dimensions (L)	
in	mm	in	mm	in	mm
1	25	1.327	33.7	0.98	25
1¼	32	1.669	42.4	0.98	25
1½	40	1.9	48.3	0.98	25
2	50	2.375	60.3	0.98	25
2½	65	2.875	73	0.98	25
2½	65	3	76.1	0.98	25
3	80	3.5	88.9	0.98	25
4	100	4.25	108	1.06	27
4	100	4.5	114.3	1.06	27
5	125	5.25	133	1.06	27
5	125	5.5	139.7	1.06	27
5	125	5.563	141.3	1.06	27
6	150	6.25	159	1.06	27
6	150	6.5	165.1	1.06	27
6	150	6.625	168.3	1.06	27
8	200	8.625	219.1	1.22	31
10	250	10.75	273	1.3	33
12	300	12.75	323.9	1.3	33