

AL45E 45° Elbow

- Model | AL45E
- Size | 1" thru 12"
- Approvals | UL, ULC, FM
- Housing | Ductile Iron ASTM A536 Gr. 65-45-12
- Working Pressure
 - UL, ULC, FM | 300 PSI / 2.07 Mpa
 - Mechanical | 500 PSI / 3.45 Mpa
- Paint Color | Orange Enamel, Optional : Red

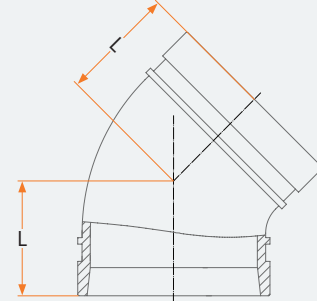

45° Elbow

Nominal Size		Pipe OD.		Dimensions (L)	
in	mm	in	mm	in	mm
1	25	1.327	33.7	1.77	45
1¼	32	1.669	42.4	1.77	45
1½	40	1.9	48.3	1.77	45
2	50	2.375	60.3	2.01	51
2½	65	2.875	73	2.24	57
2½	65	3	76.1	2.24	57
3	80	3.5	88.9	2.51	64
4	100	4.25	108	3	76
4	100	4.5	114.3	3	76
5	125	5.25	133	3.24	82.5
5	125	5.5	139.7	3.24	82.5
5	125	5.563	141.3	3.24	82.5
6	150	6.25	159	3.5	89
6	150	6.5	165.1	3.5	89
6	150	6.625	168.3	3.5	89
8	200	8.625	219.1	4.25	108
10	250	10.75	273	4.74	120.5
12	300	12.75	323.9	5.23	133