

# CIRQUE KNOB

Explore our Cirque cabinet knob, with its round profile and a delicate balance of knurled and smooth accents. Solid brass construction throughout.



## Cirque Knob

Product Code	Diameter (D)	Base (B)	Projection (P)
CIRQ-KNOB-KNRL-D030	30mm	20mm	20mm
CIRQ-KNOB-KNRL-D042	42mm	20mm	20mm

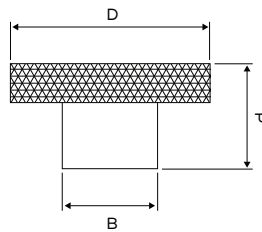

## SPECIFICATIONS

Dimensions are nominal measurements only.

### Mounting Hardware (Included)

M4 x 25mm Screws

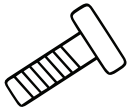

### Material

Solid Brass

### Finishes

Brushed Golden Brass, Matte Black

### Care Guide



Regularly clean or lightly brush with warm, soapy water, and then pat dry with a microfiber cloth.



DO NOT use alcohol, acid or alkali based cleaners, abrasive solutions, scouring pads or creams.

### Waranty

- 5 years structural warranty
- 12 months finish warranty

## DISCLAIMERS

- Products in this document must be installed by a licensed tradesperson.
- Heart Handles reserves the right to modify specifications or remove products from our website without prior notice.
- Any specifications listed are correct at the time of publication. However, we do not take responsibility for printing errors.
- Only drill/cut according to the actual hardware you receive. Do not drill/cut prior to receiving the actual hardware.