

# MV-CU013-80GM/GC

1.3 MP 1/2.7" CMOS GigE Area Scan Camera



**GEN*i*CAM**

**GIG*E***  
VISION

## Introduction

MV-CU013-80GM/GC camera adopts CMOS sensor to provide high-quality images. It uses GigE interface to transmit non-compressed images in real time, and its max. frame rate can reach 89.9 fps in full resolution.

## Key Feature

- Supports auto or manual adjustment of gain, exposure time, manual adjustment of LUT, Gamma correction, etc.
- Supports hardware trigger, software trigger, free run, etc.
- Adopts GigE interface and max. transmission distance of 100 meters without relay.
- Compatible with GigE Vision V2.0 Protocol, GenCam Standard, and third-party software based on the protocol and standard.

## Dimension

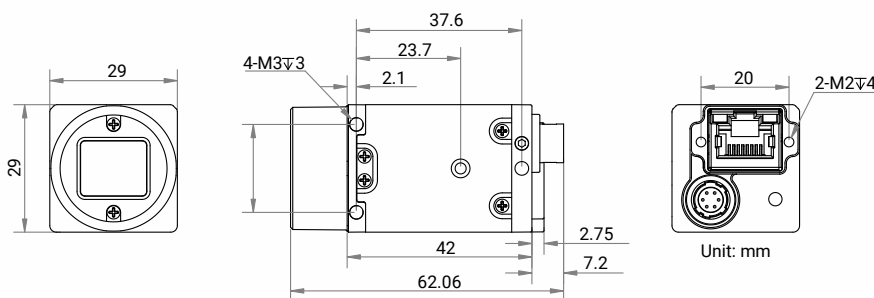

## Available Model

- Mono camera: MV-CU013-80GM
- Color camera: MV-CU013-80GC

## Applicable Industry

Electronic semiconductor, factory automation, liquor and beverage, medicine packing, etc.

## Sensor Quantum Efficiency

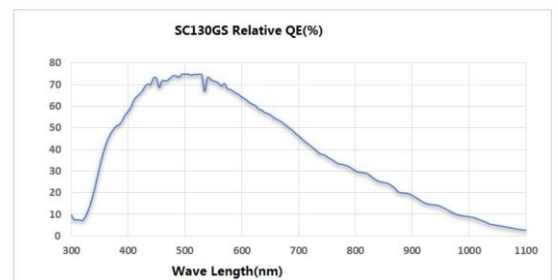

MV-CU013-80GM



MV-CU013-80GC



# Specification

Model	MV-CU013-80GM	MV-CU013-80GC
<b>Camera</b>		
Sensor type	CMOS, global shutter	
Sensor model	SS	
Pixel size	4.0 $\mu\text{m}$ $\times$ 4.0 $\mu\text{m}$	
Sensor size	1/2.7"	
Resolution	1280 $\times$ 1024	
Max. frame rate	89.9 fps @1280 $\times$ 1024 Mono 8	89.9 fps @1280 $\times$ 1024 Bayer BG 8
Dynamic range	54.5 dB	
SNR	39.2 dB	
Gain	0 dB to 20 dB	
Exposure time	31 $\mu\text{s}$ to 1 sec	
Exposure mode	Off/Once/Continuous exposure mode	
Mono/color	Mono	Color
Pixel format	Mono 8/10/10Packed/12/12Packed	Bayer BG 8/10/10Packed/12/12Packed
Binning	Supports 1 $\times$ 1, 2 $\times$ 2, 4 $\times$ 4	
Decimation	Supports 1 $\times$ 1, 2 $\times$ 2, 4 $\times$ 4	
Reverse image	Supports horizontal and vertical reverse image output	
<b>Electrical features</b>		
Data interface	Gigabit Ethernet, compatible with Fast Ethernet	
Digital I/O	6-pin P7 connector provides power and I/O, including opto-isolated input $\times$ 1 (Line 0), opto-isolated output $\times$ 1 (Line 1), bi-directional non-isolated I/O $\times$ 1 (Line 2).	
Power supply	9 VDC to 24 VDC, PoE is optional	
Power consumption	Typ. 1.9 W@12 VDC	Typ. 2.2 W@12 VDC
<b>Mechanical</b>		
Lens mount	C-Mount	
Dimension	29 mm $\times$ 29 mm $\times$ 42 mm (1.1" $\times$ 1.1" $\times$ 1.7")	
Weight	Approx. 76 g (0.17 lb.)	
Ingress protection	IP30 (under proper lens installation and wiring)	
Temperature	Working temperature: 0 $^{\circ}\text{C}$ to 50 $^{\circ}\text{C}$ (32 $^{\circ}\text{F}$ to 122 $^{\circ}\text{F}$ ) Storage temperature: -30 $^{\circ}\text{C}$ to 70 $^{\circ}\text{C}$ (-22 $^{\circ}\text{F}$ to 158 $^{\circ}\text{F}$ )	
Humidity	20% to 95% RH, non-condensing	
<b>General</b>		
Client software	MVS or third-party software meeting with GigE Vision Protocol	
Operating system	32/64-bit Windows XP/7/10, 32/64-bit Linux and 64-bit MacOS	
Compatibility	GigE Vision V2.0, GenICam	
Certification	CE, FCC, RoHS, KC	

Distribution Partner:



# SCORPION VISION