

Equal

Security redefine with equal
Smart door locks

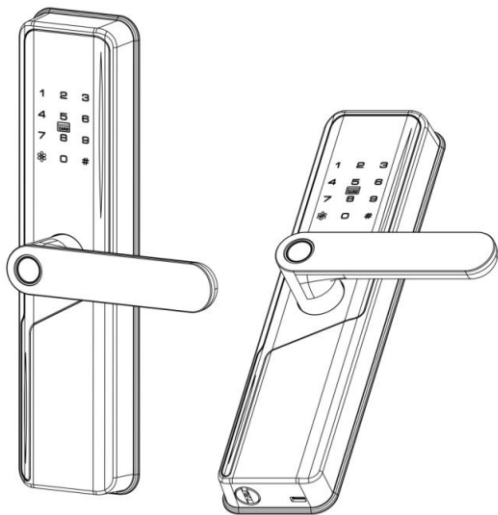

USER MANUAL

Equal Smart Matic Locks
S8 Series

TABLE OF CONTENT

Sr. No	Particular
1.	Installation Diagram
2.	Explanatory Diagram
3.	Dimension Drawing (mm)
4.	Handle Reversing Diagram
5.	Handle Square Shaft Adjustment Direction
6.	Lock Body Direction Adjustment
7.	Fingerprint needs to be input from multiple angles
8.	Function and operation
9.	Other instructions
10.	Smartlife Application Networking

1. Installation Diagram

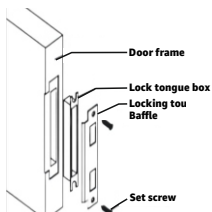
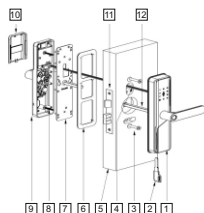

1 Front lock

2 The key

3 Fix column

4 Connecting line

5 The door

6 Silicone pad

7 Iron plate

8 Set screw

9 Rear lock

10 Battery cover

11 Lock body

12 Square shaft

2. Explanatory Diagram

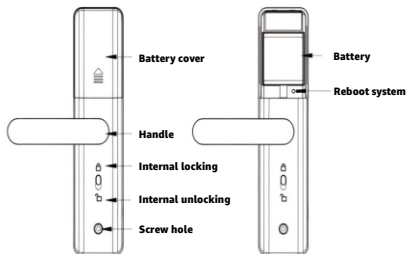
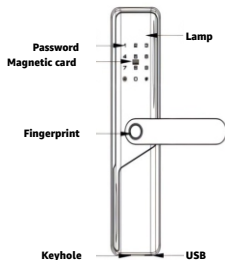

3. Dimension Drawing (mm)

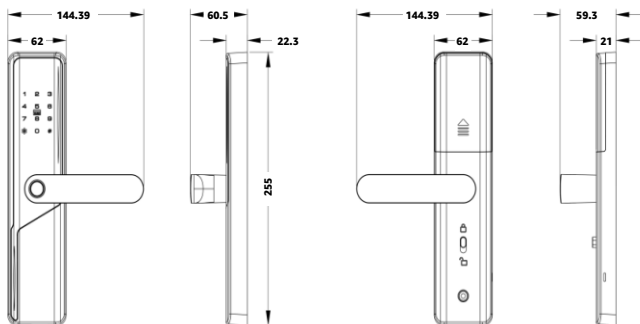

4. Handle Reversing Diagram

- Remove the screw and rotate the handle
- Rotate the handle 180 ° and fix the screw

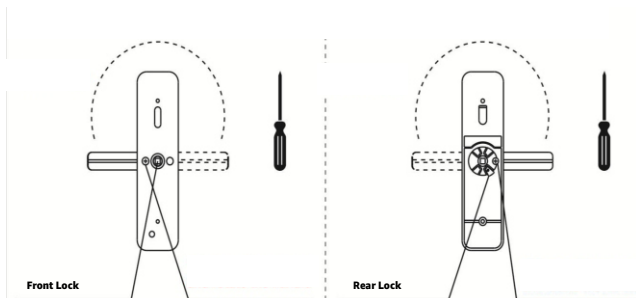

5. Handle Square Shaft Adjustment Direction

- Single tongue lock body.
The front lock handle points to r or the right side.
- Single tongue lock body with front lock handle punctuated to l on the left side.
- Double tongue lock body, the marked point of the front lock handle points to double.

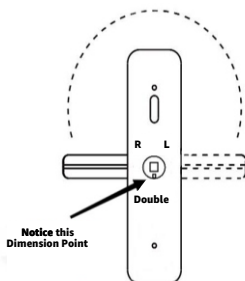

6. Lock Body Direction Adjustment

- The buckle is lifted and the locking tongue pops up.
- The lock tongue is ejected and rotated by 180 ° and pressed back.
- Square bar shaft position.

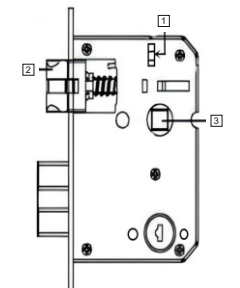

7. Fingerprint needs to be input from multiple angles



8. Function and operation

- Administrator information: refers to the administrator's fingerprint, password or IC card.
- Unlocking information: refers to the entered fingerprint, password or IC card information (including administrators and ordinary users)
- “*”key: it is the clear key / back key.
- “Key #” is the confirmation key.
- In the initial state, any fingerprint, IC card or six digit or more passwords can unlock.
- After the administrator information is entered, the fingerprint, IC card or password that is not entered cannot be unlocked.
- Access to door lock function management.

You can See the
Block Diagram on Next Page

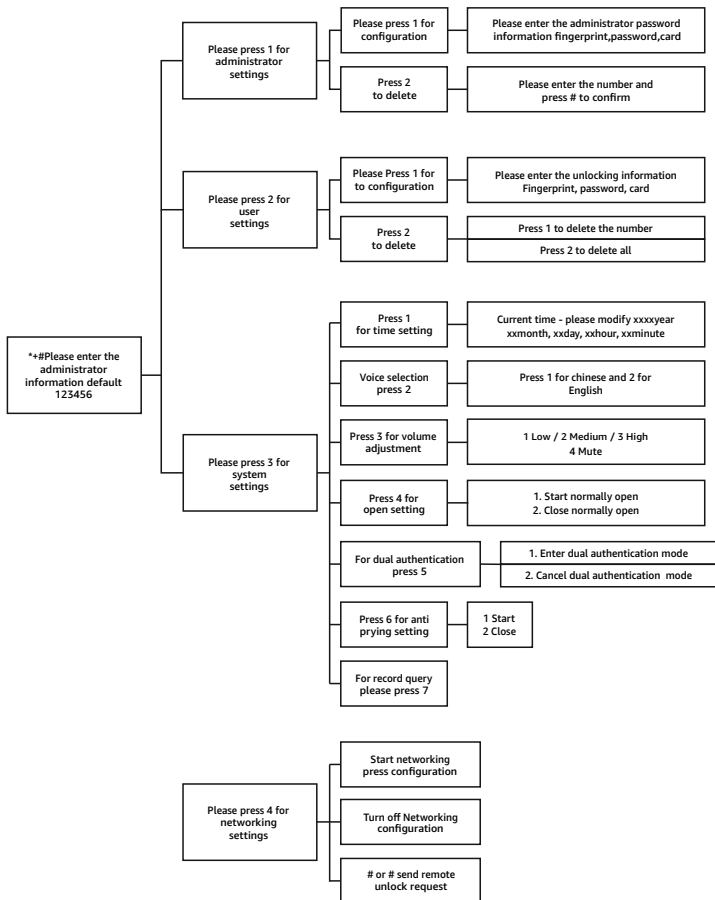

9. Other instructions

- If the unauthorized unlocking information is input incorrectly for more than 5 times in a row within 5 minutes, the system will automatically enter the invalid input state (locked state), Invalid input status duration is 90 seconds.
- Password anti snooping function: when opening the door with password, enter the password as follows: XXX password XXX; You can add some irrelevant codes before and after the password, and then press # to confirm. The password must be included in what you enter.
- The system will exit automatically if there is no operation for more than 10 seconds.
- When the voltage is lower than 4.8V, the alarm will be given automatically every time the door is unlocked. After the alarm, the rear door lock can be unlocked 100 times. After the number is exceeded, the confirm. The password must be included in what you enter. Unlocking will be delayed for 5 seconds each time. Be sure to replace the new battery before the number of unlocking times.
- Press and hold the set key for 6 seconds to initialize.

TECHNICAL PARAMETER		
Sr. No	Project	Parameter
1	Quiescent current	50uA
2	Dynamic current	180mA
3	Number of administrators	10 groups
4	Number of fingerprints	50 groups
5	Fingerprint + password + card capacity	250 groups
6	Rejection rate	0.1%
7	False admission rate	0.0001%
8	Induction time	0.5seconds
9	Power supply type	6V
10	Emergency power supply	Type c 5V 2A
11	working temperature	-25 ~60
12	Working relative humidity	20%~90%RH
13	keyboard	Touch the standard 12 bit keyboard
14	Password length	8 bits
15	False password	16 bits
16	Low voltage alarm voltage	4.8±0.2V

10. Smartlife Application Networking

- Download and install the application software "Smartlife APP" on the mobile phone (as shown in the figure).
- Open the "Smartlife APP", enter the "registration" interface, and click "mobile number / y email" to register the relevant account.
- After completing the registration, you will automatically enter the main interface, click "+" in Figure 1 at the top of the screen, then click "add device" in Figure 2, click "camera / lock" in Figure 3, find "Wi Fi" and click.

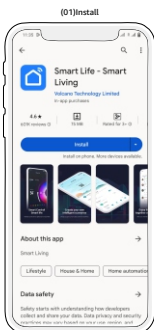

Figure 2



Figure 3

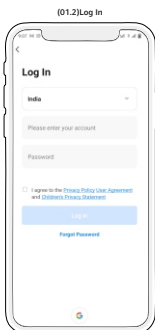
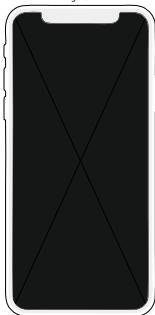
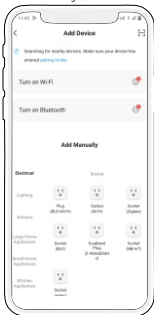
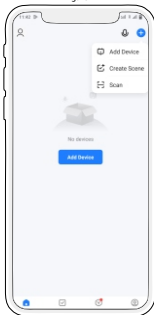

Figure 4



10. Smartlife Application Networking

- The page automatically jumps to the select Wi Fi interface. The mobile phone connects to Wi Fi first, selects a WiFi hotspot connected to 2.4G or a WiFi hotspot without a password, enters the "Wi Fi password" to connect, and then clicks "next".
- Lock connection network signal setting. "5" key will flash during waiting.
- Then operate "Smartlife app" and click "confirm that the keyboard light flashes".

Figure 5

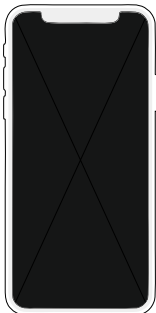

Figure 6

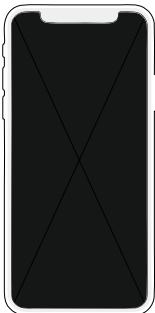

Figure 7



Figure 8

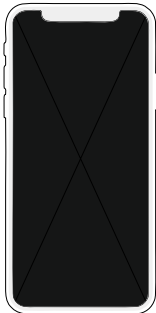

Figure 9



Figure 10



10. Smartlife Application Networking

- Click the Wi-Fi quick connect page to automatically jump to 3. After finding the device, automatically jump to 4. Wait for completion. After adding successfully, click "finish" to connect the device successfully.
- After the device is successfully connected, tap the wake-up smart lock interface and press "9 #" to request unlocking. Lock connection network After receiving the unlocking request, the app control interface. will automatically pop up "click to open the door remotely?", After confirming that it is safe.
- In this case, click "confirm" to unlock remotely. You can also click "remote dynamic password" to generate a dynamic password and input the door lock to open the door.
(dynamic password is valid within 5 minutes)

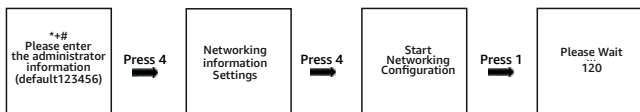

Figure 11



Figure 12



Figure 13



Equal

Manufactured & Marketed by:

Registered Office: Unique Power Technologies

H-321A, RIICO Industrial Area, Sitapura,
Jaipur - 302022, Rajasthan, India

Customer Support Desk:

Tel No. (0141) 2770301

E-mail: support@equalequip.com

Customer Care:

Toll-Free No. 1800 203 7688

www.equalequip.com

