

Instruction Manual

Thank you for purchasing FANTECH OPTILITE MK872 RGB Optical Switch Keyboard.

FANTECH OPTILITE MK872 is a plug and play usb interface RGB Optical Switch Keyboard, no need to install any driver for your first use.

TECHNICAL SPECIFICATION

- EN
- PRODUCT NAME : RGB Optical Switch Keyboard
 - NUMBER OF KEYS : 87 keys
 - POWER CONSUMPTION : 40mA - 120mA
 - WORKING VOLTAGE : DC 4.5-5.3V
 - CABLE LENGTH : 180cm

MK872 OPTILITE Size



OPTILITE MK872 RGB OPTICAL SWITCH KEYBOARD

What's included in the box

1. FANTECH OPTILITE MK872 RGB Optical Switch Keyboard
2. Switch Plugger
3. Keycaps Plugger
4. User's manual

System requirements

1. Operating systems: Windows XP/7/8/10; MAC OS
2. One free USB 2.0/3.0 port

USER MANUAL

Keys Function Map

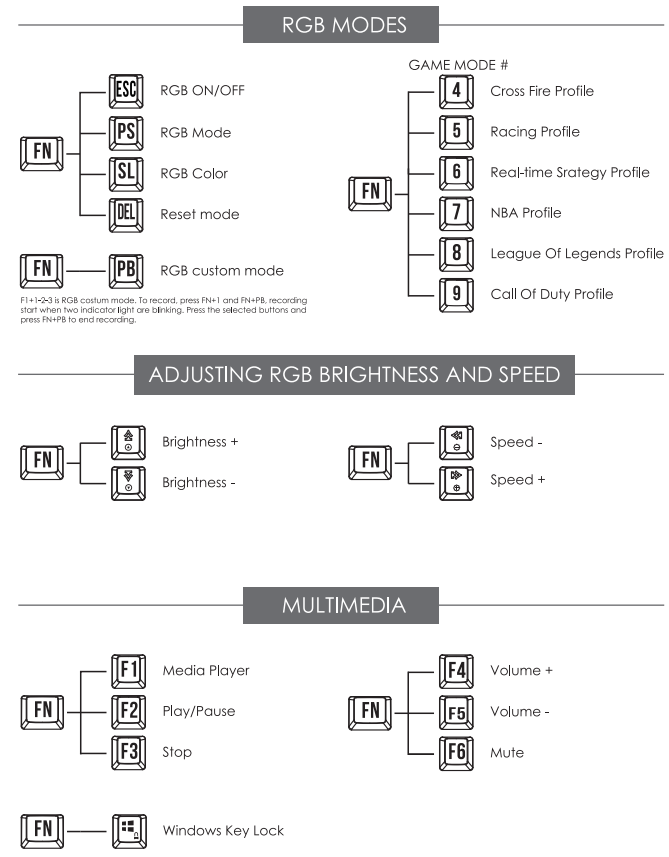

Download our Manual / Software from our official website www.fantechworld.com



Software

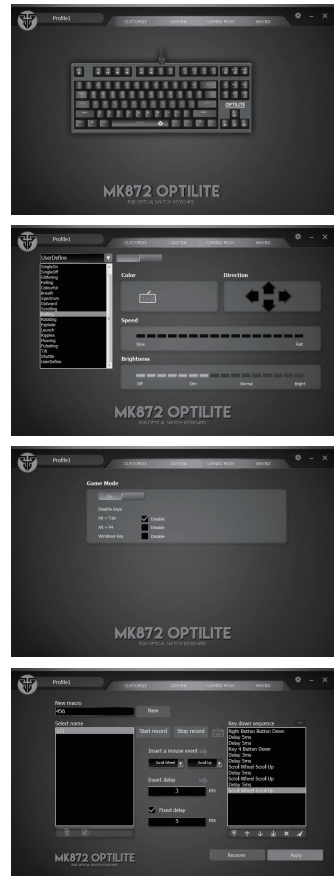

Customize

- * Select each key for function replacement
- * You can choose from 8 different customization for each key
- * After choosing your desire function Press OK.

Lighting

- * You can select up to 20 illumination mode (19 preset mode and 1 game+custom mode).
- * You can customize your own key color by selecting "User Define".
- * You can customize the illumination direction, speed and even the brightness.

Gaming Mode

- When Game Mode is turned ON. You can disable key as below :
- * Alt + Tab
 - * Alt + F4
 - * Windows Lock

Macro editing & setting

- * To make a new macro in settings, input the macro key name and then input the action.
- * The command recording will start just after you press the Start Record button.
- * You can edit the delay time before saving the macro.
- * To Save, press Stop Record button and Press the Apply button to save your macro and then it will be ready to use.

EN

Caution

- * Keyboard's main board has been coated with water and dust proof nano-technology. If accidentally poured with water, plug out the cable immediately and turn the keyboard with button faced down to make water flow out easily.
- * This keyboard designed with replaceable switch, if you found some button is not working, you can purchase and replace the switch by yourself without opening or soldering any part of keyboard.

Warning

- * Do not attempt to open, service or modify this keyboard to prevent the risk of electricity shock or other hazard and void the warranty.
- * Do not remove or change the warranty label.
- * Clean using only with dry cloth. Do not use alcohol or detergent.
- * Keep away from fire or any heat more than allowed operating and storage condition.

ID

Perhatian

- * Mainboard keyboard ini telah dilapisi dengan teknologi nano untuk anti air dan debu. Apabila tersedam air, lepas kabel dari usb port dan balikkan posisi keyboard dengan tombol menghadap kebawah agar air mudah keluar. Biarkan hingga benar-benar kering.
- * Keyboard ini didesain dengan sistem switch yang bisa diganti. Apabila ada tombol yang tidak berfungsi, anda bisa membeli dan mengganti switch dengan mudah Tanpa harus membuka dan mensolder bagian apapun dari keyboard ini.

Perhatian

- * Jangan pernah mencoba untuk membuka, servis atau memodifikasi keyboard ini untuk menghindari resiko sengatan listrik atau bahaya lainnya dan membatalkan garansi
- * Jangan membuang atau merubah label garansi
- * Bersihkan hanya dengan kain kering, jangan menggunakan alkohol atau deterjen
- * Jauhkan dari api atau panas yang melebihi suhu pemakaian dan penyimpanan

MK872 OPTILITE RGB Optical Switch Keyboard Features

- * Double injection floating key caps design, long lasting and clear view.
- * Individual RGB color led for each keys.
- * 19 Spectrum modes (19 preset mode and 1 game+custom mode).
- * FN+ combination keys for multimedia.
- * All 87 keys anti-ghosting.
- * Using gaming fast response sensor inside with 1000hz data refresh rate.
- * Gold plated, five core full copper high quality fast data transmission usb cable with booster for transmission stabilizer.
- * Using Optical switch technology with more than 80,000,000 press usage lifetime.
- * With Windows-key lock, no more unwanted windows pop-up.
- * Plug and play device. Built-in driver.