



Website: www.xmarto.com
Support: support@xmarto.com



IP Camera User Guide

Content

1. Packing list	1
2. The camera	1
3. Camera Indicator & Button Definition	2
4. Working diagram	3
5. First power recharge	4
6. Setup the camera - works as standalone camera	5
7. Pair the camera to a WiFi NVR (optional)	8
8. Pair the camera to mini WiFi hub (optional)	9
9. Install the camera	10
10. App - Camera List	11
11. App - Live Footage	12
12. App - Video Playback	13
13. Camera Settings	14
14. Motion Detection Management	15
15. Camera Light Control	15
16. Me - APP Overall Settings	16
17. App Setting	16
18. Troubleshooting	17
19. FAQ	18



1. Packing list

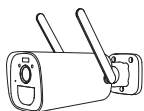

Camera x1



USB cable x1



Mounting kit x1



User manual x1

2. The camera

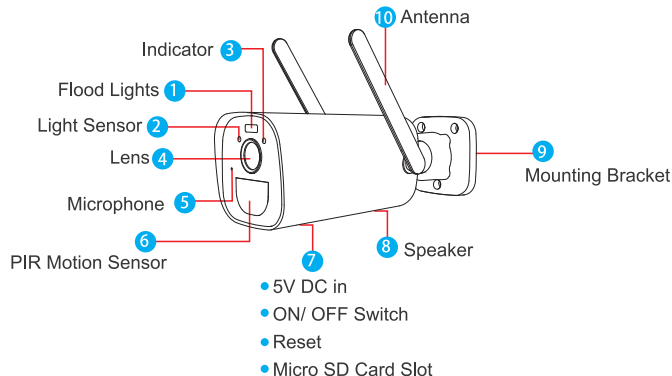

3. Camera Indicator & Button Definition

- Red light on: The camera is being viewed (privacy light)
- Red light blinks 3 times: Camera powered off
- Red light blinks fast: Camera pairing
- Red light blinks slowly: Connecting to the Internet
- Red light on even nobody is viewing: Low battery
- Green light on for 1s: The camera wakes up or just turned on.
- Green light blinks: Camera upgrading
- Green light on: Camera recharging



Button operations:

ON/OFF



Hold ON/ OFF button 2s: Power on camera

ON/OFF



Click ON/ OFF button 3 times: Power off camera

Reset



Hold reset button 5s: Reset camera to pairing mode (red light flashes)



4. Working diagram



1. The camera works standalone

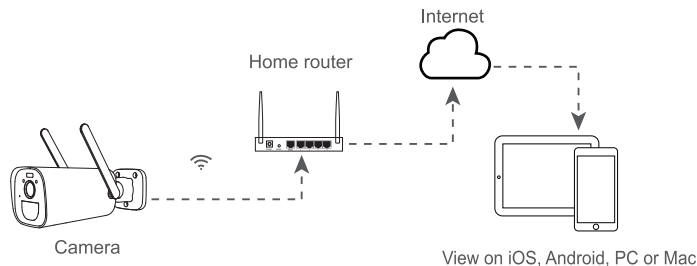

2. Pair the camera to WiFi hub or NVR

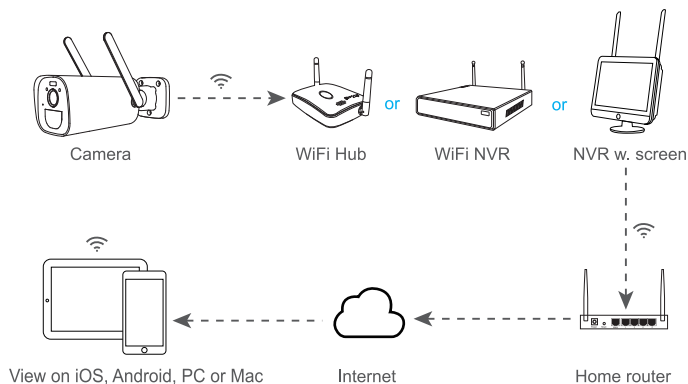

5. First power recharge

Before setup of the camera, we strongly recommend to recharge the camera overnight to make sure it has 100% power.

1. Open the rubber cover beneath the camera, use a 5V DC mobile phone power charger to charge your camera.

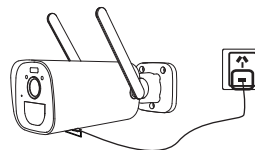

2. The indicator blinks in green while charging; indicator turns off when it's fully charged.

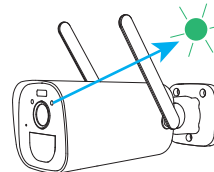

Note:

- Please use only 5V DC power charger to recharge the camera. Chargers do not meet the standard may damage the batteries.
- Please charge the battery at room temperature to avoid damage.



6. Setup the camera - works as standalone camera

1. Install App

On your iPhone or Android phone, download and install App 'xmartO WallPixel'.

You can scan the QR code to find the App, or search 'xmartO WallPixel' in App Store/ Google Play.

After App installed, spend a few minutes to create an App user account and login.



Scan to download
"xmartO WallPixel" APP



Apple iOS



Android

2. Add the camera to App

- Bring the camera and your smartphone close to your WiFi router.

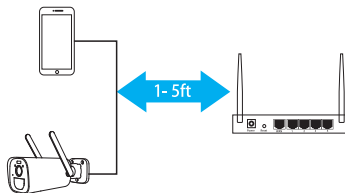

- Open the rubber cover beneath the camera, hold the ON/OFF button for 2 seconds to turn on the camera.

You should hear 'starting pairing' from the camera; and the indicator blinks in red. That means the camera enters pairing mode.

If the camera did not enter pairing mode, hold the reset button for 5 seconds to bring camera into pairing mode.



Run xmartO App

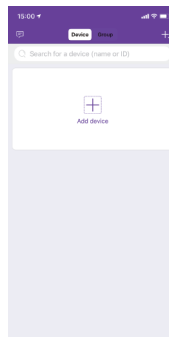

Tap + to start adding camera

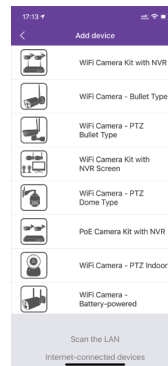

Select 'WiFi Camera - Battery-powered'

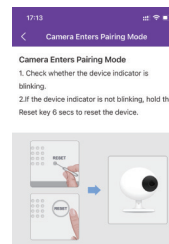

Device light is blinking

Check and confirm the camera indicator is blinking in red.

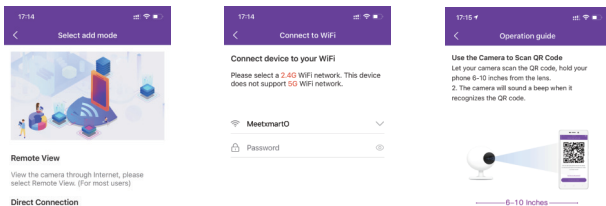

Remote View
View the camera through Internet, please select Remote View. (For most users)

Direct Connection
View the camera without Internet, the camera streams directly to your mobile. Only works while your phone is in the camera's WiFi range. (For users without Internet)

[More details of the 2 modes](#)

Remote View

Direct Connection

Select Remote View.

If you don't have Internet, select Direct Connection.(not suggested)



Print the camera lens to this QR code to recognize. Keep 6 - 10 inches distance. You will hear a prompt tone when it's read.

[No prompt tone heard?](#)

I Heard it

Next

Select your WiFi and type in your WiFi password.

Tips: only 2.4G WiFi is supported.



Within a minutes, the configuration will be done.

Please name your camera and tap 'Add device to list'.

Next

QR code scan tips. Tap Next.

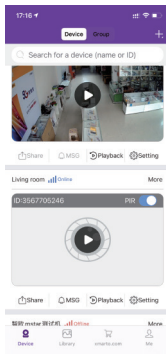

The camera appears in your App list. Tap to view the camera.



7. Pair the camera to a WiFi NVR (optional)

1. Bring the camera close to your WiFi NVR.



2. Open the rubber cover beneath the camera, hold the ON/OFF button for 2 seconds to turn on the camera.



You should hear 'starting pairing' from the camera; and the indicator blinks in red. That means the camera enters pairing mode.

If the camera did not enter pairing mode, hold the reset button for 5 seconds to bring camera into pairing mode.

3. On the NVR screen, right click menu - Add Cam by WiFi. The camera will be paired to the NVR within a minute.

Tips: make sure your NVR has an empty channel for the new camera.

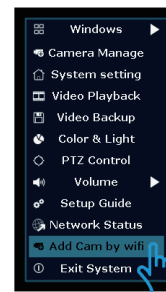



8. Pair the camera to mini WiFi hub (optional)



1. Hold the camera's reset button for 5 seconds to bring camera into pairing mode.

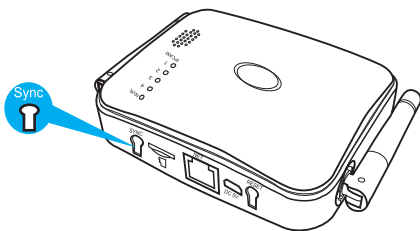

2. On the mini WiFi hub, hold SYNC button for 3 seconds to bring the hub to pairing mode. You should hear 'Start matching code'.

Within a minute, the camera should be paired to the hub. One of the LEDs on hub should turn to solid green.



9. Install the camera

1. Unscrew the bracket from the camera. Use a pencil to mark screw holes on the wall.
2. Fix the bracket on the wall with 3 screws.

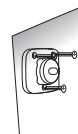
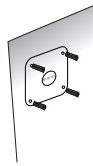

3. Attach the camera to bracket and adjust the view angle.

4. If you use a solar panel, mount the solar panel and plug to the camera. Adjust the panel so it captures good sunlight.

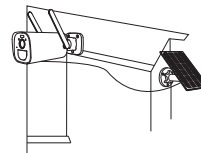
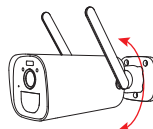

PIR sensor is sensitive to heat changes, please note:

- Avoid installing the camera where has complicated air flows. For example: the air vent of an air conditioner, the side of a fan etc.
- Please do not install the camera against glass or a mirror.
- While installing, avoid lining up the camera with a path. Keeping some angle will help the camera to sense people.
- Do not install the camera upside down. (PIR sensor is the downside.)



10.App - Camera List

- ① Group. With group, you can group multiple cameras to a quad view or multiple view. Then you can view multiple cameras simultaneously with one tap.
- ② Camera name, network status
- ③ Quick menu to recorded photos & videos, edit/delete camera.
- ④ Share device with families or friends
- ⑤ Alarm messages
- ⑥ Video playback
- ⑦ Camera settings

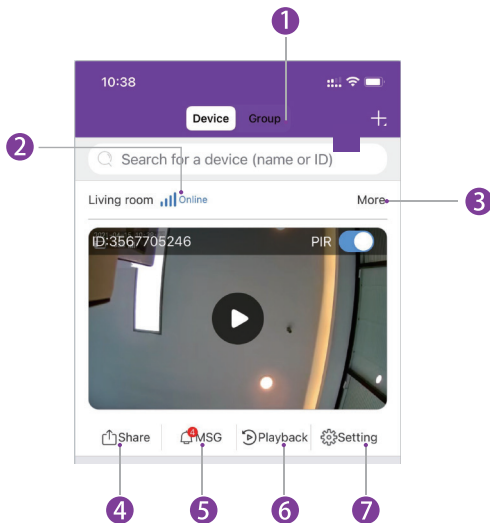

11.App - Live Footage

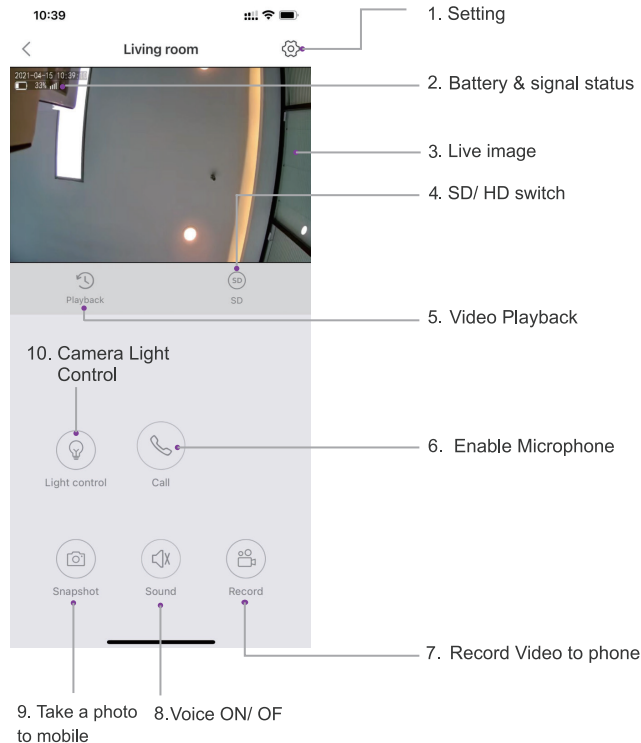



12. App - Video Playback

In camera list, tap **Playback** to play camera's recorded videos.
Make sure you have Micro SD card in the camera.

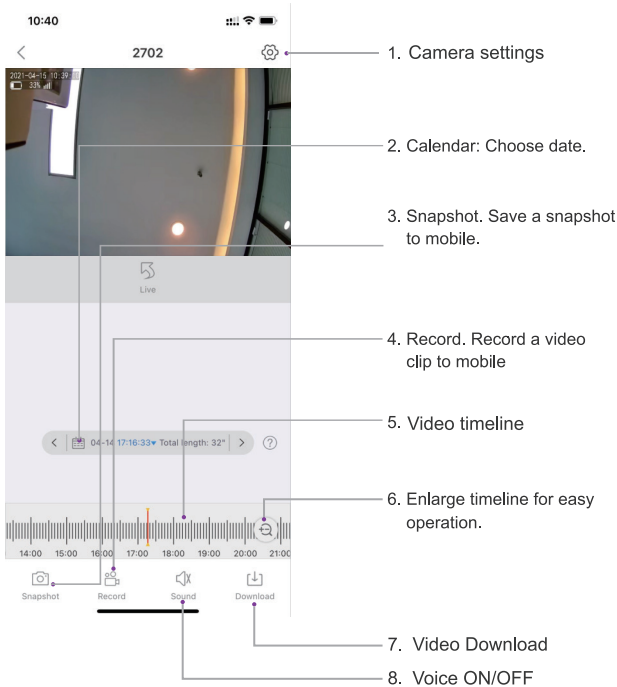

13. Camera Settings

In camera list, tap **Setting** to enter camera settings.

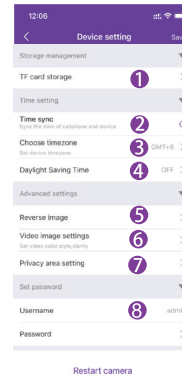
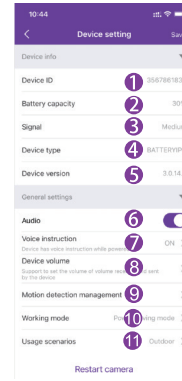

● **Important tips: please set your password to secure your camera**



14. Motion Detection Management

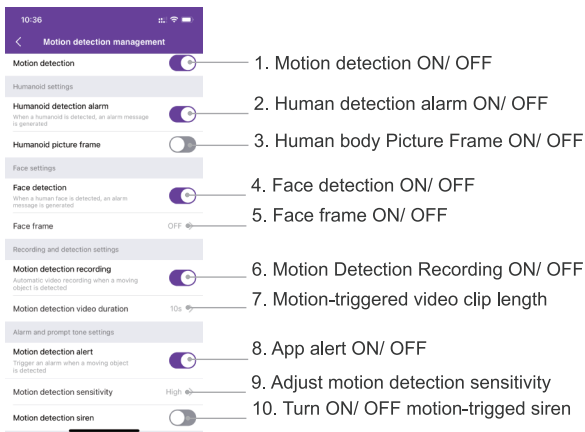

15. Camera Light Control

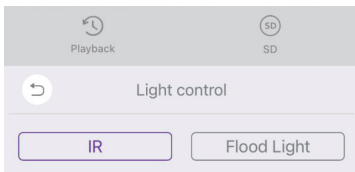

IR mode: Use IR LEDs at night. Image is in B&W.

Flood Light Mode: Flood lights turn on when people detected at night. Night vision image is in color.



16. Me - APP Overall Settings

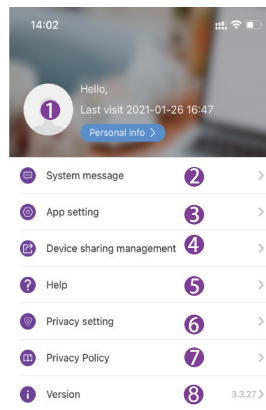

- 1 Tap profile photo to enter your App account settings.
- 2 Check App system notifications.
- 3 App-related settings.
- 4 Manage device sharing status.
- 5 Help center and feedbacks.
- 6 App permission settings from your mobile.
- 7 App privacy policies.
- 8 App version number.

17. App Setting

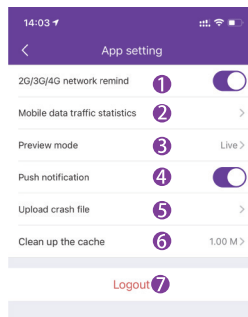

- 1 Turns ON/ OFF cellular data reminder.
- 2 Mobile data traffic situations.
- 3 Switch live view mode among Fluent & Live.
- 4 Turn App messages ON/ OFF.
- 5 Report App crashes to developer.
- 6 Clean App cache.
- 7 Logout your App account.



18. Troubleshooting

	Trouble	Solution
1	Unsuccessful network configuration	1. Make sure your phone, camera, and router are close enough. 2. Note that the camera cannot support connection to a 5G WiFi. 3. Make sure to provide correct WiFi and password.
2	Device offline	1. Check your router's Internet connection. 2. Check the connection between the camera and the router. If you changed the WiFi name or password, you need to reset the camera and setup again. 3. Check if the camera is out of battery. Recharge the camera when needed.
3	No live view	Restart the app and try again.
4	No push notification	1. Make sure the app has notification permissions. 2. Make sure the Motion detection alert of camera setting, and Push notification of App setting are both turned on.
5	No recording	1. Please insert an SD card to the camera before power on; check SD card status in camera setting. If it is abnormal, try to format the SD card. 2. Make sure the camera PIR switch is turned on. 3. Make sure the camera recording switch is turned on.



19. FAQ

Q: Why does the battery run out quickly?

A: 1. The battery will run out faster if there are more activities everyday. Please check if there are unnecessary video clips in messages. Try to lower the motion detection sensitivity if necessary.

2. Check if the camera is having weak WiFi signal to the router or NVR. You can try to change the WiFi channel of the WiFi NVR or router; or adjust the positions of the NVR, router or camera to improve the signal transmission.

Q: How to check the connection status between the camera and the router (or NVR)?

A: 1. Move in front of the camera to trigger the PIR sensor. If the camera flashes in red, it means that the camera cannot connect to the router or wireless NVR smoothly.

2. If the camera is working with a WiFi NVR, try to replay the camera from NVR to see if the videos replay normally. While replaying the camera, the camera's indicator should stay on.

Q: What should I do if I forgot my password?

A: 1. If you forgot the login password of your App account, please reset the password through the "Forgot Password" option in the login interface of App.

2. If you forgot the camera's access admin password, the only way to restore the password is: take the camera down, reset it and pair the camera to network again; then set a new password in camera setting.



FCC STATEMENT

This equipment has been tested and found to comply with the limits for a Class B digital device, pursuant to part 15 of the FCC Rules.

These limits are designed to provide reasonable protection against harmful interference in a residential installation.

This equipment generates, uses and can radiate radio frequency energy and, if not installed and used in accordance with the instructions, may cause harmful interference to radio communications.

However, there is no guarantee that interference will not occur in a particular installation. If this equipment does cause harmful interference to radio or television reception, which can be determined by turning the equipment off and on, the user is encouraged to try to correct the interference by one or more of the following measures:

- Reorient or relocate the receiving antenna.
- Increase the separation between the equipment and receiver.
- Connect the equipment into an outlet on a circuit different from that to which the receiver is connected.
- Consult the dealer or an experienced radio/TV technician for help. This equipment complies with FCC radiation exposure limits set forth for an uncontrolled environment. This equipment should be installed and operated with minimum distance 20cm between the radiator & your body.

FCC NOTICE

This device complies with Part 15 of the FCC rules. Operation is subject to the following two conditions: (1) This device may not cause harmful interference; and (2) this device must accept any interference received, including interference that may cause undesired operation.

FCC CAUTION

Caution the user that changes or modifications not expressly approved by the party responsible for compliance could void the user's authority to operate the equipment.

Note: While using the product, please comply with your local laws and regulations of audio & video devices.

If you have further questions, please refer to help center at,

www.xmarto.com

or contact us at support@xmarto.com

Thank you!