

MODEL
FC-4900

Night Guard

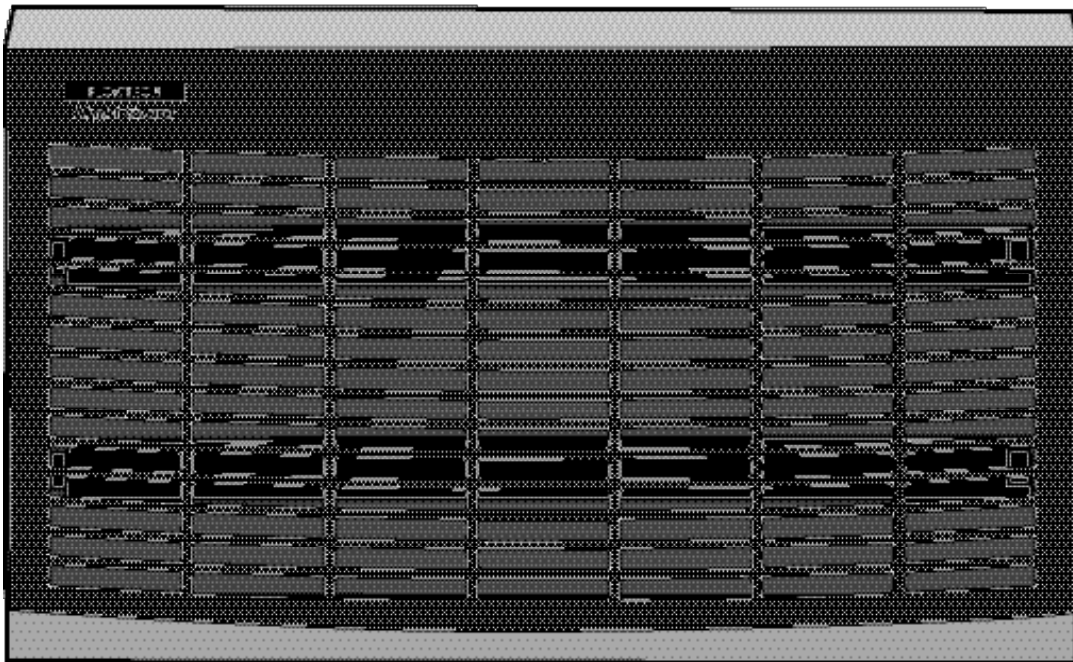

OWNER'S MANUAL

OPERATION • INSTALLATION • MAINTENANCE

INTRODUCTION

Flowtron's Night Guard fly control unit combines black light energy with an exclusive fly attracting pheromone (Fly Sex Lure) to make it a powerful fly control unit that is ecologically safe, effective and economical to operate. Designed for wall mount or portable application, its attractive appearance provides for placement in public areas as well as in back-of-store locations.

Flies and other light sensitive flying insect pests are attracted to the unit's ultraviolet light and special fly lure, and are eliminated as they come in contact with the "no-escape" adhesive board.

Captured insects remain intact permitting use in and around food handling areas. Meets all applicable FDA, OSHA and USDA guidelines.

For best results, operate your Fly Control unit 24/7 year round.

SAFETY INSTRUCTIONS

CAUTION

1. For commercial indoor use only. Device not constructed for use outdoors or in wet locations including roofed but open porches.
2. Only use grounded 110/120 volt A.C. outlets and three-wire grounded extension cords.
3. For permanent installation, check local codes and consult a licensed electrician or authoritative instruction book before installing.
4. Do not abuse power cord. Never carry unit by its cord or yank cord to disconnect unit from receptacle.
5. Keep power cord protected from heat, oil and sharp edges. Repair damaged power cords promptly.
6. Disconnect power before cleaning and servicing.

PLACEMENT:

Proper placement of your fly control unit will enhance its effectiveness, range and safety.

Location:

Flowtron Night Guard fly control units are designed for use in front or back-of-store locations. They are useful in restaurants, food take-out locations, bars and lounges, supermarket meat and deli areas, food processing plants, barns, stables, hospitals or any place where flies are a threat to sanitation and where the use of chemical pesticides is undesirable.

Portable Applications:

For off-hour operation, place unit on countertop, shelves or other work surfaces. For sporadic fly infestations, move unit from infected area to infected area as required.

Wall Mount Applications:

For best results, place unit adjacent to entrances, exits or in heavily infested areas away from direct or reflected sun light. When installing units in halls, passageways or aisles, maintain a minimum clear width for continuous passage of 36 inches. (Reference: American Disabilities Act.)

Height:

Flies generally operate at heights of up to six feet. For best results, fly control units should be placed three to six feet above the floor or higher in locations where temperatures are significantly cooler at the lower heights.

Spacing:

Fly control units should be spaced evenly throughout a facility. As a general rule distances between traps should be as follows:

Model FC-490020 feet apart
(500 sq. ft. coverage)

INSTALLATION:

Remove unit from its carton and insure that the unit is free from transportation damage.

Portable Applications:

Hinge the four wire supports located on underside of unit outward to provide added stability. Plug power cord into the receptacle at top edge of unit and the plug end of cord into a nearby 110/120 volt A.C. grounded receptacle. (See section on **Grounding Instructions**.)

Wall Mount:

1. Install two screws in the wall 11 3/4 inches apart and mount the Night Guard unit using the keyhole openings in the rear panel.

NOTE: Use wall anchors as required at screw locations.

2. Locate a nearby electrical receptacle and run the power cord to the receptacle. Fasten appropriately to the wall to secure the power cord in place. Use a three-conductor extension cord with a three-prong grounding type plug if required. (See section on Grounding Instructions.)
3. Install adhesive board and Fly Sex Lure. See **Maintenance** section of the Owner's Manual for directions.

4. Plug the power cord into the receptacle at the top edge of the Flowtron Night Guard unit. Plug the other end of the power cord into a grounded 110/120 wall receptacle.

GROUNDING INSTRUCTIONS:

Your Fly Control unit is equipped with a three-conductor power cord and a three-prong grounding type plug to fit the proper grounding type receptacle. To reduce the risk of electrical shock, the plug must be plugged into an appropriate outlet that is properly installed and grounded. The Fly Control unit has a grounding plug that looks like the plug shown, and is intended for use on a circuit that has an outlet as shown. Consult a qualified electrician or serviceman if the grounding instructions are not completely understood, or if in doubt as to whether proper grounding exists.

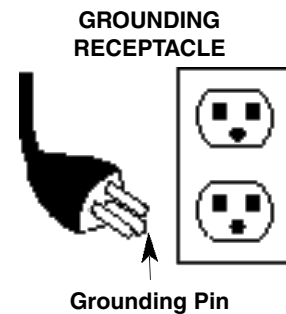

FLY SEX LURE:

Flowtron Night Guard fly control units use a specially designed slow-release strip containing (Z)-9-tricosene, a non-toxic and odorless fly lure, to substantially increase the effectiveness of the Fly Control unit.

U.S. Government researches have demonstrated that (Z)-9-tricosene, a synthetic compound identical to the sex pheromone of house and garbage flies, (*musca domestica* L.) enhances the effectiveness of glue board traps by a factor of three to six times that of non-baited glue traps.

To install the Fly Sex Lure, see instructions for replacing the lure in the Maintenance section of the Owners Manual.

MAINTENANCE:

Adhesive Boards:

As a general rule, adhesive boards should be replaced when 65%-75% of the surface is covered with debris and less than half of the available glue surface remains exposed.

To replace the adhesive board, remove the power cord from the side of the housing, raise the front grill and remove the used adhesive board by gripping its non-sticky tab located at the bottom of the adhesive board. Peel the covering from the replacement adhesive board and position the board along the back and bottom of the unit. Insure that the top edge of the board is positioned behind the retaining clips located at the top center and top edges of the back panel.

Flowtron replacement adhesive boards **GB-490** are available from your dealer or on-line at www.flowtron.com.

Fly Lure:

For best results the fly lure slow-release strip should be replaced each time the adhesive board is replaced or every 30 days, whichever is sooner.

The Fly Sex lure is placed on the adhesive board at the center between the two ultraviolet lamps. To install or replace the lure strip, remove the power cord from the side of the housing, raise the front grill and press the face of the replacement lure onto the adhesive board. Wrap used lure in newspaper and dispose in trash. Always wash hands thoroughly after contact with the lure strip.

Flowtron replacement Fly Lures # **FA-5000** are available from your dealer or on-line at www.flowtron.com.

Bulb(s):

Ultraviolet light is invisible to the eye and its effectiveness in luring flies decreases with time. Although the bulb appears to be functioning and is continuing to produce blue light, the invisible ultraviolet or “black light” component may no longer be effective. For best results replace bulbs every six months.

To replace a defective bulb, remove the power cord from the side of the housing, raise the front grill and remove the bulb by grasping and rotating the bulb 180° and pulling it horizontally out of its socket. Insert the replacement bulb into the bulb socket and rotate 180° into place.

Flowtron replacement bulb(s) # **BF-205** are available from your dealer or on-line at www.flowtron.com.

Starter(s)

To replace a defective starter, remove the power cord from the side of the housing, raise the front grill and remove the starter by twisting it counter-clockwise. Install replacement starter, type FS-2, by inserting it into the starter socket and twisting clockwise. Return the grill to its installed position.

FC-4900 PARTS LIST

REF.	P/N	ITEM	QTY
1	512 9875	Power Cord	1
2	572 9876	Front Grill	1
3	552 9877	Housing	1
4	552 9878	Top Plate	1
5	BF-205	Bulb	2
6	571 9879	Bulb Socket	2
7	571 9880	Bulb/Starter Socket	2
8	FS-2	Starter	2
9	532 9882	Ballast	2
10	571 9883	Power Receptacle	1
11	572 9884	Legs	4
12	545 9885	Shoulder Screw	2
13	GB-490	Adhesive Board	1
14	FA-5000	Fly Lure	1
15	557 9890	Owner's Manual	1

FC-4900 WIRING DIAGRAM

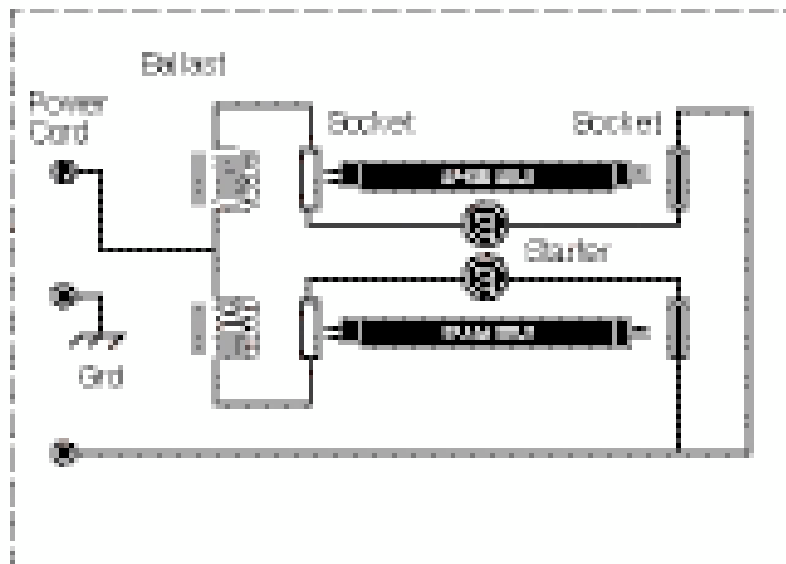

FC-4900

EXPLODED VIEW

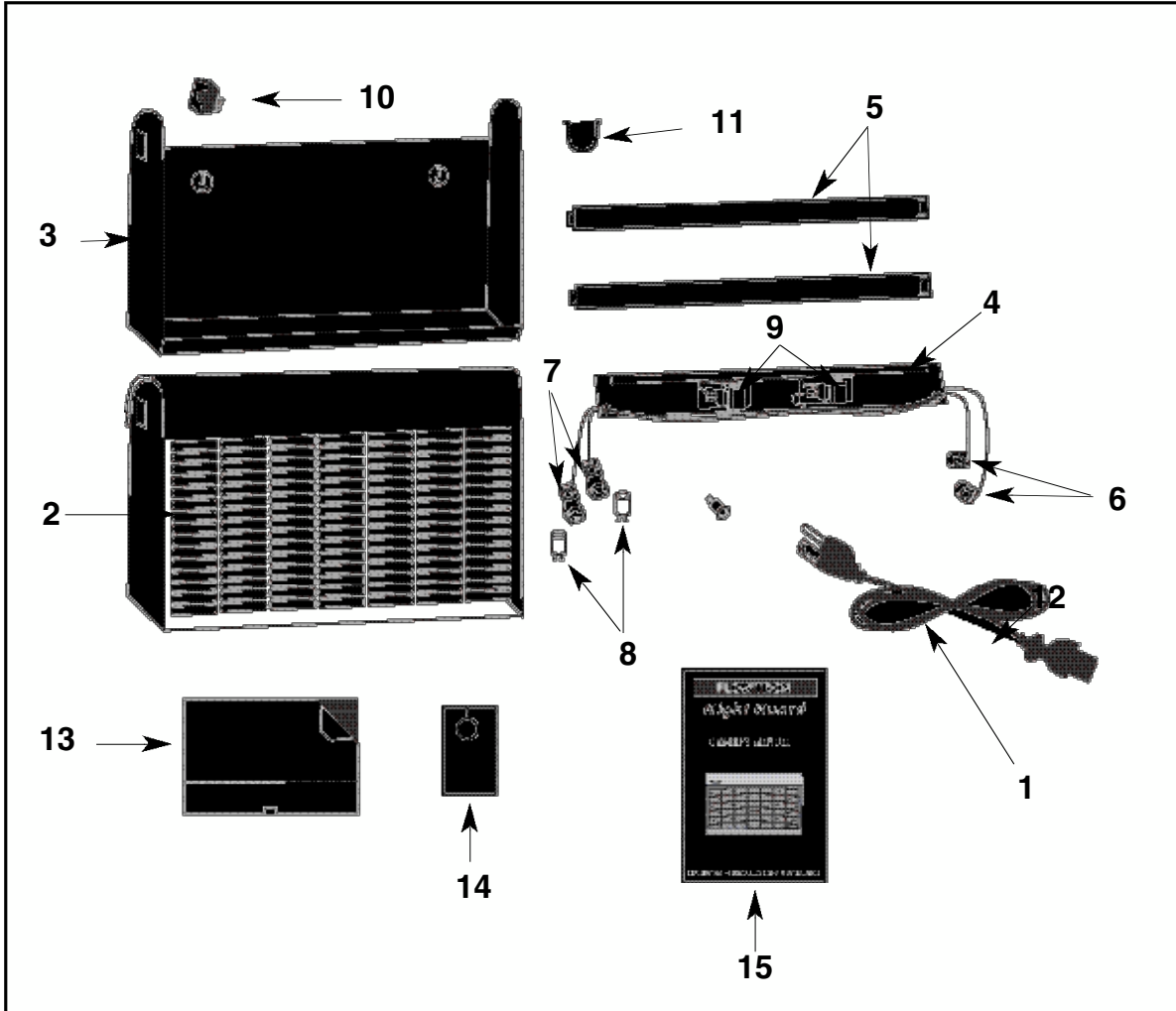

One Year Limited Warranty

Flowtron, division of Armatron, warrants your Fly Control unit to be free from defects in materials or workmanship under normal use and service for one year from date of the original purchase. All parts, except for burned out bulbs, which are defective, will be repaired free of charge. Any implied warranties, including the implied warranty of merchantability are also limited in duration to the one year period from the original purchase date.

The provisions of this warranty shall not apply to any Fly Control unit which has been subject to misuse, neglect or accident, nor which is used for a purpose for which it is not designed, or which shall have been repaired or altered in any way as to adversely affect its performance and reliability. Service by unauthorized parties voids your warranty.

Flowtron neither assumes nor authorizes any person to assume for it any other liability in connection with its products. No responsibility is assumed for any consequential damages that may result from the use of a Flowtron product, nor for damages due to accident, abuse, lack of responsible care, the affixing of any unauthorized attachment, loss of parts or subjecting this unit to any but the specified voltage. Some states do not allow the exclusion or limitation of incidental or consequential damages, so the above limitation or exclusion may not apply to you.

If the unit fails to operate during the warranty period, send the product along with purchase receipt showing purchase date and description to: Flowtron Service Center, 15 Highland Ave., Malden, MA 02148. Transportation costs for returning any defective product are the responsibility of the user.

This warranty gives you specific legal rights and may also have other rights which vary from state to state.

Troubleshooting and Repair Analysis Caution: unplug unit before servicing

Problem	Possible Cause	Correction
A. Bulb(s) do not light.	1. No electrical power. 2. Lamp(s) not seated properly 3. Starter defective. 4. Burned out bulb(s)	1. Check fuse or circuit breaker. Check extension cord. 2. Check socket(s) for proper seating and alignment. 3. Replace starter. 4. Replace bulb(s).
B. Bulb lights, but no longer attracts flies.	1. Invisible blacklight output reduced due to bulb age. 2. Fly lure not longer effective.	1. Replace bulb. See bulb replacement section of owner's manual. 2. Replace Sex Lure strip.

Any problems you encounter that are not corrected by the action recommended in this chart should be referred to the Flowtron Service Dept. 617-321 2300.

ACCESSORIES



Adhesive Board
GB-490
 Six-pack supply of replacement adhesive boards.



Fly Sex Lure
FA-5000
 Makes your Fly Control unit more effective in eliminating house and garbage flies.



Ultraviolet Replacement Bulbs
BF-205
 Two-pack supply of replacement bulbs.
 Six month bulb replacement recommended to maintain maximum black light output.