

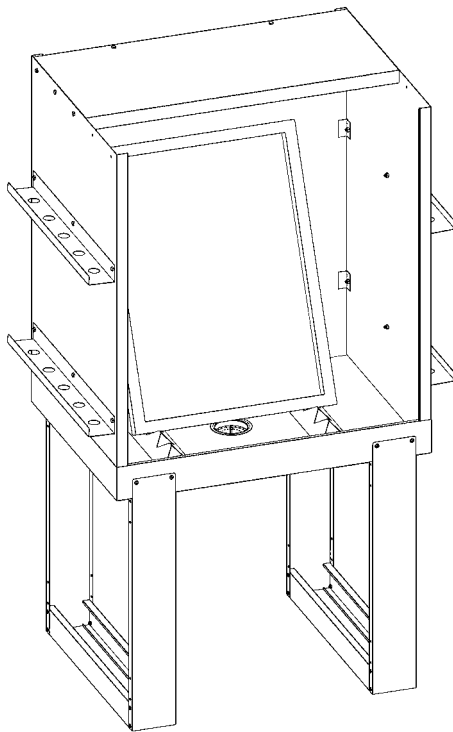

# Washout Booth

Assembly instructions for: VWB-3627-AC  
VWB-5127-AC



**VWB-3627-AC**

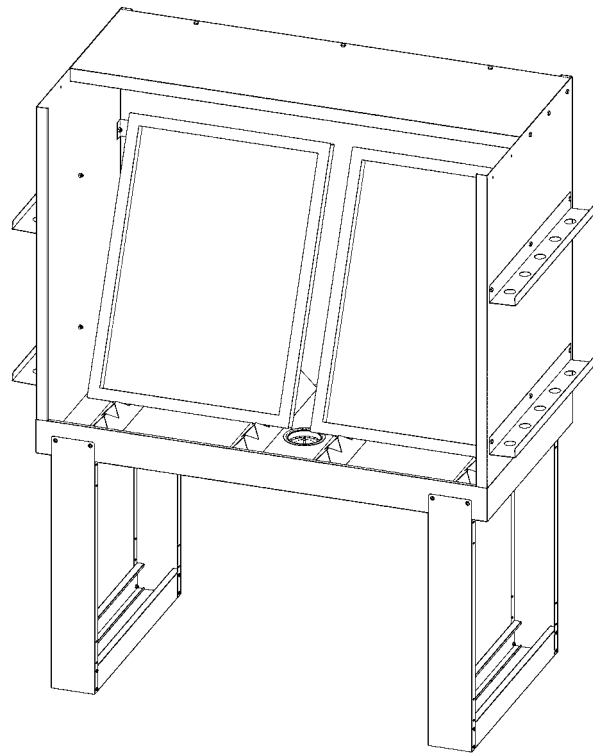

**VWB-5127-AC**

## **Contents**

General Information  
Safety  
Tools Required  
Parts List  
Assembly Instructions  
Bill of Materials

## **Pg. #**

2  
2  
2  
2  
3-5  
6-7

**Vastex International, Inc.**  
7 Emery St  
Bethlehem, PA 18015 USA  
Phone# 610 625-2702  
Fax# 610 625-2775  
Web Site [VASTEX.COM](http://VASTEX.COM)  
E-Mail [info@vastex.com](mailto:info@vastex.com)

---

## **General Information**

---

**Thank you** for purchasing your printing equipment from Vastex International Inc.

Vastex has been designing and building printing equipment since 1960. We have knowledge and experience, and are proud to supply the printing industry with quality equipment at an affordable price. You can be confident your purchase will give you years of trouble free service.

---

## **Safety**

---

### **Intended Use:**

This equipment is intended for the preparation and cleaning of screens and other screen coating equipment and accessories.

### **Safety:**

- The operator should read and understand this manual before operating this equipment. Store manual and safety information near equipment for easy access to operators.
- Keep children and pets clear of the work area.
- Be sure to clear workspace before assembling this unit.
- Eye protection and other appropriate PPE must be worn when operating this equipment.
- Proper plumbing and plumbing fixtures are to be installed once the unit is in its final determined position.
- The unit is not to be placed into operation until plumbing of the unit is completed..
- Equipment is not to be relocated until all plumbing and all attached fixtures have been removed from the unit.

---

## **Tools Required**

---

- Philips Head Screw Driver
- 3/8", 7/16" Wrenches.
- **OR METRIC:** 8mm, 11mm.

---

## **Parts List**

---

Refer to drawings on pages 6 and 7 of this document.

- Pg. 6 VWB-3627-AC
- Pg. 7 VWB-5127-AC

# Base Model Assembly

## Leg Assembly

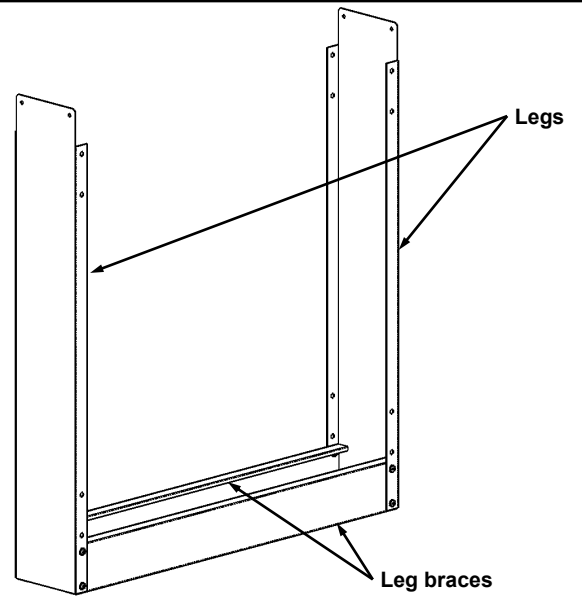
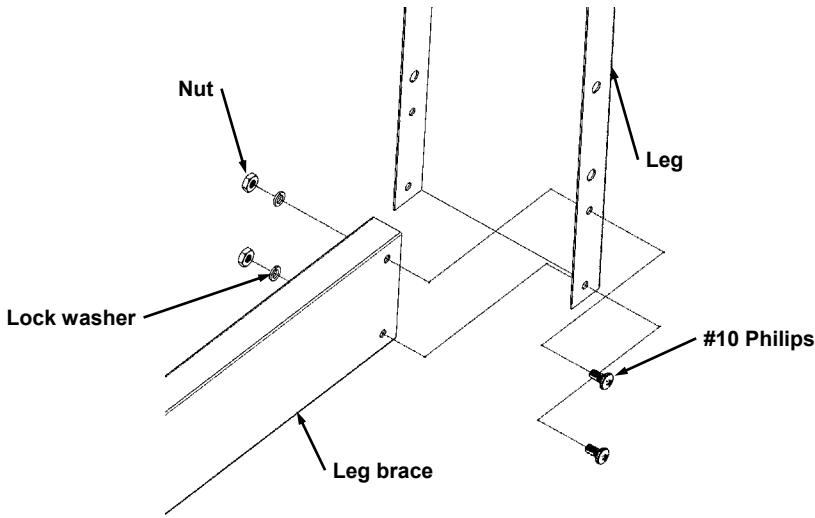

- 1) Install brace to leg. Tighten screws with Phillips head.

Assembled leg set (2x)

## Leg Assembly to Base

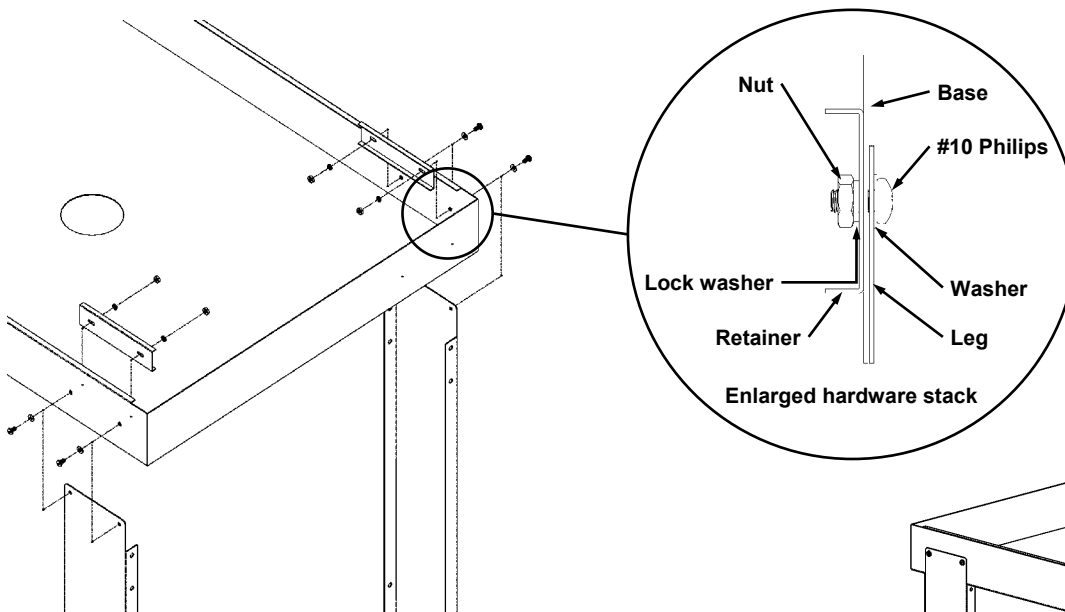

- 2) Attach base to legs. Tighten screws with Phillips head.

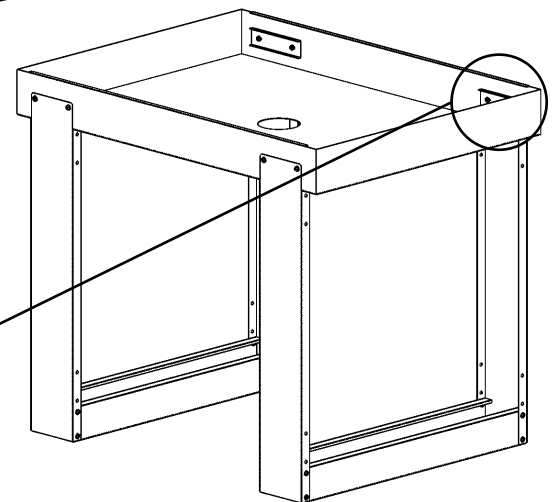
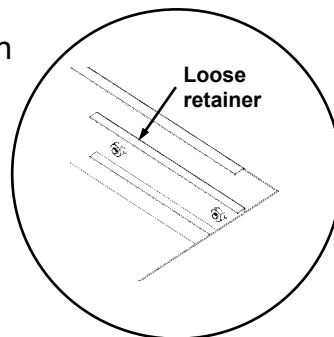

Base with legs

# Base Model Assembly

## Hood Assembly

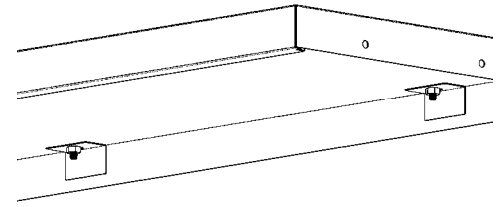
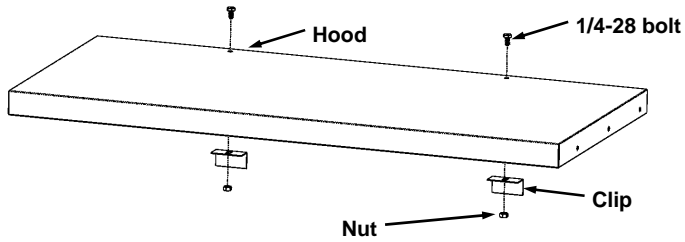

Underside of hood

3) Install clips loose with 1/4-28 bolts.

## Side Panel Attachment

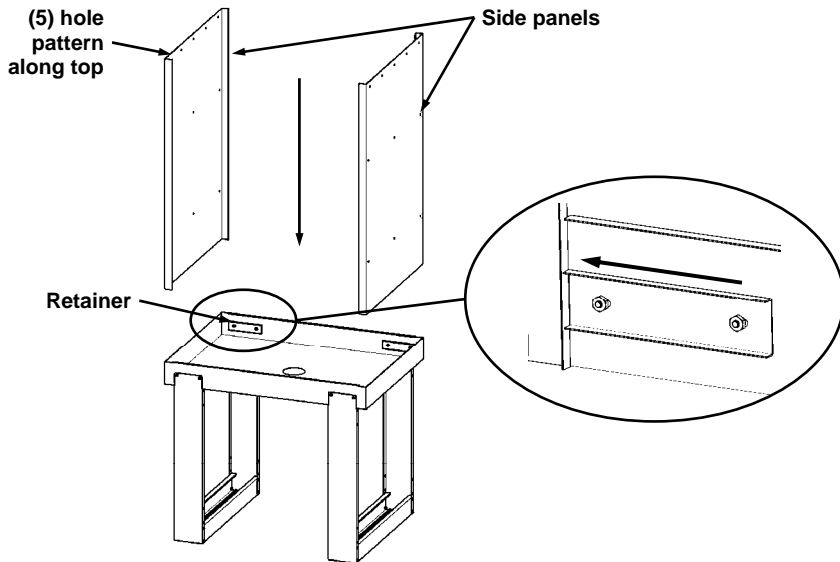

4) Insert side panels.

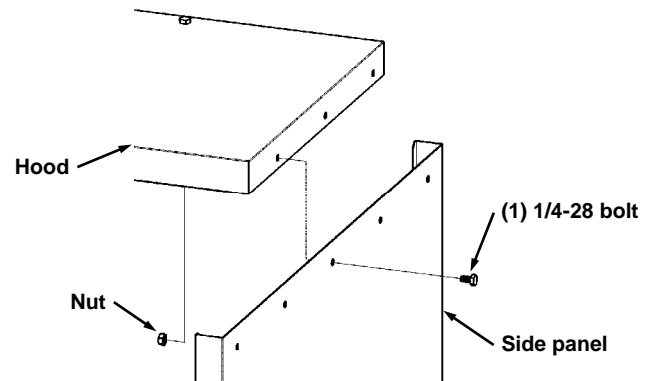

5) Connect the hood to side panels. Use a 7/16" wrench to tighten screws.

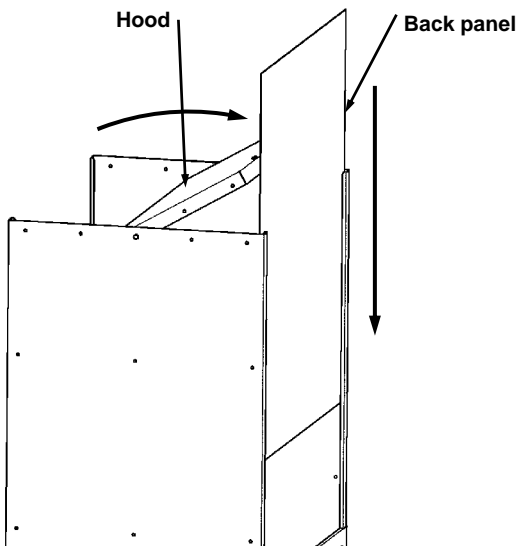

6) Install back panel.

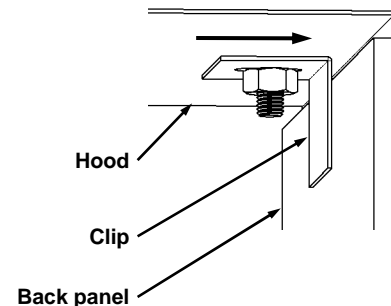

7) Tighten clip against back panel. Use 7/16" wrench for tightening.

# Base Model Assembly

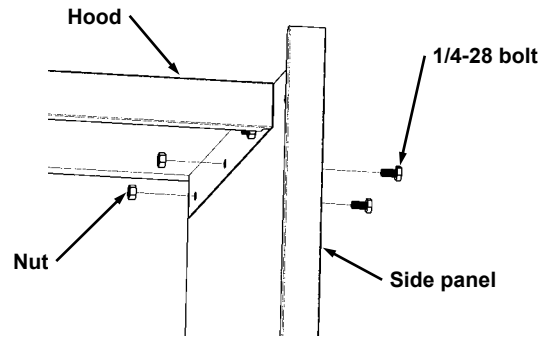

- 8) Install (4) remaining bolts to hood and side panels with 7/16" wrench.

# Final Assembly

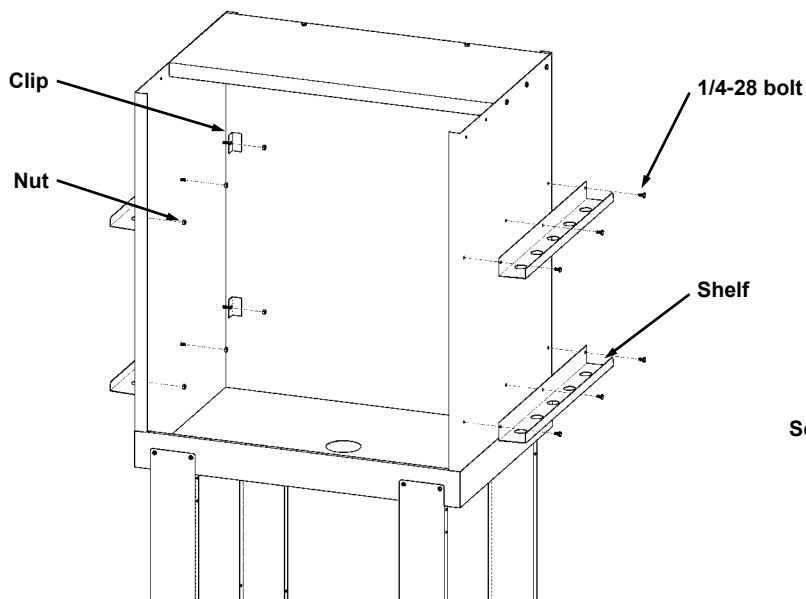

- 9) Install side panel clips and shelves using a 7/16" wrench.

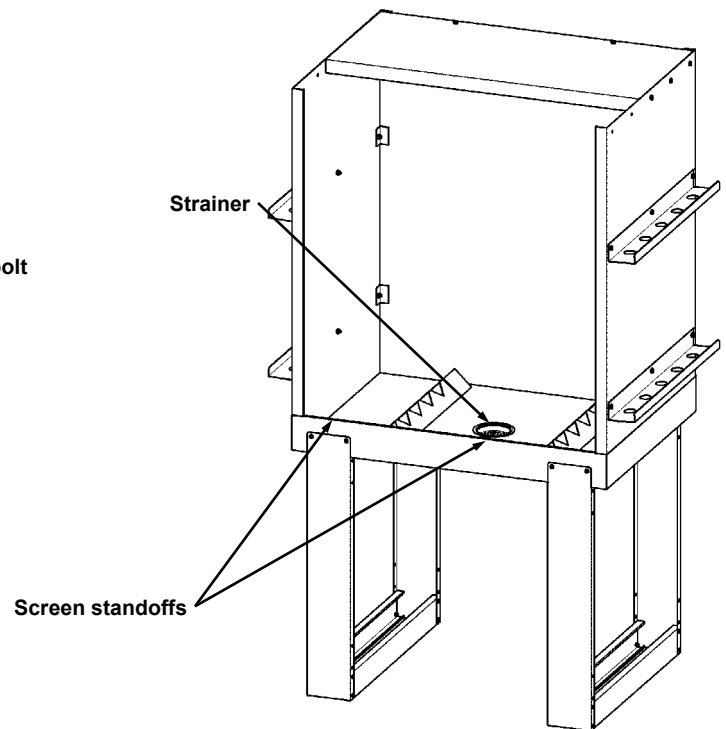

- 10) Place screen standoffs in base and install strainer per instructions on package.

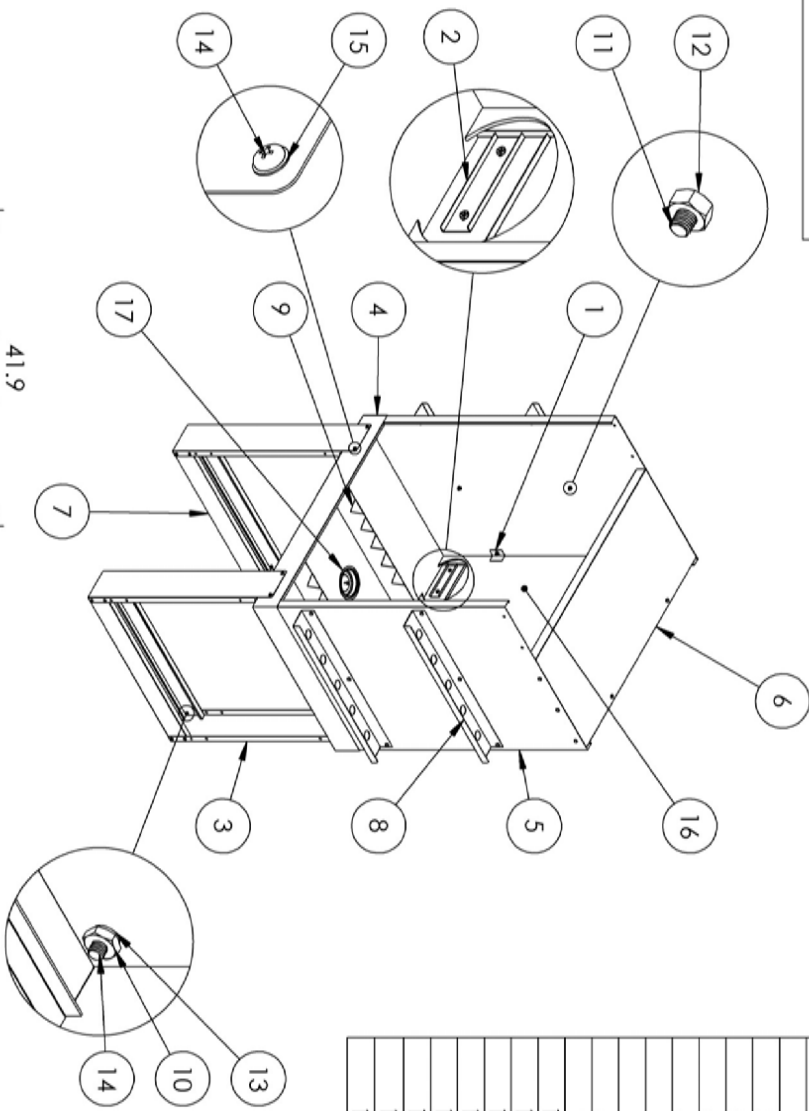

ITEM NO.	Part Number	Description	Qty
1	13-01-005-0	SIDE CLIPS	6
2	13-01-007-0	RETAINER CHANNEL	4
3	13-01-008-0C	LEG VERTICAL	4
4	13-02-001-0	BASE	1
5	13-02-002-0	SIDE PANEL	2
6	13-02-003-0	HOOD	1
7	13-02-004-0	BRACE LEG: 27	4
8	13-02-005-0	SHELF	4
9	13-02-006-0	SCREEN STANDOFF	2
10	04-05-060	NUT #10 -32HEX STAINLESS STEEL	24
11	04-05-180	BOLT 1/4-28 x 1/2 SS HEX HEAD	20
12	04-05-181	NUT 1/4-28 SS	20
13	04-05-182	LOCK/WASHER SS #10	24
14	04-05-183	BOLT #10 SS 10-32X3/8 PH/PH	24
15	04-05-184	WASHER #10 SS	8
16	04-13-227	BACK PANEL, TRANSLUCENT	1
17	04-16-100	SINK STRAINER, 1 1/2" NPT	1

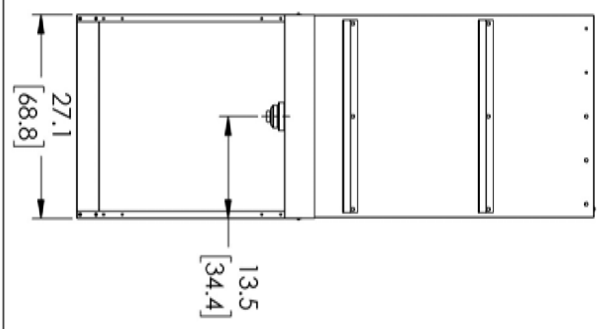
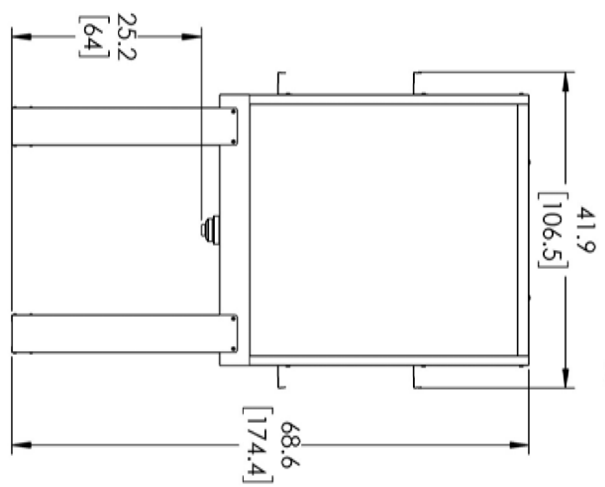

SCREEN PRINTING MANUFACTURED SINCE 1980 VASTEX.COM		TOLERANCE UNLESS OTHERWISE SPECIFIED		TITLE: <b>VASTEX INTERNATIONAL</b>	
XXX	XX	X	XXX	XX	X
DECIMAL	+	-	+	-	+
FRACTION	+	-	+	-	+
ANGLE	+	-	+	-	+
DATE	BY	CHKD	DATE	BY	CHKD
DRAWING NO. <b>C VWB-3627-AC</b>			SCALE: 1:12		
WASHOUT BOOTH 36 X 27			SHEET 1 OF 1		

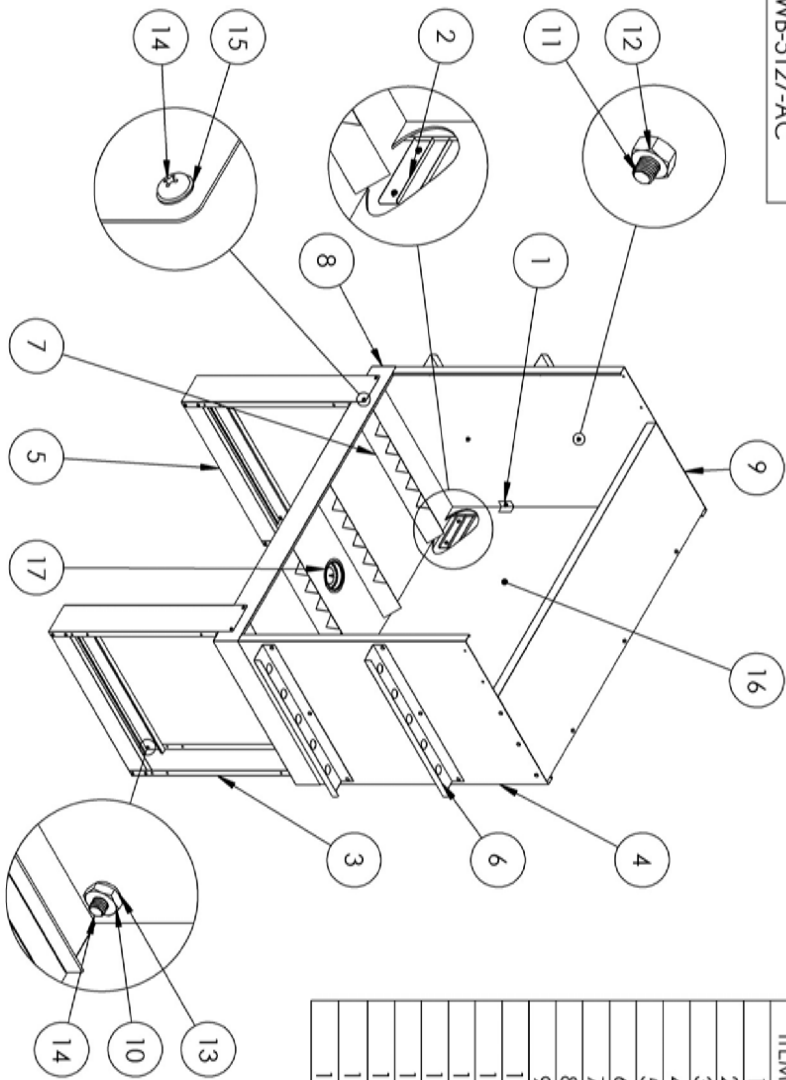

ITEM NO.	Part Number	Description	Qty
1	13-01-005-0	SIDE CLIPS	7
2	13-01-007-0	RETAINER CHANNEL	4
3	13-01-008-0C	LEG VERTICAL	4
4	13-02-002-0	SIDE PANEL	2
5	13-02-004-0	BRACE LEG, 27	4
6	13-02-005-0	SHELF	4
7	13-02-006-0	SCREEN STANDOFF	4
8	13-02-007-0	BASE	1
9	13-02-008-0	HOOD	1
10	04-05-060	NUT #10 -32HEX STAINLESS STEEL	24
11	04-05-180	BOLT 1/4-28 X 1/2 SS HEX HEAD	21
12	04-05-181	NUT 1/4-28 SS	21
13	04-05-182	LOCKWASHER SS #10	24
14	04-05-183	BOLT #10 SS 10-32X3/8 PH/PH	24
15	04-05-184	WASHER #10 SS	8
16	04-13-228	BACK PANEL, TRANSLUCENT	1
17	04-16-100	SINK STRAINER, 1 1/2" NPT	1

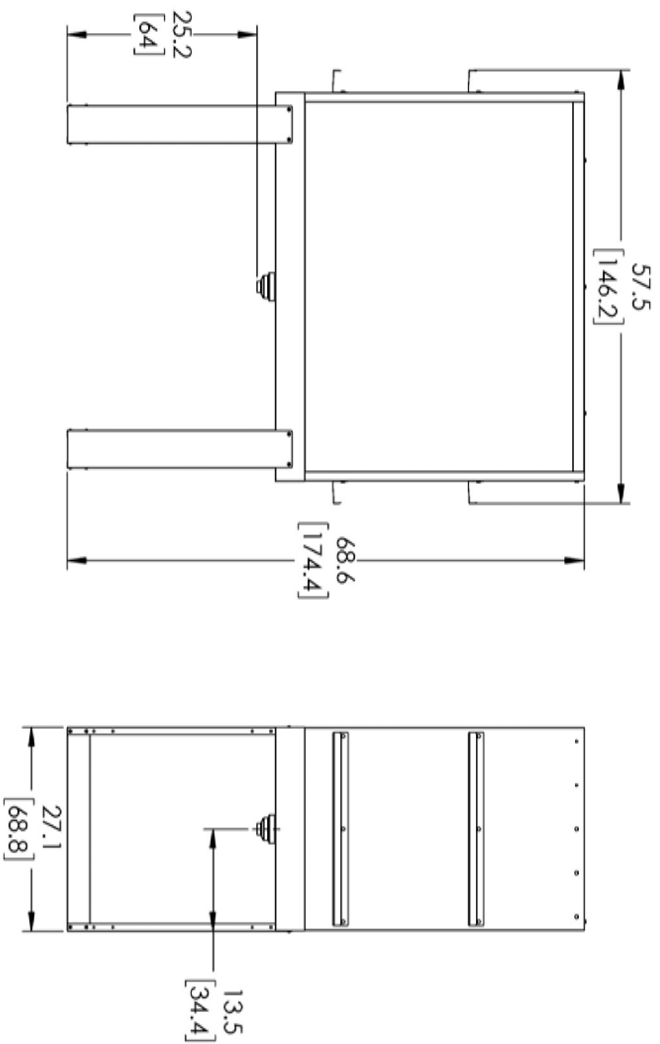

SCREEN PRINTING MAY BE FADING SINCE 1980		TOLERANCE UNLESS OTHERWISE SPECIFIED		TITLE	
VASTEX.COM		.XXX XX X		VASTEX INTERNATIONAL	
DATE	BY	DECIMAL	FRACTION	SIZE	DWG. NO.
		±.010 ±.015 ±.030	±.062	1/8"	VWB-5127-AC
CHECKED	DATE	ANGLE	±.1°	SCALE	SHEET
APPROVED				1:32	1 OF 1