

**Instruction manual**

Cooling device for mugs

**SCHULZE Mug Cooler Station**

# **1. Introduction**

## **1.1 Content**

---

<b>1. Introduction</b>	<b>02</b>
1.1 Content	02
1.2 Warning pictograms on the machine	03
1.3 Illustration of the machine	04
1.4 Technical data	04
1.5 Safety arrangements at the workspace	04
1.6 Environmental protection	04
<b>2. Initiation</b>	<b>04</b>
2.1 Notes regarding transportation	04
2.2 Installation of the machine	05
2.3 Power supply voltage	05
2.4 Initiation of the machine	05
2.5 Application range of the machine	05
<b>3. Maintenance</b>	<b>05</b>
3.1 Wiring diagram	05
3.2 Conformance Declaration	06

## Warning pictograms on the machine

Warnpiktogramme auf der Maschine  
Piktogramy ostrzegawcze na maszynie

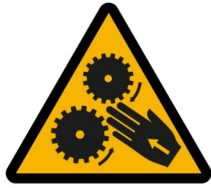

### ATTENTION! MOVING ELEMENTS

ACHTUNG! BEWEGLICHE TEILE  
UWAGA! RUCHOME ELEMENTY



### ATTENTION! HAND CRUSH HAZARD

ACHTUNG! QUETSCHGEFAHR DER HAND  
UWAGA! NIEBEZPIECZEŃSTWO  
ZGNIECENIA DŁONI



### ATTENTION! DANGER

ACHTUNG! GEFAHR  
UWAGA! NIEBEZPIECZEŃSTWO



### ATTENTION! HIGH VOLTAGE

ACHTUNG! HOCHSPANNUNG  
UWAGA! WYSOKIE NAPIĘCIE



### ATTENTION! HOT SURFACE

ACHTUNG! HEIÙE OBERFLÄCHE  
UWAGA! GORAÙA POWIERZCHNIA



### ATTENTION! THE HEAT PRESS OPENS AUTOMATICALLY

ACHTUNG! PRESSE ÖFFNET AUTOMATISCH  
UWAGA! PRASA OTWIERA SIĘ AUTOMATYCZNIE

## 1.3 Illustration of the machine

---



1. Fan
2. Main switch

## 1.4 Technical data

---

Dimensions	63 x 43 x 28 cm
Weight	13,5 kg
Power supply voltage	230 VAC
Fan	1 pc..

## 1.5 Safety arrangements at the workspace

---

### Testing the machine

After the correct installation of the machine it is important to ensure that the machine works properly, is not damaged after the transportation and has no safety defects. The testing can only be done by the employer or other authorized persons. It is mandatory to guarantee a correct installation and safe usage of the machine. The machine is destined for industrial use only. Instruction for installation of the machine can be found in chapter 2.2.

### Information and education

According to §81 the industrial law and §14 employment protection law (german law), the advice from the producer and general safety arrangements at the workplace, the employer has to make arrangements to give all information about the safety, function and the range of application to the user. In particular the user needs to be acquainted with the complete manual and be explicitly informed of the dangers of working with the machine. The details have to be explained in a coherent form and language.

### Safety arrangements

- In order to ensure optimized safety, please read the instruction manual precisely.
- Only one person is allowed to work on the machine at the time.
- The power plug has to be pulled out of the power supply, while maintenance.
- **Very important!** The machine may be connected only to an installation provided with a protection against electric shock.

## 1.6 Environmental protection

---

The packaging of the device must be disposed of in accordance with the applicable rules. Do not dispose of the equipment marked with an  together with your household waste. No longer needed machines may be returned to the manufacturer or disposed of in an environmentally friendly manner by means of appropriate disposal systems.

## 2. Initiation

### 2.1 Notes regarding transportation

---

The SCHULZE Mug Cooler Station is covered with a cardboard for transport. Right after receiving it should be checked, if the cardboard and the machine are in good condition without damages. It has to be done just after receiving the goods and in accompany of a responsible person. If the machine has to be sent somewhere else, it should be covered with the same cardboard and in the same way as when it was delivered.

## 2.2 Installation of the machine

The machine has been secured against damage during transportation. After receiving and unpacking the machine, it must be assembled. Follow the instructions below.

1. Remove the tape (pictures 1-2).
2. In the plastic bag attached to the machine there are 4 screws and one Allen key (picture 3).
3. Loosen the 3 screws that secure the metal element (picture 4).
4. Rotate the element by 180° (picture 5).
5. Tighten all 7 fastening screws (pictures 6-7).

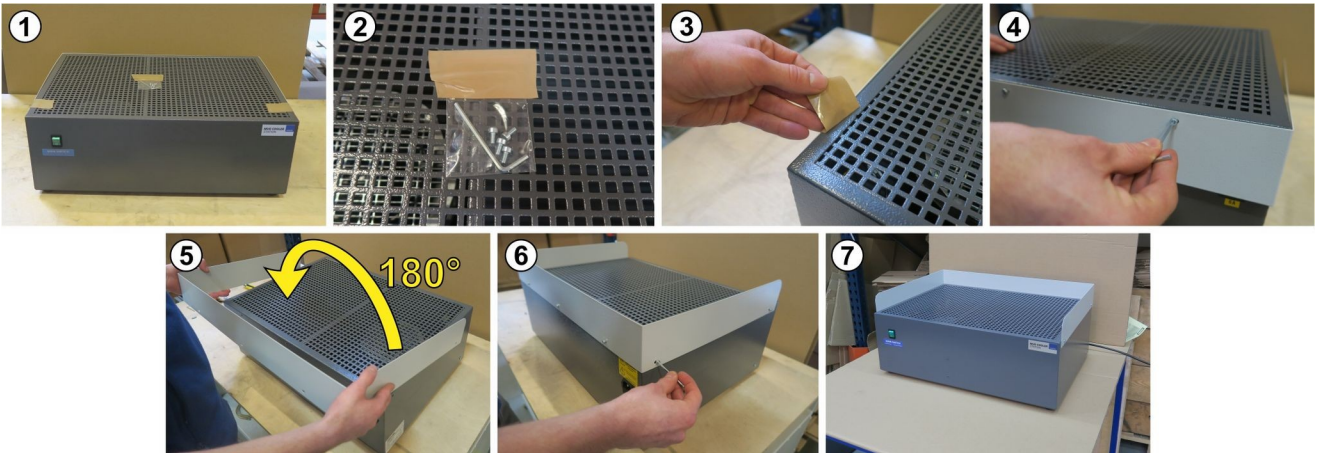

## 2.3 Power supply voltage

The SCHULZE Mug Cooler Station has to be connected to a voltage of 230 VAC / 50 Hz.

The machine is equipped with a power plug. Make sure that the power outlet is in the right condition and that the grounding is connected to it. Caution: Please do not connect this machine to any other outlet (socket) than those equipped with ground-fault protection ELCB (earth leakage circuit breaker). In case of doubt ask your licensed electrician to check the wiring. Connecting the machine to a socket that is not earthed, or where the earthing does not work properly, is hazardous to health and dangerous for the machine. Any damages arising from an improper plugging invalidates the warranty.

## 2.4 Initiation of the machine

Before connecting the device to the power outlet, check that the power outlet is in good condition and that the protective cable is properly connected. Switch on the machine using the green button. When finished, the switch must be turned off and the plug removed from the socket.

## 2.5 Application range of the machine

SCHULZE Mug Cooler Station is used to cool mugs after printing in the transfer press. The machine is not designed for cooling mugs filled with liquid. Mugs should be placed in an inverted position (bottom up) to ensure proper air movement also inside the mugs.

## 3. Maintenance

### 3.1 Wiring diagram

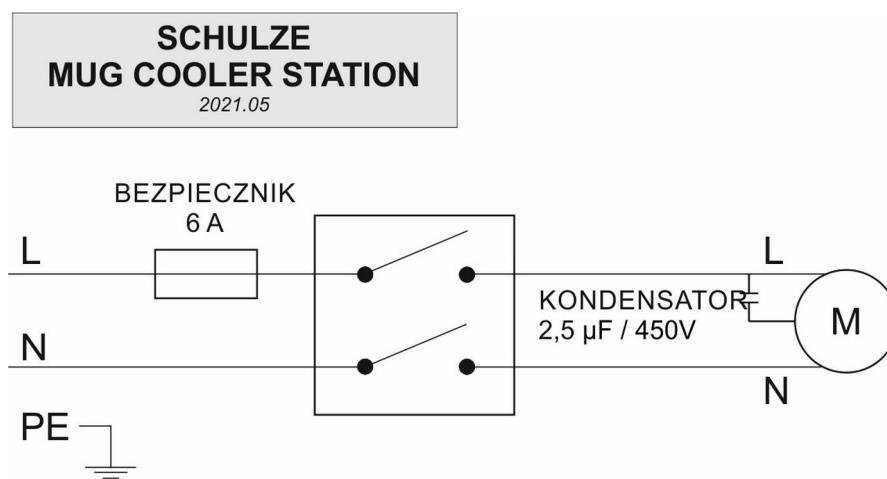

## 3.2 Conformance declaration

### CONFORMANCE DECLARATION

nr COOLER/05/21/01

Manufacturer ROMANIK Andrzej Romanik ul. Przemysłowa 10 84 - 240 Reda, Poland hereby declares that the following machine:

SCHULZE Mug Cooler Station

is compliant with the specifications of the followings EC directives:

Machinery (2006/42/EC)  
Low Voltage (2014/35/EU)  
EMC (2014/30/EU)  
RoHS II (2011/65/EU) and RoHS III (2015/863)

used norms and technical specifications:

PN-EN ISO 12100:2012  
PN-EN 60204-1:2018-12  
PN-EN 61000-6-1:2019-03  
PN-EN 61000-6-3:2008/A1:2012  
PN-EN ISO 13850:2016-03  
PN-EN IEC 6300:2019-01

Applied quality system: testing report / 2021

Reda, 11.05.2021 r.

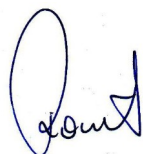

Company owner:  
Andrzej Romanik

Manufacturer:  
Romanik Andrzej Romanik  
ul. Przemysłowa 10  
84-240 Reda  
**Polen**

Distributor and representative:  
Walter Schulze GmbH  
Sarirstraße 5  
12529 Schönefeld  
**Deutschland**  
[www.schulzeshop.com](http://www.schulzeshop.com)

Entity authorized to prepare technical documentation and declaration of conformity: ROMANIK Andrzej Romanik ul. Przemysłowa 10,  
84-240 Reda, tel. 58 6780-700, e-mail: [sprzedaz@romanik.pl](mailto:sprzedaz@romanik.pl)

The manufacturer reserves the right to make constructional and technological changes.

